

TFH ARCHITECTS

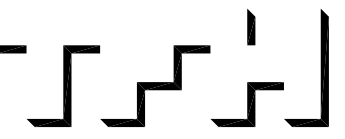

GRANT & MELLEEN SREET
PARKSIDE NEIGHBORHOOD CENTER & AFFORDABLE HOUSING
PEOPLE'S REGIONAL OPPORTUNITY PROGRAM
PORTLAND, MAINE



TFH ARCHITECTS
100 COMMERCIAL STREET
PORTLAND MAINE 04101
TELEPHONE 207 775 6141
ARCHITECTURE PLANNING

CONSULTANTS:

CIVIL:
Prakash & Greer
175 US Route One
Farmington, ME 04105
207-759-5242
STRUCTURAL:
Structural Design Consulting
Five Baskin Lane
Farmington, ME 04105-2448
207-878-8030
MECHANICAL:
Whitney Engineering
10 Danforth Place
Portland, ME 04102
207-833-2921
ELECTRICAL:
Bennett Engineering
7 Barnwell Road
Froesport, ME 04032
207-865-9475

REV#	DATE	DESCRIPTION
-	-	-
-	-	-
-	-	-
-	-	-

DATE: 01/29/04

PROJECT No. 0114

DRAWN BY: AWH

CHECKED BY: RPW

SCALE: AS NOTED

SHEET TITLE:

2ND FLOOR PLAN

BUILDING B

HVAC1.2

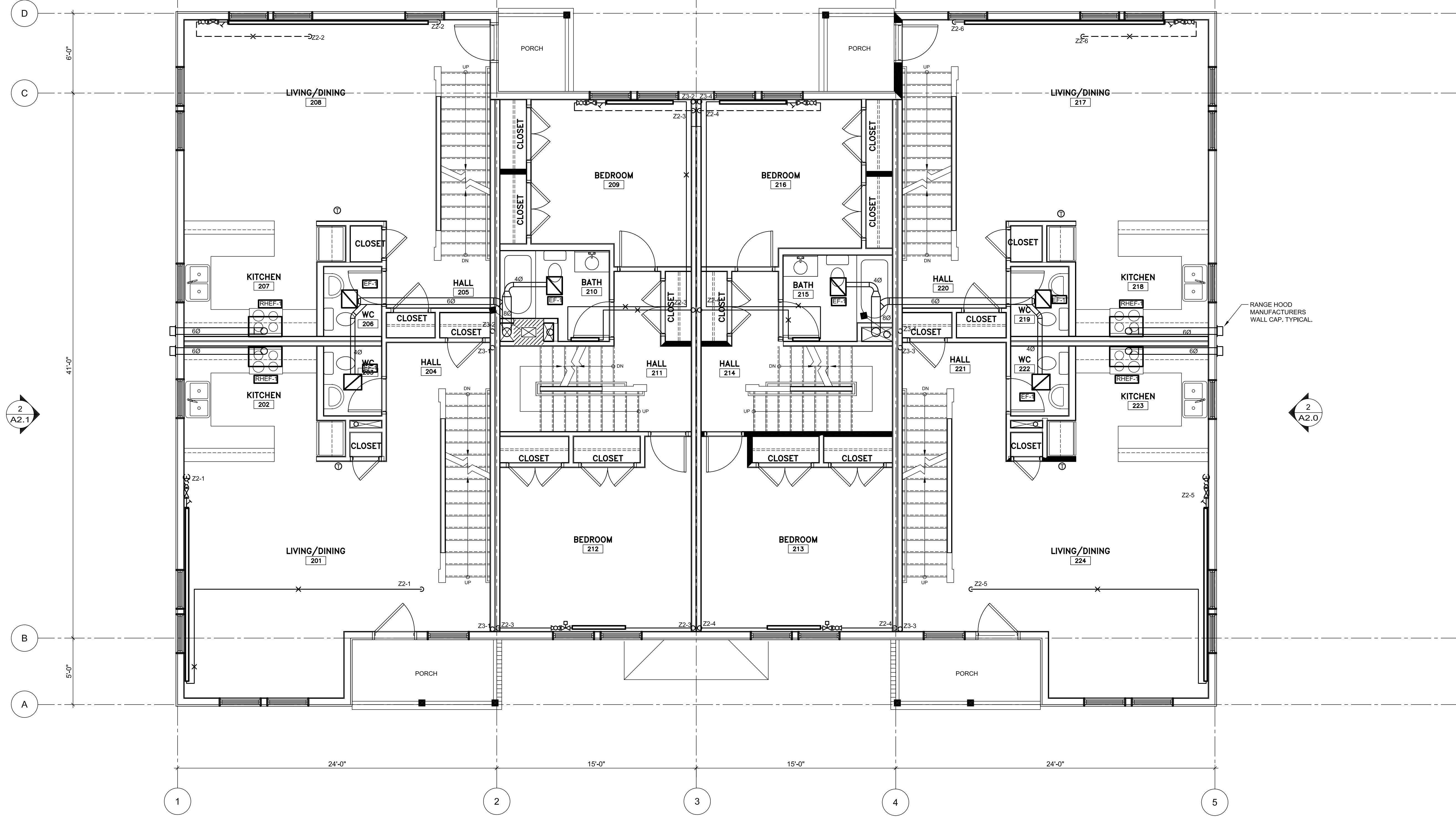

1 2ND FLOOR PLAN BUILDING B - HVAC
1/4" = 1'-0"

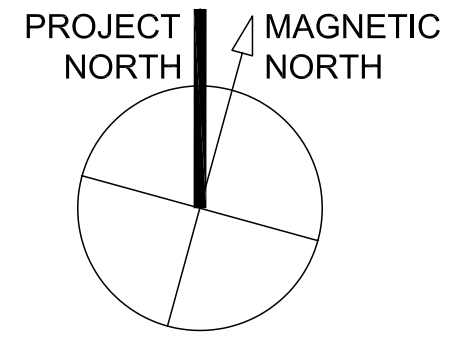
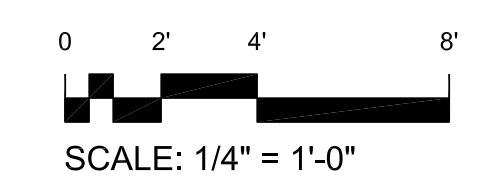

T:\00_TFH Projects\PROP0114_Mellen Grant\Rev\Proposed\Whitney\021004.mxd 10/24/04 10:49:53 2.DWG 2/28/04 FLOOR PLAN - 3/17/2004 9:47:45 AM