

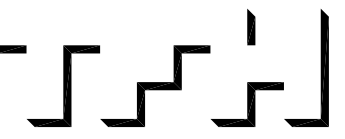

© TFH ARCHITECTS



GRANT & MILLEN SREET
PARKSIDE NEIGHBORHOOD CENTER & AFFORDABLE HOUSING
PEOPLE'S REGIONAL OPPORTUNITY PROGRAM
PORTLAND, MAINE



TFH ARCHITECTS
100 COMMERCIAL STREET
PORTLAND MAINE 04101
TELEPHONE 207 775 6141
ARCHITECTURE PLANNING

CONSULTANTS:

CIVIL:
Pirkham & Greer
170 US Route One
Farmton, ME 04105
207-783-0242

STRUCTURAL:
Structural Design Consulting
Five Baskin Lane
Farmton, ME 04105-2448
207-878-8030

MECHANICAL:
Whitney Engineering
10 Danforth Place
Portland, ME 04102
207-833-2921

ELECTRICAL:
Bennett Engineering
7 Barnwell Road
Froesport, ME 04032
207-865-0475

REV#	DATE	DESCRIPTION
-	-	-
-	-	-
-	-	-
-	-	-

DATE: 01/29/04

PROJECT No. 0114

DRAWN BY: AWH

CHECKED BY: RPW

SCALE: AS NOTED

SHEET TITLE:

1ST FLOOR PLAN

BUILDING B

HVAC1.1

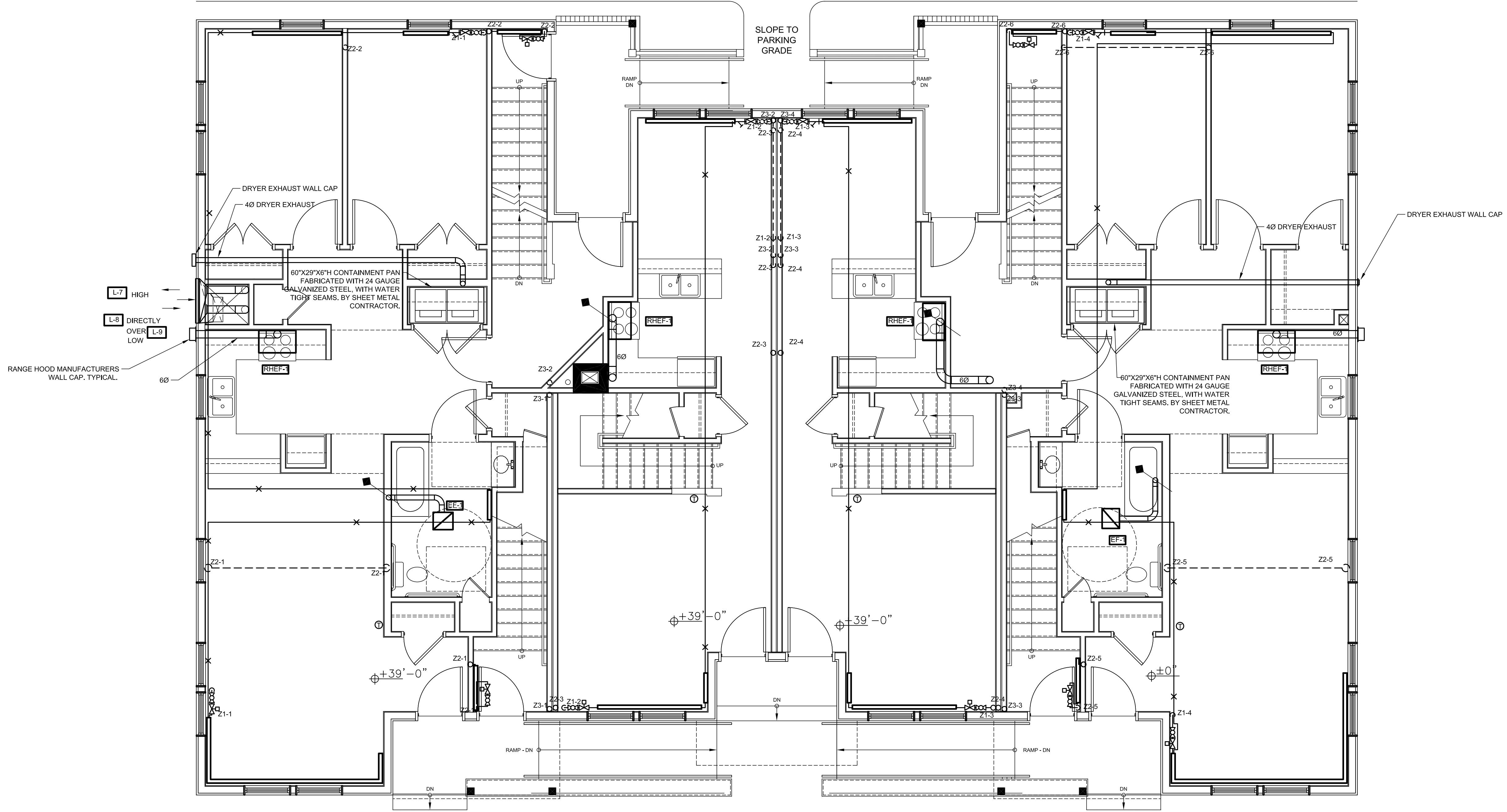

1 1ST FLOOR PLAN BUILDING B - HVAC
1/4" = 1'-0"

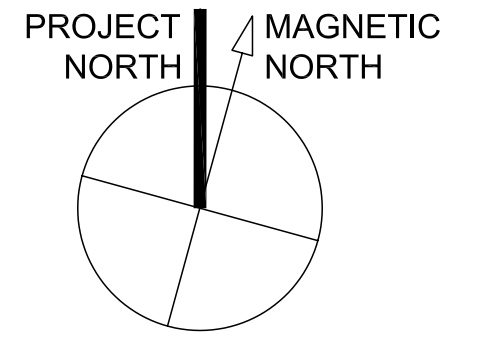
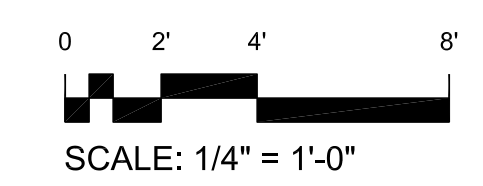

T:\00_TFH Projects\PROP0114_Melan Grant\Rev\Revised\Whitney\021004.mxd (02/04/04) 1:10 PM