

**1 DECK @ REAR ENTRY**  
1 1/2" = 1'-0"

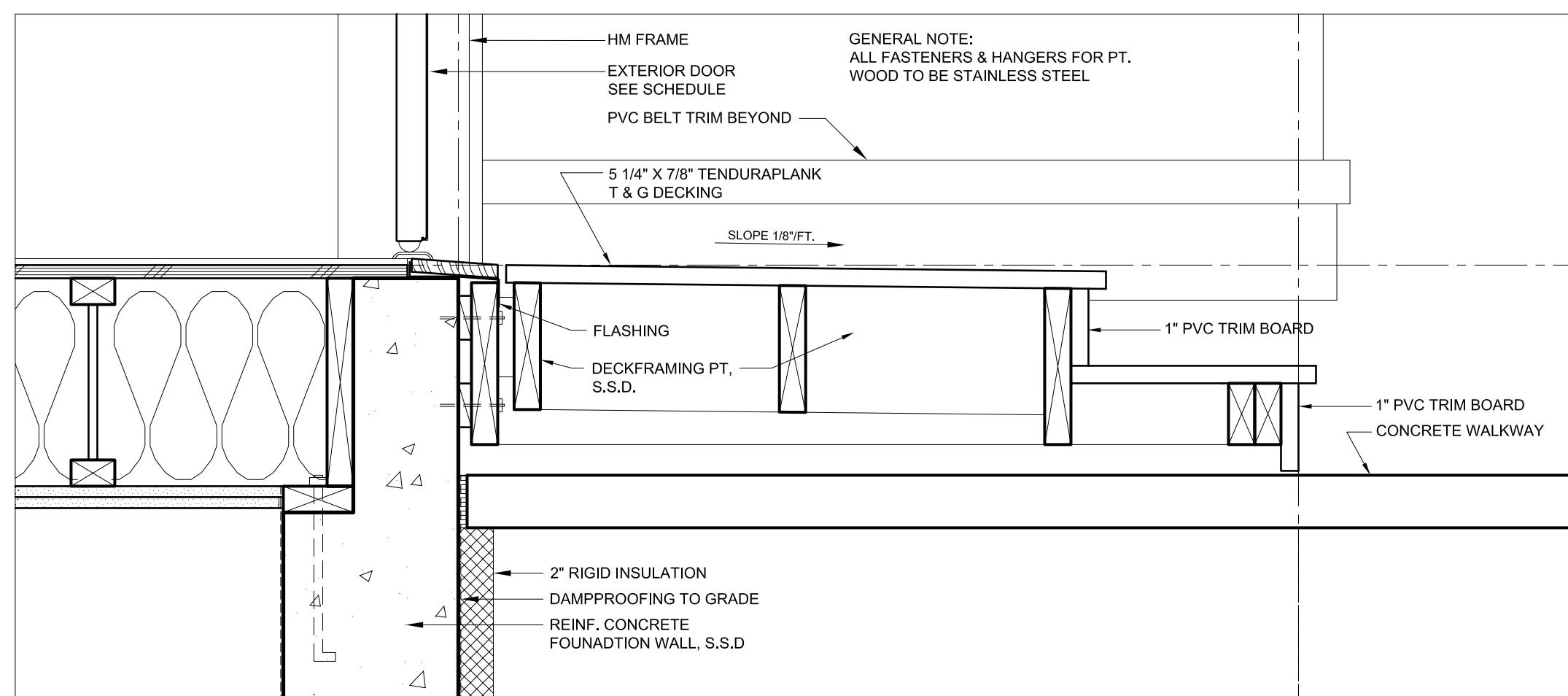

**2 DECK @ TOWNHOUSE ENTRY**  
1 1/2" = 1'-0"

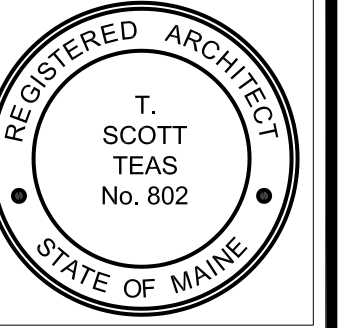

TFH ARCHITECTS



GRANT & MILLEN SREET  
PARKSIDE NEIGHBORHOOD CENTER & AFFORDABLE HOUSING  
PEOPLE'S REGIONAL OPPORTUNITY PROGRAM  
PORTLAND, MAINE

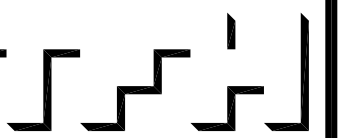

TFH ARCHITECTS  
100 COMMERCIAL STREET  
PORTLAND MAINE 04101  
TELEPHONE 207 775 6141  
ARCHITECTURE PLANNING

CONSULTANTS:

**CIVIL:**  
Prathan & Greer  
170 US Route One  
Farmton, ME 04105  
207-781-0242

**STRUCTURAL:**  
Structural Design Consulting  
Five Biskum Lane  
Farmton, ME 04105-2448  
207-781-0030

**MECHANICAL:**  
Whitney Engineering  
10 Danforth Place  
Portland, ME 04102  
207-833-2921

**ELECTRICAL:**  
Bennett Engineering  
7 Barwell Road  
Freeport, ME 04032  
207-865-0475

REVISIONS:

DATE: 01/29/04

PROJECT No. 0114

DRAWN BY: DAM/SA

CHECKED BY: TST

SCALE: AS NOTED

SHEET TITLE:

WALL SECTIONS

BUILDING B

A5.1