

TFH ARCHITECTS

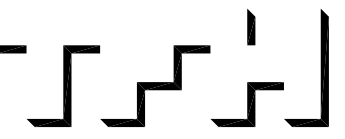

GRANT & MELLEEN SREET
PARKSIDE NEIGHBORHOOD CENTER & AFFORDABLE HOUSING
PEOPLE'S REGIONAL OPPORTUNITY PROGRAM
PORTLAND, MAINE



TFH ARCHITECTS
100 COMMERCIAL STREET
PORTLAND MAINE 04101
TELEPHONE 207 775 6141
ARCHITECTURE PLANNING

CONSULTANTS:
CIVIL:
Pridham & Greer
170 US Route One
Farmington, ME 04105
207-781-6242
STRUCTURAL:
Structural Design Consulting
Five Biskum Lane
Farmington, ME 04105-2448
207-878-8030
MECHANICAL:
Whitney Engineering
10 Danforth Place
Portland, ME 04102
207-833-2921
ELECTRICAL:
Bennett Engineering
7 Bennett Road
Freeport, ME 04032
207-865-0475

REVISIONS:
DATE: 01/29/04
PROJECT No. 0114
DRAWN BY: DAM/SA
CHECKED BY: TST
SCALE: AS NOTED

SHEET TITLE:
ROOF PLAN

BUILDING B
A1.4

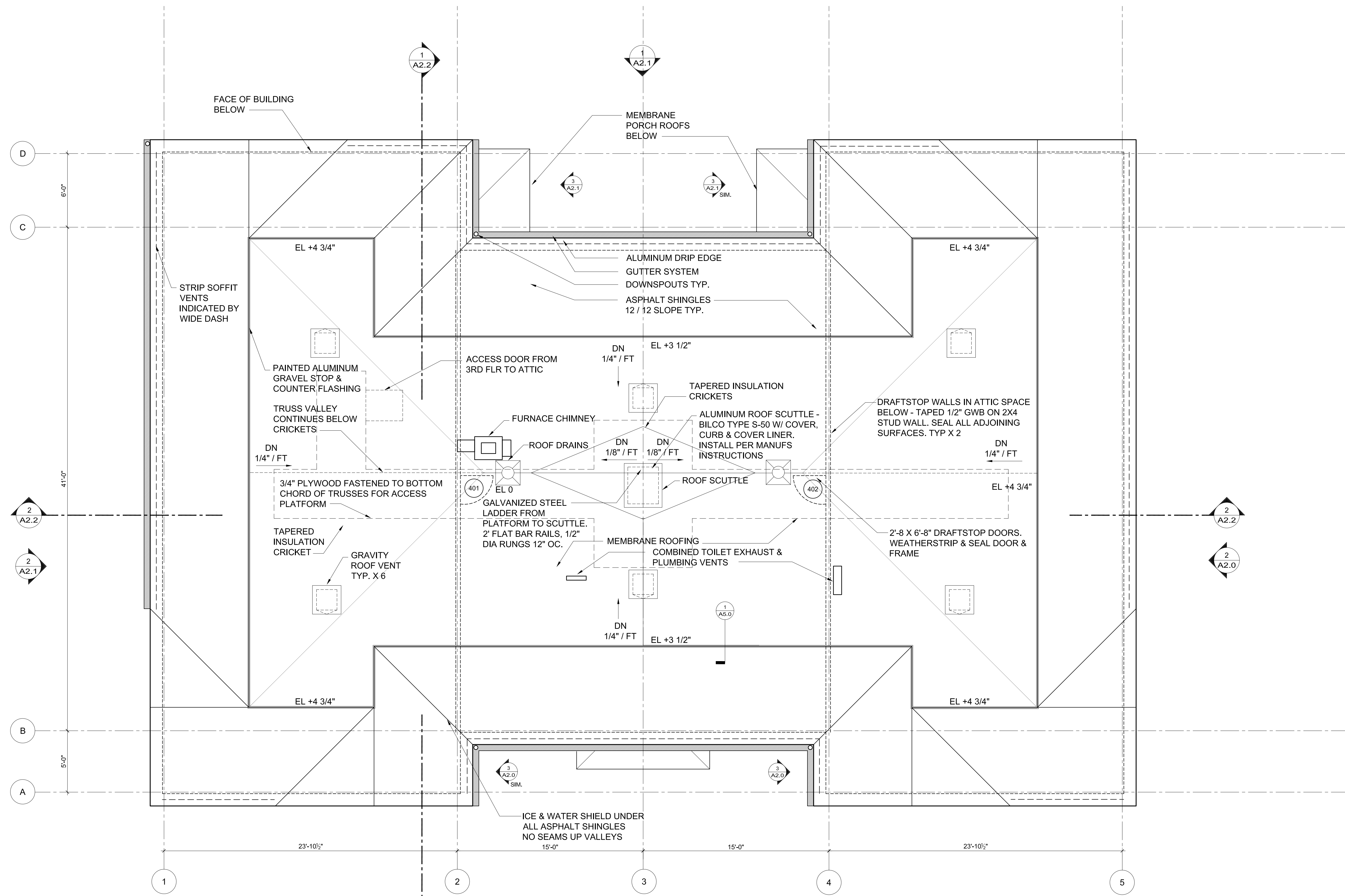

NOTE: ELEVATIONS ARE APPROXIMATE ABOVE ROOF DRAINS

ATTIC VENTILATION:
ROOF AREA = 3701 SF/150 = 24.6 SF REQUIRED
194 LF OF SOFFIT VENTS @ 9 CUBIC IN./LIN. FT 194'0" x 9" = 145.6 SF
6 GABLE VENTS @ 100 CU IN. EA. 600 SQ. IN. = 4.1 SF
6 ROOFTOP VENTS @ 2.25 SF EA 13.5 SF
TOTAL PROVIDED 163.2 SF

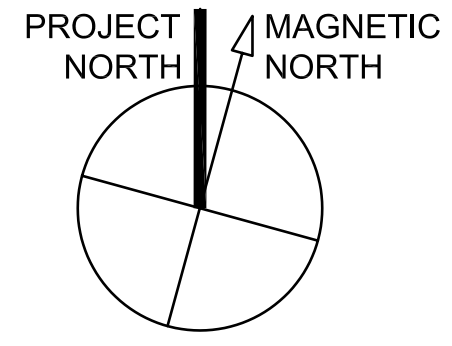
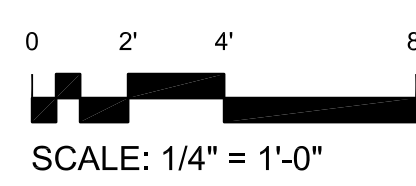

1 ROOF PLAN BUILDING B
1/4" = 1'-0"

T:\00_TFH\Projects\PROP0114_Mellen Grant\Drawings\Plan\0114_A1.4_Roof_Bldg.dwg, 2/26/2004, 6:22:47 PM