

TFH ARCHITECTS

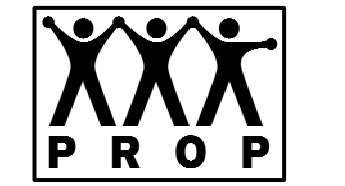

GRANT & MIELLEN SREET
PARKSIDE NEIGHBORHOOD CENTER & AFFORDABLE HOUSING
PEOPLE'S REGIONAL OPPORTUNITY PROGRAM
PORTLAND, MAINE

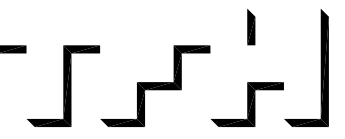

TFH ARCHITECTS
100 COMMERCIAL STREET
PORTLAND MAINE 04101
TELEPHONE 207 775 6141
ARCHITECTURE PLANNING

CONSULTANTS:

CIVIL:
Pridham & Greer
170 US Route One
Farmington, ME 04105
207-781-0242

STRUCTURAL:
Structural Design Consulting
Pine Bluffs Lane
Farmington, ME 04105-2448
207-578-0030

MECHANICAL:
Whitney Engineering
10 Danforth Place
Portland, ME 04102
207-833-2911

ELECTRICAL:
Bennett Engineering
7 Bennett Road
Freeport, ME 04032
207-865-0475

REVISIONS:

DATE: 01/29/04
PROJECT No. 0114
DRAWN BY: DAM/SA
CHECKED BY: TST
SCALE: AS NOTED

SHEET TITLE:

ROOF PLAN

BUILDING A

A1.4

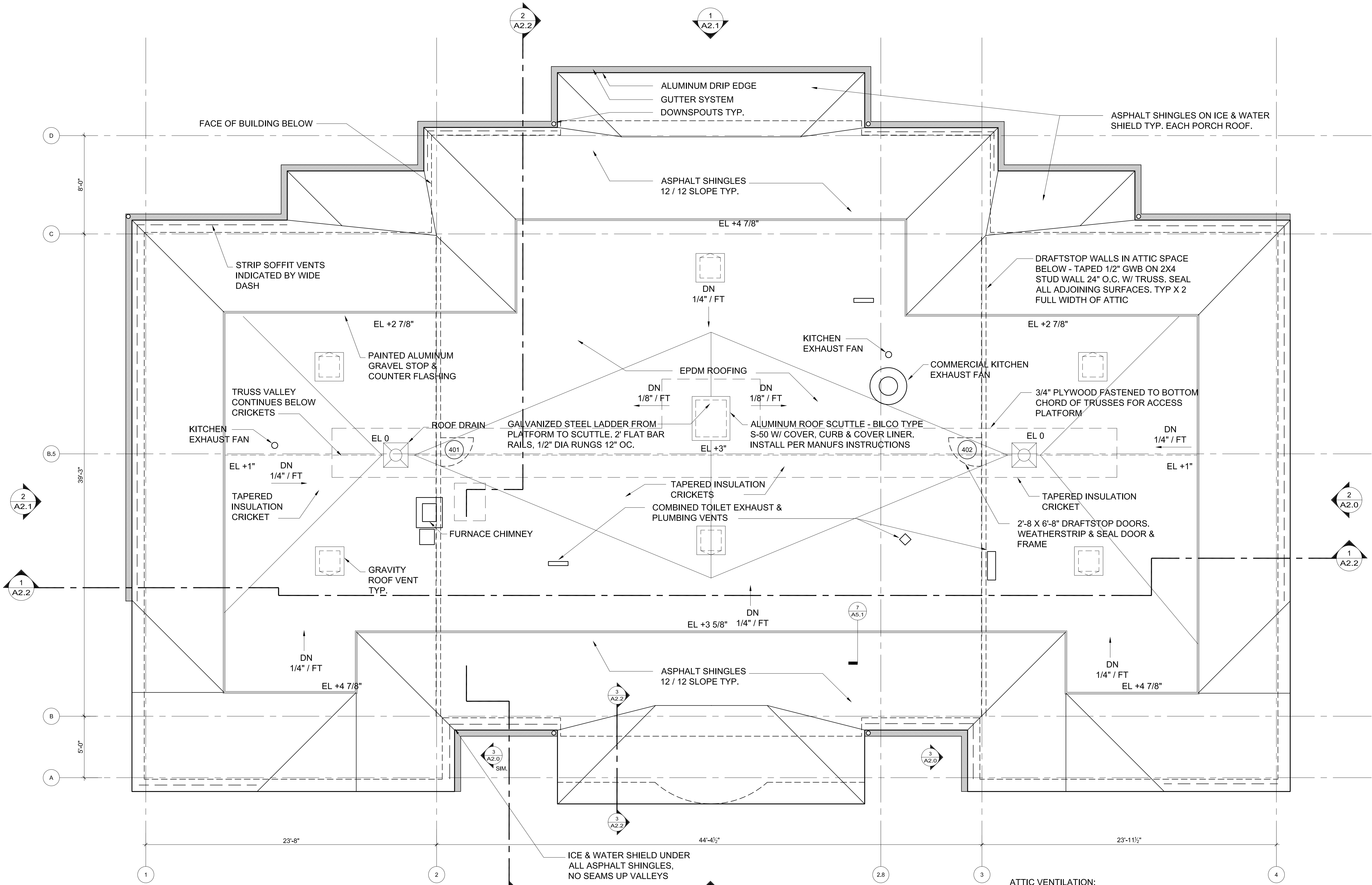

NOTE: ELEVATIONS ARE APPROXIMATE ABOVE ROOF DRAINS

ATTIC VENTILATION:
ROOF AREA = 4865 SF/150 = 32.5 SF REQUIRED
158 LF OF SOFFIT VENTS @ 9 CUBIC IN./LIN. FT
4 GABLE VENTS @ 100 CU IN. EA. 158'-6" x 9" = 118.5 SF
13.5 SF
6 ROOFTOP VENTS @ 2.25 SF EA
134.7 SF
TOTAL PROVIDED

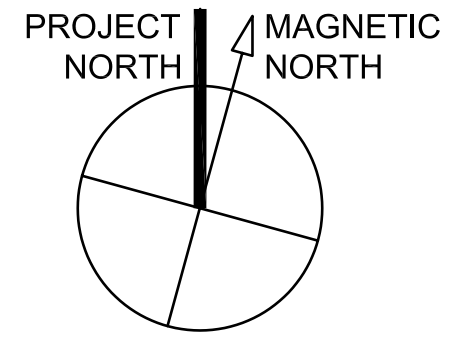
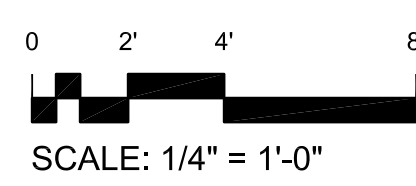

1 ROOF PLAN BUILDING A
1/4" = 1'-0"

T:\00_TFH\Projects\PROP0114_Mellen Grant\Drawings\Plan0114_A1_Roof_Bldg.dwg, 2/26/2004, 6:02:13 PM