

T:\001\_TFH\Projects\PROP0101\_Mellie Grant\Drawings\FloorPlan\A1.0\_Bldg A.DWG, 2408 FLOOR PLAN, 2/26/2004, 3:35:54 PM

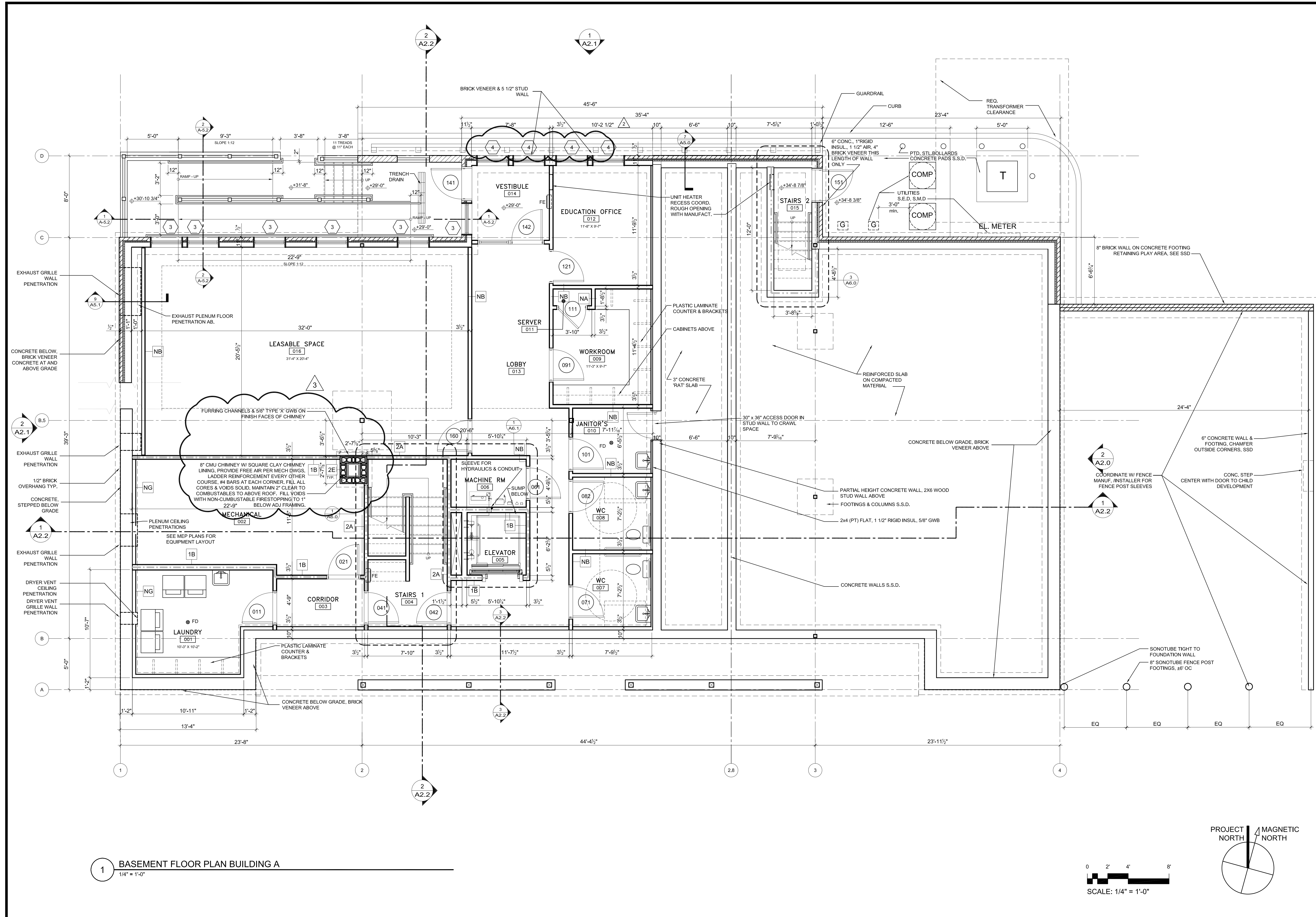

**1** BASEMENT FLOOR PLAN BUILDING A  
1/4" = 1'-0"

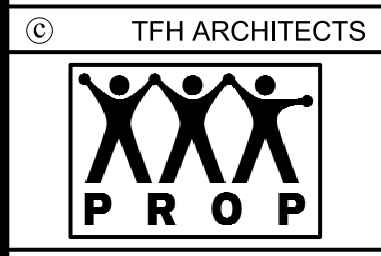
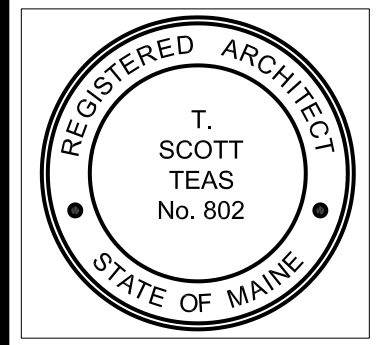
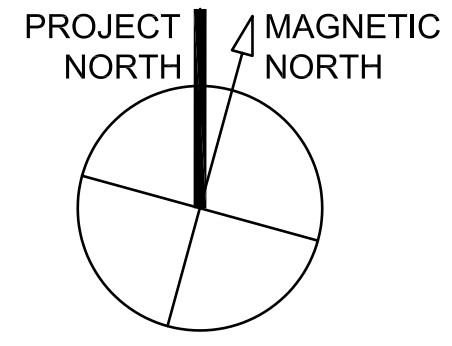
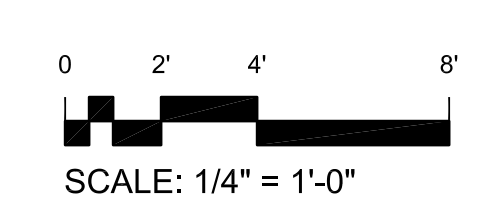

**GRANT & MELLEEN SREET**  
**PARKSIDE NEIGHBORHOOD CENTER & AFFORDABLE HOUSING**  
**PEOPLE'S REGIONAL OPPORTUNITY PROGRAM**  
**PORTLAND, MAINE**

**TFH ARCHITECTS**  
 100 COMMERCIAL STREET  
 PORTLAND MAINE 04101  
 TELEPHONE 207 775 6141  
 ARCHITECTURE PLANNING

**CONSULTANTS:**  
**CIVIL:** Prichard & Greer  
 170 US Route One  
 Farmington, ME 04105  
 207-781-6242  
**STRUCTURAL:** Structural Design Consulting  
 Five Baskin Lane  
 Farmington, ME 04105-2448  
 207-878-8030  
**MECHANICAL:** Whitney Engineering  
 10 Danforth Place  
 Portland, ME 04102  
 207-833-2991  
**ELECTRICAL:** Bennett Engineering  
 7 Bennett Road  
 Freeport, ME 04032  
 207-865-9475

**REVISIONS:**

**DATE:** 01/29/04  
**PROJECT No.:** 0114  
**DRAWN BY:** DAM/SA  
**CHECKED BY:** TST  
**SCALE:** AS NOTED

**SHEET TITLE:**  
 BASEMENT FLOOR PLAN

**BUILDING A**  
**A1.0**