



GRANT & MELLEN SREET
 PARKSIDE NEIGHBORHOOD CENTER & AFFORDABLE HOUSING
 PEOPLE'S REGIONAL OPPORTUNITY PROGRAM
 PORTLAND, MAINE

TFH ARCHITECTS
 100 COMMERCIAL STREET
 PORTLAND MAINE 04101
 TELEPHONE 207 775 6141
 ARCHITECTURE PLANNING

CONSULTANTS:
CIVIL
 Pritchard & Geier
 170 US Route One
 Falmouth, ME 04105
 207-781-5242
STRUCTURAL
 Structural Design Consulting
 Five Balsam Lane
 Falmouth, ME 04105-0448
 207-478-6038
MECHANICAL
 Whitney Engineering
 15 Davenport Place
 Portland, ME 04102
 207-633-2921
ELECTRICAL
 Bennett Engineering
 7 Bennett Road
 Freeport, ME 04032
 207-855-6475

REVISIONS:
 5 GENERAL REVISIONS - 5/30/4

DATE: 01/29/04
 PROJECT No. 0114
 DRAWN BY: DAMISA
 CHECKED BY: TST
 SCALE: AS NOTED

SHEET TITLE:
 ROOF PLAN

BUILDING A

A1.4

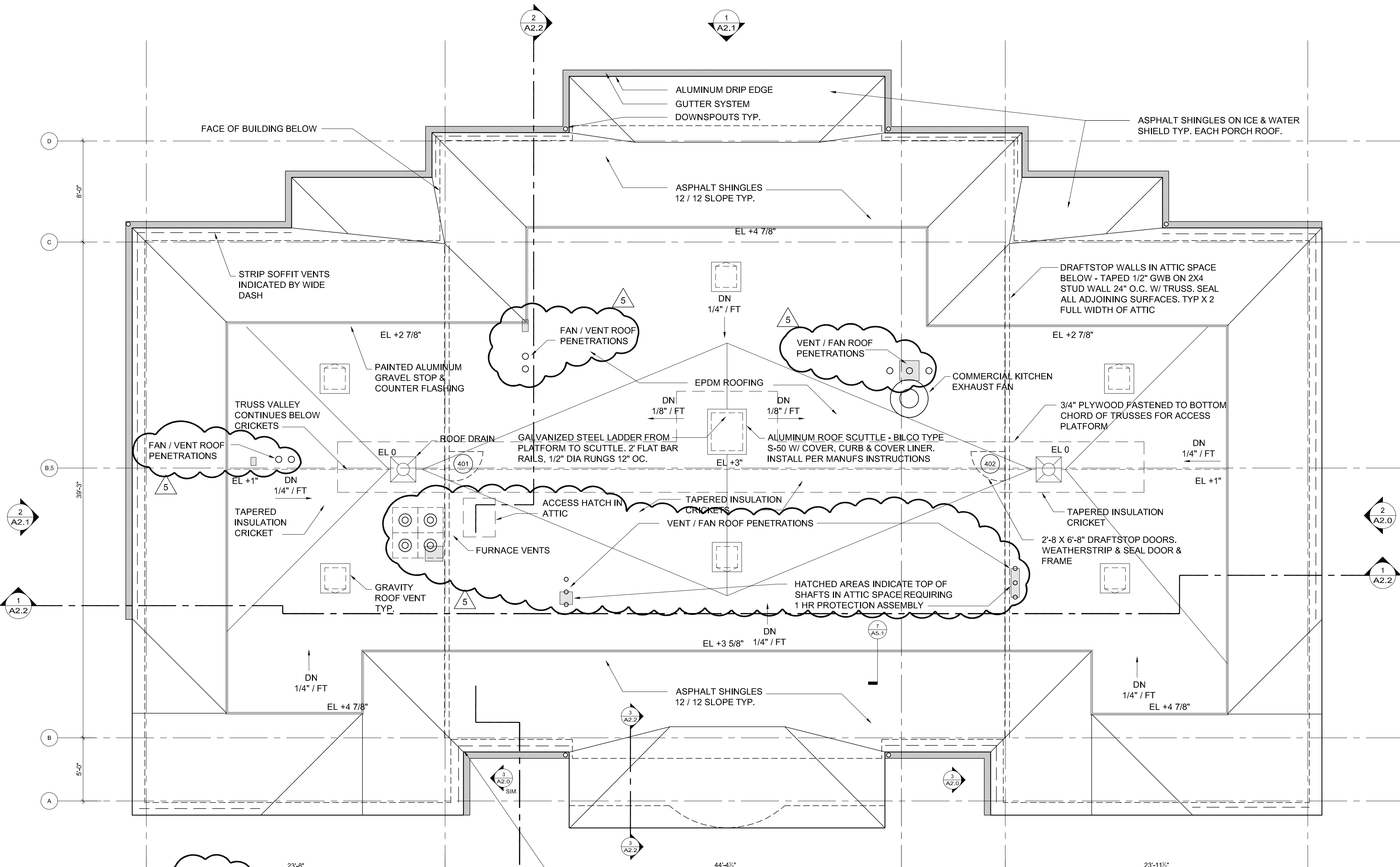

GENERAL NOTE:
 WHERE VENT OF EXHAUST PIPING PENETRATE THE ATTIC BELOW OR W/ 3' OF SLOPED ASPHALT ROOFS, SLOPE VENT PIPING AWAY FROM ROOF EDGES IN ORDER TO DECREASE VISIBILITY FROM ADJACENT BUILDINGS. LOCATIONS AND QUANTITIES OF ROOF PENETRATIONS ARE SHOWN SCHEMATICALLY. COORDINATE ALL REQUIRED ROOF PENETRATIONS WITH MEP DRAWINGS

HATCHED AREAS INDICATE TOP OF SHAFTS IN ATTIC SPACE REQUIRING 1 HR PROTECTION ASSEMBLY

ATTIC VENTILATION:
 ROOF AREA = 4865 SF / 150 = 32.5 SF REQUIRED
 158 LF OF SOFFIT VENTS @ 9 CUBIC IN./LIN. FT 158'-6" x 9" = 118.5 SF
 4 GABLE VENTS @ 100 CU IN EA. 400 SQ IN. = 2.7 SF
 6 ROOFTOP VENTS @ 2.25 SF EA 13.5 SF
 TOTAL PROVIDED 134.7 SF

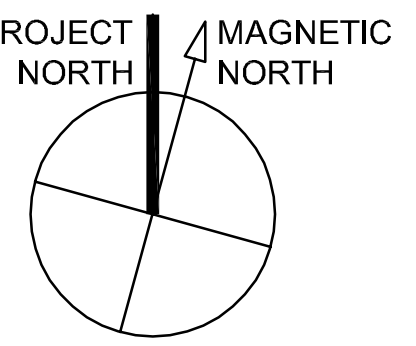
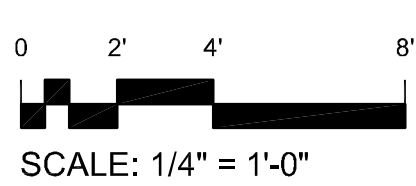

1 ROOF PLAN BUILDING A
 1/4" = 1'-0"

T:\00_TFH\Projects\PR0101\4_Mellen Grant\Drawings\Plan01\A1.4_Roof_Bldg.dwg, 2/4/08 RCOF PLAN, 5/27/2004 12:08:16 PM