

**-IMPORTANT NOTE-**  
 THIS DOCUMENT HAS BEEN PREPARED AS AN INSTRUMENT OF THE PROFESSIONAL SERVICE, AND IS NOT AN ARCHITECTURAL PLAN. IDEAS/DESIGNS INCLUDED HEREIN ARE THE SOLE PROPERTY OF HENRY SCHEIN DENTAL, AND ARE PROTECTED UNDER COPYRIGHT. THEY MAY NOT BE USED OR REPRODUCED WITHOUT EXPRESSED WRITTEN CONSENT OF HENRY SCHEIN AND FULL PAYMENT OF ANY ASSOCIATED DESIGN FEES.  
**ALL DIMENSIONS ARE SUBJECT TO JOB-SITE VERIFICATION.**

**DRAWING NAME:** COMMUNITY DENTAL PORTLAND-1A-F  
**PROJECT START DATE:** 07/20/2015  
**FINALS START DATE:** 01/22/2016  
**DRAWN BY:** ARCH  
**FINALS BY:** AKL  
**CHECKED BY:** GMC

REVISIONS:	
02/10/16	AKL
02/16/16	AKL
04/07/16	AKL
---	---
---	---
---	---
---	---
INT.SQ.FT. = PER ARCH	

**SCALE:** 3/16"=1'-0" **SHT. SIZE:** D

**FLOOR PLAN**

**SA.O**

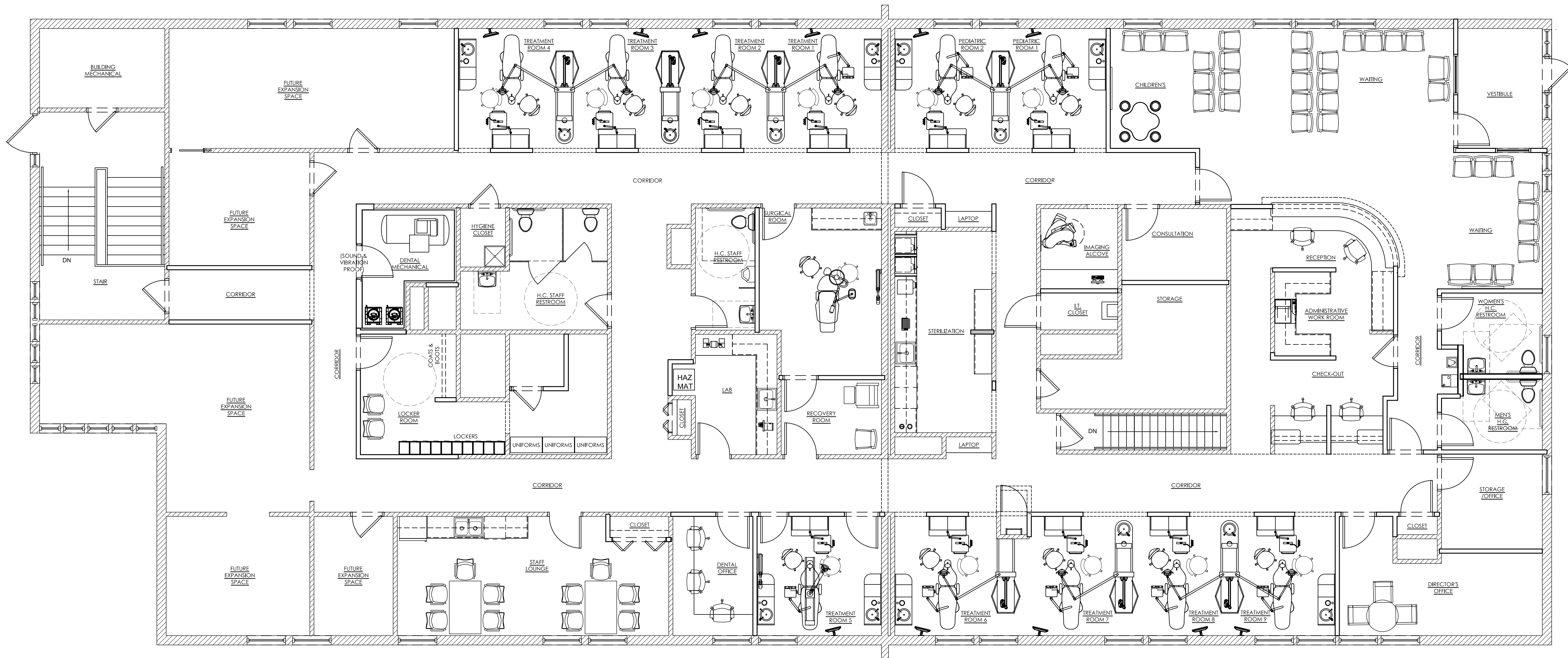

THIS PLAN IS FOR THE SOLE PURPOSE OF SPECIFICATION AND INSTALLATION OF THE DENTAL EQUIPMENT SUPPLIED BY HENRY SCHEIN DENTAL. EXISTING CONDITIONS MAY NOT MEET LOCAL BUILDING AND ACCESSIBILITY CODES. IT IS THE ARCHITECT/ CONTRACTOR'S RESPONSIBILITY TO VERIFY THAT ALL CODE RESTRICTIONS AND CLEARANCES ARE MET.

**PROPOSED DENTAL FLOOR PLAN**

3/16"=1'-0"