

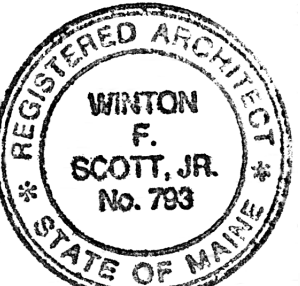

Winton Scott Architects  
5 Milk Street  
Portland, Maine 04101  
207 774 4811  
www.wintonsscott.com

Architecture / Planning  
Preservation Architecture  
Interior Architecture



*Winton Scott*

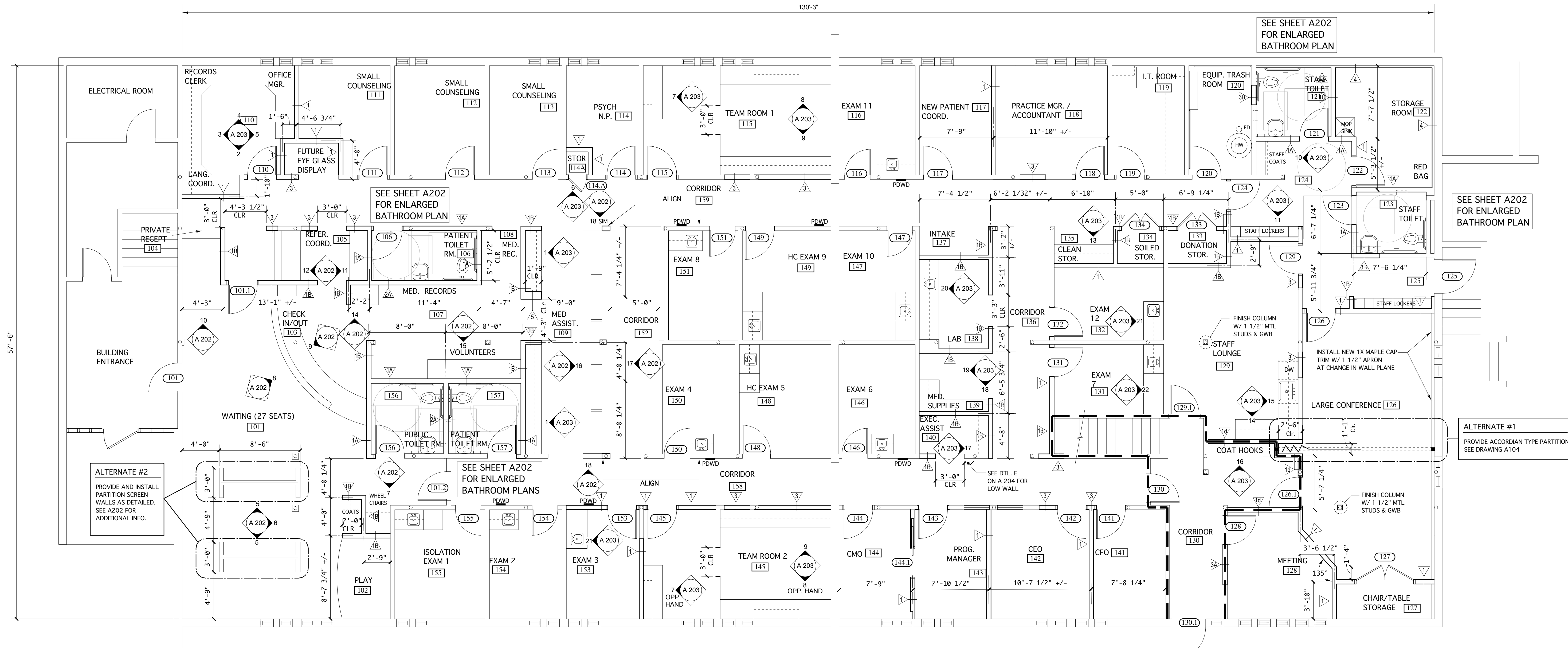

# FLOOR PLAN

3/16"=1'-0"

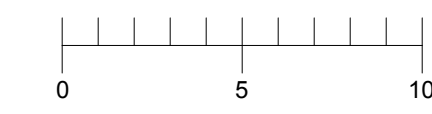

## LEGEND

- PDWD** PULL-DOWN WALL DESK. PROVIDED BY OWNER INSTALLED BY CONTRACTOR
- 141** DOOR NUMBER - SEE DOOR SCHEDULE
- 3A** PARTITION TYPE - SEE PARTITION TYPE SCHEDULE
- A 203 15** MILLWORK ELEVATION - SEE REFERENCED SHEET NUMBER
- 14** MILLWORK ELEVATION - SEE REFERENCED SHEET NUMBER

Portland  
Community  
Health Center

180 Park Avenue  
Portland, Maine

CONSTRUCTION DOCUMENTS  
August 31, 2012

Layout Plan

Scale: As Noted