

project name

Butler Payson
pine st.
state st.
portland, me.

avesta housing

goduti/thomas architects

portland, maine 04101

ph. 207-775-3184

fax 207-774-0846

NO.	SIZE	R.O.		THICK.	TYPE see A6.3	MATERIAL	FINISH	LABEL	THRESHOLD	HAND	HARDWARE see specs	DETAILS	FRAME			REMARKS	
		W.	H.										MATERIAL	FINISH	THROAT		
ext. ADA entry	101	3068	see door elevation		1 3/4	A	t.b. alum/temp. insul glass	powder coat		t.b. alum. low slope	right outswing	HW 1	Sheet A3.1	t.b. alum.	p.c.		Kauner Encore 3 3 1/4" front glaze system
int. ADA entry	102	3068	see door elevation		1 3/4	B	t.b. alum/temp. insul glass	powder coat		t.b. alum. low slope	left	HW 2	Sheet A3.1	t.b. alum.	p.c.		
laundry	103	3068	3'-1 1/2 x 6'-9"		1 3/4	C	60 min steel	paint	60 min		left	HW 3		60 min h.m.	paint		
2 hr stair entry	104																
exist mainten	105	3068	3'-1 1/2 x 6'-9"		1 3/4	D	90 min h.m.	paint	90 min		left	HW 3		90 min h.m.	paint		
exist elev mach	106																
low hdm	107																
boiler	108																
crawl space access	109	3068	3'-1 1/2 x 6'-9"		1 3/4	E	90 min h.m.	paint	90 min		right	HW 4		90 min h.m.	paint		
carnage house	110	3030	3'-1 1/2 x 3'-1 1/2"		1 3/4	F	90 min h.m.	paint	90 min		left	HW 3		90 min h.m.	paint		
original entry	III	3068	3'-1 1/2 x 6'-9"		1 3/4	G	insulated	paint			t.b. alum. low slope	right	HW 5	thermal break	paint		
	201				1 3/4	H	wood	paint			t.b. alum. low slope	right	HW 6				

interior signage

locations	type
elevator lobby door	A
apartment entries door	A
tenant storage doors	A
recycle door	A
laundry storage	A
all stair exit out doors	B
bant stair out doors	B
office door	A
grand dining room	A
activity room	A
access. bthrms	B
mechanical door	C
elevator machine door	C
janitors closets, etc.	C
main entry door # 101	international symbol of accessibility no smoking: similar type A

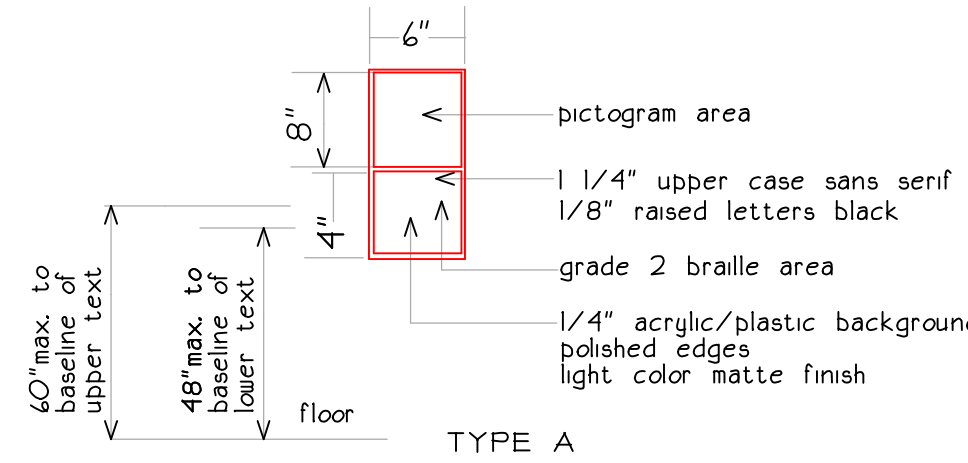

TYPE A

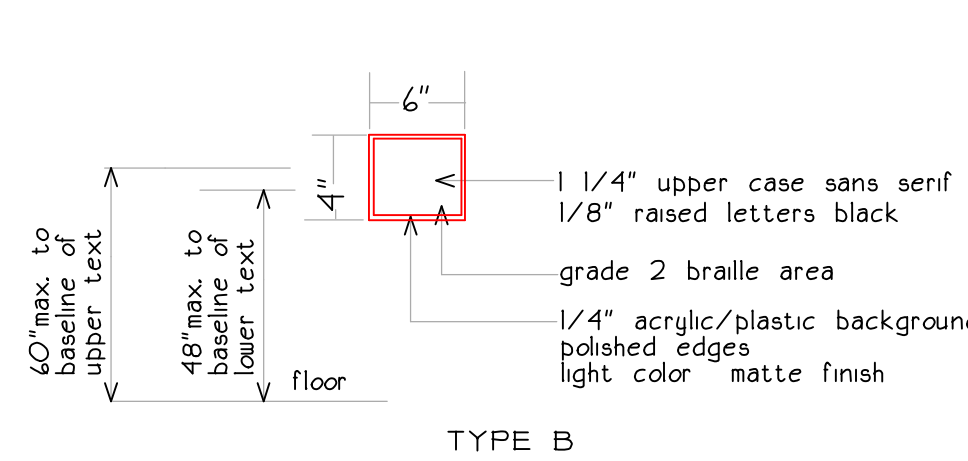

TYPE B

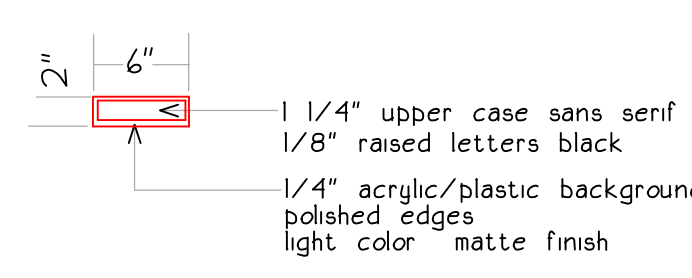

TYPE C

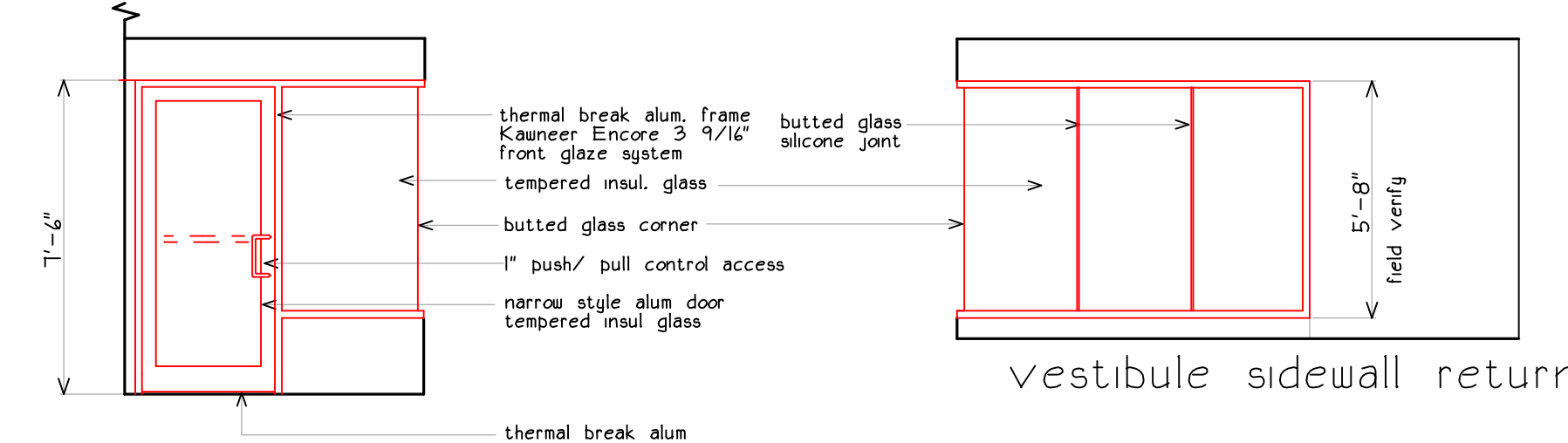

A ext. ADA entry

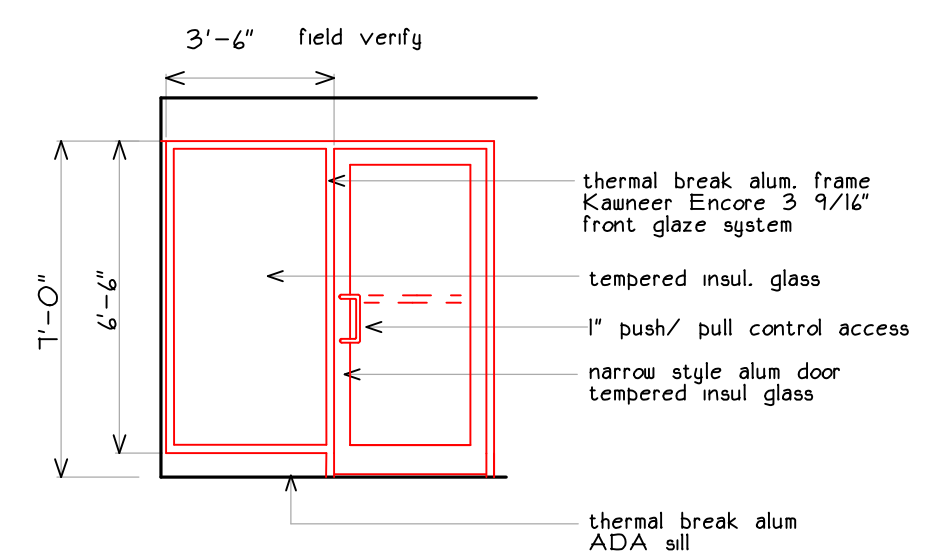

B int. ADA entry

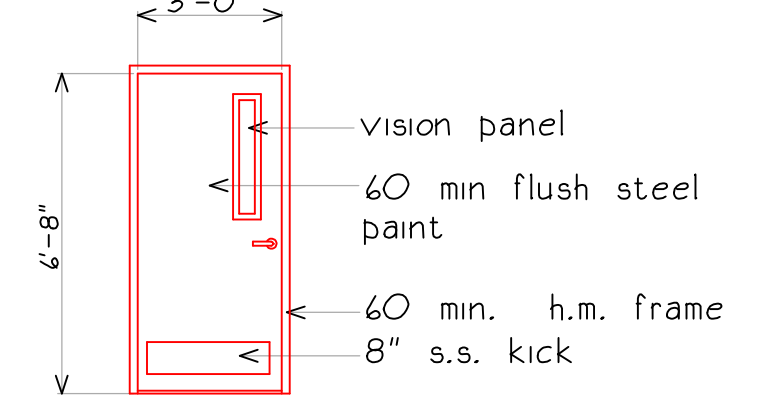

C laundry

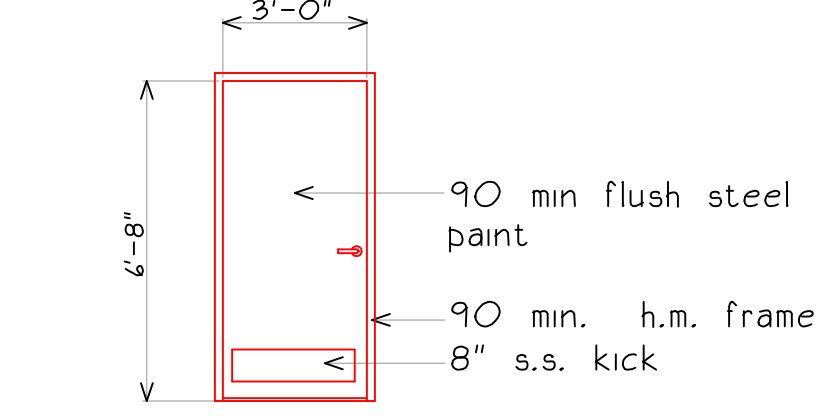

D stair

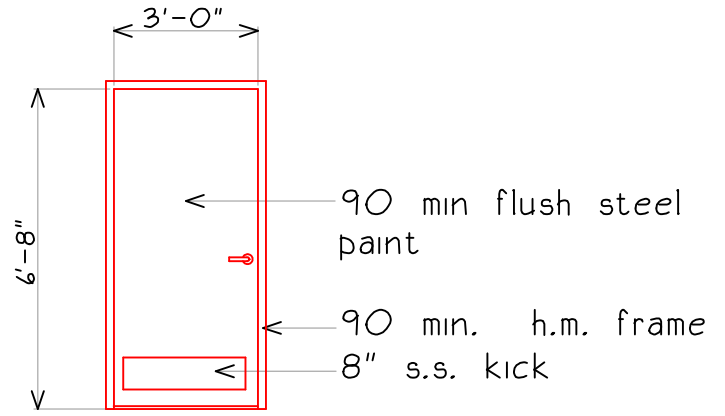

E boiler

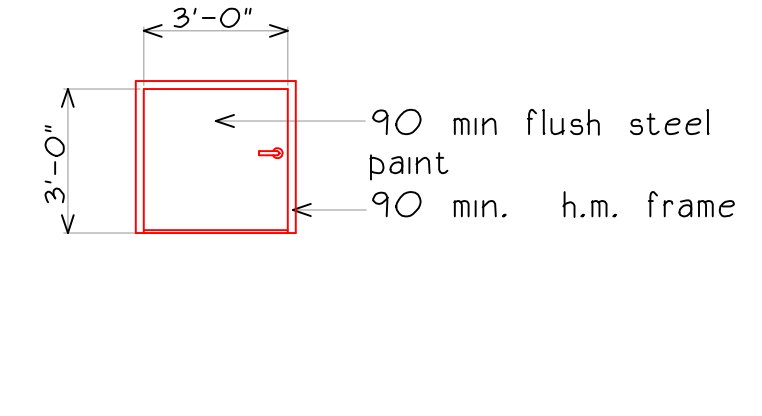

F crawl space

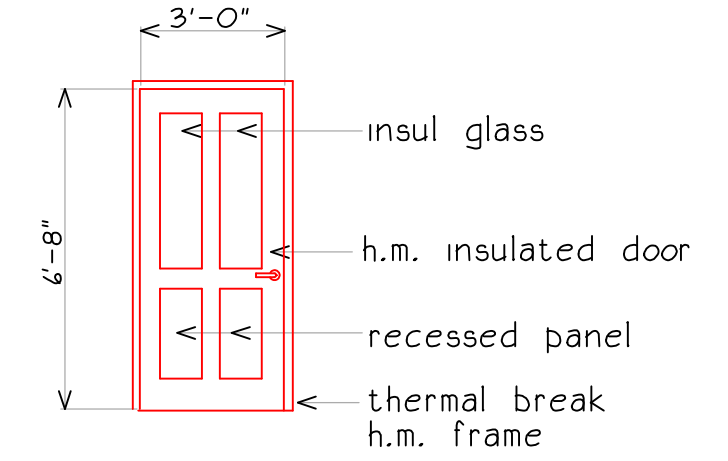

G ext. carriage

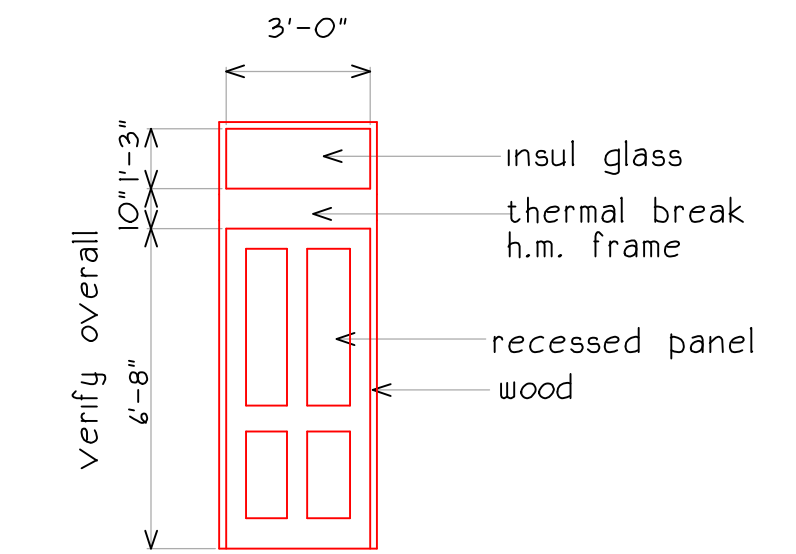

H deering st. entry door

sch. #1: exterior vestibule door: alum powdercoated storefront, passage door
 PUSH/PULL: 1" ROD, HORIZONTAL PUSH, VERTICAL PULL, USIO
 CLOSER: POWER ASSIST PTD.
 HINGES: BY DOOR MANUF. PTD.
 THRESHOLD: ADA THERM. BREAK BY DOOR MANUF.
 DOOR STOP: EXTERIOR CONCRETE FLOOR USIO
 WEATHERSTRIPPING: WITH DOOR MANUF.

sch. #2: interior vestibule: alum powdercoated storefront, control door
 LOCKSET: USIO
 CLOSER: POWER ASSIST PTD.
 HINGES: BY DOOR MANUF. PTD.
 THRESHOLD: ADA THERM. BREAK BY DOOR MANUF.
 WEATHERSTRIPPING: WITH DOOR MANUF.
 ELECTRIC STRIKE: FOB ACCESS SYSTEM

sch. #3: common areas passage set
 PASSAGE: SARGENT 10G04 LB USIO
 HINGES: (3) 4 1/2" BALL BEARING MCKINNEY TA2114 USIO
 CLOSER: USIO
 KICK PLATE: USIO
 DOORSTOP: FLOOR USIO

sch. #4: utility lockset, closet common areas
 LOCKSET SET: SARGENT 65U65 USIO
 HINGES: (3) 3 1/2" PIN USIO
 CLOSER: USIO
 KICK PLATE: USIO
 DOORSTOP: wood and concrete floors

sch. #5: carriage hose exterior
 LOCKSET SET: SARGENT 65U65 USIO
 HINGES: (3) 3 1/2" PIN USIO
 CLOSER: USIO
 DOORSTOP: wood and concrete floors

sch. #6: original deer entry
 LOCKSET SET: SARGENT 65U65 USIO
 HINGES: (3) 3 1/2" PIN USIO
 CLOSER: USIO
 DOORSTOP: wood and concrete floors

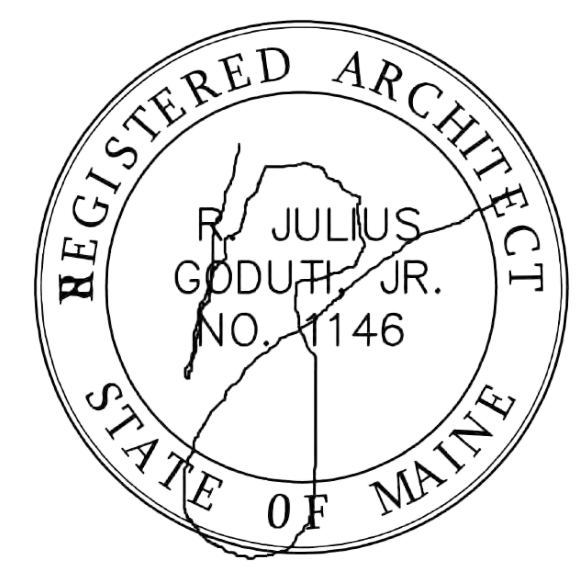

revisions

date
January 17th, 2015

sheet title

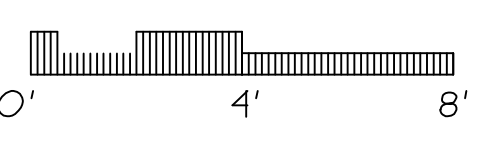

scale
1/4"=1'-0"

drawn by
RG

project number

butpag

sheet number

PA6.3