

project name

Butler Payson
pine st.
state st.
portland, maine

avesta housing

goduti/thomas architects

44 oak st.

portland, maine 04101

ph. 207-115-3184

fax 207-114-0846

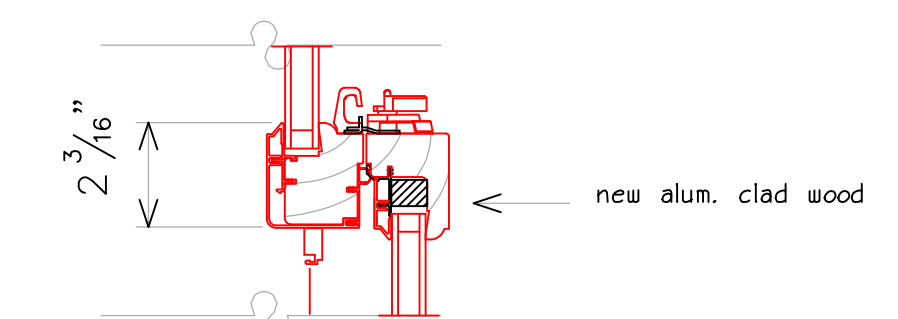
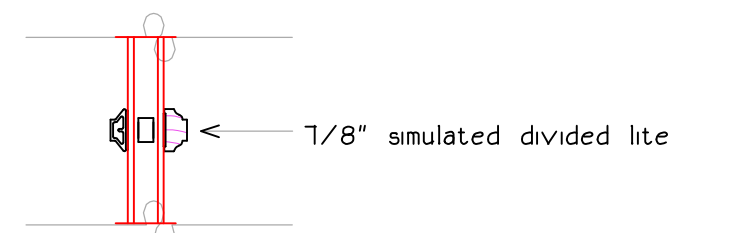

parting rail

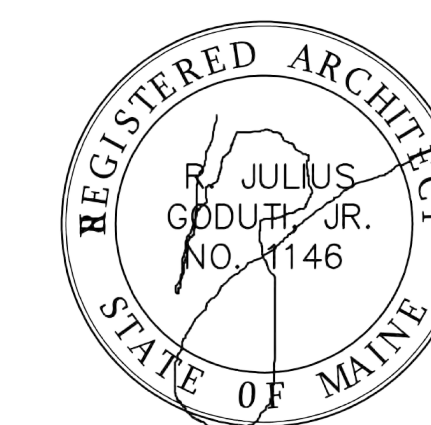

revisions

date

january 11th, 2015

sheet title

**marvin alum clad
double hung
details**

**payson original building
payson carriage building**

scale

3" = 1'-0"

drawn by

RG

project number

butler payson

sheet number

PA5.1

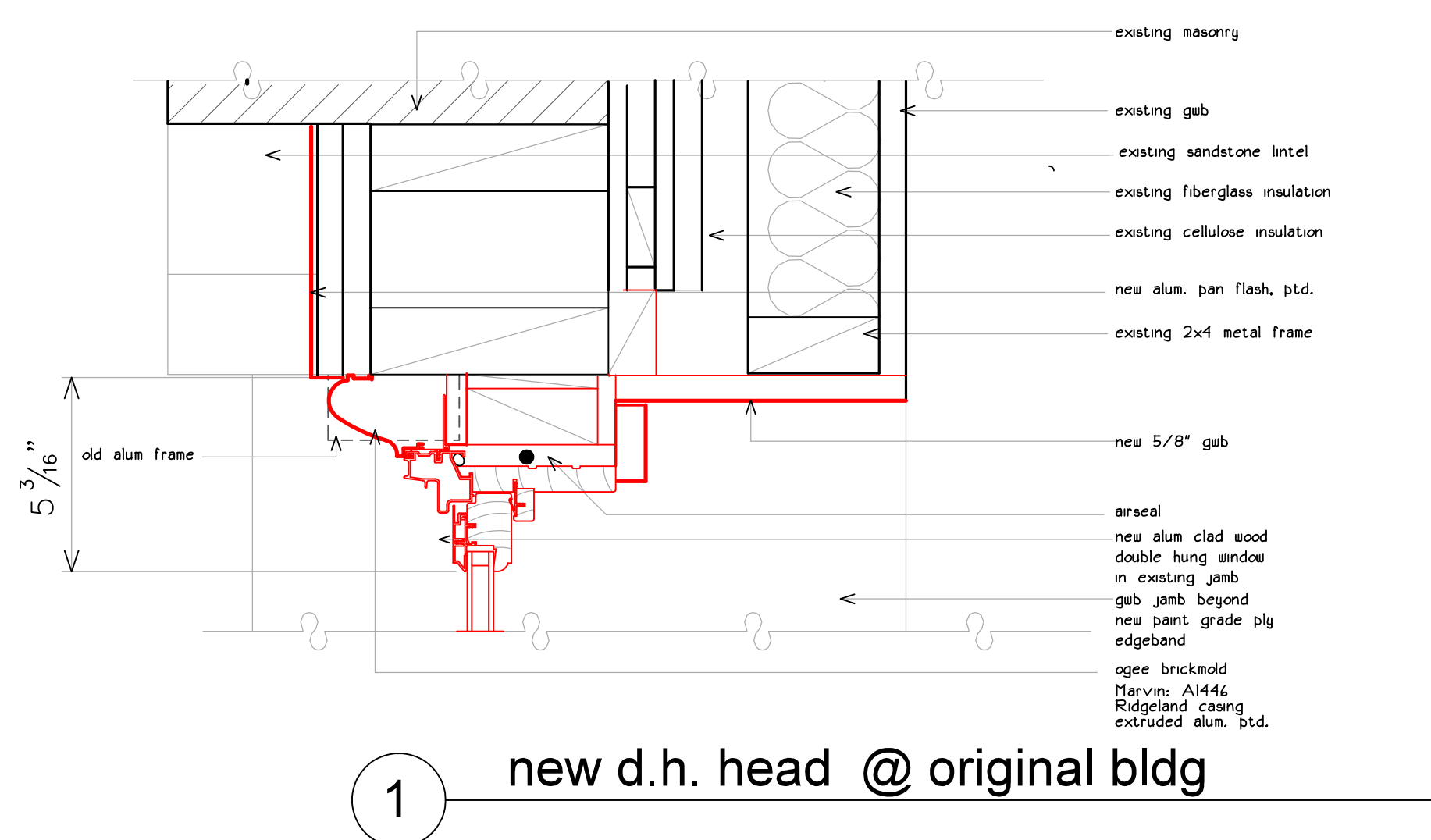

1 new d.h. head @ original bldg



2 new d.h. jamb @ original bldg

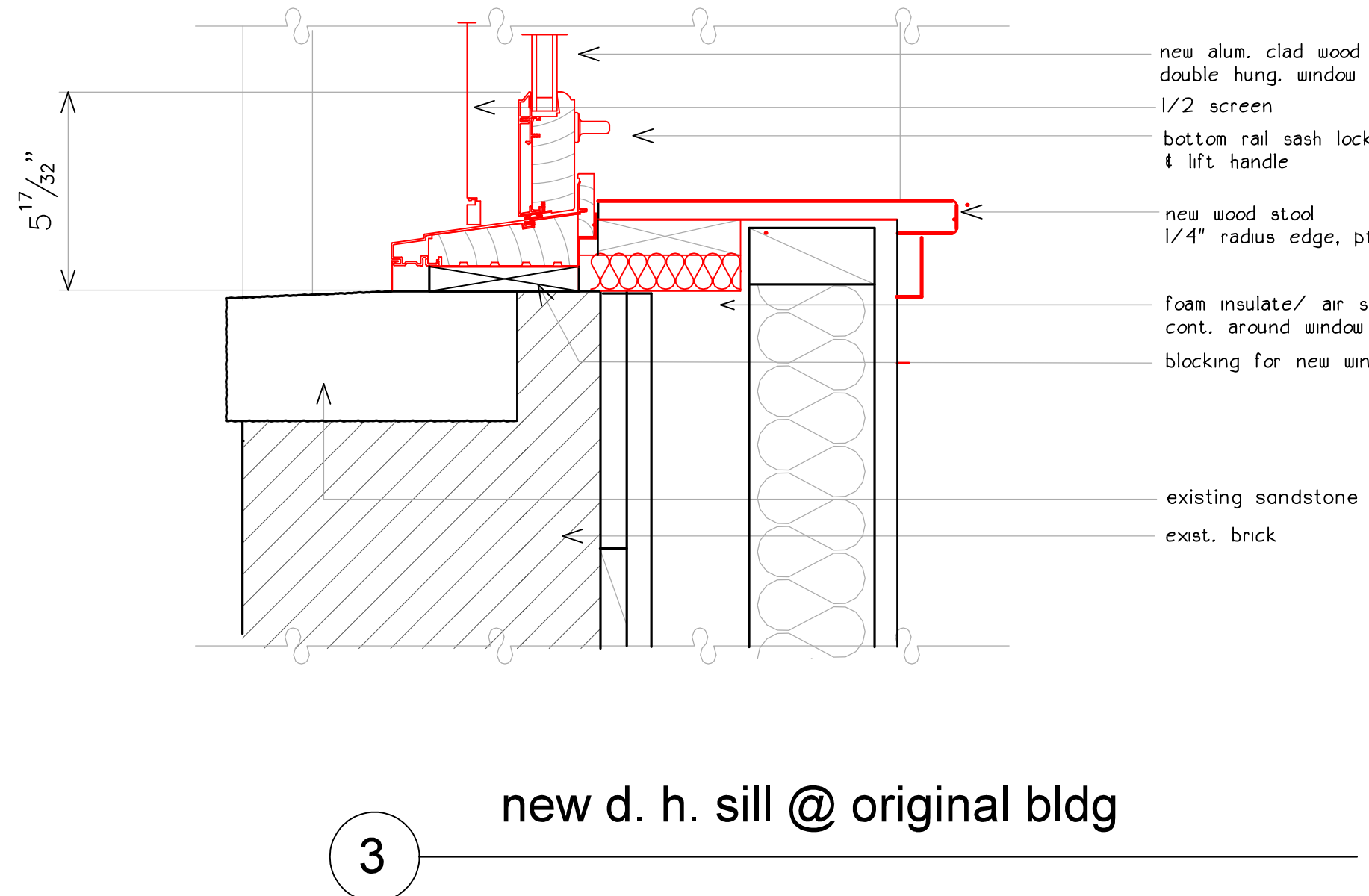

3 new d. h. sill @ original bldg

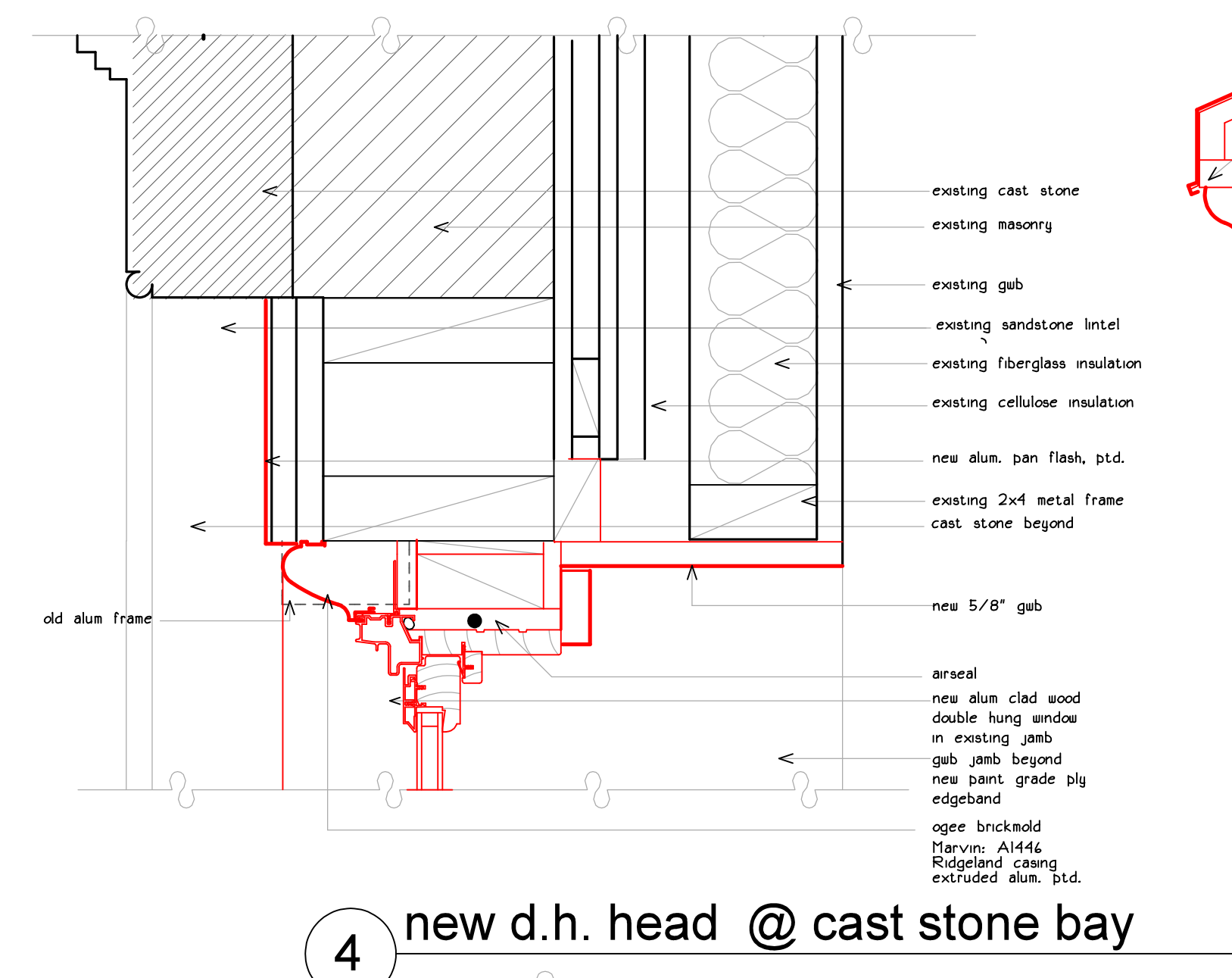

4 new d.h. head @ cast stone bay

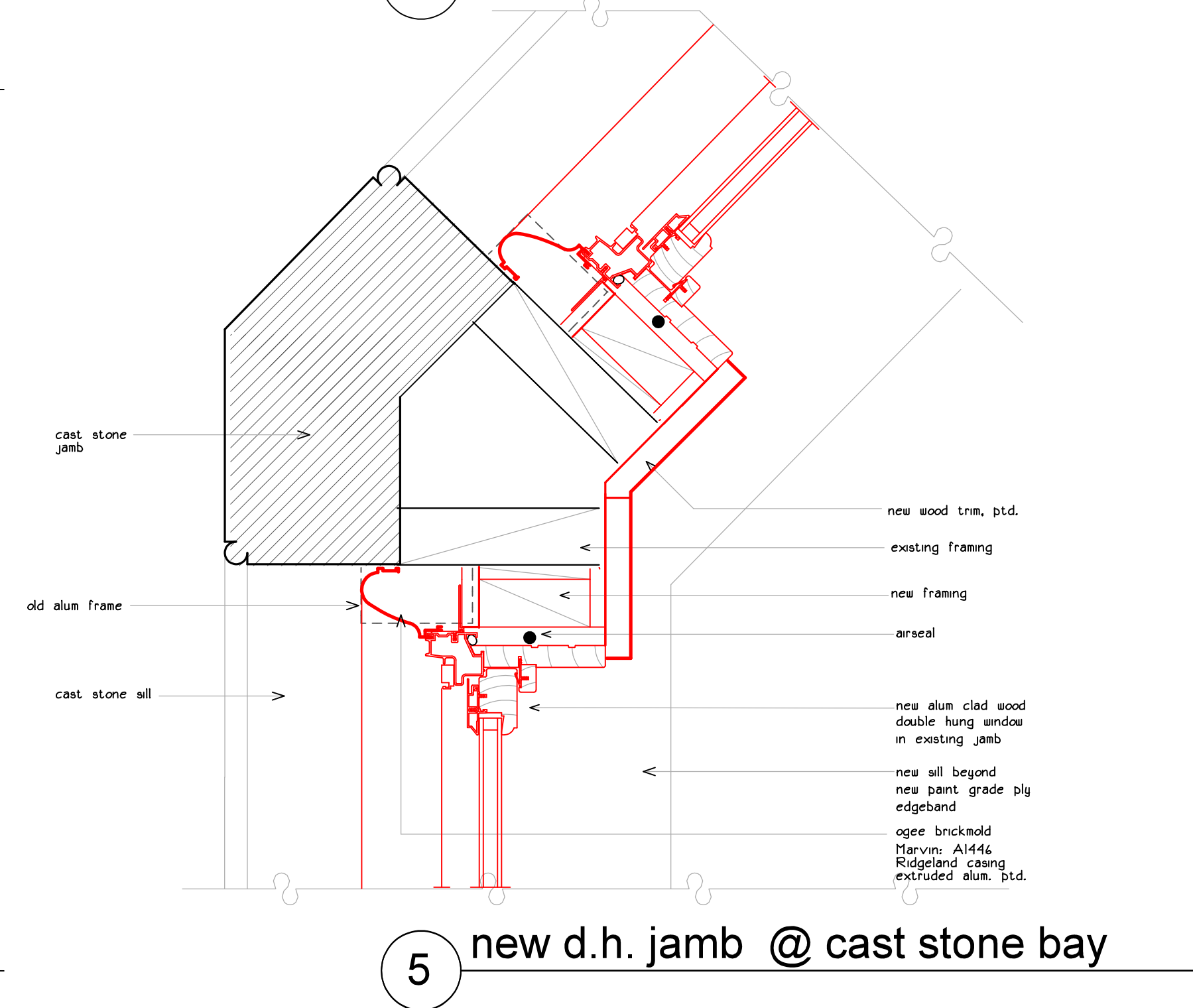

5 new d.h. jamb @ cast stone bay

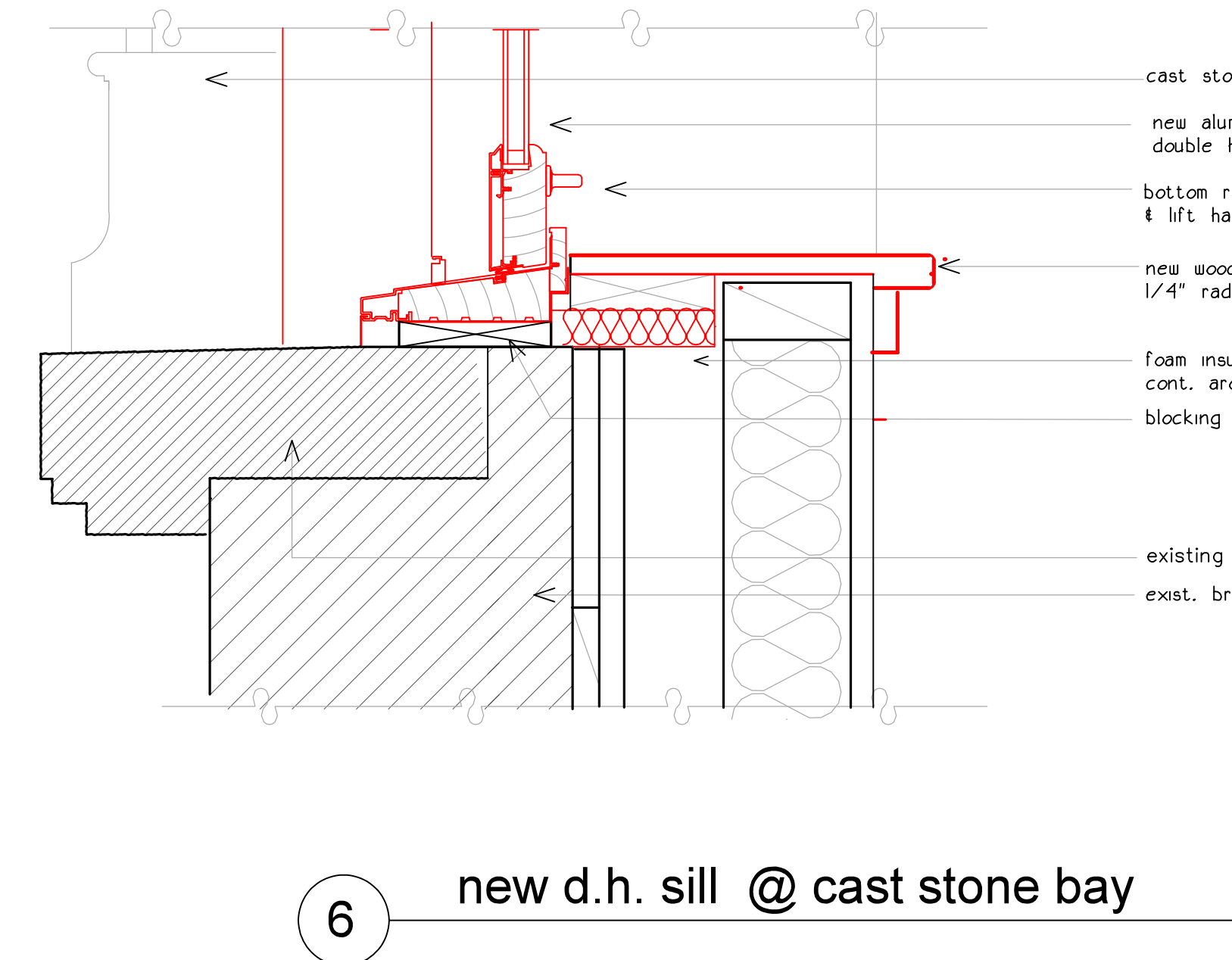

6 new d.h. sill @ cast stone bay

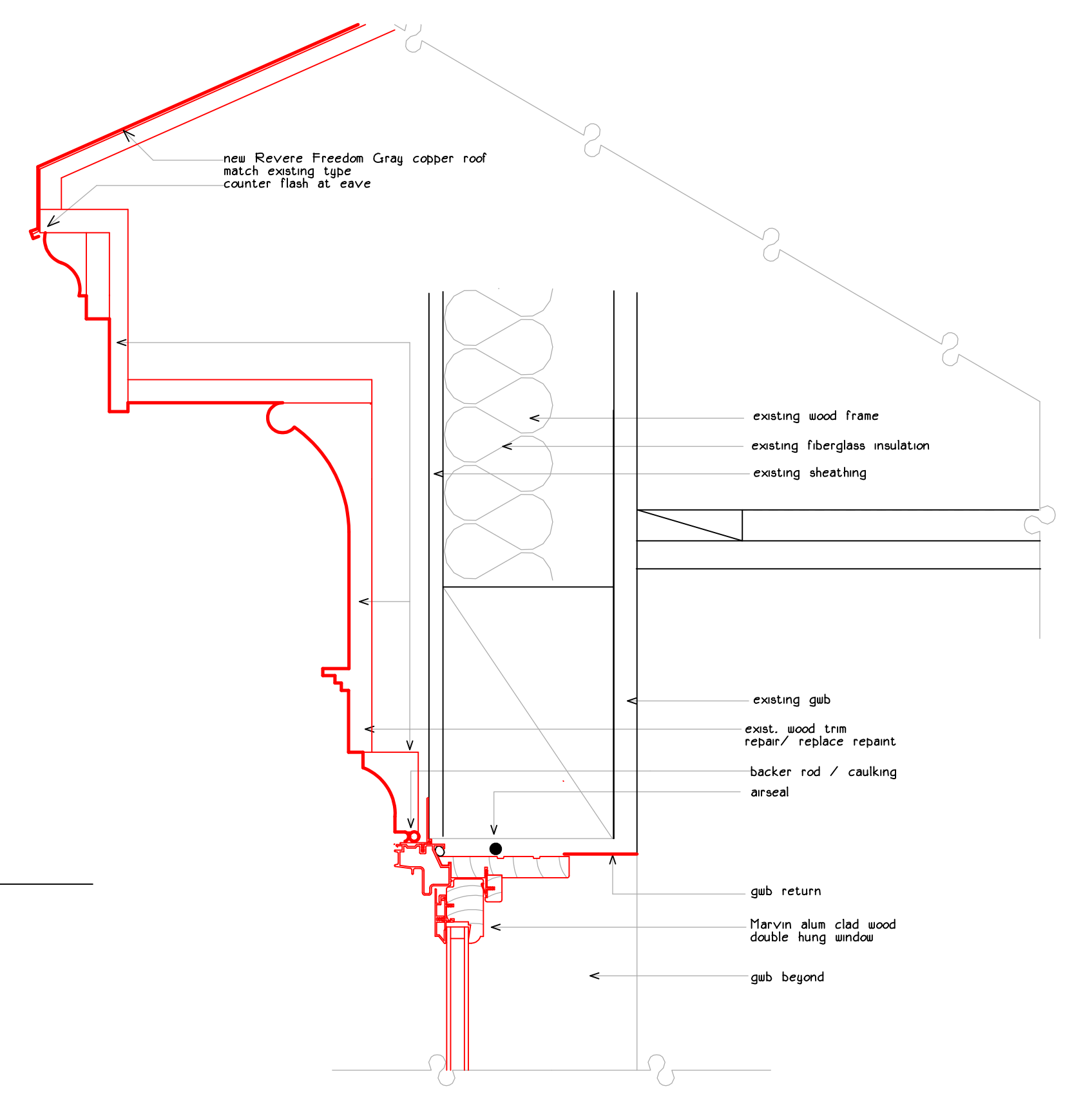

7 new head @ 2nd floor bay

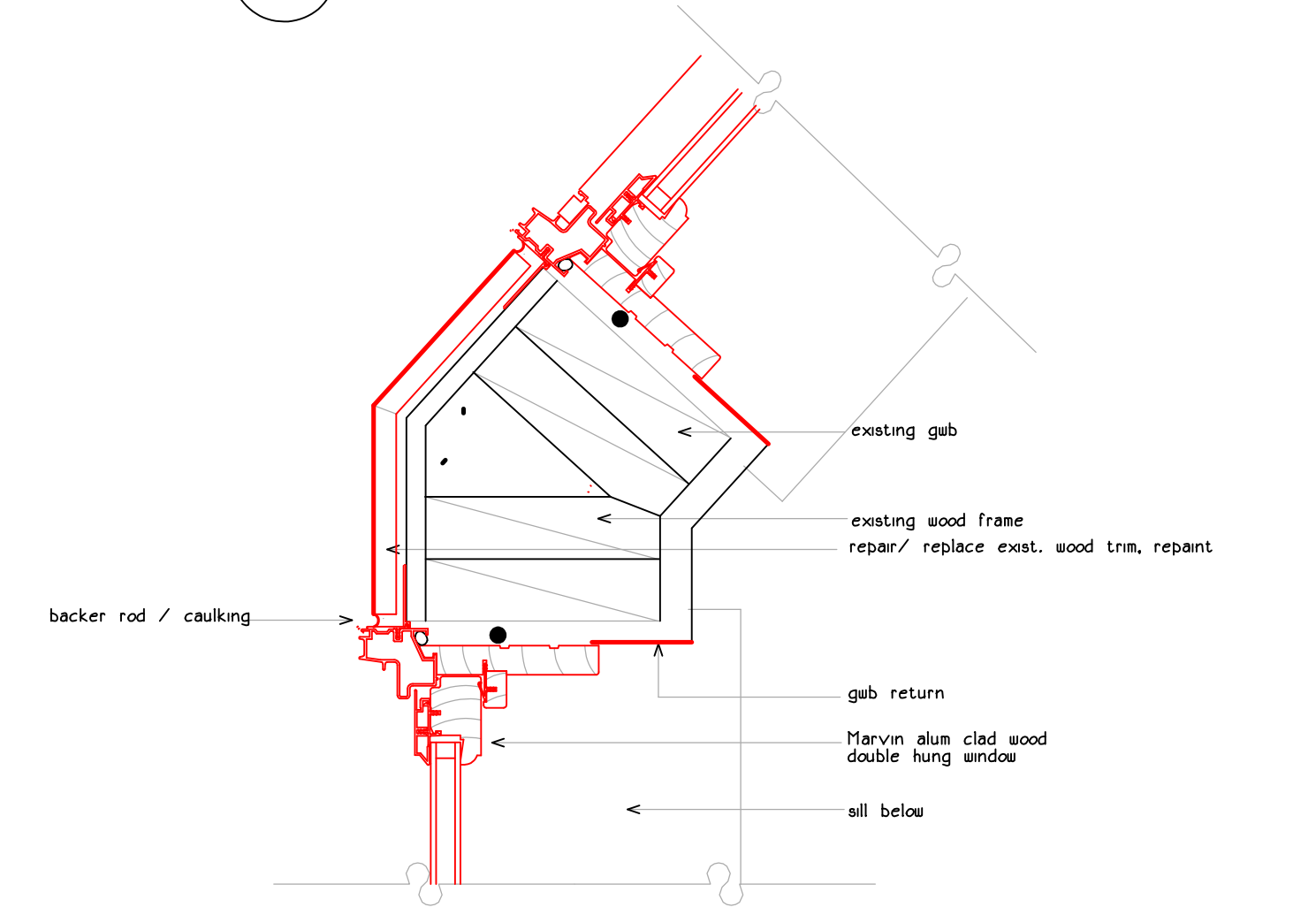

8 new jamb @ 2nd floor bay

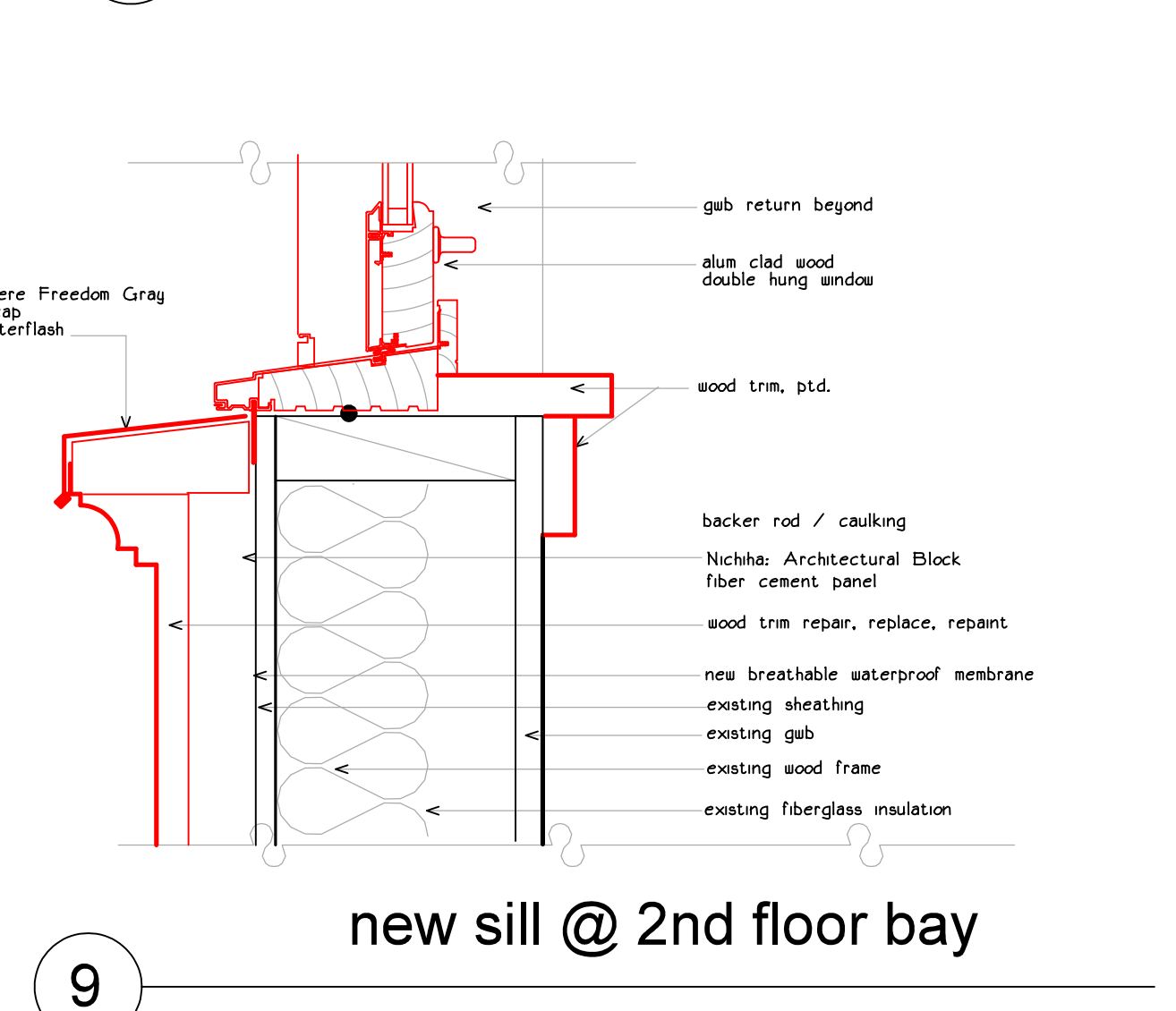

9 new sill @ 2nd floor bay