

**SEBAGO LAKE POOLS/ROYAL IMPROVEMENTS, INC.
FROST N' FLAME, INC.**

621 Main St. 889 Roosevelt Trail
Gorham, ME 04038 Windham, ME 04062
856-1000 856-7000 893-3483 893-2876
FAX 856-1164

www.frostandflame.com www.sebagolakepools.com

HOME PHONE		JOB INVOICE	
CELL	917-941-4238	WK PHONE	370-4521
DATE OF ORDER	10/20/15	ORDER TAKEN BY	Shawn/Nick
CONTRACTOR			
PHONE #		FAX #	
MAILING ADDRESS OR E-MAIL		jcd327@gmail.com	

To: Chris Papagni
27 Congress St Town: Portland
State: ME Zip Code:

Directions: Congress St on corner (use side driveway)
Sage green color on Brick (unit on Back on corner driveway ledge)

QTY	MATERIALS	PRICE	AMOUNT
	White GF 3/20 1001 908 stove # 359671 Sale		3941 00
1	Skytech Bunkie 1001		180 00
	Vent kit 10 24" need 45% offset get Vent <u>ASU</u> close to wall		
	Simpson Vent pipe Need source cap on outside		1045 00
1	River Rock # 157428		134 00
	Turn Point for termination # 270-54		
	Note: customer has panels on wall that are held on By magnets you can get access for gas line		4900 00

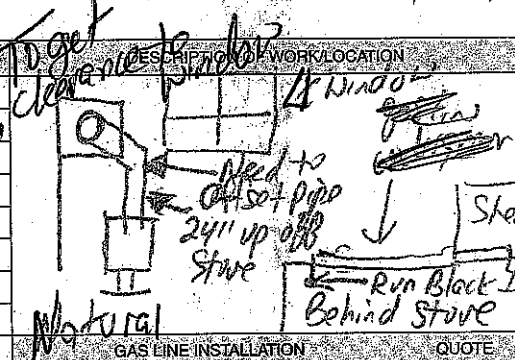

GAS LINE INSTALLATION		QUOTE
COST OF ANY PROPANE NOT INCLUDED		
Connect to existing gas line go outside into storage shed to outside shed line to stove location		
GAS LINE MATERIALS		395 00
GAS LINE LABOR		275 00
thru back to inside run Black Iron Inside		

LABOR	HRS	RATE	AMOUNT
Install stove + vent going thru brick wall			570 00
			75 00

COST OF PERMIT IF REQUIRED		
SHIPPING COST		
JOB LABOR		595 00
MATERIALS		4900 00
MATERIALS FOR GAS LINE		395 00
GAS LINE LABOR		275 00
TAX		291 73
TOTAL		6456 73

Thank You

- SITE INSPECTION -
BALANCE DUE 6,431 23

20% Restocking Fee for ANY returned or cancelled materials!

I, the customer, have read the back of this contract for terms & conditions of sale, and have signed the back page.

Work ordered by _____
Signature _____
I hereby acknowledge the satisfactory completion of the above described work

ANY PERMITS REQUIRED ARE CUSTOMER'S RESPONSIBILITY

50% DEPOSIT TO ORDER: 3,215.61 pd on card

BALANCE DUE UPON INSTALLATION: 3,215.62

ESTIMATE GOOD FOR _____ DAYS
(Customer Required to Sign Back of Contract)

Circle One:
MC/Visa/Disc.
CREDIT CARD # _____ EXPI. DATE _____

ANY INSTALLATION DATE GIVEN MAY VARY DEPENDING ON WEATHER, PRODUCT AVAILABILITY, LABOR SHORTAGES AND/OR MATERIALS NOT AVAILABLE BY REGULAR SUPPLIERS

The Company shall not be liable under any circumstances for any loss sustained by the Customer as a result of the exhaustion of the Customer's supply of propane. The Company shall not be liable for any injuries to persons, damages, to property or loss of propane arising out of the transportation, storage or use of propane or the use, operation, removal, maintenance or repair of any propane equipment or appliance, except that such injuries, damage or loss shall result directly from the negligence of the Company or its employees or representatives.