

TITLE: CM Plan
 PROJECT: 510 Cumberland
 DATE: 6/13/2017

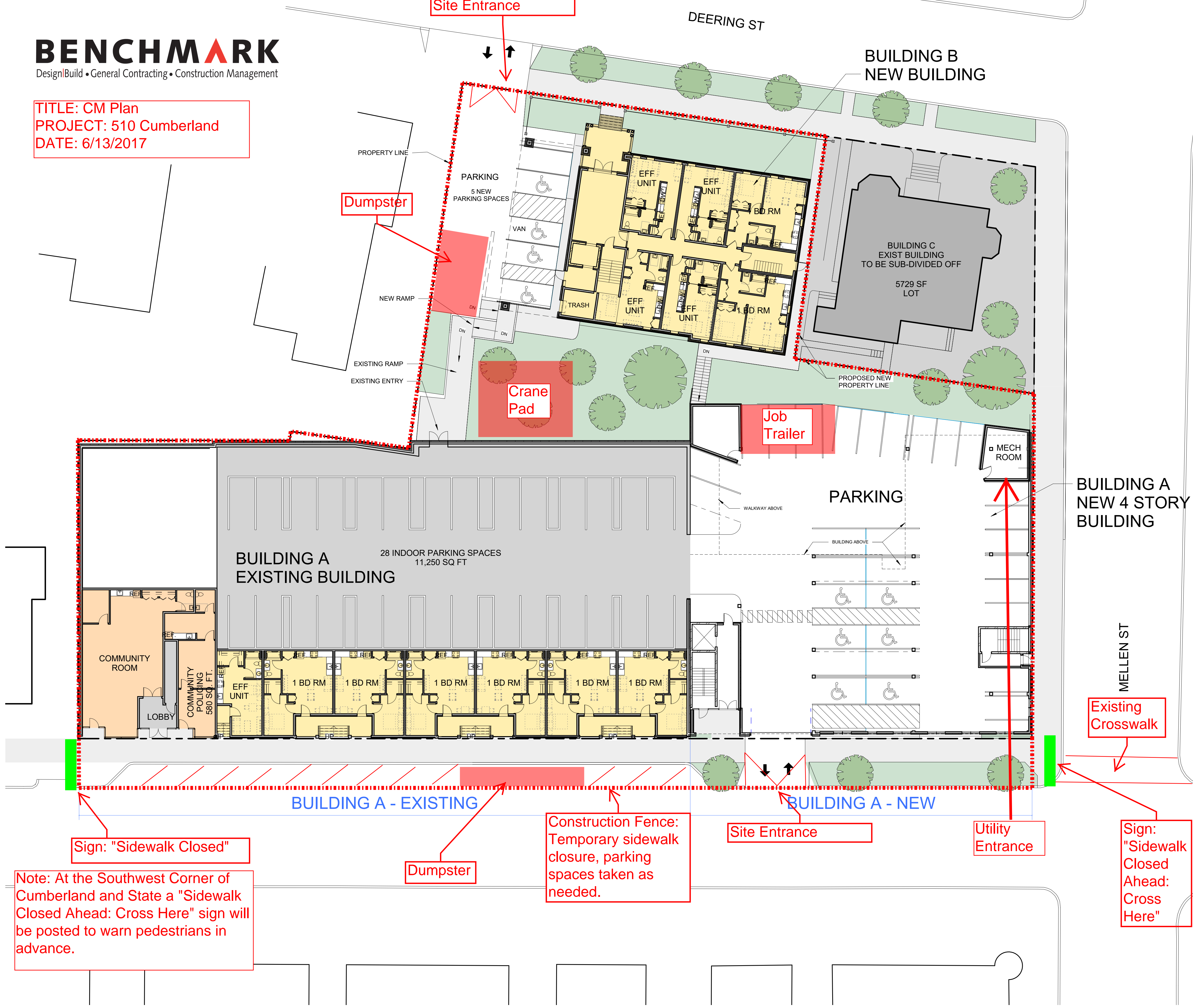

Sign: "Sidewalk Closed"

Note: At the Southwest Corner of Cumberland and State a "Sidewalk Closed Ahead: Cross Here" sign will be posted to warn pedestrians in advance.

Dumpster

Construction Fence: Temporary sidewalk closure, parking spaces taken as needed.

Site Entrance

Utility Entrance

Existing Crosswalk

Sign: "Sidewalk Closed Ahead: Cross Here"

