

P5641-31

6" cylinder with heavy duty aluminum construction and die cast wall bracket. Powder coated finish. cCSAus listed for wet locations.

\$129.58

[BUY ONLINE](#)

[FIND A DEALER](#)



Overview

Product Specifications



Features

Product SKU

P5641-31

Family ?

Cylinder

Category

Outdoor

Description

6" cylinder with heavy duty aluminum construction and die cast wall bracket. Powder coated finish. cCSAus listed for wet locations.

Finish

Black

Bulb Type ?

Uses PAR-38 or BR-40

Bulb Wattage ?

250/150

Bulb Quantity ?

1

Listed ?

Wet location listed



Showcase Your Space

Tag Your Photos #progressitg & Join Our Instagram Feed!



Mount Type ?

Wall

SU



Style ?

Contemporary/Modern

Room Type ?

Outdoor Lighting and/or

Dimensions ?

Width/Diameter: 6"

Height: 12"

You Might Also Like

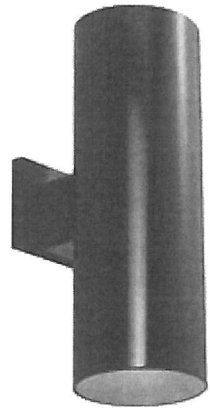

P5642-20

\$176.44

CYLINDER OUTDOOR

**WALL OR
CEILING MOUNT**
EUROLUXE® SERIES

Cat.# BRLU-04

Job
749 Congress St

Type
B



Approvals

Intended Use

- Several colors and accessories, including guards and shields, are available for both interior and exterior applications, such as entry, perimeter, walls, stairwells, corridors, etc.

Construction

- Borosilicate glass lens sealed to housing by silicone gasket and stainless steel philips head screws; Ribbed lens uniformly spreads light for a symmetrical, soft distribution
- Die cast aluminum housing and face trims
- Two point lag or hickey mount to recessed junction box
- Dark bronze, Black and White finishes are offered

Electrical

- Available in 50w HPS, 28w fluorescent and 100w max. incandescent, 120V only
- BRLU LED has 6 LED in 15w, 120-277V, 830 lumens, 5000K, 700mA
- Lamp included on 50w HPS, 28w fluorescent and 15w LED

Listings

- Listed to UL1598 for use in wet locations

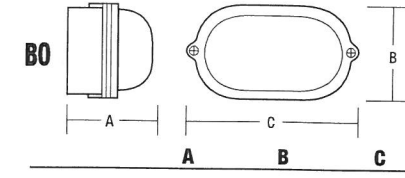
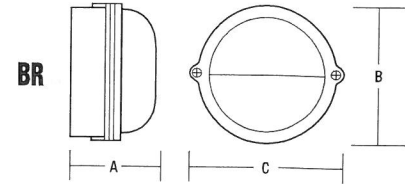
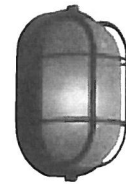
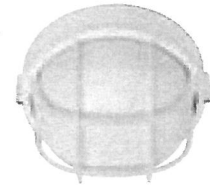

	A	B	C
BRI ROUND	5 1/2"	9 1/2"	10 1/8"
	150 mm	241 mm	257 mm
BOI OVAL	5 1/2"	6 2/8"	11 1/4"
	150 mm	162 mm	286 mm



ORDERING INFORMATION ORDERING EXAMPLE: B01-01

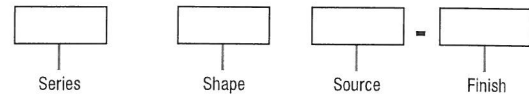

Catalog Number	Shape	Finish	Wattage	Weight	
				lbs.	kg
LED¹					
BRLU-01	Round	Bronze	15 max.	6.0	2.7
BRLU-04	Round	White	15 max.	6.0	2.7
INCANDESCENT²					
BRI-01	Round	Bronze	100 max.	4.0	1.8
BRI-02	Round	Black	100 max.	4.0	1.8
BRI-04	Round	White	100 max.	4.0	1.8
B01-01	Oval	Bronze	100 max.	3.5	1.6
B01-02	Oval	Black	100 max.	3.5	1.6
B01-04	Oval	White	100 max.	3.5	1.6
HIGH PRESSURE SODIUM (lamp included)²					
BRS-01	Round	Bronze	50	7.5	3.4
BRS-02	Round	Black	50	7.5	3.4
BRS-04	Round	White	50	7.5	3.4
BOS-01	Oval	Bronze	50	7.0	3.2
BOS-02	Oval	Black	50	7.0	3.2
BOS-04	Oval	White	50	7.0	3.2
FLUORESCENT (lamp included)^{1,3}					
BRF-01	Round	Bronze	28	6.0	2.7
BRF-02	Round	Black	28	6.0	2.7
BRF-04	Round	White	28	6.0	2.7
BOF-01	Oval	Bronze	28	5.5	2.5
BOF-02	Oval	Black	28	5.5	2.5
BOF-04	Oval	White	28	5.5	2.5

1 Fluorescent CSA certified for outdoor applications only, not available in 277V
 2 Pulse-rated medium base socket
 3 Two-pin fluorescent socket - PLC 28, 2700K, -20°F starting
 4 LED units feature 5 year limited warranty

ACCESSORIES (order as separate part #)

Catalog Number	Description
BO-GX'	Cast aluminum guard for oval fixture
BR-GX'	Cast aluminum guard for round fixture
BO-SX'	Cast aluminum shield for oval fixture
BR-SX'	Cast aluminum shield for round fixture

1 Finish must be specified, substitute X for: 1-bronze, 2-black, 4-white

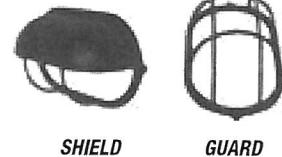

PHOTOMETRIC REPORTS

Catalog Number	Report #
BRI-OX	HP05330.IES
BRI-OX/BR-SX	HP05331.IES
BRI-XX	ITL60433.IES
BRLU-OX	BRLU01.IES



Hubbell Outdoor Lighting • 701 Millennium Boulevard • Greenville, SC 29607 • Phone: 864-678-1000
 Due to our continued efforts to improve our products, product specifications are subject to change without notice.

© 2015 HUBBELL OUTDOOR LIGHTING, All Rights Reserved • For more information visit our website: www.hubbelloutdoor.com • Printed in USA

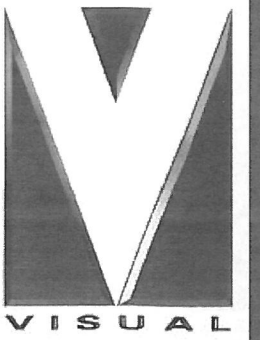

749 Congress St.
Portland, ME
Photometric

Designer
SAJ Bennett Eng.
Date
4/4/2016
Scale
Not to Scale
Drawing No.
E0
Summary

749 Congress St Townhouses

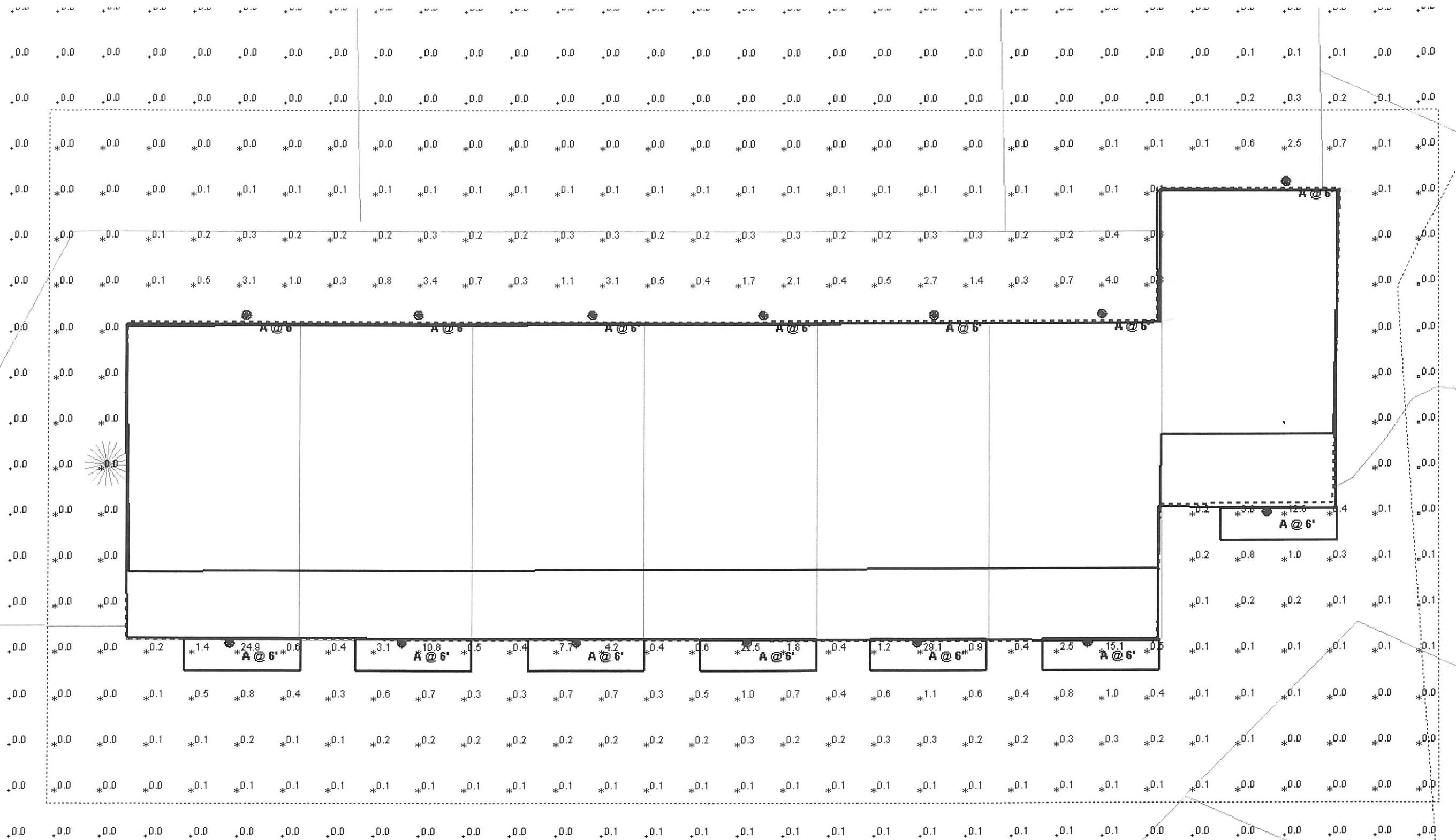

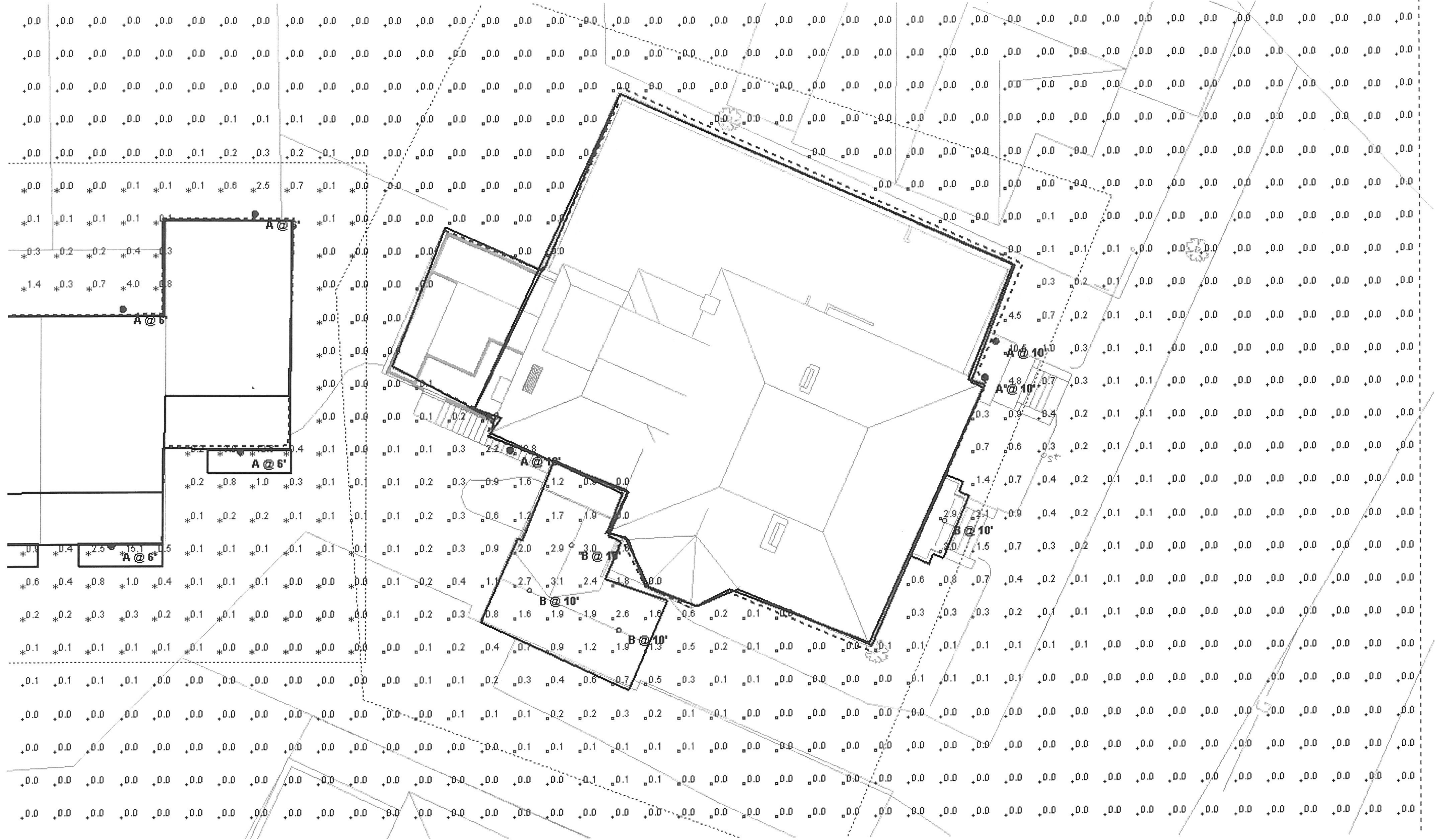
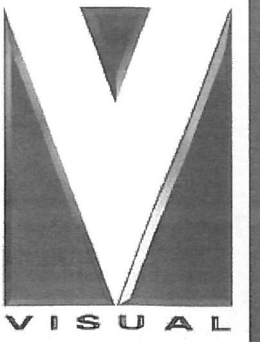

749 Congress St

749 Congress St.
Portland, ME
Photometric

Designer
SAJ Bennett Eng.
Date
4/4/2016
Scale
Not to Scale
Drawing No.
E0
Summary

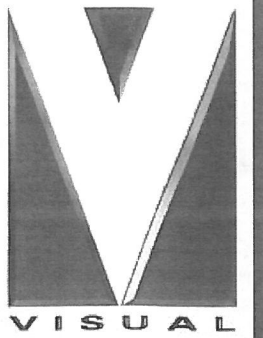

Luminaire Schedule											
Symbol	Label	Quantity	Manufacturer	Catalog Number	Description	Lamp	Number Lamps	Filename	Lumens Per Lamp	Light Loss Factor	Wattage
	A	17	Philips Lighting Company			75PAR30L/HAL/FL40 120V	1	229443.ies	769.744	0.8	75
	B	4	HUBBELL OUTDOOR	BRLU-0X	CAST BROWN PAINTED METAL HOUSING, FLAT DIFFUSE METAL CIRCUIT BOARD MOUNTING PLATE, ONE CIRCUIT BOARD WITH 6 LEDS, FROSTED LINEAR PRISMATIC GLASS DROP LENS WITH CONCENTRIC CIRCULAR BOTTOM	SIX WHITE LIGHT EMITTING DIODES (LEDS) EACH WITH CLEAR HEMISPHERICAL INTEGRAL LENS, VERTICAL BASE-UP POSITION. VOLTAGE (120VAC, 60Hz) TO THE LED DRIVER.	6	BRLU-0X.ies	153.8734	1	15

Statistics							
Description	Symbol	Avg	Max	Min	Max/Min	Avg/Min	Avg/Max
749 Congress St	□	0.5 fc	12.8 fc	0.0 fc	N/A	N/A	0.0:1
749 Congress Townhouse	✕	0.8 fc	29.1 fc	0.0 fc	N/A	N/A	0.0:1
Overall Site	+	0.1 fc	29.1 fc	0.0 fc	N/A	N/A	0.0:1

749 Congress St.
Portland, ME
Photometric

Designer
SAJ Bennett Eng.
Date
4/4/2016
Scale
Not to Scale
Drawing No.
E0
Summary