

LEGEND

EXISTING	PROPOSED
--- PROPERTY LINE	--- EDGE OF PAVEMENT
--- ABUTTERS PROPERTY EASEMENT	--- VERTICAL GRANITE CURB
--- EDGE OF PAVEMENT CONTOURS	--- BUILDING
--- BUILDING CURB	--- BUILDING ENTRY/EGRESS
--- GAS LINE	--- BUILDING OVERHEAD DOOR
--- SANITARY SEWER	--- CONTOURS
--- STORM DRAIN	--- GAS LINE
--- OVERHEAD UTILITY	--- SANITARY SEWER
--- WATER LINE	--- STORM DRAIN
--- CATCH BASIN	--- OVERHEAD UTILITY
--- SEWER MANHOLE	--- UNDERGROUND UTILITY
--- HYDRANT	--- WATER LINE
--- WATER VALVE	--- FOUNDATION DRAIN
--- GAS VALVE	--- DRIPSTRIP W/ UNDERDRAIN
--- POLE MOUNTED TRANSFORMER	--- SPOT GRADE
--- UTILITY POLE W/ GUY WIRE	--- CATCH BASIN
--- LIGHT POLE	--- DRAIN MANHOLE
--- AREA LIGHT ON POLE	--- SANITARY MANHOLE
--- SIGN	--- TRANSFORMER
--- FENCE	--- UTILITY POLE
--- BENCHMARK	--- SURFACE DRAINAGE
	--- WATER SHUT OFF
	--- STOCKADE FENCE
	--- BOLLARD
	--- FULL DEPTH BITUMINOUS PVT
	--- BRICK PAVERS
	--- CONCRETE PAVERS

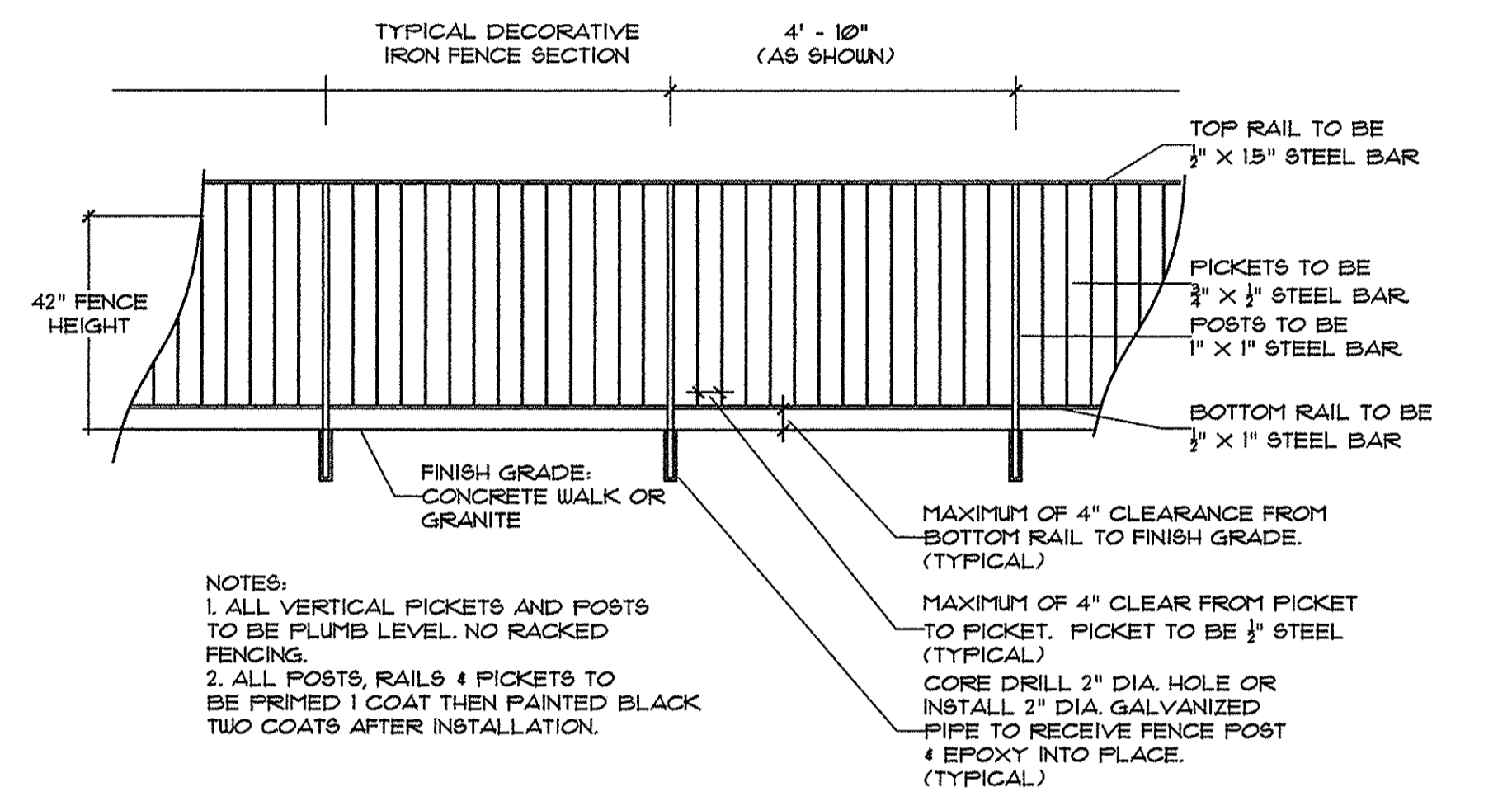

DECORATIVE IRON FENCING

N.T.S.

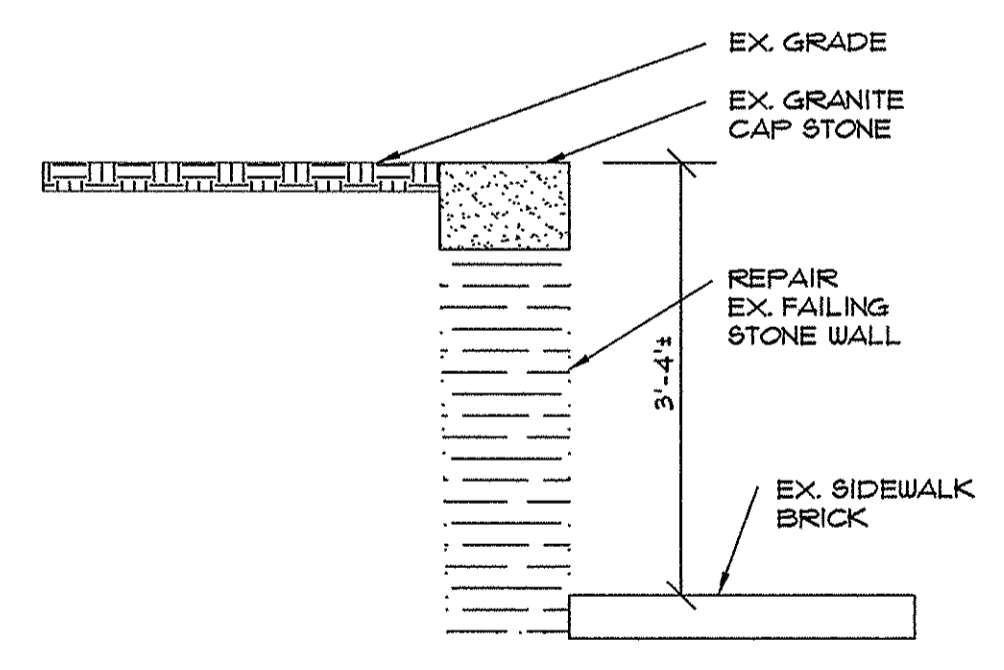

STONE WALL REPAIR
N.T.S.

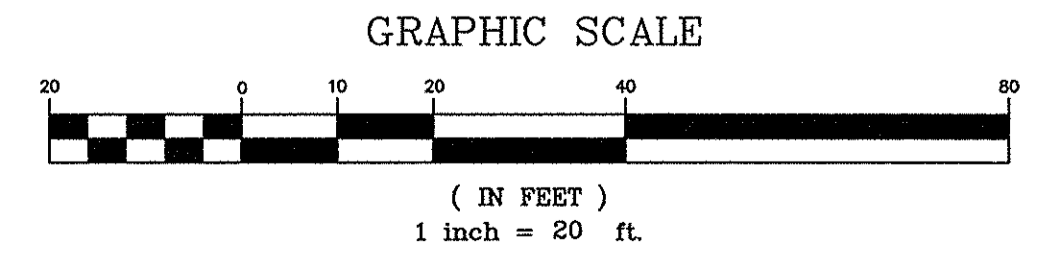
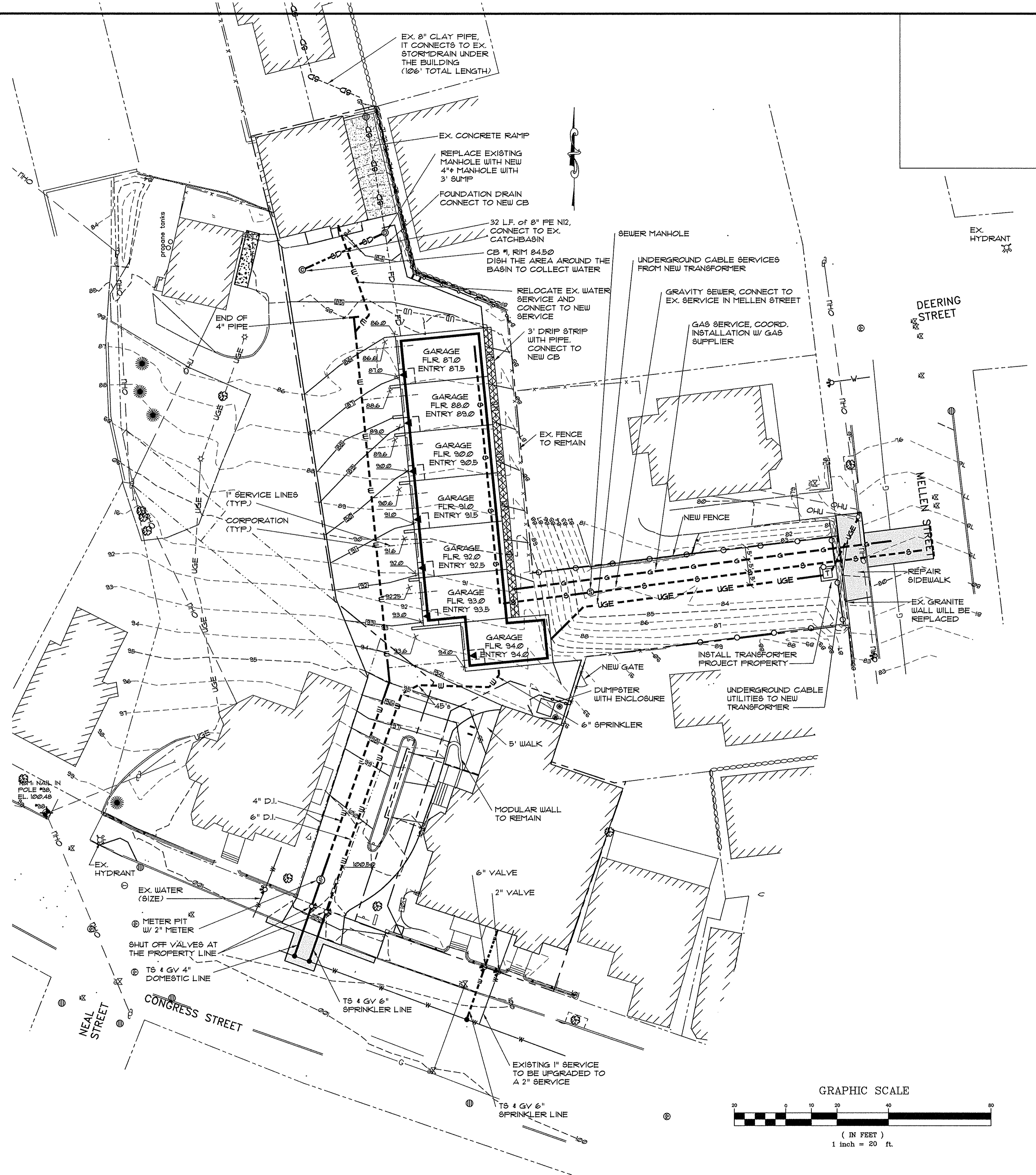

PINKHAM & GREER CIVIL ENGINEERS
28 WAWANAH ME. PORTLAND, ME 04103
TEL: 207.761.5642 FAX: 207.781.4245

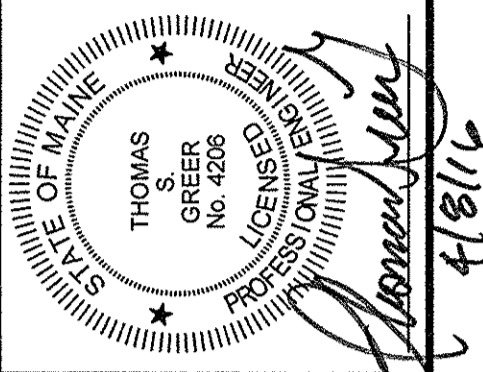

DATE	REV.	DESCRIPTION
4/18/16	1	NEW STAFF COMMENTS

APPLICANT: DENOVO, LLC
47 WAITES LANDING ROAD
FALMOUTH, MAINE

SCALE: AS SHOWN
DATE: FEBRUARY 22, 2016
PROJECT: 16166

DRN BY: JDC
DES BY: TSG
CHK BY: TSG

749 CONGRESS STREET
749 CONGRESS STREET
PORTLAND, MAINE

GRADING & UTILITIES PLAN

C1.4

MAPLOT 471A/20, 30, 28, 32