

**CITY OF PORTLAND  
SITE PLAN AND SUBDIVISION NOTES**

- LANDSCAPING SHALL MEET THE "ARBORICULTURAL SPECIFICATIONS AND STANDARDS OF PRACTICE AND LANDSCAPE GUIDELINES" OF THE CITY OF PORTLAND TECHNICAL AND DESIGN STANDARDS AND GUIDELINES.
- THE ENTIRE SITE SHALL BE DEVELOPED AND/OR MAINTAINED AS DEPICTED ON THE SITE PLAN. APPROVAL OF THE PLANNING AUTHORITY OR PLANNING BOARD SHALL BE REQUIRED FOR ANY ALTERATION TO OR DEVIATION FROM THE APPROVED SITE PLAN, INCLUDING, WITHOUT LIMITATION: TOPOGRAPHY, DRAINAGE, LANDSCAPING, RETENTION OF WOODED OR LAWN AREAS, ACCESS, SIZE, LOCATION, AND SURFACING OF PARKING AREAS AND LOCATION AND SIZE OF BUILDINGS.
- ALL POWERLINE UTILITIES SHALL BE UNDERGROUND.
- SIDEWALKS AND CURBING SHALL BE DESIGNED AND BUILT WITH TIFDOWN RAMP(S) AT ALL STREET CORNERS, CROSSWALKS AND DRIVEWAYS IN CONFORMANCE WITH THE CITY OF PORTLAND TECHNICAL AND DESIGN STANDARDS AND GUIDELINES.
- ALL EROSION CONTROL MEASURES SHALL BE CONSTRUCTED AND MAINTAINED IN ACCORDANCE WITH THE MAINE EROSION AND SEDIMENT CONTROL BMP'S PUBLISHED BY THE BUREAU OF LAND AND QUALITY, MAINE DEPARTMENT OF ENVIRONMENTAL PROTECTION, MARCH 2003.
- ALL EROSION CONTROL MEASURES SHALL BE INSTALLED PRIOR TO ANY SITE EXCAVATION OR REGRADING.
- ALL DISTURBED AREAS ON THE SITE NOT COVERED BY BUILDINGS OR PAVED AREAS SHALL BE STABILIZED WITH LOAM AND SEED OR OTHER METHODS AS REQUIRED BY BEST MANAGEMENT PRACTICES (SEE ABOVE).
- PRIOR TO CONSTRUCTION, A PRECONSTRUCTION MEETING SHALL BE HELD AT THE PROJECT SITE WITH THE CONTRACTOR, DEVELOPMENT REVIEW COORDINATOR, PUBLIC WORK'S REPRESENTATIVE AND OWNER TO REVIEW THE CONSTRUCTION SCHEDULE AND CRITICAL ASPECTS OF THE SITE WORK. AT THAT TIME, THE SITE/BUILDING CONTRACTOR SHALL PROVIDE THREE (3) COPIES OF A DETAILED CONSTRUCTION SCHEDULE TO THE ATTENDING CITY REPRESENTATIVE. IT SHALL BE THE CONTRACTOR'S RESPONSIBILITY TO ARRANGE A MUTUALLY AGREEABLE TIME FOR THE PRECONSTRUCTION MEETING.
- EXISTING VEGETATION SHALL BE CONSERVED IN AREAS SHOWN ON THIS SITE. FENCING OR OTHER PROTECTIVE BARRIERS SHALL BE ERRECTED OUTSIDE THE DRIP-LINE OF INDIVIDUAL, GROUPINGS OF TREES DESIGNATED FOR PRESERVATION PRIOR TO THE ONSET OF CONSTRUCTION. REGRADING SHALL NOT TAKE PLACE WITHIN THE DRIP-LINE OF TREES DESIGNATED FOR PRESERVATION. NO STORAGE OR CONSTRUCTION MATERIALS SHALL BE PERMITTED WITHIN THE DRIP-LINE OF TREES TO BE PRESERVED.
- SUBDIVISION AT THE TIME OF APPROVAL IS DEFINED AS "SUBDIVISION SHALL MEAN THE DIVISION OF A LOT, TRACT OR PARCEL OF LAND INTO THREE (3) OR MORE LOTS, INCLUDING LOTS OF FORTY (40) ACRES OR MORE, WITHIN ANY FIVE-YEAR PERIOD, WHETHER ACCOMPLISHED BY SALE, LEASE, DEVELOPMENT, BUILDINGS OR OTHERWISE AND AS FURTHER DEFINED IN 30-A M.R.S.A. SECTION 4401. THE TERM SUBDIVISION SHALL ALSO INCLUDE THE DIVISION OF A NEW STRUCTURE OR STRUCTURES ON A TRACT OR PARCEL OF LAND INTO THREE (3) OR MORE DWELLING UNITS WITHIN A FIVE-YEAR PERIOD AND THE DIVISION OF AN EXISTING STRUCTURE OR STRUCTURES PREVIOUSLY USED FOR COMMERCIAL OR INDUSTRIAL USE INTO THREE (3) OR MORE DWELLING UNITS WITHIN A FIVE-YEAR PERIOD. THE AREA INCLUDED IN THE EXPANSION OF AN EXISTING STRUCTURE IS DEEMED TO BE A NEW STRUCTURE FOR THE PURPOSE OF THIS PARAGRAPH. A DWELLING UNIT SHALL INCLUDE ANY PART OF A STRUCTURE WHICH, THROUGH SALE OR LEASE, IS INTENDED FOR HUMAN HABITATION, INCLUDING SINGLE-FAMILY AND MULTIFAMILY HOUSING CONDOMINIUMS, TIME-SHARE UNITS AND APARTMENTS."

**GENERAL NOTES**

- OWNER: MARTIN B. DASSA & ALYSSA J. DASSA TRUSTEES, 3 COTTONWOOD LANE, FALMOUTH, MAINE 04105. DEEDS RECORDED IN CUMBERLAND COUNTY REGISTRY OF DEEDS BK. 20901, PG. 208, DATE 11/15/06.
- DEVELOPER: DENOVO, LLC, 41 WAITES LANDING ROAD, FALMOUTH, MAINE 04105.
- ENGINEER: PINKHAM & GREER CIVIL ENGINEERS, 28 VANNAH AVENUE, PORTLAND, MAINE, 04103.
- ARCHITECT: ARCHETYPE ARCHITECTS, 48 UNION WHARF, PORTLAND, MAINE 04101.
- TOPOGRAPHIC AND BOUNDARY: TITCOMB ASSOCIATES, 133 GRAY ROAD, FALMOUTH, MAINE, 04105.
- UNDERLYING SOILS MAPPING TAKEN FROM SOIL CONSERVATION STUDY OF CUMBERLAND COUNTY AND CLASSIFIED HINCKLEY (H1B). THE SURFACE OF THE SITE IS CURRENT URBAN LAND.
- TAX MAP REFERENCE: MAP 47 / BLOCK A / LOT 20, 28, 30, 32.
- TOTAL PARCEL = 0.71 acres
- UNITS TO BE SERVICED BY PUBLIC WATER FROM CONGRESS STREET AND PUBLIC SEWER, AND GAS FROM MELLEN STREET. THESE SERVICES, INCLUDING HYDRANTS, ARE AS SHOWN ON SHEET C14, GRADING AND UTILITIES PLAN.
- POWER, TELEPHONE AND CABLE SERVICES ARE TO BE UNDERGROUND FROM A NEW POLE ON THE SUBJECT PARCEL ADJACENT TO MELLEN STREET. THESE SERVICES ARE SHOWN ON SHEET C14, GRADING AND UTILITIES PLAN.
- CALL DIG-SAFE PRIOR TO COMMENCING WORK, 1-800-DIG-SAFE.
- ALL WORK WITHIN THE PUBLIC RIGHT OF WAY SHALL MEET CITY OF PORTLAND TECHNICAL MANUAL STANDARDS.
- PROPOSED PARKING SPACES: 11-OUTDOOR, 1-INDOOR PER UNIT.
- THE SUBJECT PARCEL SHOWN AS 749 CONGRESS STREET IS SUBJECT TO A CITY OF PORTLAND LEVEL III SITE PLAN AND SUBDIVISION PERMIT.
- FLOODPLAIN: THIS PROPERTY IS IN ZONE C OF THE FLOOD INSURANCE RATE MAP, COMMUNITY PANEL 230051 0014 B, EFFECTIVE DATE JULY 17, 1996. IT IS NOT IN A SPECIAL FLOOD HAZARD ZONE.
- NEW PROPERTY PINS TO BE SET AT THE EXPENSE OF THE DEVELOPER AT THE END OF CONSTRUCTION.
- ALL CONSTRUCTION AND SITE ALTERATIONS SHALL BE DONE IN ACCORDANCE WITH THE "MAINE EROSION AND SEDIMENT CONTROL BMP'S" PUBLISHED BY THE BUREAU OF LAND AND WATER QUALITY, MAINE DEPARTMENT OF ENVIRONMENTAL PROTECTION, LATEST EDITION, MARCH 2003.

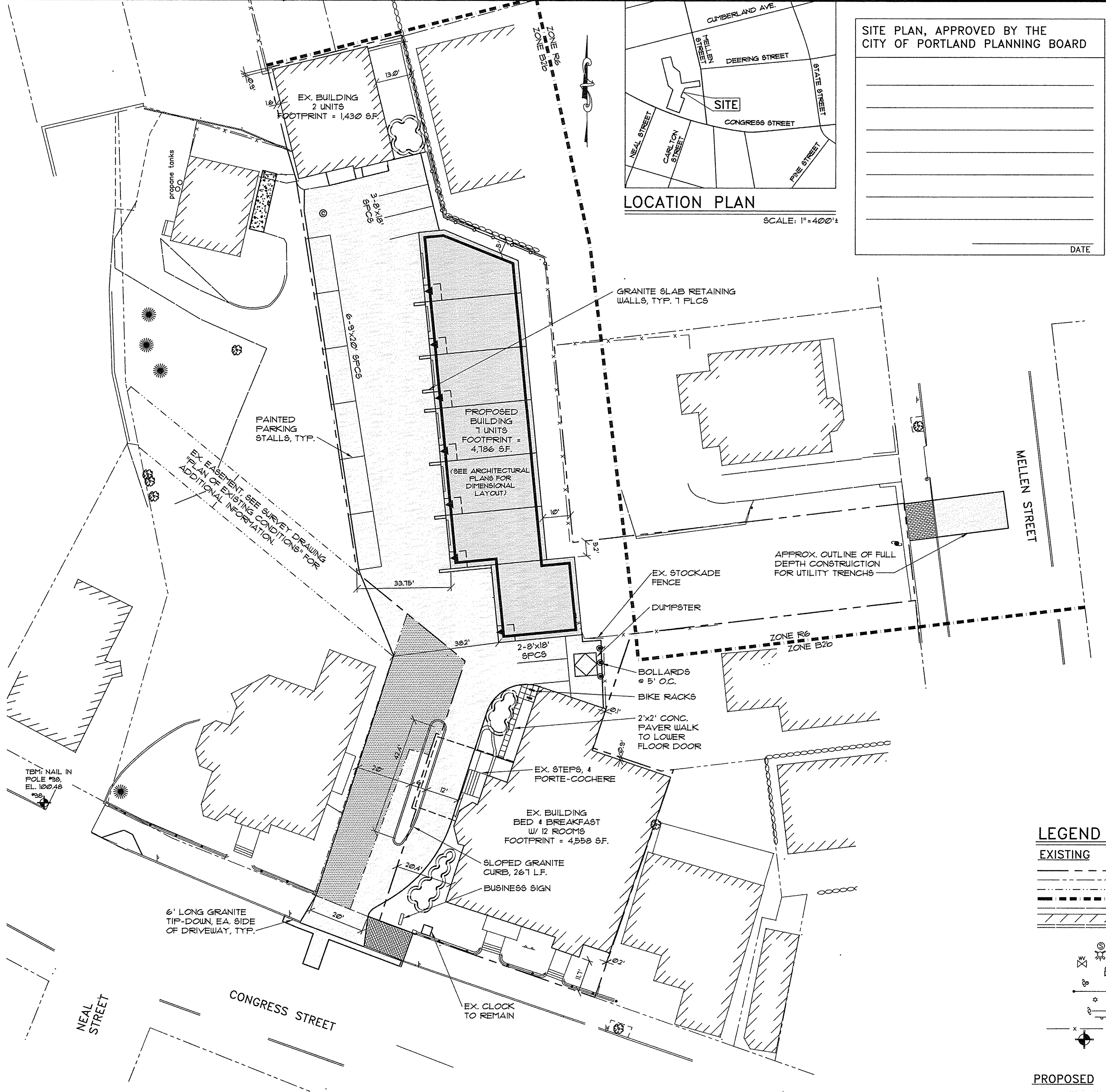

SITE PLAN, APPROVED BY THE CITY OF PORTLAND PLANNING BOARD

DATE \_\_\_\_\_

**ZONE INFORMATION**

B2b - COMMUNITY BUSINESS ZONE  
R6 - RESIDENTIAL ZONE

PERMITTED USES: MULTI-FAMILY DWELLING, RESTAURANTS, HOTELS & MOTELS LESS THAN 150 ROOMS

**PARKING INFORMATION**

OFF STREET PARKING 11 SPACES  
BIKE RACKS

EXTERIOR: 4  
INTERIOR: GARAGE

**PROJECT DRAWINGS**

|     |   |
|-----|---|
| C11 | COVER SHEET                             |
| C12 | SUBDIVISION RECORDING PLAT              |
| C13 | SITE PLAN                               |
| C14 | EXISTING CONDITIONS AND DEMOLITION PLAN |
| C15 | GRADING AND UTILITIES PLAN              |
| C16 | EROSION CONTROL PLAN, NOTES AND DETAILS |
| C17 | LANDSCAPE PLAN, NOTES AND DETAILS       |
| C21 | SITE DETAILS                            |
| C22 | SITE DETAILS                            |

PLAN OF EXISTING CONDITIONS SURVEY

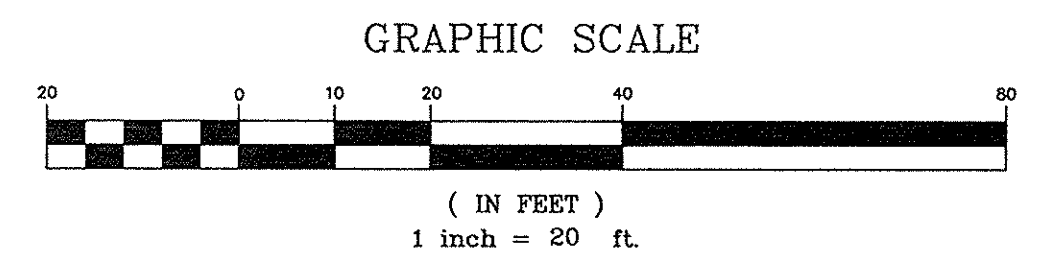

**LEGEND**

| EXISTING                 | PROPOSED                   |
|--------------------------|----------------------------|
| PROPERTY LINE            | EDGE OF PAVEMENT           |
| ADJUTERS PROPERTY        | VERTICAL GRANITE CURB      |
| EASEMENT                 | BUILDING                   |
| ZONING DISTRICT          | BUILDING ENTRY/EGRESS      |
| EDGE OF PAVEMENT         | BUILDING OVERHEAD DOOR     |
| BUILDING                 | CATCH BASIN                |
| CURB                     | UTILITY POLE               |
| CATCH BASIN              | STOCKADE FENCE             |
| SEWER MANHOLE            | BOLLARD                    |
| HYDRANT                  | FULL DEPTH BITUMINOUS PAVT |
| WATER VALVE              | BRICK PAVERS               |
| GAS VALVE                | CONCRETE PAVERS            |
| POLE MOUNTED TRANSFORMER |                            |
| UTILITY POLE W/ GUY WIRE |                            |
| AREA LIGHT ON POLE       |                            |
| SIGN                     |                            |
| FENCE                    |                            |
| BENCHMARK                |                            |

**PINKHAM & GREER CIVIL ENGINEERS**  
28 VANNAH AVE. PORTLAND, ME. 04103  
TEL. 207.781.5242 FAX. 207.781.6426

THOMAS GREER No. 4208 LICENSED PROFESSIONAL ENGINEER

APPLICANT: DENOVO, LLC  
47 WAITES LANDING ROAD  
FALMOUTH, MAINE

749 CONGRESS STREET  
749 CONGRESS STREET  
PORTLAND, MAINE

**C1.2**

MAPLOT 47/A/20, 30, 28, 32

SCALE: AS SHOWN  
DATE: FEBRUARY 22, 2016  
PROJECT: 15165

DRN BY: JDC  
DESG BY: TSG  
CHK BY: TSG

SITE PLAN