

747 CONGRESS
LLC

Prepared For:

Consultant:



Architect:

THE FRANCIS

Project:

749 CONGRESS ST
PORTLAND, ME 04102

Revisions:

Date: 03 AUG 2016
Scale: As indicated

NEW FIRST FLOOR
REFLECTED CEILING
PLAN

A7.01

REFLECTED CEILING PLAN NOTES:

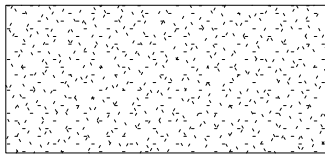
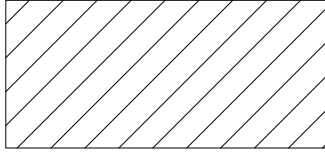
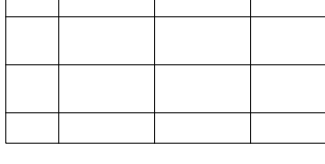
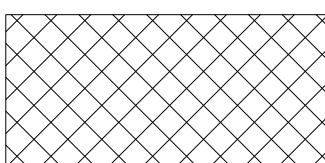
-  EXISTING PLASTER CEILING TO REMAIN
-  NEW GYP CEILING SEE PLAN FOR HEIGHT
-  NEW GYP SOFFIT. SEE PLAN FOR HEIGHT
-  NEW 2X4 ACT CEILING
-  EXISTING TIN CEILING TO REMAIN

- ART WAC LIGHTING ME-826 WT
- FM1 FEISS FM447BK DIAMOND 2 LIGHT FLUSH
- FM2 BRUCK #102-733-mc-CM
- FM3 BRUCK #102-733-mc-CM
- FM4 TBD
- FM5 BRUCK #102-733-mc-CM
- P1 SONNEMAN TRIBECA 10" PENDANT # 4932.97
- P2 CIRCA LIGHTING AGNES LARGE PENDANT #ARN5352MBK
- P3 TOM DIXON ETCH MINI BLACK PENDANT ETSM01BLKUL
- P4 SCHOOLHOUSE ELECTRIC ISAAC 1 LIGHT PENDANT-NATURAL BRASS
- P5 TROY LIGHTING F4295 ODYSSEY 4 LIGHT CHANDELIER
- P6 HUDSON VALLEY ARCHIE CHANDELIER 8510-OB
- P7 TROY LIGHTING ODYSSEY 5 LIGHT CHANDELIER F4297
- P8 TROY LIGHTING F4295 ODYSSEY 4 LIGHT CHANDELIER
- P9 CIRCA LIGHTING AGNES LARGE PENDANT #ARN5352MBK
- R1 ELITE B507W-WH
- R2 WAC LIGHTING HR2LEDT409PN927WT 2" TESLA PRO
- U COLUMBIA LIGHTING LRO4-35ML-EU
- WS1 REJUVENATION CYPRESS SMALL SCNCE #A9563
- WS2 SCHOOLHOUSE ELECTRIC CYLINDER SCNCE ANTIQUE BLACK FINISH WITH FROSTED BULB
- WS3 GEORGE KOVACS BATH ART COLLECTION 20" WIDE BATH WALL LIGHT # T4250
- WS4 BEAT WALL SCNCE BY TOM DIXON TDXP92978
- WS5 SCHOOLHOUSE ELECTRIC ISAAC SCNCE - PERSIMMON

CEILING FIXTURES

1/8" = 1'-0"

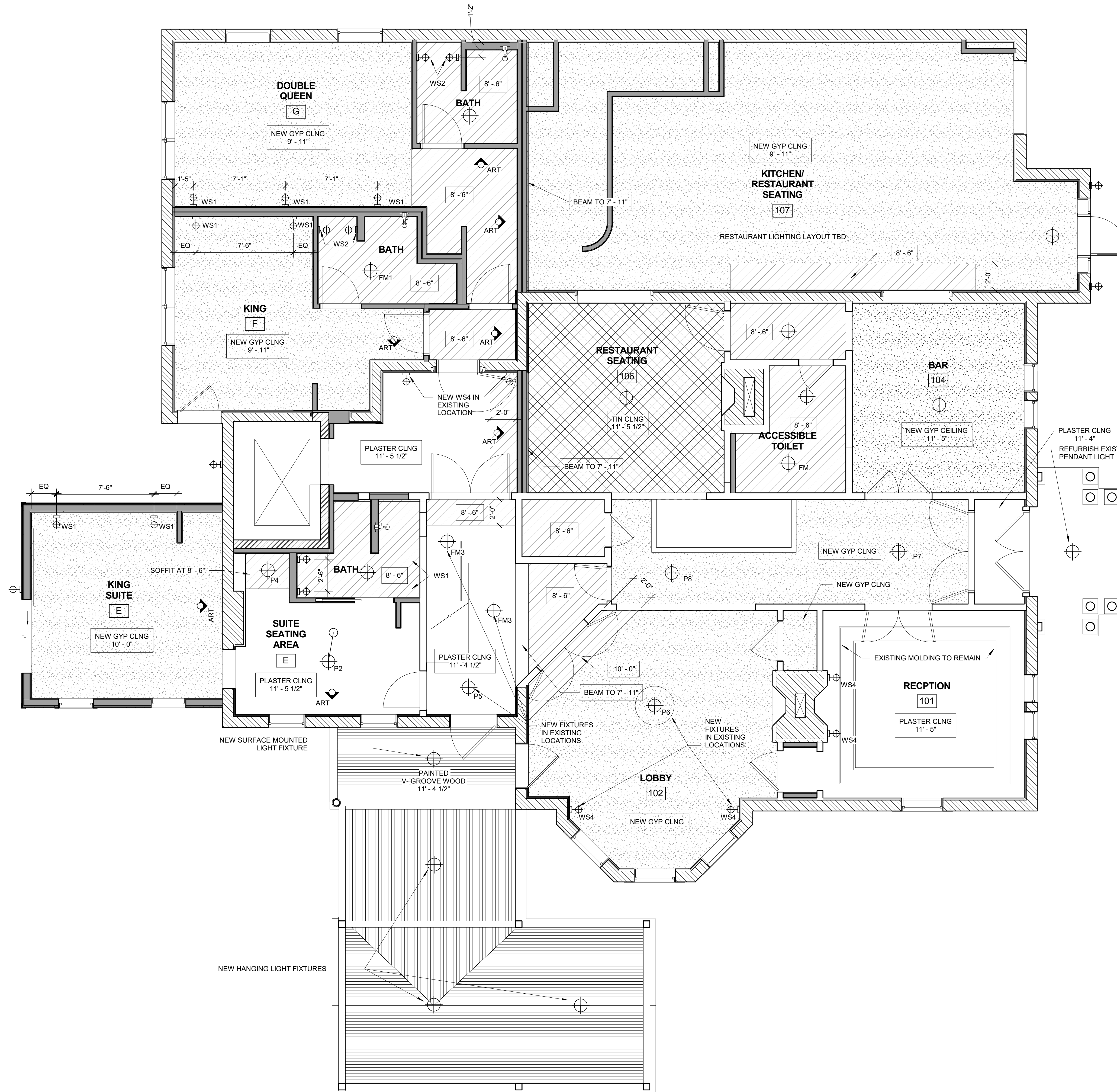

1 | 1ST FLOOR - NEW
1/4" = 1'-0"

