

Code & Life Safety Review Notes

Occupancy Classification: Assembly (A-2)

Occupant Load: 15 square feet (net) per person with moveable tables & seating= 64 Occupants

Remoteness of exits: 1/3 the minimum diagonal of the room w/ sprinklers

Fire Alarms & Signaling: per NFPA 72

Sprinklers: per NFPA 13 (new installation for entire building)

Construction Type: IIIA, Non-combustible exterior walls with combustible interior component

Separation of Occupancies

- 1-hour fire separation between basement and first floor w/ sprinklers
- 1-hour fire separation between enclosed Rear Staircase and basement level
- 1-hour fire separation between enclosed Mechanical Room and basement level
- Kitchen does not need to be separated from the Dining/Serving area
- Kitchen does not need to be separated from the Storage Group S-2 when sprinklered, per IRC 508.4

One-Hour Rated Ceilings:

Intumescent Fireproofing Paint, ForceField FireGuard E-84 by Shield Industries, Inc. at existing exposed wood ceilings (ASTM E-119)

One-Hour Rated Walls:

5/8" FireCode Type "X" GWB ea. side 2x4 studs @ 16" o.c. (UL 305)

One-Hour Rated Existing Masonry Walls:

2- to 3-wythe brick wall (similar to UL 902)

Unprotected Exterior Stairs:

Existing exterior stairs may be unprotected if serving a sprinklered space (Main Entry Stairs)

Rated Doors:

Refer to door schedule for required fire-ratings

Handrails: Provide handrails as noted on plan, per NFPA 101, Section 7.2.2.4

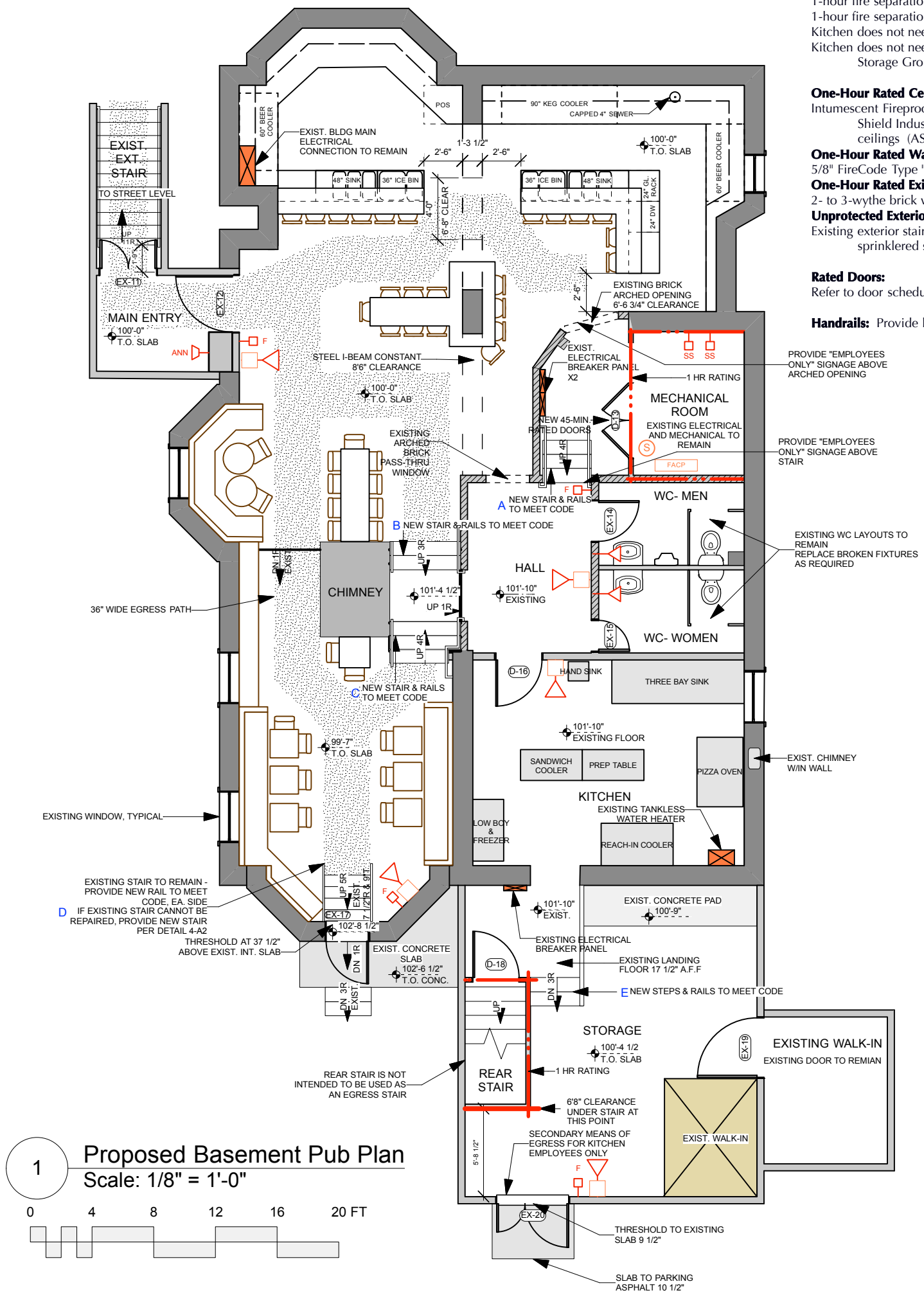

		Nominal Size			Fire Rating				
		Width	Height	Thickness	Door Operation	Frame	Door Slab	HW Set	Comments
EX-	11	3'6"	6'8"	1 3/8"	Swing Bi-part	EXIST	EXIST	EGRESS	EGRESS HARDWARE PER CODE
EX-	12	3'8"	6'8"	1 3/8"	Swing Simple	EXIST	EXIST	EGRESS	EGRESS HARDWARE PER CODE
D-	13	5'0"	6'8 3/4"	1 3/8"	Swing Bi-part	60	45	CLOSER	TACTILE WARNING LEVER
EX-	14	2'7 1/2"	6'8"	1 3/8"	Swing Simple	EXIST	EXIST	CLOSER	REPLACE DOOR LEAF IF DAMAGED
EX-	15	2'0"	6'8"	1 3/8"	Swing Simple	EXIST	EXIST	CLOSER	REPLACE DOOR LEAF IF DAMAGED
D-	16	3'0"	6'8"	1 3/8"	Swing Simple	N/A	N/A	TBD	TEMPERED VISION PANEL
EX-	17	2'9"	6'8"	1 3/8"	Swing Simple	EXIST	EXIST	EGRESS	EXISTING TO REMAIN, EGRESS HARDWARE PER CODE
D-	18	3'0"	6'8"	1 3/8"	Swing Simple	60	60	CLOSER	PROVIDE A NEW RATED DOOR AND FRAME IN EXIST. OPENING
EX-	19	3'10 1/4"	6'8"	1 3/8"	Swing Simple	EXIST	EXIST	EXIST	EXISTING TO REMAIN
EX-	20	4'9 1/2"	6'11 1/2"	1 3/8"	Swing Bi-part	EXIST	EXIST	EGRESS	EXISTING TO REMAIN, EGRESS HARDWARE PER CODE