

SECTION 1
1 1/2" = 1'-0"

NOTE: G.C. SHALL CLEAN ALL EXISTING STRUCTURAL STEEL MEMBERS FREE OF RUST, DIRT, DEBRIS, OIL, AND GREASE. ALLOW FOR ENGINEER OF RECORD TO REVIEW EXISTING STEEL TO DETERMINE IF ANY EXISTING MEMBERS HAVE BEEN COMPROMISED AND REQUIRE REPLACEMENT. ENGINEER SHALL SUPPLY SUPPLEMENTAL DIRECTIVE AND/OR DRAWING AS REQUIRED (AFTER REVIEW AND ANALYSIS) TO BE IMPLEMENTED BY G.C..

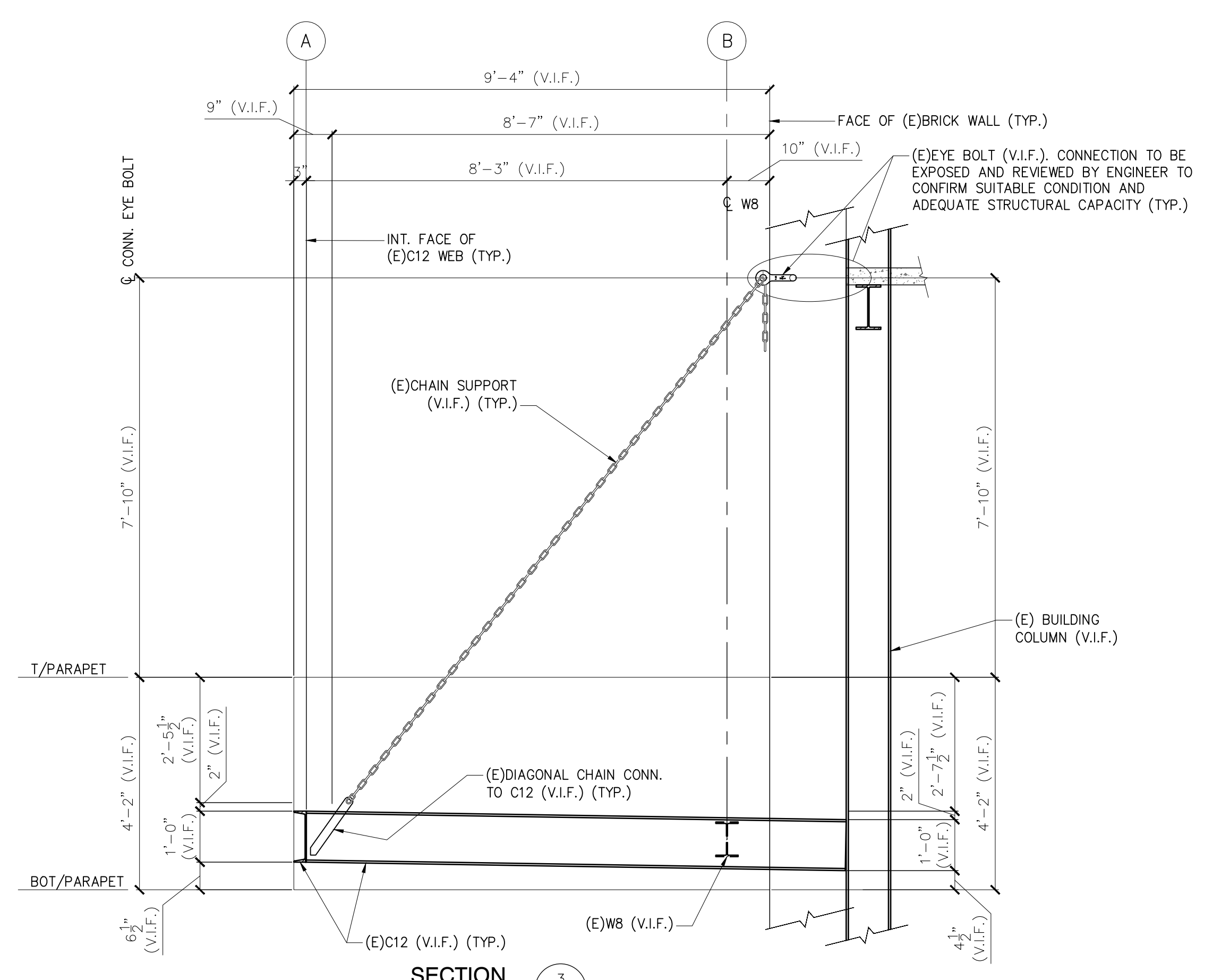

SECTION 3
1/2" = 1'-0"

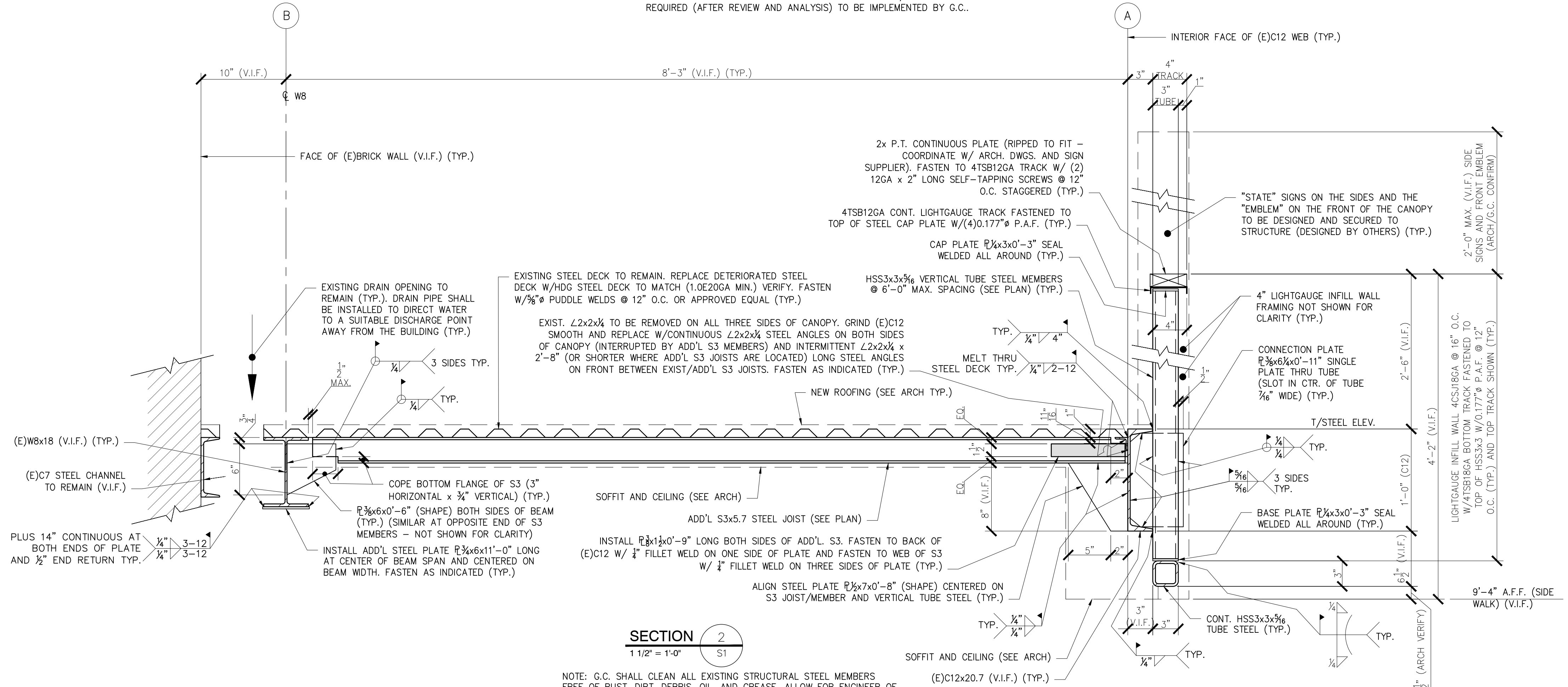

SECTION 2
1 1/2" = 1'-0"

NOTE: G.C. SHALL CLEAN ALL EXISTING STRUCTURAL STEEL MEMBERS FREE OF RUST, DIRT, DEBRIS, OIL, AND GREASE. ALLOW FOR ENGINEER OF RECORD TO REVIEW EXISTING STEEL TO DETERMINE IF ANY EXISTING MEMBERS HAVE BEEN COMPROMISED AND REQUIRE REPLACEMENT. ENGINEER SHALL SUPPLY SUPPLEMENTAL DIRECTIVE AND/OR DRAWING AS REQUIRED (AFTER REVIEW AND ANALYSIS) TO BE IMPLEMENTED BY G.C..

THESE DRAWINGS HAVE BEEN DEVELOPED BY L&L STRUCTURAL ENGINEERING SERVICES, INC. FOR THE TITLED SET ONLY. THE DRAWINGS ARE THE SOLE PROPERTY OF L&L ENGINEERING SERVICES, INC. AND THEY SHALL NOT BE USED, LENT, COPIED OR ALTERED WITHOUT THE WRITTEN CONSENT OF L&L STRUCTURAL ENGINEERING SERVICES, INC.

L & L STRUCTURAL ENGINEERING SERVICES, INC.
SIX O. STREET
SOUTH PORTLAND, MAINE 04106
PHONE: (207) 767-4830
FAX: (207) 799-5432
EMAIL: JLEASURE@L-ENG.COM

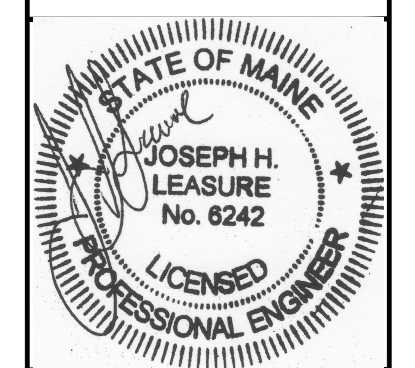

rev.	date	description	designed by	drawn by	checked by	scale	date	plot date	project #
0	4/12/17	FOR CONSTRUCTION	JHL	RAW	JHL	AS NOTED	02/10/2016	04/12/2017	2015-191

STATE THEATER
609 CONGRESS STREET
PORTLAND, MAINE
ENTRY MARQUEE CANOPY RESTORATION
ENTRY MARQUEE SECTIONS

S2