

GENERAL NOTES:

SPRINKLERS: ALL CONDENSED OR EXPOSED SPRINKLES ARE SPRINKLER SYSTEMS. THE IN-SPACE AND IN-SPACE SYSTEMS ARE SPRINKLER SYSTEMS. THE UNDERSTAGE AND OTHER SPACES, INCL. THE MAIN THEATRE, THE NEW KITCHEN, THE BATHS, AND THE LOBBIES AND HALLWAYS WILL BE SPRINKLERED AS A PART OF THIS RECONSTRUCTION. SPRINKLER DRAWINGS WILL BE SUBMITTED DIRECTLY TO ALL APPLICABLE GOVERNING AGENCIES BY THE ARCHITECT. SPRINKLER CONTRACTORS TO APPLICABLE AGENCIES.

FIRE ALARM SYSTEM: THE ENTIRE THEATRE WILL BE PROTECTED BY AN INTEGRATED F.A. SYSTEM. THE DESIGN, SPECIFICATION FOR THIS SYSTEM WILL BE SUBMITTED DIRECTLY TO ALL APPLICABLE GOVERNING AGENCIES BY THE ARCHITECT. ALL F.A. WORK SHALL BE IN ACCORDANCE WITH THE NATIONAL FIRE PROTECTION ASSOCIATION (NFPA) 72 CODE. BELL SIGNALS / EMERGENCY LIGHTS: PROVIDE ILLUMINATED EXIT SIGNS AND EMERGENCY LIGHTS IN ALL AREAS. PROVIDE EMERGENCY LIGHTS IN ALL AREAS. PROVIDE EMERGENCY LIGHTS IN ALL AREAS. PROVIDE EMERGENCY LIGHTS IN ALL AREAS.

Existing Walls
 New Walls
 Walls to be Removed

No.	Description	Date
REVISIONS		

OCCUPANT LOAD AND EXIT CAPACITY ANALYSIS 5-9-07

STATE THEATER RENOVATIONS

ORCHESTRA LEVEL PLAN

Scale: 1/8" = 1'-0"
 Date: 5/11/07
 Drawn By: HVW/9/4
 Checked By: SPM
 Approved By:
 Project No.: 03002.01
 DWG. NO.: A-1

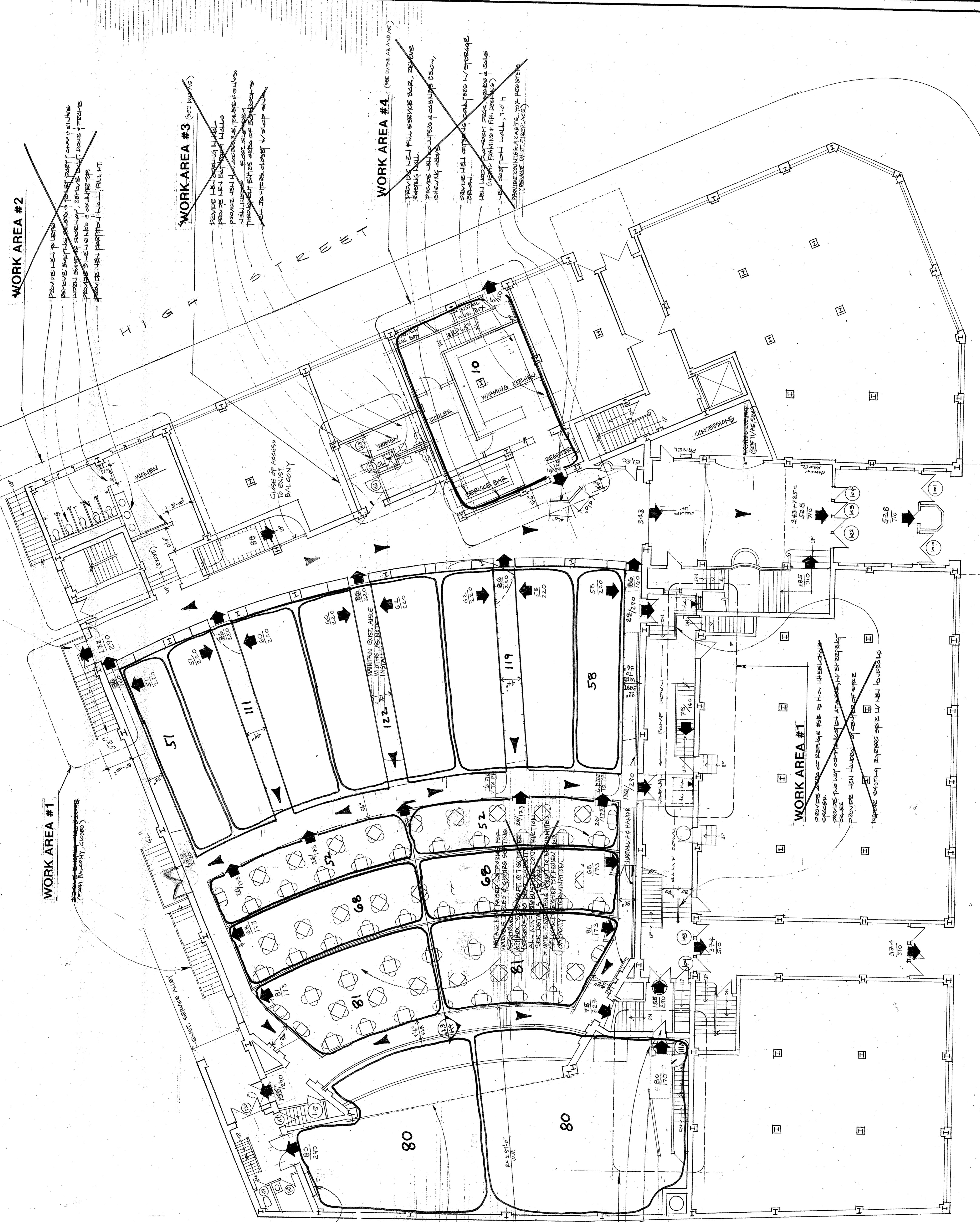

ORCHESTRA LEVEL PLAN
 SCALE: 1/8" = 1'-0"

C O N G R E S S S T R E E T