

DISPLAY THIS CARD ON PRINCIPAL FRONTAGE OF WORK

**CITY OF PORTLAND**

**PERMIT ISSUED**

BUILDING INSPECTION

**PERMIT**

Permit Number 100804  
**JUL 21 2010**

Please Read Application And Notes, If Any, Attached

This is to certify that STONE COAST PROPERTIES LLC/NG & GRILL  
has permission to "NORM'S BAR & GRILL" - 6 side seats - 4 tables and 8 chairs - 87.6 sq ft **City of Portland**  
AT 603 CONGRESS ST E 046 D031001

provided that the person or persons, firm or corporation accepting this permit shall comply with all of the provisions of the Statutes of Maine and of the Ordinances of the City of Portland regulating the construction, maintenance and use of buildings and structures, and of the application on file in this department.

Apply to Public Works for street line and grade if nature of work requires such information.

Notification of inspection must be given and written permission procured before this building or part thereof is lath or other work is used-in. 2 HOURLY NOTICE IS REQUIRED.

A certificate of occupancy must be procured by owner before this building or part thereof is occupied.

**OTHER REQUIRED APPROVALS**

Fire Dept. \_\_\_\_\_  
Health Dept. \_\_\_\_\_  
Appeal Board \_\_\_\_\_  
Other \_\_\_\_\_  
Department Name

*[Handwritten Signature]*  
Director - Building & Inspection Services

**PENALTY FOR REMOVING THIS CARD**

**City of Portland, Maine - Building or Use Permit Application**

389 Congress Street, 04101 Tel: (207) 874-8703, Fax: (207) 874-8716

Permit No: 10-0804	Issue Date:	CBL: 046 D031001
-----------------------	-------------	---------------------

Location of Construction: 603 CONGRESS ST	Owner Name: STONE COAST PROPERTIES LL	Owner Address: 142 HIGH ST STE 320	Phone:
Business Name:	Contractor Name: NORMS BAR & GRILL	Contractor Address:	Phone:
Lessee/Buyer's Name	Phone:	Permit Type: Outdoor Seating	Zone: B-3

Past Use: Commercial "NORM'S BAR & GRILL" 87.6 sq ft	Proposed Use: Commercial "NORM'S BAR & GRILL" - Outside seating 4 tables and 8 Chairs 87.6 sq ft	Permit Fee: \$254.00	Cost of Work: \$80.00	CEO District: 2
		FIRE DEPT: <input type="checkbox"/> Approved <input checked="" type="checkbox"/> Denied <i>N/A</i>	INSPECTION: Use Group: <i>U/A</i> Type: <i>Outdoor Seating</i>	

Proposed Project Description: "NORM'S BAR & GRILL" - Outside seating 4 tables and 8 Chairs 87.6 sq ft	Signature: <i>[Signature]</i>	Signature: <i>[Signature]</i>
PEDESTRIAN ACTIVITIES DISTRICT (P.A.D.)		
Action: <input type="checkbox"/> Approved <input type="checkbox"/> Approved w/Conditions <input checked="" type="checkbox"/> Denied		
Signature:	Date:	

Permit Taken By: Idobson	Date Applied For: 07/07/2010	<b>Zoning Approval</b>
-----------------------------	---------------------------------	------------------------

- This permit application does not preclude the Applicant(s) from meeting applicable State and Federal Rules.
- Building permits do not include plumbing, septic or electrical work.
- Building permits are void if work is not started within six (6) months of the date of issuance. False information may invalidate a building permit and stop all work..

<b>Special Zone or Reviews</b> <input type="checkbox"/> Shoreland <input type="checkbox"/> Wetland <input type="checkbox"/> Flood Zone <input type="checkbox"/> Subdivision <input type="checkbox"/> Site Plan Maj <input type="checkbox"/> Minor <input type="checkbox"/> MM <input type="checkbox"/> Date: <i>7/15/10</i>	<b>Zoning Appeal</b> <input type="checkbox"/> Variance <input type="checkbox"/> Miscellaneous <input type="checkbox"/> Conditional Use <input type="checkbox"/> Interpretation <input type="checkbox"/> Approved <input type="checkbox"/> Denied Date:	<b>Historic Preservation</b> <input type="checkbox"/> Not in District or Landmark <input type="checkbox"/> Does Not Require Review <input type="checkbox"/> Requires Review <input type="checkbox"/> Approved <input type="checkbox"/> Approved w/Conditions <input type="checkbox"/> Denied Date:
--------------------------------------------------------------------------------------------------------------------------------------------------------------------------------------------------------------------------------------------------------------------------------------------------------------------------------------------------	-----------------------------------------------------------------------------------------------------------------------------------------------------------------------------------------------------------------------------------------------------------------------------	-------------------------------------------------------------------------------------------------------------------------------------------------------------------------------------------------------------------------------------------------------------------------------------------------------------------------

**PERMIT ISSUED**

JUL 21 2010

City of Portland

**CERTIFICATION**

I hereby certify that I am the owner of record of the named property, or that the proposed work is authorized by the owner of record and that I have been authorized by the owner to make this application as his authorized agent and I agree to conform to all applicable laws of this jurisdiction. In addition, if a permit for work described in the application is issued, I certify that the code official's authorized representative shall have the authority to enter all areas covered by such permit at any reasonable hour to enforce the provision of the code(s) applicable to such permit.

SIGNATURE OF APPLICANT	ADDRESS	DATE	PHONE
RESPONSIBLE PERSON IN CHARGE OF WORK, TITLE		DATE	PHONE

**City of Portland, Maine - Building or Use Permit**

389 Congress Street, 04101 Tel: (207) 874-8703, Fax: (207) 874-8716

<b>Permit No:</b> 10-0804	<b>Date Applied For:</b> 07/07/2010	<b>CBL:</b> 046 D031001
------------------------------	----------------------------------------	----------------------------

<b>Location of Construction:</b> 603 CONGRESS ST	<b>Owner Name:</b> STONE COAST PROPERTIES LL	<b>Owner Address:</b> 142 HIGH ST STE 320	<b>Phone:</b>
<b>Business Name:</b>	<b>Contractor Name:</b> NORMS BAR & GRILL	<b>Contractor Address:</b>	<b>Phone:</b>
<b>Lessee/Buyer's Name</b>	<b>Phone:</b>	<b>Permit Type:</b> Outdoor Seating	

<b>Proposed Use:</b> Commercial "NORM'S BAR & GRILL" - Outside seating 4 tables and 8 Chairs 87.6 sq ft	<b>Proposed Project Description:</b> "NORM'S BAR & GRILL" - Outside seating 4 tables and 8 Chairs 87.6 sq ft
------------------------------------------------------------------------------------------------------------	-----------------------------------------------------------------------------------------------------------------

<b>Dept:</b> Zoning	<b>Status:</b> Approved	<b>Reviewer:</b> Marge Schmuckal	<b>Approval Date:</b> 07/15/2010
<b>Note:</b>			<b>Ok to Issue:</b> <input checked="" type="checkbox"/>
<b>Dept:</b> Building	<b>Status:</b> Approved with Conditions	<b>Reviewer:</b> Tammy Munson	<b>Approval Date:</b> 07/21/2010
<b>Note:</b>			<b>Ok to Issue:</b> <input checked="" type="checkbox"/>
1) The outside dining permit is approved for the area delineated at the inspection and stated on the permit, and must be kept on site. THIS PERMIT MUST BE RENEWED ANNUALY 2) The tables and chairs must not block any means of egress of any building, even during storage. 3) This permit approves outside seating only. Any alcohol or entertainment in this space requires licensing approvals from the City Clerk.			

<b>Comments:</b> 7/15/2010-mes: returned to Lannie
-------------------------------------------------------



100804

# Outdoor Dining Permit Application

If you or the property owner owes real estate or personal property taxes or user charges on any property within the City, payment arrangements must be made before permits of any kind are accepted.

<input checked="" type="checkbox"/> New Application for Outside Dining <input type="checkbox"/> Renewal Application for Outside Dining			<i>passed - see email</i> City Clerk signature for liquor license approval: <u>July 19<sup>th</sup>, 2010</u> or Pending Council Date <u>DM</u>	
Location/Address of Outdoor Seating:				
Total Square Footage of Proposed Seating Area <sup>1</sup>			Square Footage of Lot	
Tax Assessor's Chart, Block & Lot		Phone#:	Owner:	
Chart# <u>46</u>	Block# <u>D</u>	Lot# <u>31</u>	<u>828-9944</u>	<u>NORMAN J 767R</u>
Applicant * <b>must</b> be owner or Lessee		Lessee/Buyer's Name:		Annual Fee: <b>\$80</b>
Name: <u>Norm Jabar, Deb Hanville</u>		(If Applicable) <u>N/A</u>		Total Sq. Ft. <u>108</u>
Address: <u>617 Congress</u>				Sq. Ft. Fee: \$
City, State & Zip: <u>Portland</u> <u>04101</u>				Total Fee: \$
<b>RECEIVED</b>				
Current use: <u>Restaurant</u>				
Business name: <u>Norm's Bar + Grill</u> <span style="float: right;">JUL - 7 2010</span>				
Seating area dimensions:				
How many chairs? <u>0</u>		How many tables? <u>4</u>		Dept. of Building Inspections City of Portland Maine
<input checked="" type="checkbox"/> Yes Alcohol is served.				
<input type="checkbox"/> No Alcohol being served.				
Who should we contact for the pre-inspection: <u>Norm Jabar, Deb Hanville</u>				
Mailing address: <u>617 Congress</u>		Phone: <del>711-7650</del> <u>828-9944</u>		

Please submit all of the information outlined in the Outdoor Dining Application Checklist. Failure to do so will result in the automatic denial of your permit.

In order to be sure the City fully understands the full scope of the project, the Planning and Development Department may request additional information prior to the issuance of a permit. For further information visit us on-line at [www.portlandmaine.gov](http://www.portlandmaine.gov), stop by the Building Inspections office, room 315 City Hall or call 874-8703.

I hereby certify that I am the Owner of record of the named property, or that the owner of record authorizes the proposed work and that I have been authorized by the owner to make this application as his/her authorized agent. I agree to conform to all applicable laws of this jurisdiction. In addition, if a permit for work described in this application is issued, I certify that the Code Official's authorized representative shall have the authority to enter all areas covered by this permit at any reasonable hour to enforce the provisions of the codes applicable to this permit.

Signature of Applicant: [Signature]

Date: 7/2/10

<sup>1</sup> In no instance shall the total square footage of dining area equal more than 10% of park space, unless the applicant receives a waiver from the Director of Parks and Recreation or his or her designee. **This is not a permit; you may not commence ANY work until the permit is issued.**

**CITY OF PORTLAND**  
**DEPARTMENT OF PLANNING & URBAN DEVELOPMENT**

389 Congress Street  
 Portland, Maine 04101

**INVOICE FOR PERMIT FEES**

<b>Application No:</b> 10-0804	<b>Applicant:</b> STONE COAST PROPERTIES LLC
<b>Project Name:</b> "NORM'S BAR & GRILL" - Outsid	<b>Location:</b> 603 CONGRESS ST
<b>CBL:</b> 046 D031001	<b>Development Type:</b>
<b>Invoice Date:</b> 07/07/2010	

<b>Previous Balance</b>	-	<b>Payment Received</b>	+	<b>Current Fees</b>	-	<b>Current Payment</b>	=	<b>Total Due</b>	<b>Payment Due Date</b>
\$0.00		\$0.00		\$254.00		\$80.00		\$174.00	On Receipt

**First Billing**

**Previous Balance** **\$0.00**

<u>Fee Description</u>	<u>Qty</u>	<u>Fee/Deposit Charge</u>		
Outside Seating Sidewalk	87	\$174.00		
Outside Seating	1	\$80.00		
		<u>\$254.00</u>		
			<b>Total Current Fees:</b>	<b>+\$254.00</b>
			<b>Total Current Payments:</b>	<b>-\$80.00</b>
			<b>Amount Due Now:</b>	<b>\$174.00</b>

-----  
 Detach and remit with payment

**Bill to:** STONE COAST PROPERTIES LLC  
 142 HIGH ST STE 320  
 PORTLAND, ME 04101

CBL 046 D031001  
**Application No:** 10-0804  
**Invoice Date:** 07/07/2010  
**Invoice No:** 37791  
**Total Amt Due:** \$174.00  
**Payment Amount:**

Make checks payable to the *City of Portland*, ATTN: Inspections, 3rd Floor, 389 Congress Street, Portland, ME 04101.

**Tammy Munson - Re: Norm's ?**

**From:** Alexandra Murphy  
**To:** Tammy Munson  
**Date:** 7/20/2010 9:27 AM  
**Subject:** Re: Norm's ?

can be issued. passed by Council last night.

Alexandra J. P. Murphy  
Business License Administrator  
City Clerk Department  
389 Congress Street  
Portland, ME 04101  
(207) 874-8557 phone  
(207) 874-8612 fax

>>> Tammy Munson 7/20/2010 9:13 AM >>>  
Norm's?



# OUTDOOR DINING PERMIT CHECKLIST

Permits are required for expanding food service establishments to the outside on City Property. The annual fee is \$80.00 plus \$2.00 per square foot of dining area on streets, sidewalks or other public ways and \$80.00 plus \$6.00 per square foot of dining area in city parks. For purposes of fee calculation, the area abutting the buildings which border Monument Square and extending ten (10) feet from the facade of said buildings shall be considered a sidewalk. The ten (10) foot area shall be measured from that portion of the facade that protrudes furthest into the sidewalk. The area beyond the ten (10) foot sidewalk shall be considered park space.

Outdoor dining is permitted year round under the permit; however, furniture must be removed in inclement weather to allow for sidewalk snow removal. **The permit must be renewed each year.**

All of the following information is required and must be submitted. You will also be required to fill out an Outdoor Dining Permit Application.

## **A plot plan is required and must include:**

- A drawing of the lot, where the building sits on the lot along with the lot and building dimensions
- The dimensional setback from the sidewalk to the building
- The location of the street, and if it's a corner lot, the intersecting streets
- The sidewalk along with its width and curbing location
- The location of the table and chair placement, including dimensions  
(NOTE: there must be a minimum of four feet of open sidewalk from the outer boundary of the seating area to the curb, and a minimum of five feet on corners, and egress from the building must be maintained free of obstruction per the building code and NFPA Life Safety Code).

## **Additional Requirements:**

- The permit holder is required to produce, at the time of submission, and maintain public liability insurance coverage in an amount of not less than four hundred thousand dollars (\$400,000) combined single limit for bodily injury, death and property damage, naming the City as an additional insured thereon.

## **All permits for outdoor dining are issued subject to the following conditions:**

- The tables and chairs must be placed within the permitted area on the sidewalk in such a manner as to allow the free and safe passage of pedestrian traffic. If the tables and chairs are moved and located outside of the permitted outdoor seating area, they must be relocated to within the permitted area. Failure to contain the tables and chairs to the permitted area may result in a reduced permitted area or a revocation of the permit.



# CERTIFICATE OF LIABILITY INSURANCE

OP ID LH

DATE (MM/DD/YYYY)

07/08/10

THIS CERTIFICATE IS ISSUED AS A MATTER OF INFORMATION ONLY AND CONFERS NO RIGHTS UPON THE CERTIFICATE HOLDER. THIS CERTIFICATE DOES NOT AFFIRMATIVELY OR NEGATIVELY AMEND, EXTEND OR ALTER THE COVERAGE AFFORDED BY THE POLICIES BELOW. THIS CERTIFICATE OF INSURANCE DOES NOT CONSTITUTE A CONTRACT BETWEEN THE ISSUING INSURER(S), AUTHORIZED REPRESENTATIVE OR PRODUCER, AND THE CERTIFICATE HOLDER.

**IMPORTANT:** If the certificate holder is an ADDITIONAL INSURED, the policy(ies) must be endorsed. If SUBROGATION IS WAIVED, subject to the terms and conditions of the policy, certain policies may require an endorsement. A statement on this certificate does not confer rights to the certificate holder in lieu of such endorsement(s).

<b>PRODUCER</b>  NEBIG Auburn/D Branch 232 Center St Suite D-2 Auburn ME 04210 Phone:207-786-0417 Fax:207-777-5827	<b>CONTACT NAME:</b>		
	<b>PHONE (A/C, No, Ext):</b>	<b>FAX (A/C, No):</b>	
<b>E-MAIL ADDRESS:</b>			
<b>PRODUCER CUSTOMER ID #: NORMS-2</b>			
<b>INSURED</b>  Norm's Bar & Grill Inc 617 Congress St Portland ME 04101	<b>INSURER(S) AFFORDING COVERAGE</b>		<b>NAIC #</b>
	<b>INSURER A: Patriot Insurance CL</b>		<b>32069</b>
	<b>INSURER B:</b>		
	<b>INSURER C:</b>		
	<b>INSURER D:</b>		
	<b>INSURER E:</b>		
<b>INSURER F:</b>			

**COVERAGES**                      **CERTIFICATE NUMBER:**                      **REVISION NUMBER:**

THIS IS TO CERTIFY THAT THE POLICIES OF INSURANCE LISTED BELOW HAVE BEEN ISSUED TO THE INSURED NAMED ABOVE FOR THE POLICY PERIOD INDICATED. NOTWITHSTANDING ANY REQUIREMENT, TERM OR CONDITION OF ANY CONTRACT OR OTHER DOCUMENT WITH RESPECT TO WHICH THIS CERTIFICATE MAY BE ISSUED OR MAY PERTAIN, THE INSURANCE AFFORDED BY THE POLICIES DESCRIBED HEREIN IS SUBJECT TO ALL THE TERMS, EXCLUSIONS AND CONDITIONS OF SUCH POLICIES. LIMITS SHOWN MAY HAVE BEEN REDUCED BY PAID CLAIMS.

INSR LTR	TYPE OF INSURANCE	ADDL SURR INSR	WVD	POLICY NUMBER	POLICY EFF (MM/DD/YYYY)	POLICY EXP (MM/DD/YYYY)	LIMITS
A	<input checked="" type="checkbox"/> GENERAL LIABILITY <input checked="" type="checkbox"/> COMMERCIAL GENERAL LIABILITY <input type="checkbox"/> CLAIMS-MADE <input checked="" type="checkbox"/> OCCUR	X		CPP6111920	06/15/10	06/15/11	EACH OCCURRENCE \$ 1000000
	GEN'L AGGREGATE LIMIT APPLIES PER: <input type="checkbox"/> POLICY <input type="checkbox"/> PRO-JECT <input type="checkbox"/> LOC						DAMAGE TO RENTED PREMISES (Ea occurrence) \$ 500000 MED EXP (Any one person) \$ 5000 PERSONAL & ADV INJURY \$ 1000000 GENERAL AGGREGATE \$ 2000000 PRODUCTS - COMP/OP AGG \$ 2000000 \$
	AUTOMOBILE LIABILITY <input type="checkbox"/> ANY AUTO <input type="checkbox"/> ALL OWNED AUTOS <input type="checkbox"/> SCHEDULED AUTOS <input type="checkbox"/> HIRED AUTOS <input type="checkbox"/> NON-OWNED AUTOS						COMBINED SINGLE LIMIT (Ea accident) \$ BODILY INJURY (Per person) \$ BODILY INJURY (Per accident) \$ PROPERTY DAMAGE (Per accident) \$ \$ \$
	UMBRELLA LIAB <input type="checkbox"/> OCCUR EXCESS LIAB <input type="checkbox"/> CLAIMS-MADE DEDUCTIBLE \$ RETENTION \$						EACH OCCURRENCE \$ AGGREGATE \$ \$ \$
	WORKERS COMPENSATION AND EMPLOYERS' LIABILITY ANY PROPRIETOR/PARTNER/EXECUTIVE OFFICER/MEMBER EXCLUDED? <input type="checkbox"/> Y/N (Mandatory in NH) If yes, describe under DESCRIPTION OF OPERATIONS below		N/A				WC STAT'L TORY LIMITS <input type="checkbox"/> OTH-ER E.L. EACH ACCIDENT \$ E.L. DISEASE - EA EMPLOYEE \$ E.L. DISEASE - POLICY LIMIT \$

DESCRIPTION OF OPERATIONS / LOCATIONS / VEHICLES (Attach ACORD 101, Additional Remarks Schedule, if more space is required)  
 Certificate holder is additional insured

<b>CERTIFICATE HOLDER</b>  City of Portland Fax # 874-8716 Lannie Dobson 389 Congress Street Portland ME 04101	<b>CANCELLATION</b>  SHOULD ANY OF THE ABOVE DESCRIBED POLICIES BE CANCELLED BEFORE THE EXPIRATION DATE THEREOF, NOTICE WILL BE DELIVERED IN ACCORDANCE WITH THE POLICY PROVISIONS.  AUTHORIZED REPRESENTATIVE  
----------------------------------------------------------------------------------------------------------------------------------	------------------------------------------------------------------------------------------------------------------------------------------------------------------------------------------------------------------------------------



# NORMS Bar + Grill

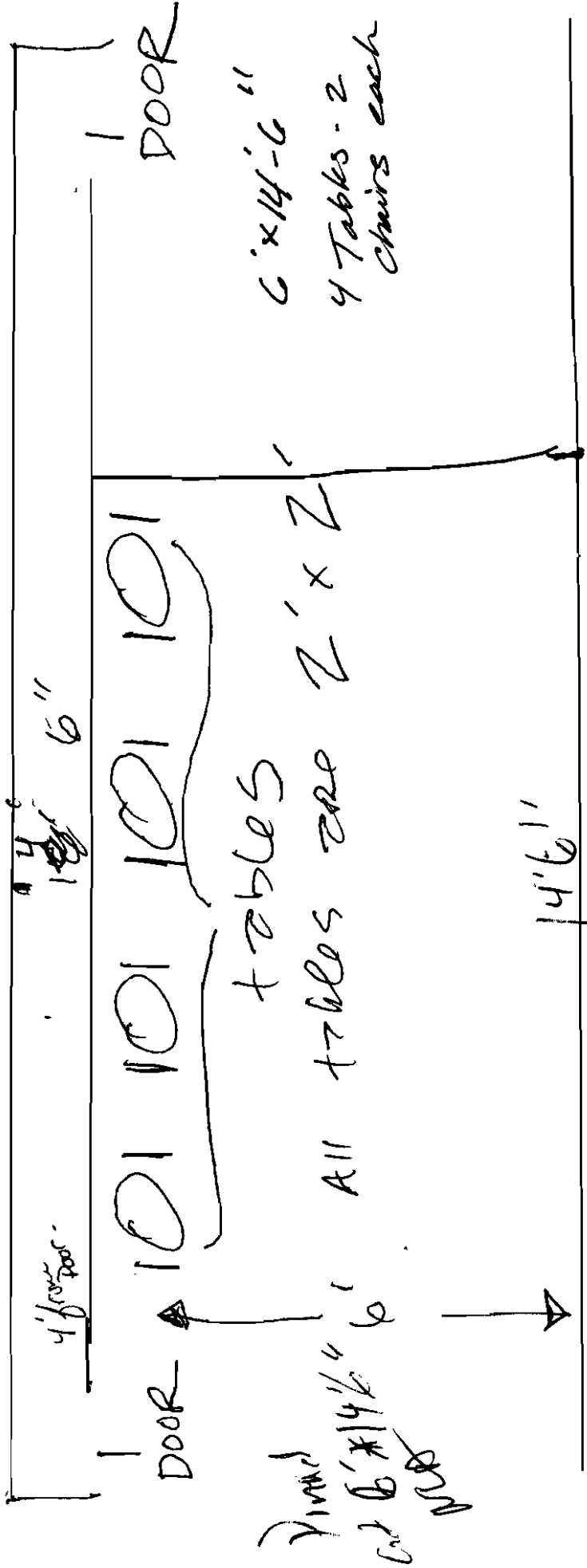

total sq ft. 108'

SIDE WALL

CITY OF PORTLAND APPROVED CONSTRUCTION PLANS
JUL 14 2010
SUBMITTED BY: [unclear] PRIOR DATE: [unclear]