

CODE NOTES:
 MAIN CONCOURSE AREA: 13,810 SF
 MAIN CONCOURSE
 FIRST TIER: 268 SEATED ON 330 STANDING
 SECOND TIER: 148 PERSONS SEATED
 BALCONY PORTION: 300 PERSONS SEATED
 LOWER BAR: 84 PERSONS FLEX SEATING
 UPPER BAR: 84 PERSONS FLEX SEATING
 TOTAL MAIN AUDIENCE: 1011-1088 PERSONS
 EXITING CAPACITY: 183

CODE NOTES:
 MAIN LEVEL: 1088 PERSONS
 BALCONY: 572 PERSONS
 TOTAL OCCUPANCY: 1660 PERSONS

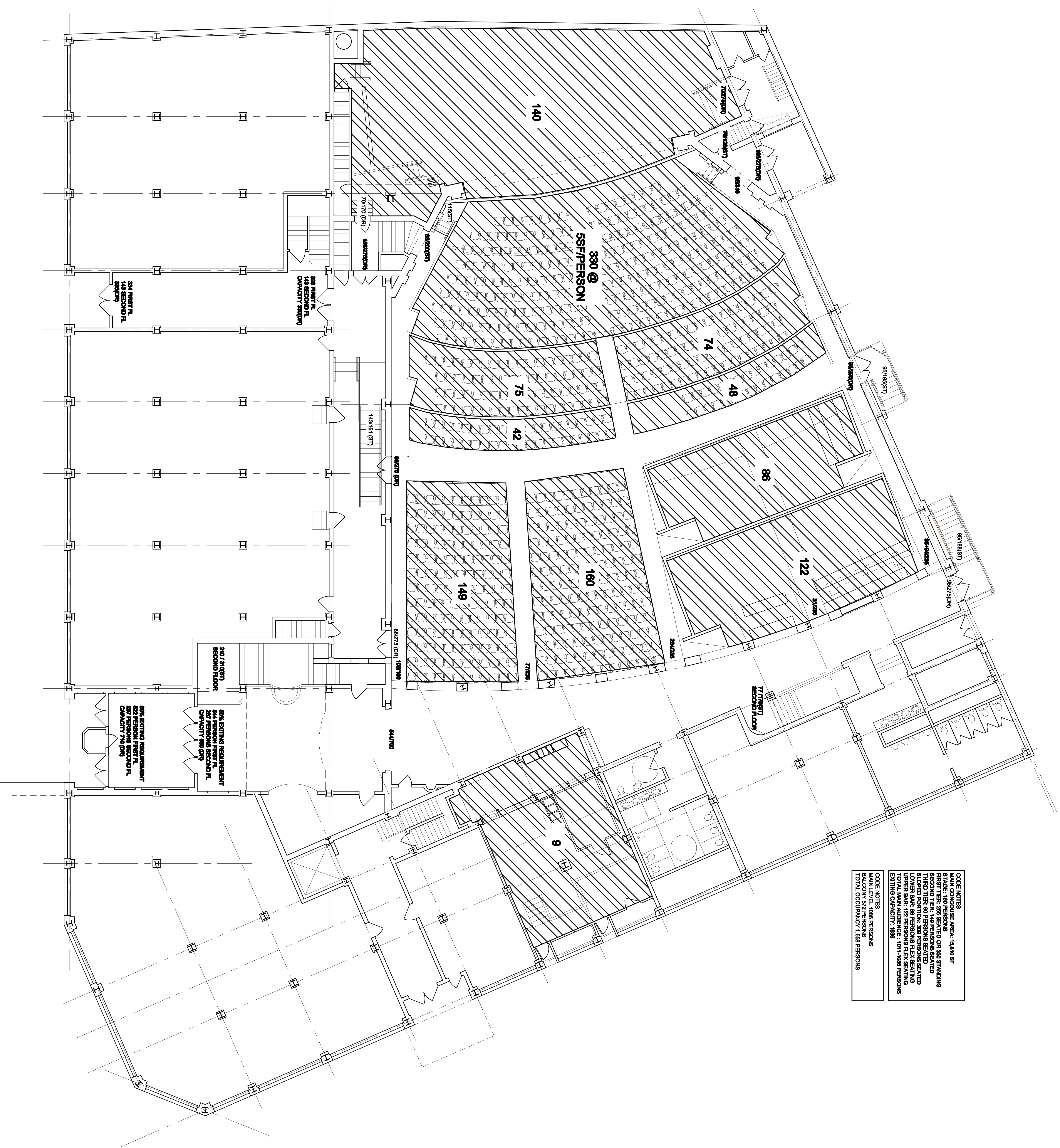

GENERAL NOTE:
 THIS DRAWING IS BEING DISTRIBUTED FOR USE AS A BASE PLAN FOR THE ADOPTED SEATING PLAN. SEATING SHALL BE VERIFIED IN THE FIELD BY OTHERS BEFORE FINAL SEAT ORDER IS PLACED.

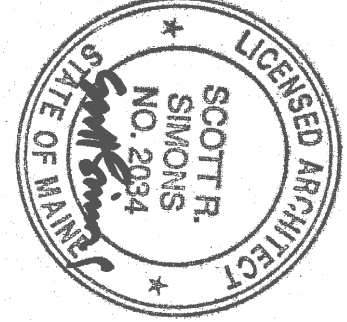

PROJECT NAME:
 STATE THEATER

INTERIOR CONSULTANTS:
 AND CONCEPT DESIGNERS
 PORTLAND, MAINE 04101

SCALE:

THIS DRAWING IS THE PROPERTY OF SCOTT STAVENIS ARCHITECTS AND SHALL REMAIN THE PROPERTY OF SCOTT STAVENIS ARCHITECTS. ANY REPRODUCTION OR DISTRIBUTION OF THIS DRAWING WITHOUT THE WRITTEN PERMISSION OF SCOTT STAVENIS ARCHITECTS IS STRICTLY PROHIBITED.

NO.	DATE	DATE
1		
2		
3		
4		
5		
6		

DATE OF ISSUE: JULY 15, 2010
 PROJECT NUMBER: STATE THEATER
 DRAWING NUMBER: CONSTRUCTION DRAWING

**FIRST FLOOR PLAN
 EXITING**

A101EX