

C1 HIGH ST. ALLEY EXTERIOR STAIR ELEVATION
SCALE: 1/4" = 1'-0"

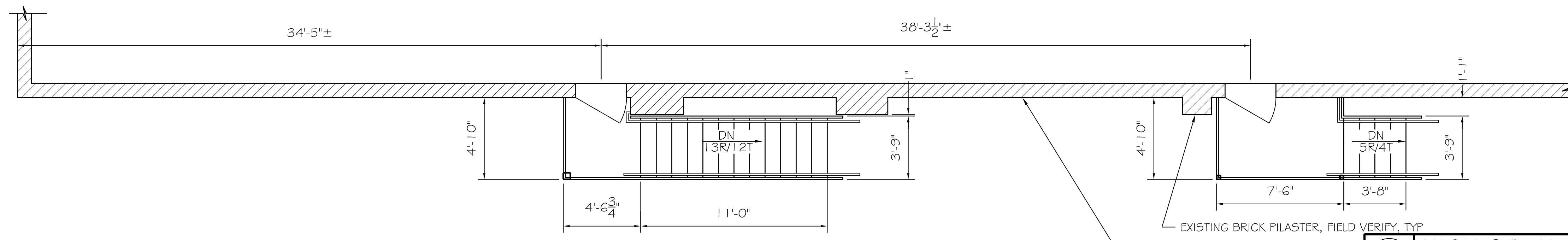

B1 HIGH ST. ALLEY EXTERIOR STAIR PLAN - LOWER LEVEL
SCALE: 1/4" = 1'-0"

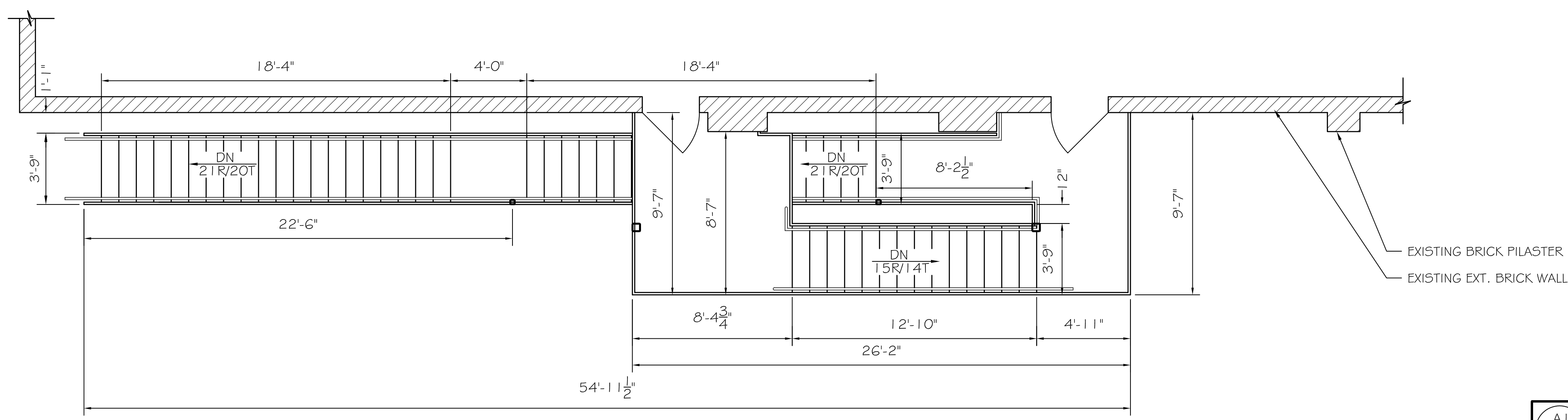

A1 HIGH ST. ALLEY EXTERIOR STAIR PLAN - UPPER LEVEL
SCALE: 1/4" = 1'-0"

ASSOCIATED DESIGN PARTNERS INC.
Office: (207) 878-1751
80 Leighton Road
Falmouth, Maine 04105
Fax: (207) 878-1788
E-Mail: adp@adpengineering.com

THIS DRAWING, DESIGN AND ELECTRONIC FILE ARE THE PROPERTY OF ASSOCIATED DESIGN PARTNERS, INC. THE REPRODUCTION, COPYING OR ANY OTHER USE OF THIS DOCUMENT WITHOUT WRITTEN CONSENT IS PROHIBITED.

PROJECT: **STATE THEATER**
609 CONGRESS ST, PORTLAND ME
FOR: GRANT WILSON
SHEET TITLE: **REPLACEMENT FIRE ESCAPE PLANS AND ELEVATIONS**

No.	BY	REVISIONS	DATE
1	ASW	ISSUED FOR PRICING	3/8/06
2	ASW	ISSUED FOR FIRE MARSHALL REVIEW	4/7/06
3	ASW	ISSUED FOR PRICING	

DATE : 03-08-06
SCALE : AS NOTED
DESIGN BY: ASW
DRAWN BY: NR
FILE #: 05247-A101.DWG
PROJECT NUMBER:
05247
SHEET NO.:
A101