

ADDENDUM # 2

shinberg
CONSULTING, LLC

F1.00
6/15/09

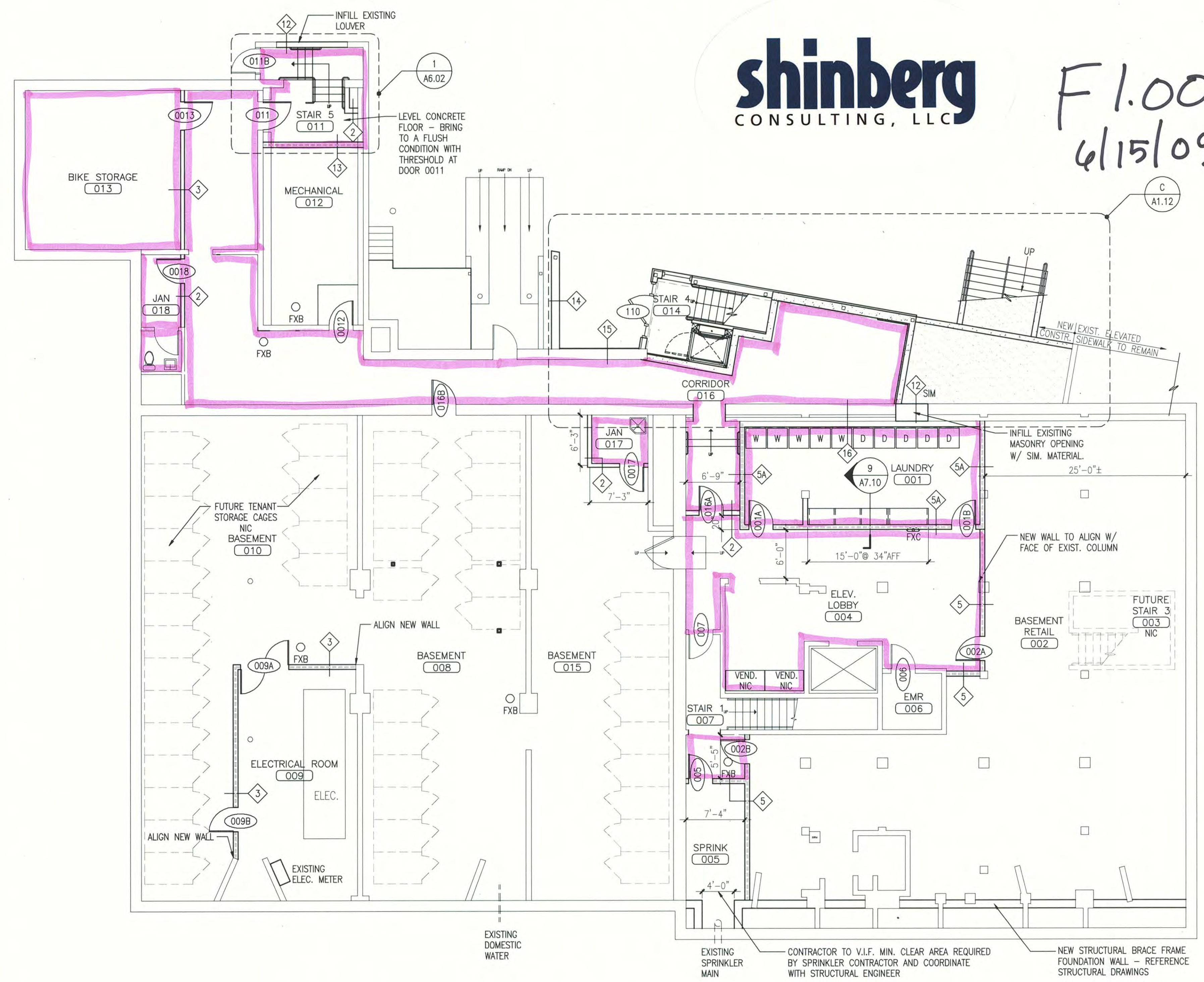

- ORANGE DROP 5/8" DRYWALL CEILING 4" DOWN FROM EXISTING ("CHICAGO STYLE")
- BLUE INSTALL 5/8" DRYWALL DIRECTLY TO EXISTING CEILING
- GREEN INSTALL 2'x2' ACT TO BE ARMSTRONG #1775 DUNE (OR EQUAL) CLIMAPLUS CIRrus w/ 9/16" SUPRAFINE GRID
- PINK INSTALL 2'x4' ACT TO BE ARMSTRONG SQUARE EDGE PANELS CLEAN ROOM VL (OR EQUAL) w/ 1/16" GRID

