

940040

 Permit # \_\_\_\_\_ City of Portland BUILDING PERMIT APPLICATION Fee \$25. Zone \_\_\_\_\_ Map # \_\_\_\_\_ Lot# \_\_\_\_\_

Please fill out any part which applies to job. Proper plans must accompany form.

Owner: JOAN Alears Phone # 799-7916  
 Address: 20 Ramble Rd- Cape Elizabeth, ME 04107  
 LOCATION OF CONSTRUCTION 12 Deering St.  
 Contractor: Hap Cleary Sub.: 799-7916  
 Address: Box 6608 - Ptld, ME Phone # 04101  
 Est. Construction Cost: \$800 Proposed Use: 15-fam dwlg  
 Past Use: 15-fam  
 # of Existing Res. Units \_\_\_\_\_ # of New Res. Units \_\_\_\_\_  
 Building Dimensions L \_\_\_\_\_ W \_\_\_\_\_ Total Sq. Ft. \_\_\_\_\_  
 # Stories: \_\_\_\_\_ # Bedrooms \_\_\_\_\_ Lot Size: \_\_\_\_\_  
 Is Proposed Use: Seasonal \_\_\_\_\_ Condominium \_\_\_\_\_ Conversion \_\_\_\_\_  
 Explain Conversion Interior renovations - closet; 2nd fl

## For Official Use Only

Date 1/6/93 Subdivision: \_\_\_\_\_  
 Inside Fire Limits \_\_\_\_\_ Name \_\_\_\_\_  
 Bldg Code \_\_\_\_\_ Lot JAN 19 1991  
 Time Limit \_\_\_\_\_ Ownership: \_\_\_\_\_ Public \_\_\_\_\_ Private \_\_\_\_\_  
 Estimated Cost 800

## Zoning:

Street Frontage Provided: \_\_\_\_\_  
 Provided Setbacks: Front \_\_\_\_\_ Back \_\_\_\_\_ Side \_\_\_\_\_ Side \_\_\_\_\_

## Review Required:

Zoning Board Approval: Yes \_\_\_\_\_ No \_\_\_\_\_ Date: \_\_\_\_\_  
 Planning Board Approval: Yes \_\_\_\_\_ No \_\_\_\_\_ Date: \_\_\_\_\_  
 Conditional Use: \_\_\_\_\_ Variance \_\_\_\_\_ Site Plan \_\_\_\_\_ Subdivision \_\_\_\_\_  
 Shoreland Zoning Yes \_\_\_\_\_ No \_\_\_\_\_ Floodplain Yes \_\_\_\_\_ No \_\_\_\_\_  
 Special Exception \_\_\_\_\_  
 Other (Explain) WHD-1-13-94

## Foundation:

1. Type of Soil: \_\_\_\_\_
2. Set Backs - Front \_\_\_\_\_ Rear \_\_\_\_\_ Side(s) \_\_\_\_\_
3. Footings Size: \_\_\_\_\_
4. Foundation Size: \_\_\_\_\_
5. Other \_\_\_\_\_

## Floor:

1. Sills Size: \_\_\_\_\_ Sills must be anchored.
2. Girder Size: \_\_\_\_\_
3. Lally Column Spacing: \_\_\_\_\_ Size: \_\_\_\_\_
4. Joists Size: \_\_\_\_\_ Spacing 16" O.C.
5. Bridging Type: \_\_\_\_\_ Size: \_\_\_\_\_
6. Floor Sheathing Type: \_\_\_\_\_ Size: \_\_\_\_\_
7. Other Material: \_\_\_\_\_

## Exterior Walls:

1. Studding Size \_\_\_\_\_ Spacing \_\_\_\_\_
2. No. windows \_\_\_\_\_
3. No. Doors \_\_\_\_\_
4. Header Sizes \_\_\_\_\_ Span(s) \_\_\_\_\_
5. Bracing: Yes \_\_\_\_\_ No \_\_\_\_\_
6. Corner Posts Size \_\_\_\_\_
7. Insulation Type \_\_\_\_\_ Size \_\_\_\_\_
8. Sheathing Type \_\_\_\_\_ Size \_\_\_\_\_
9. Siding Type \_\_\_\_\_ Weather Exposure \_\_\_\_\_
10. Masonry Materials \_\_\_\_\_
11. Metal Materials \_\_\_\_\_

## Interior Walls:

1. Studding Size \_\_\_\_\_ Spacing \_\_\_\_\_
2. Header Sizes \_\_\_\_\_ Span(s) \_\_\_\_\_
3. Wall Covering Type \_\_\_\_\_
4. Fire Wall if required \_\_\_\_\_
5. Other Materials \_\_\_\_\_

## Ceiling:

1. Ceiling Joists Size: \_\_\_\_\_
2. Ceiling Strapping Size \_\_\_\_\_ Spacing \_\_\_\_\_
3. Type Ceilings: \_\_\_\_\_
4. Insulation Type \_\_\_\_\_ Size \_\_\_\_\_
5. Ceiling Height: \_\_\_\_\_

## Roof:

1. Truss or Rafter Size \_\_\_\_\_ Span \_\_\_\_\_
2. Sheathing Type \_\_\_\_\_ Size \_\_\_\_\_
3. Roof Covering Type \_\_\_\_\_

## Chimneys:

Type: \_\_\_\_\_ Number of Fire Places 1/11/94

## Heating:

Type of Heat: \_\_\_\_\_

## Electrical:

Service Entrance Size: \_\_\_\_\_ Smoke Detector Required Yes \_\_\_\_\_ No \_\_\_\_\_

## Plumbing:

1. Approval of soil test if required Yes \_\_\_\_\_ No \_\_\_\_\_
2. No. of Tubs or Showers \_\_\_\_\_
3. No. of Flushes \_\_\_\_\_
4. No. of Lavatories \_\_\_\_\_
5. No. of Other Fixtures \_\_\_\_\_

## Swimming Pools:

1. Type: \_\_\_\_\_
2. Pool Size: \_\_\_\_\_ x \_\_\_\_\_ Square Footage \_\_\_\_\_
3. Must conform to National Electrical Code and State Law.

Permit Received By Louise E. Chase

Signature of Applicant Hap Cleary Date \_\_\_\_\_

CEO's District 5

CONTINUED TO REVERSE SIDE

Ivory Tag - CEO

White - Tax Assessor

 PERMIT ISSUED  
 WITH REQUIREMENTS

 PERMIT ISSUED  
 WITH REQUIREMENTS

15 MAR 1993

FROM APARTMENT

EXISTING WALL FRAMED WITH  
2" BY 4" ON THE "FLAT"

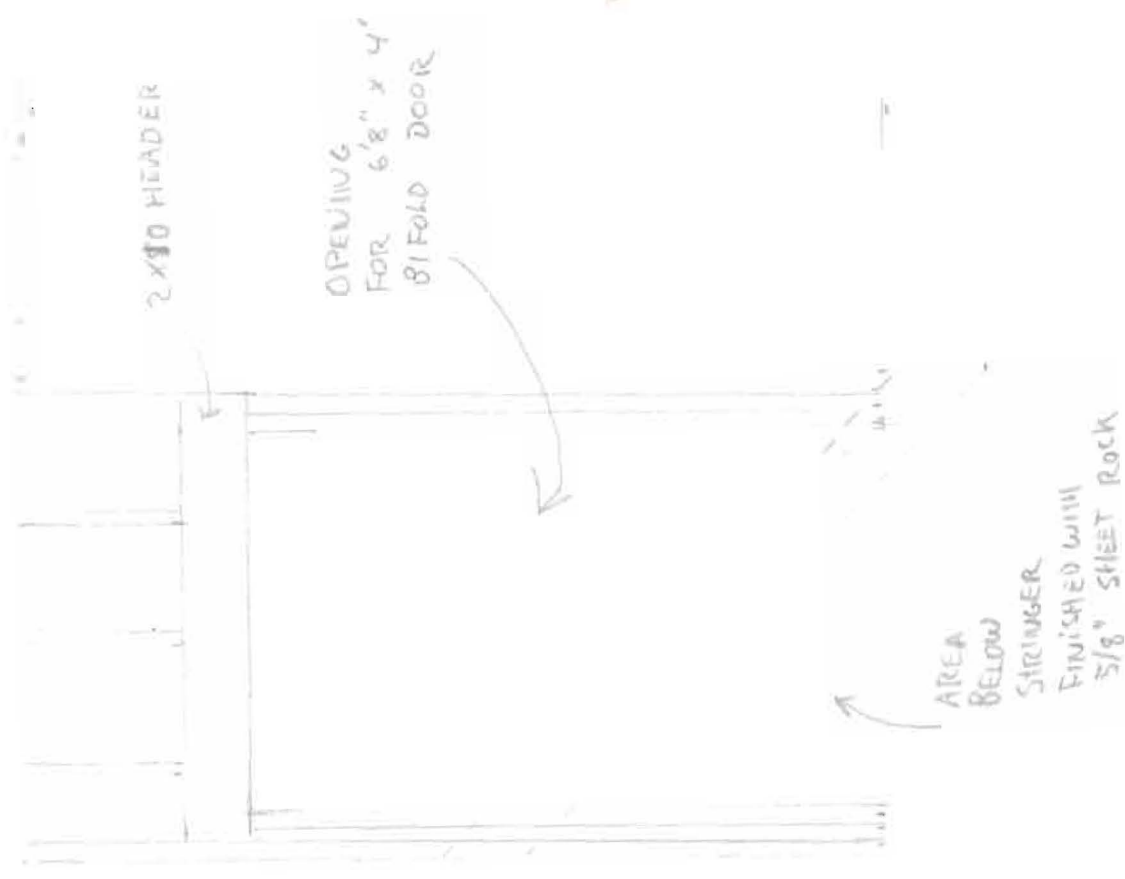

EXIT TO  
HALL



SECTIONAL VIEW  
THROUGH STAIRWELL

STAIR  
WELL  
WIDTH 35"

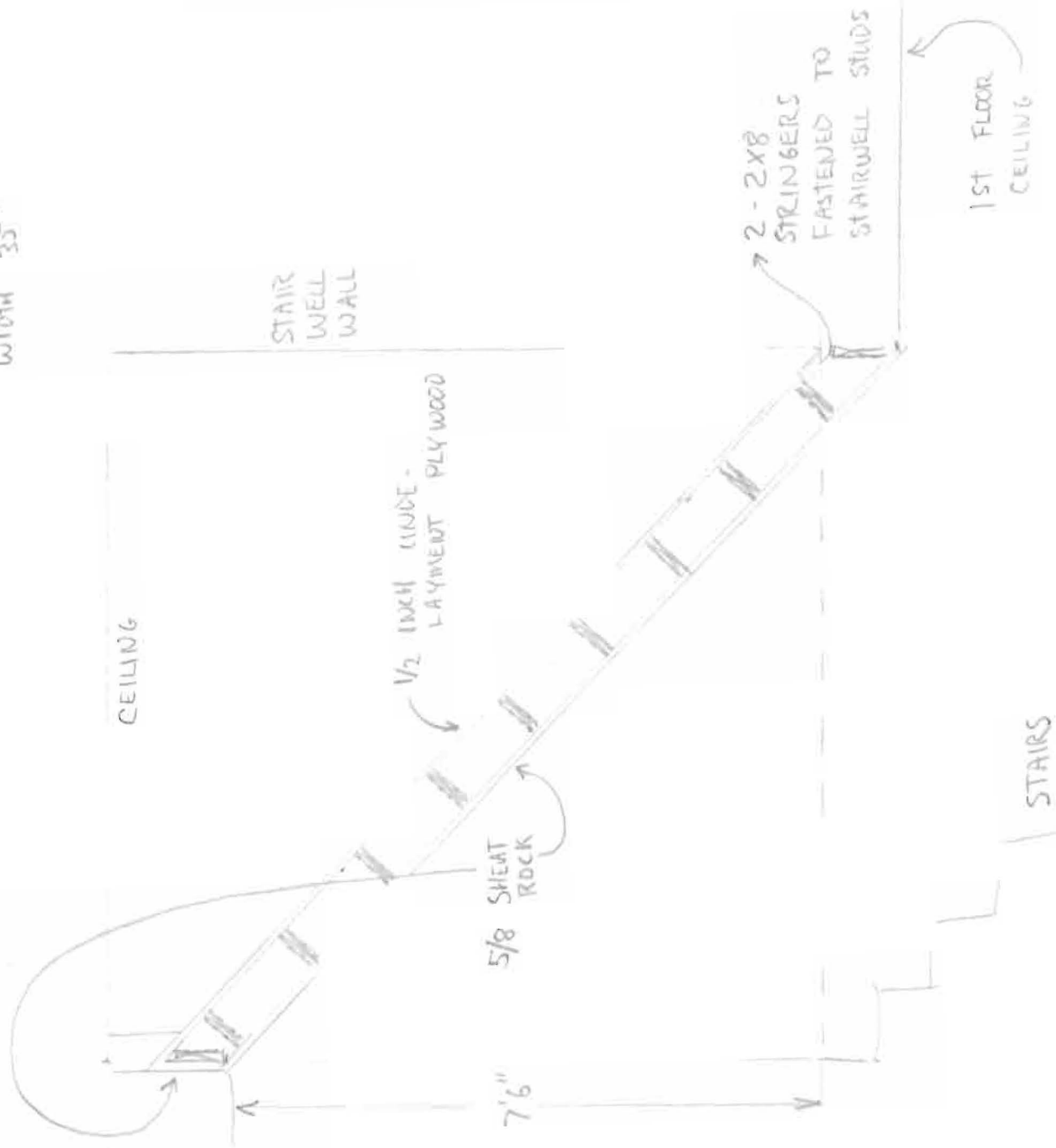

HALL

STAIRS



BUILDING PERMIT REPORT

Address 12 Deering St. Date 19/Jun/94  
Reason for Permit to make interior renovations -  
Close 2nd floor Bldg. Owner: Jean Alears  
Contractor: Hap Cleary  
Permit Applicant: \_\_\_\_\_  
Approval: \*4 \*18

CONDITION OF APPROVAL:

1. Before concrete for foundation is placed, approvals from Public Works and Inspection Services must be obtained. (A 24 hour notice is required prior to inspection).
2. Precaution must be taken to protect concrete from freezing.
3. It is strongly recommended that a register land surveyor check all foundation forms before concrete is placed. This is done to verify that the proper setbacks are maintained.
- X 4. All vertical openings shall be enclosed with construction having a fire rating of at least one (1) hr., including fire doors with selfclosers.
5. Each apartment shall have access to (2) separate, remote and approved means of egress. A single exit is acceptable when it exits directly from the apartment to the building exterior with no communications to other apartment units.
6. The boiler shall be protected by enclosing with one (1) hour fire rated construction including fire doors and ceiling, or by providing automatic extinguishment. Sprinkler piping serving not more than six sprinklers may be connected to a domestic water supply system having a capacity sufficient to provide 0.15 gallons per minute, per square foot of floor throughout the entire area. An INDICATING shut-off valve shall be installed in an accessible locations between the sprinkler and the connection to the domestic water supply. Minimum pipe size shall be 3/4 inch copper or 1 inch steel. Maximum coverage area of a residential sprinkler is 144 square feet per sprinkler.
7. Every sleeping room below the fourth story in buildings of Use Groups R and I-1 shall have at least one operable window or exterior door approved for emergency egress or rescue. The units must be operable from the inside opening without the use of special knowledge or separate tools. Where windows are provided as a means of egress or rescue, they shall have a sill height not more than 44 inches (1118 mm) above the floor. All egress or rescue windows from sleeping room must have minimum net clear opening height dimension shall be 24 inches (610 mm). The minimum net clear opening width dimension shall be 20 inches (508 mm), and a minimum net clear opening of 5.7 sq.ft.
8. All single and multiple station smoke detectors shall be of an approved type and shall be installed in accordance with the provisions of the building code (BOCA National Building Code 1990), and NFPA 101 Chapter 18 & 19.

9. Private garages located beneath habitable rooms in occupancies in Use Group R-1, R-2, R-3 or I-1 shall be separated from adjacent interior spaces by Fire Partitions and floor/ceiling assembly ;lies which are constructed with not less than 1-hour fire resisting rating. Private garages attached side-by-side to rooms in the above occupancies shall be completely separated from the interior spaces and the attic area by means of 1/2 inch gypsum board or the equivalent applied to the garage side. (Chapter 4 section 407.0 of the BOCA/1993).

10. Guardrails & Handrails - A guardrail system is a system of building components located near the open sides of elevated walking surfaces for the purpose of minimizing the possibility of an accidental fall from the walking surface to the lower level. Minimum height all Use Group 42", except Use Group R which is 36". In occupancies in Use Group A, B, H-4, I1, I-2 M and R and public garages and open parking structures, open guards shall have balusters or be of solid material such that a sphere with a diameter of 4" cannot pass through any opening. Guards shall not have an ornamental pattern that would provide a ladder effect.

11. All exit signs, lights and means of egress lighting shall be done in accordance with Chapter 10, section & subsections 1023.& 1024.0 of the City's building code (The BOCA National Building Code/1993).

12. Stair construction in Use Group R-3, R-4 is a minimum of 9" tread and 8-1/4" maximum rise.

13. Headroom in habitable space is a minimum of 7'6".

14. The minimum headroom in all parts of a stairway shall not be less than 80 inches.

15. All construction and demolition debris must be disposed at the City's authorized reclamation site. The fee rate is attached. Proof of such disposal must be furnished to the office of Inspection Services before final certificate or occupancy is issued or demolition permit is granted.

16. Section 25-135 of the Municipal Code for the City of Portland states:"No person or utility shall be granted a permit to excavate or open any street or sidewalk from the time of November 15 of each year to April 15 of the following year".

17. The builder of a facility to which Section 4594-C of the Maine State Human Rights Act, Title 5 MRSA refers, shall obtain a certification from a design professional that the plans of the facility meet the standards of construction required by this section. Prior to commencing construction of the facility, the builder shall submit the certification to the Division of Inspection Services.

18. NO exterior work is to be done

Sincerely,

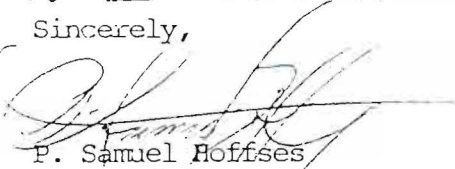
  
P. Samuel Hoffses  
Chief of Inspections

/dmm 01/14/94  
(redo w/additions)