

GENERAL NOTES:

- REFER TO STRUCTURAL ENGINEER'S PLANS FOR WALL DESIGN. DESIGN OF TEMPORARY SOIL RESTRAINT MEASURES SHALL BE THE RESPONSIBILITY OF THE CONTRACTOR IF NECESSARY FOR CONSTRUCTION.
- CONTRACTOR SHALL PLACE CATCH BASIN INLET PROTECTION ON CATCH BASINS AND FIELD INLETS DOWN-GRADIENT OF ALL NON-STABILIZED SURFACES, PER DETAIL.
- LOCATION OF PROPOSED SEDIMENTATION BARRIER IS INDICATED ON PLAN. CONTRACTOR TO ENSURE THAT SEDIMENTATION BARRIER IS INSTALLED ALONG THE DOWN-GRADIENT LOCATION OF DISTURBANCE, PER DETAIL.
- CONTRACTOR SHALL INSTALL CONSTRUCTION ENTRANCE AT ALL LOCATIONS OF INGRESS AND EGRESS DURING CONSTRUCTION TO THE SITE. SEE DETAIL.
- CURB TO BE REMOVED, STOCKPILED AND RESET IN ACCORDANCE WITH DETAIL. BROKEN CURB SHALL BE PROPERLY DISPOSED OF AND SHALL BE REPLACED AT THE CONTRACTOR'S EXPENSE. IN INSTANCES WHERE CATCH BASIN HEADSTONES ARE TO BE REPLACED WITH TIPDOWNS, CONTRACTOR SHALL PROVIDE NEW GRANITE CURB TIPDOWN AND OTHER CURBING AS NECESSARY. CATCH BASIN HEADSTONES SHOULD ONLY BE REMOVED IF THEY ARE TO HINDER ADA ACCESS TO CURB RAMPS.

- CONTRACTOR SHALL INSTALL CATCH BASIN HOOD ON ALL CATCH BASINS.
- CONTRACTOR SHALL CONFIRM H-20 LOADING AT INDICATED COVER ON PLAN IS FEASIBLE OVER DRAINAGE PIPE PRIOR TO CONSTRUCTION.
- CONTRACTOR SHALL ENSURE THAT FOUNDATION DRAINS AND UNDERDRAINS ARE CONSTRUCTED WITH POSITIVE OUTLET TO PROPOSED CONNECTIONS.
- REFER TO THE ARCHITECTURAL CROSS SECTION PLANS FOR VERTICAL CLEARANCE WITHIN THE PARKING GARAGE INCLUDING BASEMENT, FIRST FLOOR AND VEHICULAR ENTRANCE RAMPS.

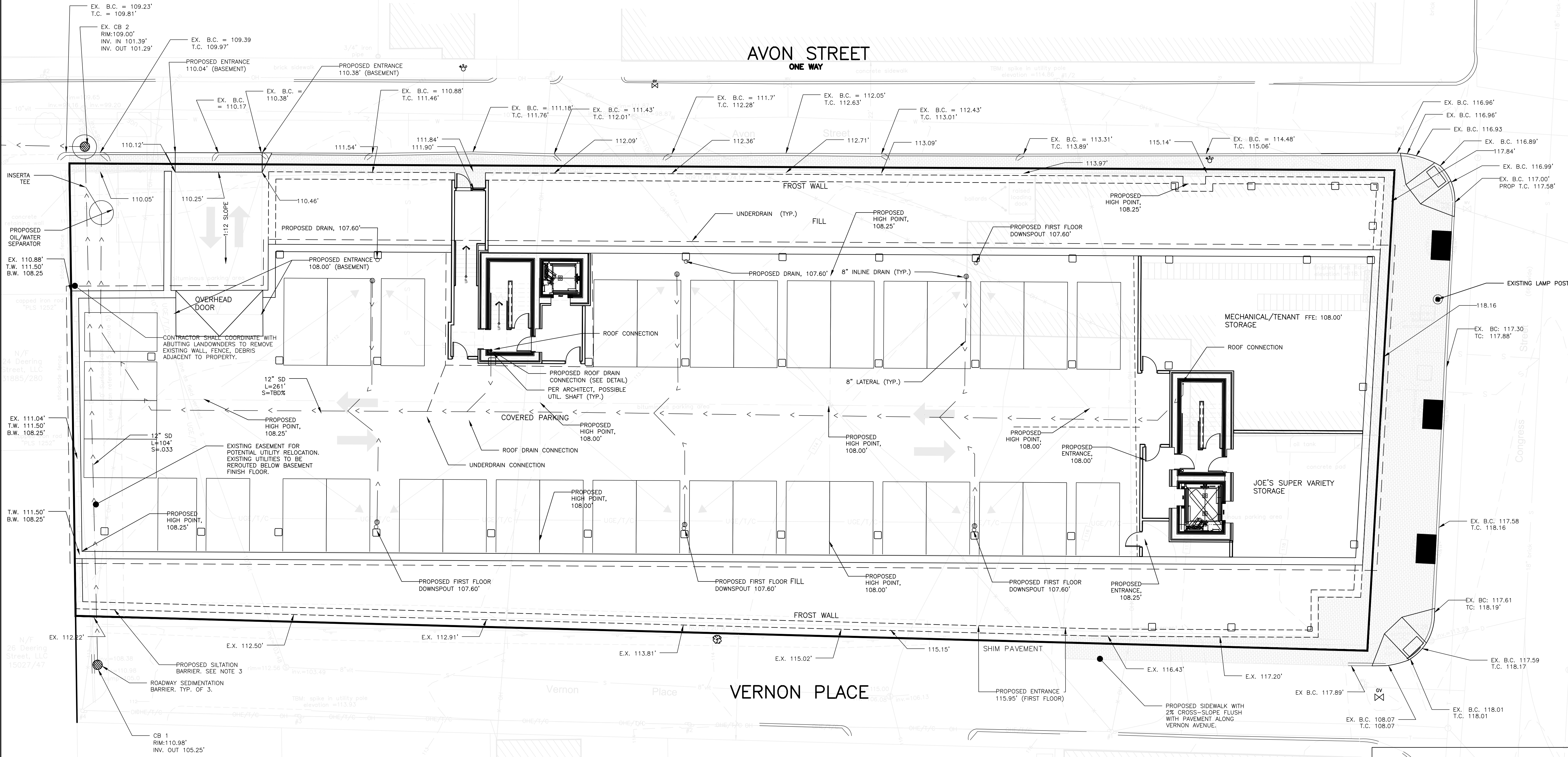
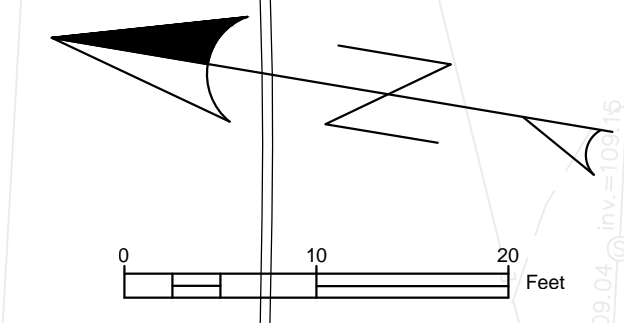

ISSUED FOR	BY	DATE
PRELIM. APPLICATION	WHS	7/30/15
REVISION	REV.	DATE

DRAWING NAME: **GRADING & DRAINAGE PLAN: BASEMENT**  
 PROJECT NAME: **667 CONGRESS STREET REDEVELOPMENT**  
 CLIENT: **REDFERN PROPERTIES, LLC.**  
 P.O. BOX 8616 PORTLAND, MAINE, 04104

**A C C O R N**  
 ENGINEERING, INC.

ACORN ENGINEERING, INC. 11415  
 158 DANFORTH (207) 779-2665  
 THIS PLAN SHALL BE VOID WITHOUT THE SIGNATURES OF THE ENGINEER'S SOLE AUTHORIZED OR OTHERWISE. SHALL BE AT THE USER'S SOLE RISK AND WITHOUT LIABILITY TO ACORN ENGINEERING, INC.

FILE: 1060\_CONGRESS  
 DATE: 4/6/2015  
 JN: 1060  
 SCALE: 1"=10'  
 DESIGNED BY: MAG  
 DRAWN BY: MAG  
 CHECKED BY: WHS

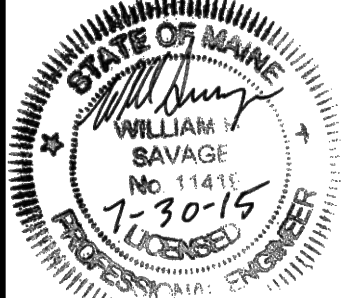

DRAWING NO.  
**C-30**

PRELIMINARY: NOT  
 ISSUED FOR  
 CONSTRUCTION