

- GENERAL NOTES:
- CONTRACTOR SHALL COORDINATE WITH TIME WARNER TO PROVIDE CABLE TO RESIDENCES ON VERNON PLACE IN PLACE OF OVERHEAD SERVICE WIRES CROSSING THE PROPOSED DEVELOPMENT. OVERHEAD WIRES SHALL BE REROUTED SUBSURFACE TO THE NORTH END OF THE PROPERTY TO THE EXISTING POLE AND THEN RUN OVERHEAD ON EXISTING POLES ALONG VERNON PLACE. ADDITIONAL GUY WIRING WITH EASEMENTS WILL BE REQUIRED.
  - CONTRACTOR SHALL EITHER FILL ABANDONED SEWER WITHIN THE SITE AND VERNON STREET WITH FLOWABLE FILL OR EXCAVATE AND DISPOSE OF OFFSITE OR COMBINATION.
  - CONTRACTOR IS TO BE CAUTIONED THAT CERTAIN LOCATIONS AND/OR ELEVATIONS OF EXISTING UTILITIES HAVE BEEN PROVIDED THROUGH UTILITY COORDINATION OR OTHER OBSERVATIONS. INFORMATION IS NOT TO BE RELIED UPON AS EXACT OR COMPLETE. CONTRACTOR TO FIELD VERIFY AND COORDINATE WITH UTILITY COMPANY AND DIG SAFE NO LESS THAN 72 HOURS PRIOR TO ANY EXCAVATION TO REQUEST EXACT FIELD LOCATION OF ALL UTILITIES. IT SHALL BE THE RESPONSIBILITY OF THE CONTRACTOR TO RELOCATE ALL EXISTING UTILITIES WHICH CONFLICT WITH THE PROPOSED IMPROVEMENTS INDICATED IN THE CONTRACT DOCUMENTS. CONTRACTOR TO NOTIFY ENGINEER OF ANY DIFFERENTIALS FROM EXISTING CONDITIONS, INCLUDING UTILITY SURVEY, PRIOR TO ANY CHANGES.
  - FOR ALL UTILITIES: ACCORN ENGINEERING DESIGN LIMITS EXTEND TO OUTSIDE WALL OF BUILDING. METERING OF UTILITIES TO BE COMPLETED BY M.E.P. UNLESS SPECIFIED OTHERWISE.
  - SEWER, SEWER UTILITIES WITHIN CITY STREET RIGHT OF WAY TO BE CONSTRUCTED IN ACCORDANCE WITH CITY OF PORTLAND TECHNICAL STANDARDS. WASTE FROM KITCHEN OF PROPOSED JOE'S VARIETY STORE SHALL CONVEY WASTE TO A GREASE TRAP. M.E.P. TO PLACE VALVE FOR BACKFLOW PREVENTION INSIDE

- WATER UTILITIES: ALL 6" AND 8" WATER PIPE SHALL BE DUCTILE IRON PIPE UNLESS OTHERWISE APPROVED. FINAL PIPE SIZING TO BE PROVIDED BY MEP ENGINEER. INTERNAL METERING, BACKFLOW PREVENTION (PER PWD), A TESTABLE DOUBLE CHECK VALVE ASSEMBLY WILL BE REQUIRED AT THE BUILDING ENTRANCE, AND PRESSURE REDUCERS, IF REQUIRED, TO BE COMPLETED BY M.E.P. ENGINEER. DOMESTIC WATER PIPE SIZES WILL DETERMINE THE FINAL WATER METERING OPTIONS. METER MAY BE SMALLER THAN THE DIAMETER OF THE WATER MAIN. WATER METERING, PRESSURE REDUCER AND BACKFLOW PREVENTION TO BE IN ACCORDANCE WITH THE PORTLAND WATER DISTRICT STANDARDS. CONTRACTOR TO FOLLOW SUB-METERING GUIDELINES OF THE CITY OF PORTLAND. CURB STOPS AND GATE VALVES SERVING AS CURB STOPS SHALL BE LOCATED WITHIN THE R.O.W. AND WITHIN 6" OF PROPERTY LINE.
- ELECTRIC, TELEPHONE, AND COMMUNICATIONS UTILITIES: DESIGN TO BE FINALIZED BY M.E.P. ENGINEER. ELECTRICAL LOAD TO BE DETERMINED BY M.E.P. ENGINEER. METER LOCATION BY M.E.P. ALL ELECTRIC CONSTRUCTION SHALL CONFORM TO CMP GUIDEBOOK OF STANDARD REQUIREMENTS, MOST RECENT EDITION. UGE/T/C AND UGE WITHIN CITY OF PORTLAND R.O.W. SHALL BE ENCASED IN CONCRETE. PULL BOXES AND PEDESTAL LOCATIONS TO BE DETERMINED BY FAIRPOINT AND TIME WARNER PRIOR TO CONSTRUCTION. CONTRACTOR TO COORDINATE.

- GAS UTILITIES: PROJECT GAS LOAD AND INTERNAL GAS UTILITY DESIGN TO BE FINALIZED BY M.E.P. ENGINEER. GAS METERS TO BE LOCATED BY M.E.P.
- CONTRACTOR TO COORDINATE WITH THE CITY OF PORTLAND, THE PORTLAND WATER DISTRICT, AND THEIR RESPECTIVE CONTRACTOR FOR THE INSTALLATION OF UTILITIES WITHIN AVON STREET IN ACCORDANCE WITH THEIR ASSOCIATED CONSTRUCTION DOCUMENTS.
- CONTACTS:
  - 10.1. LIGHTTOWER FIBER NETWORKS, MARK BONANNO (508) 616-7818
  - 10.2. MAINE MEDICAL CENTER, JOHN FOLEY (207) 662-6938
- ALTHOUGH DEPICTED ON THE FIRST FLOOR, THE 10" SANITARY SEWER PIPING AND ALL TRIBUTARY ATTACHMENTS ARE TO BE LOCATED IN THE SUBSURFACE BELOW THE BASEMENT LEVEL; REFER TO C-30 AND THE MEP PLANS FOR ADDITIONAL DETAILS.

| SEWER STRUCTURE SCHEDULE |                   |         |                                     |          |
|--------------------------|-------------------|---------|-------------------------------------|----------|
| STRUCTURE                | INTERIOR DIAMETER | RIM     | INV. IN                             | INV. OUT |
| EX. SMH-1                | 4'                | 109.7'  | 99.28'                              | 99.18'   |
| EX. SMH-2                | 4'                | 111.87' | 10" EX. 99.87'<br>10" PROP. 102.21' | 99.86'   |

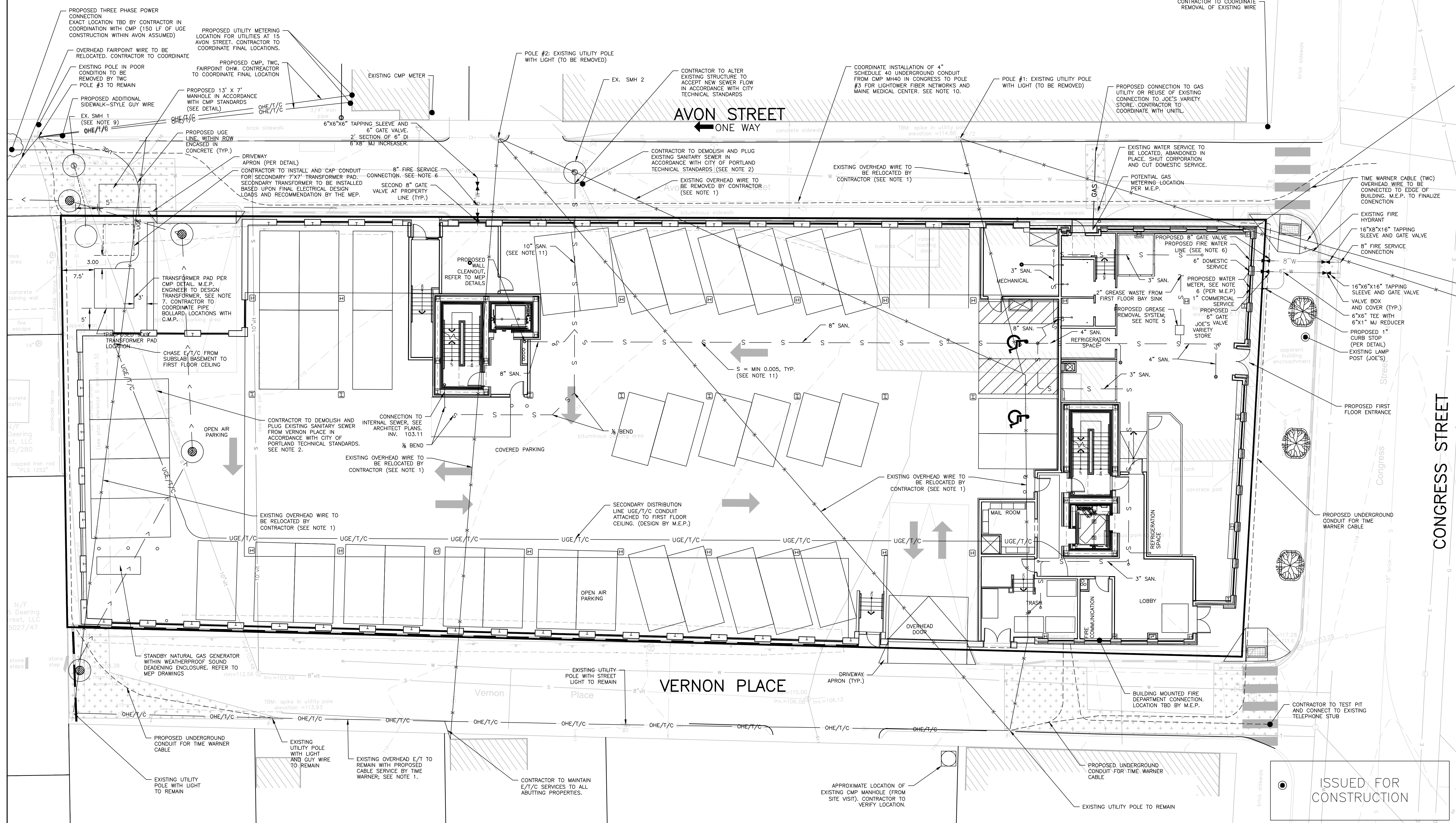
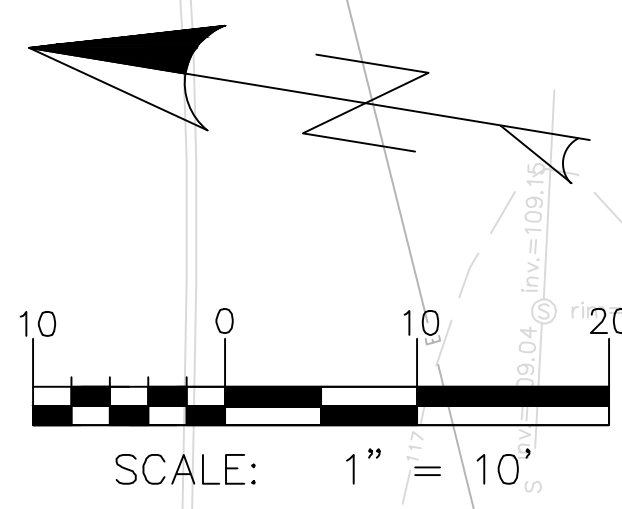

| ISSUED FOR          | BY  | DATE     |
|---------------------|-----|----------|
| PRELIM. APPLICATION | WHS | 7/22/16  |
| PRICING             | WHS | 7/24/16  |
| PC DD SET           | WHS | 8/7/16   |
| PC PROGRESS SET     | WHS | 9/21/16  |
| COMMENT/RESPONSE    | WHS | 10/13/16 |
| FINAL APPLICATION   | WHS | 10/13/16 |
| BIDDING             | WHS | 10/27/16 |
| COA                 | WHS | 10/28/16 |
| FOR CONSTRUCTION    | WHS | 11/29/16 |
| CITY COMMENTS       | WHS | 12/4/16  |
| CITY APPROVED PLAN  | WHS | 12/9/16  |
| MEP CHANGES         | WHS | 1/28/16  |

UTILITY PLAN  
 PROJECT NAME: 667 CONGRESS STREET REDEVELOPMENT  
 CLIENT: REDFERN LONGFELLOW, LLC.  
 P.O. BOX 8616 PORTLAND, MAINE, 04104

ACORN ENGINEERING, INC. MAINE 04102  
 158 DANFORTH (207) 779-2665

ENGINEERING, INC.

FILE: 1060\_CONGRESS  
 DATE: 4/6/2015  
 JN: 1060  
 SCALE: 1"=10'  
 DESIGNED BY: MAG  
 DRAWN BY: MAG  
 CHECKED BY: WHS

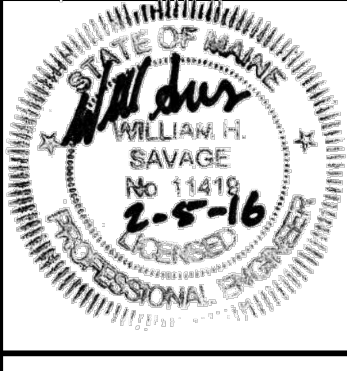

DRAWING NO.  
**C-20**

ISSUED FOR CONSTRUCTION