

LIGHTING SHOWN FOR REFERENCE ONLY SEE ELECTRICAL PLANS FOR LIGHTING LAYOUT

EXTERIOR LIGHT FIXTURE LEGEND

TYPE A - LIGHTOLGY - URBAN WALL SCONCE - GRAPHITE COLOR - LARGE SIZE 8"X22" - LED LAMPING - ON DIMMER SWITCH

TYPE B - GARAGE CEILING FIXTURE - LED LAMPING

REFLECTED CEILING PLAN NOTES

- 1) G.C. TO COORDINATE LOCATIONS OF PLUMBING CLEAN OUTS AND PROVIDE FIRE RATED ACCESS PANELS AT CEILING
- 2) G.C. TO PROVIDE ACCESS PANELS AS REQUIRED FOR ALL ELEMENTS (SPRINKLER VALVES, ETC) NOT SHOWN ON THIS REFLECTED CEILING PLAN
- 3) G.C. TO PROVIDE METAL FRAMING AND BLOCKING REQUIRED FOR ALL ACCESS PANELS AND CONTROL JOINTS
- 4) FOR APARTMENT UNIT CEILING INFORMATION SEE APARTMENT UNIT DETAIL SHEETS
- 5) ALL RECESSED LIGHTING FIXTURES TO HAVE RATED HOUSINGS TO MEET FIRE RATINGS OF CEILING THEY ARE INSTALLED WITHIN

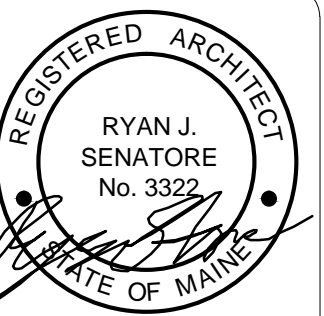

© 2015 RYAN SENATORE ARCHITECTURE

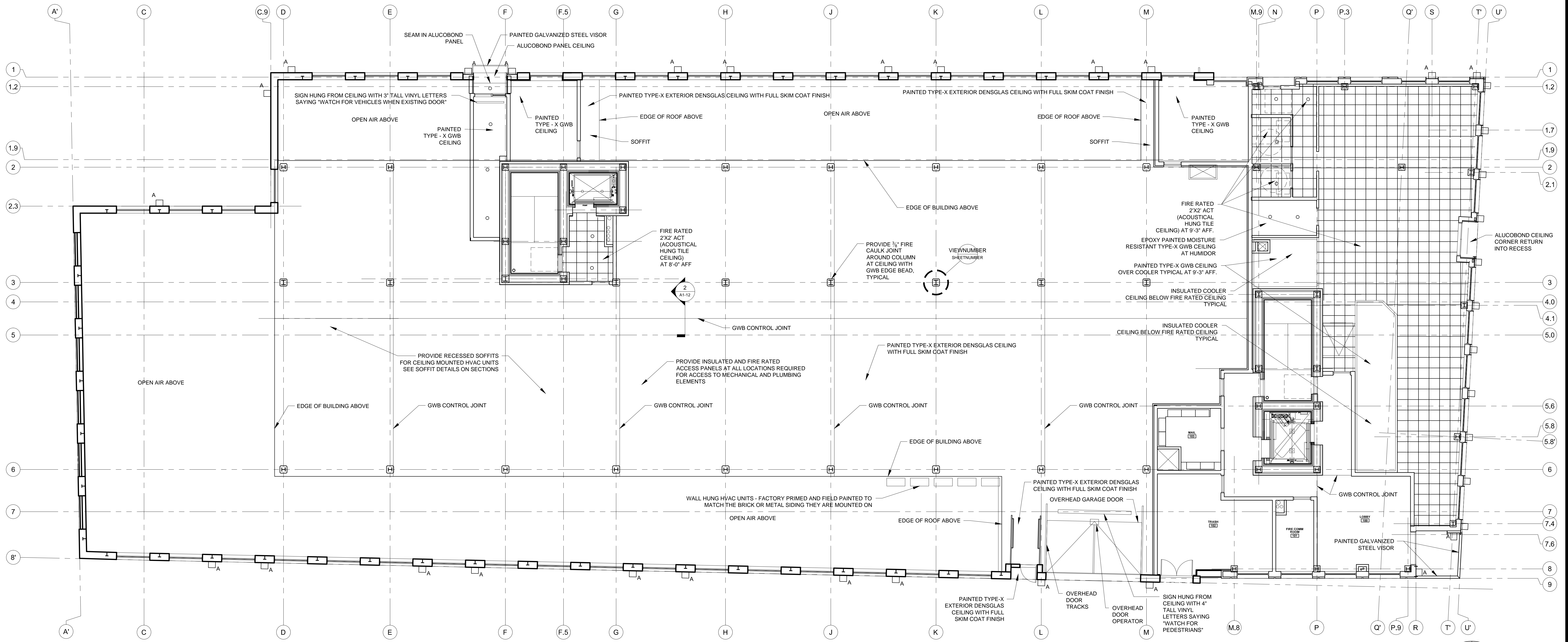
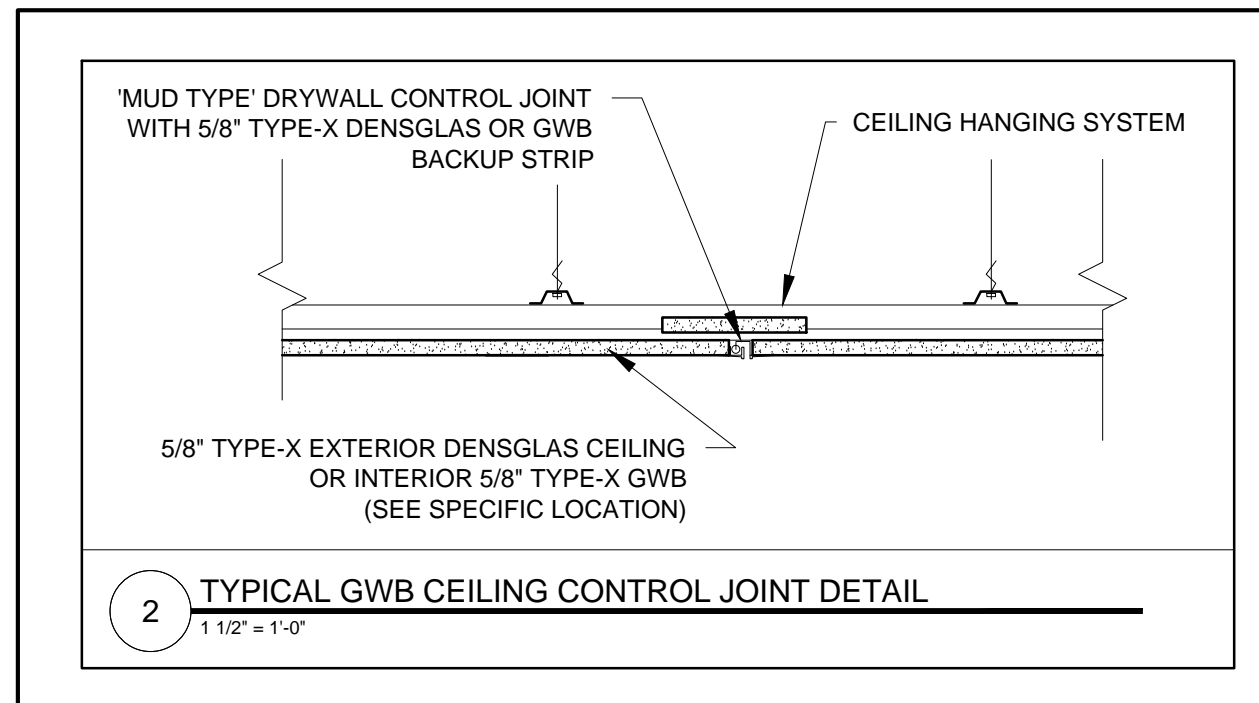

667 CONGRESS STREET
APARTMENTS
PORTLAND, MAINE



RYAN SENATORE ARCHITECTURE
667 CONGRESS STREET
PORTLAND, MAINE 04101
207-650-6414
senatorearchitecture.com

CONSULTANTS:
STRUCTURAL: Structural Integrity
77 Oak Street
Portland, ME 04101
207-774-4614

REVISIONS:

DATE: 2 NOVEMBER 2016
PROJECT No. 1503
DRAWN BY: RJS / RRT
CHECKED BY: RJS
SCALE: AS NOTED

SHEET TITLE:
FIRST FLOOR
REFLECTED
CEILING PLAN

A1-12

1 FIRST FLOOR REFLECTED CEILING PLAN
1/8" = 1'-0"