

PLAN NOTES

- 1) ALL STEEL COLUMNS TO BE FIREPROOFED TO MEET 2HR UL RATING AS SHOWN ON TYPICAL COLUMN FIREPROOFING ON SHEET A0-1
- 2) ALL STEEL BEAMS AND DIAGONAL STEEL BEAMS AT STAIR/ELEVATOR TOWERS TO BE FIREPROOFED TO MEET 2HR UL RATING AS SHOWN ON TYPICAL BEAM FIREPROOFING ON SHEET A0-1 (UNLESS NOTED OTHERWISE)

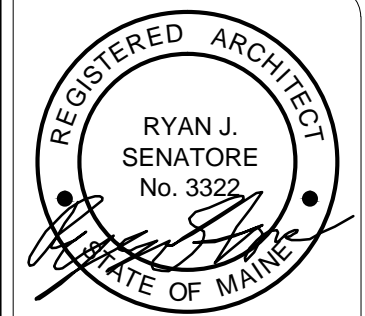

© 2015 RYAN SENATORE ARCHITECTURE

667 CONGRESS STREET
APARTMENTS
 PORTLAND, MAINE



RYAN SENATORE ARCHITECTURE
 665 CONGRESS STREET
 PORTLAND, MAINE 04101
 207-650-6414
 rsenatorearchitecture.com

CONSULTANTS:
 STRUCTURAL: Structural Integrity
 77 Oak Street
 Portland, ME 04101
 207-774-4614

REVISIONS:

DATE: 2 NOVEMBER 2016
 PROJECT No. 1503
 DRAWN BY: RJS / RRT
 CHECKED BY: RJS
 SCALE: AS NOTED

SHEET TITLE:
FIRST FLOOR PLAN

A1-1

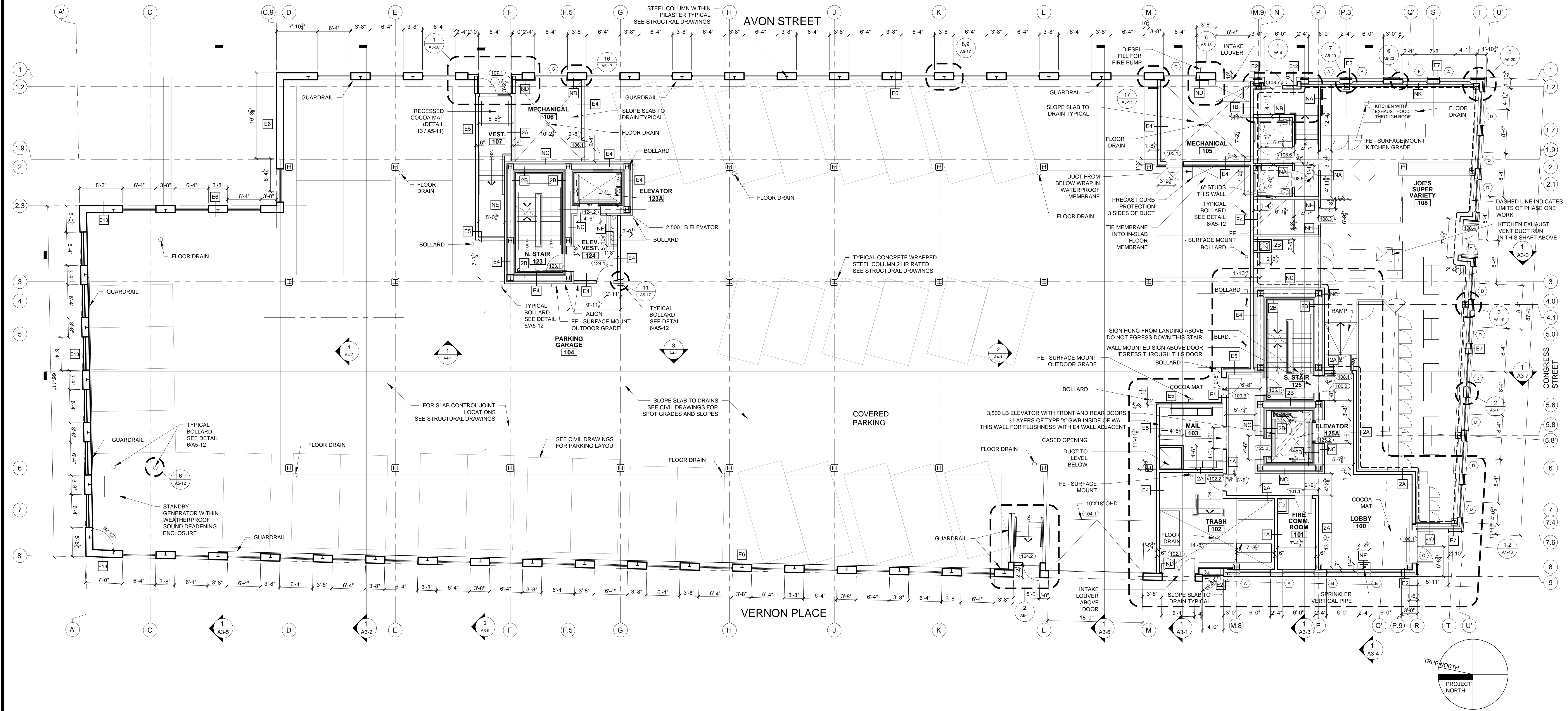

1 FIRST FLOOR PLAN
 1/8" = 1'-0"