

GENERAL NOTES:

- CROSS SECTION FROM RSA A3-5; REFER TO RSA DRAWING FOR ADDITIONAL BUILDING DETAILS
- ARCHITECTURAL AND STRUCTURAL CROSS-SECTIONS ARE SUBJECT TO CHANGE. CONTRACTOR TO COORDINATE VARIOUS PROFESSIONAL DRAWINGS AND NOTIFY ACORN ENGINEERING ANY CONFLICTS OR DISCREPANCIES.
- THE OWNER SHALL BE RESPONSIBLE FOR OBTAINING ANY EASEMENT OR TEMPORARY CONSTRUCTION RIGHTS AS NECESSARY BY PRIVATE ADJACENT LAND OWNERS. DURING THE PRE-CONSTRUCTION PHASE THE CONTRACTOR SHALL NOTIFY THE OWNER SHOULD THEIR MEANS AND METHODS REQUIRE AND EASEMENT OR TEMPORARY CONSTRUCTION RIGHTS. THE CONTRACTOR SHALL NOT DISTURB ANY SOIL BEYOND THE PROPERTY LINE WITHOUT NOTIFYING AND OBTAINING SUCH EASEMENT OR TEMPORARY CONSTRUCTION RIGHT FROM THE OWNER. PRIOR TO THE CONTRACTOR PRICING THE WORK THE CONTRACTOR SHALL REQUEST PROOF OF SUCH EASEMENT OR TEMPORARY RIGHTS. SHOULD EASEMENTS OR TEMPORARY RIGHTS NOT BE AVAILABLE THE CONTRACTOR SHALL INCLUDE COST FOR BRACING AND SHORING AS NECESSARY.
- GEOTECHNICAL REPORT BY SUMMIT GEOTECHNICAL SERVICES DATED MAY 2015 REQUIREMENTS INCLUDE BUT ARE NOT LIMITED TO:
 - ALL FROST WALLS SHALL EXTEND MIN 4' BELOW FINAL BASEMENT FLOOR GRADE UNLESS BEDROCK IS DETECTED THEN MIN 2' IS ACCEPTABLE; ACTUAL DEPTH TO BE DETERMINED BY STRUCTURAL ENGINEER
 - EXPOSED, LOAD-BEARING NATIVE SOIL IS TO BE PROOFROLLED WITH A MIN 2 PASSES WITH A 5-TON VIBRATORY ROLLER IN 2 PERPENDICULAR DIRECTIONS
 - EXPOSED, LOAD-BEARING BEDROCK IS TO BE CLEARED OF LOOSE AND WEATHERED ROCK
 - EXPOSED RUBBLE FILL BELOW FOOTINGS IS TO BE REMOVED DOWN TO THE NATIVE GLACIAL TILL SOIL AND OUTWARDS EQUAL TO A DISTANCE OF THE FOOTING WIDTH
 - VOIDS IN RUBBLE FILL ARE TO BE FILLED WITH 3/4" CRUSHED STONE OR AN APPROVED ALTERNATIVE
 - ROCK ANCHORS SHALL BE INSTALLED PER REPORT IF ADDITIONAL FOUNDATION UPLIFT CAPACITY IS NEEDED
 - SLAB SUBGRADE TO BE OBSERVED BY SGS CONTRACTOR TO COORDINATE
- MAINTAIN MIN 18" COVER AND A MINIMUM SLOPE OF 0.005 FT/FT ON ALL SUBSLAB DRAINS. USE OF ELBOWS TO MINIMIZE ROCK EXCAVATION IS ALLOWED FOR PRIVATE UTILITIES.
- CONTRACTOR TO TEST PIT TO DETERMINE EXACT ELEVATION OF THE FLOOR DRAIN CONNECTION TO THE EXISTING SANITARY LINE.
- PLAN IS SCALED AS NOTED, BUT ROADWAY CROSS SLOPES HAVE BEEN EXAGGERATED FOR VISUAL PURPOSES.

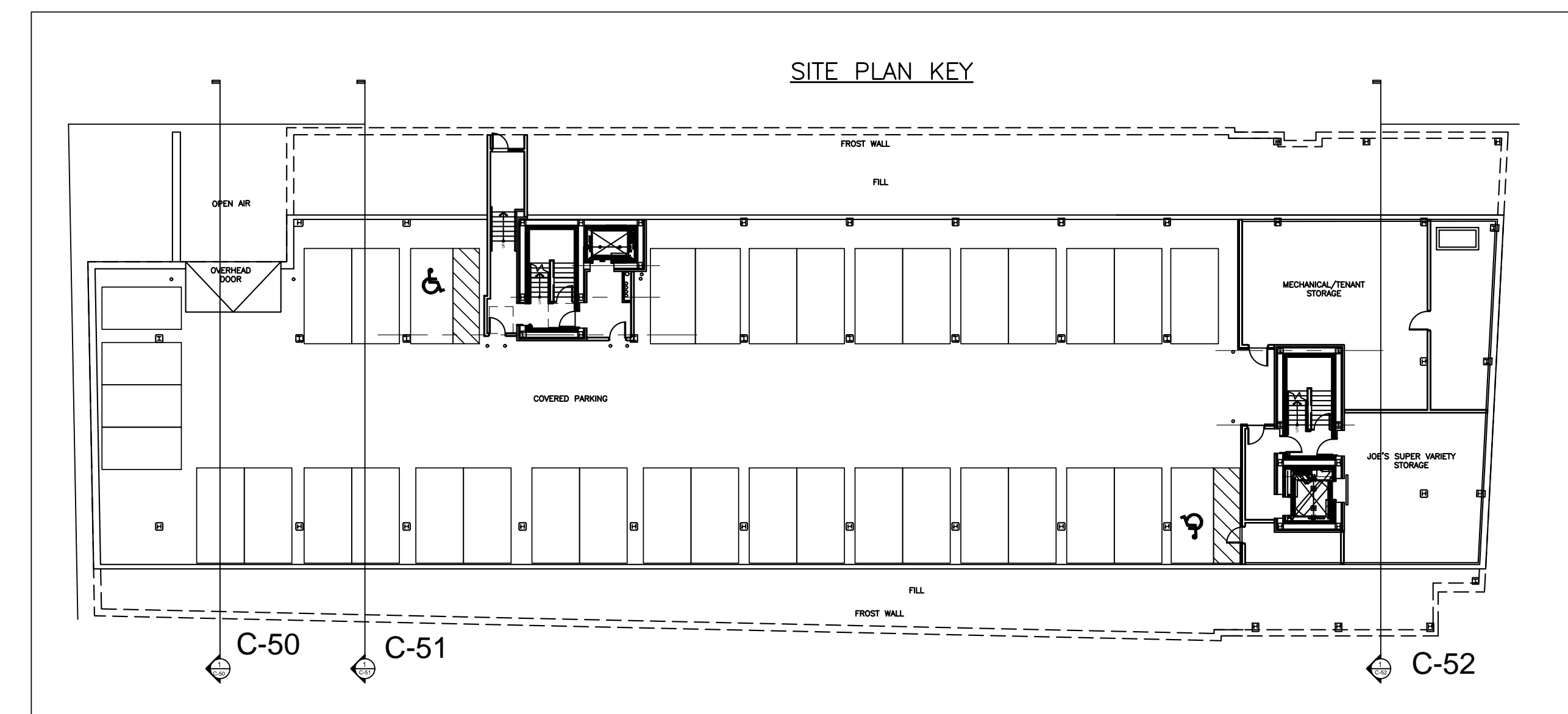
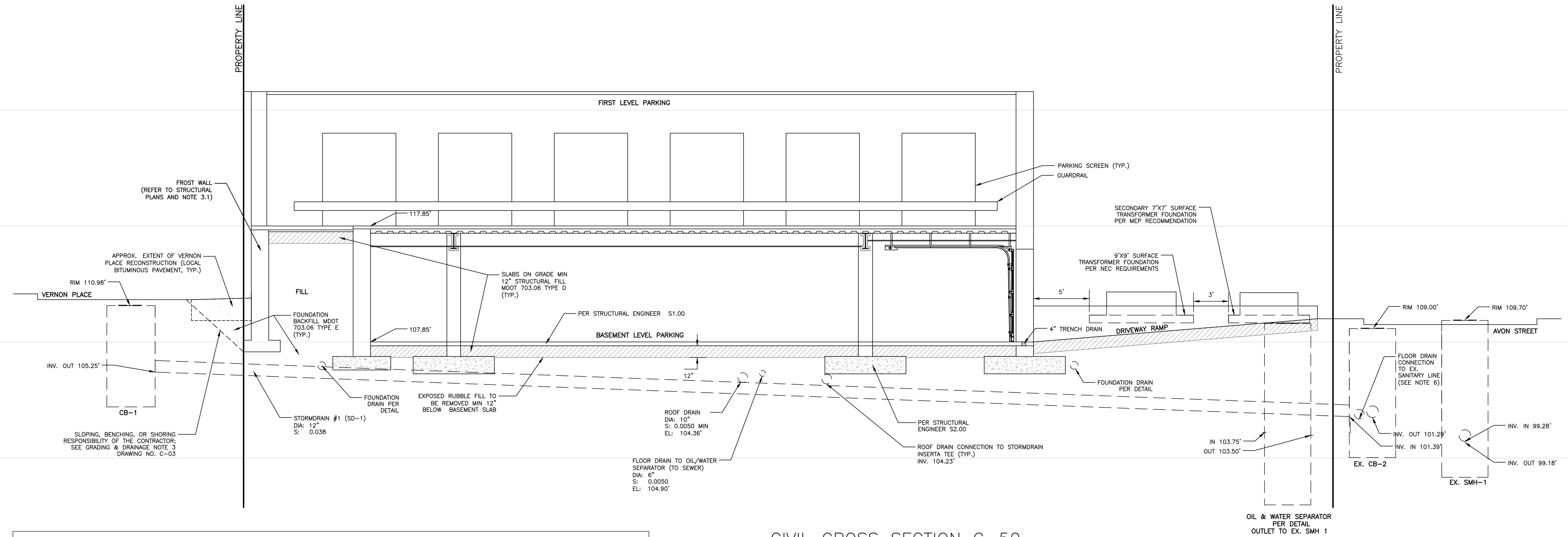

CIVIL CROSS SECTION C-50

ISSUED FOR CONSTRUCTION

ISSUED FOR	BY	DATE
PLANNING DEPT	WHS	10/23/15
COA	WHS	10/29/15
FOR CONSTRUCTION	WHS	11/2/15
REVISION	REV.	DATE

DRAWING NAME: CROSS SECTION-1
 PROJECT NAME: 667 CONGRESS STREET REDEVELOPMENT
 CLIENT: REDFERN PROPERTIES, LLC.
 P.O. BOX 8816 PORTLAND, ME 04104

ACORN ENGINEERING, INC. MAINE 04102
 158 DANFORTH (207) 779-2655

ACORN ENGINEERING, INC.

THIS PLAN SHALL NOT BE REPRODUCED, COPIED, EITHER WHOLLY OR PARTIALLY, OR TRANSMITTED IN ANY FORM OR BY ANY MEANS, WITHOUT THE WRITTEN PERMISSION OF ACORN ENGINEERING, INC.

FILE:	1060_DETAILS
DATE:	8/21/15
JN:	1060
SCALE:	1:50
DESIGNED BY:	WHS
DRAWN BY:	OJD
CHECKED BY:	WHS

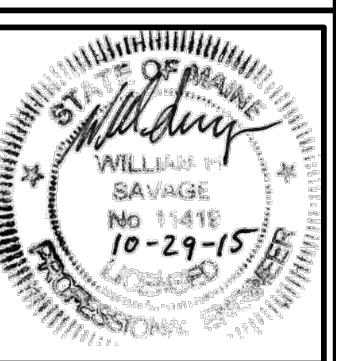

DRAWING NO. **C-50**