

PARKING SUMMARY		
PARKING DIMENSION	# PARKING SPACES	STRIPING
8.5X15	6	YELLOW
8X18	1	WHITE
8.5X18	13	WHITE
9X18	22	WHITE
ADA 8X18	2	PER DETAIL
TOTAL SPACES	44	

LEGEND	
HATCH STYLE	ASSOCIATED AREAS
	PROPOSED BRICK SIDEWALK
	UTILITY PAVEMENT CUTS
	EXISTING PAVEMENT TO BE RESURFACED (NOTE 1)
	LOCAL PAVEMENT PROFILE RECONSTRUCTION (TYP.)
	STONE DUST SURFACE

- GENERAL NOTES:
- 1.25" SURFACE PAVEMENT TO BE REPLACED FOR AVON STREET AND VERNON PLACE ADJACENT TO PROJECT. FOR THE FULL WIDTH OF PROJECT. EXISTING PAVEMENT TO BE MILLED. STRUCTURES WITHIN ROADWAY SHALL BE ADJUSTED AS NECESSARY.
 - CONTRACTOR SHALL PLACE NEW CURBING IN LOCATIONS AS NOTED WITHOUT EXISTING CURBING, IN ACCORDANCE WITH DETAIL. EXISTING TIPDOWNS OR TERMINAL CURBS ARE LOCATED AT ALL CURB CUTS. FOR PURPOSES OF BIDDING, CONTRACTOR SHALL NOTE THAT ALL TIPDOWNS SHALL BE RECONSTRUCTED IN ACCORDANCE WITH DETAIL, AND THAT EXISTING TIPDOWNS MAY NOT MEET CITY OF PORTLAND STANDARD.
 - INTERIOR STRIPING AS INDICATED ON SITE PLAN SHALL BE 4" WIDE.
 - ON-STREET PARKING DELINEATION IS FOR GRAPHIC REPRESENTATION ONLY AND NOT FOR CONSTRUCTION.

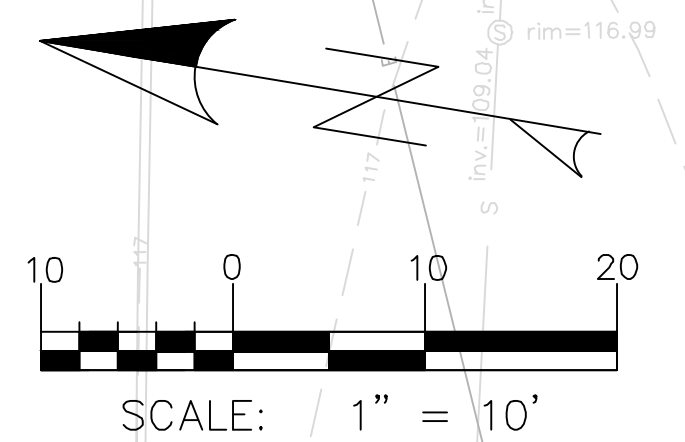

ISSUED FOR	BY	DATE
PRELIM. APPLICATION	WHS	7/30/18
PC DD SET	WHS	8/7/18
PC PROGRESS SET	WHS	9/27/18
COMMENT/RESPONSE	WHS	7/15/18
FINAL APPLICATION	WHS	10/13/18
BIDDING	WHS	10/19/18
COA	WHS	12/20/18
FOR CONSTRUCTION	WHS	11/27/18
REVISION	REV.	DATE

SITE PLAN: FIRST FLOOR
667 CONGRESS STREET REDEVELOPMENT
REDFERN PROPERTIES, LLC.
 P.O. BOX 8616 PORTLAND, MAINE, 04104

DRAWING NAME: **667 CONGRESS STREET REDEVELOPMENT**
 PROJECT NAME: **667 CONGRESS STREET REDEVELOPMENT**
 CLIENT: **REDFERN PROPERTIES, LLC.**

ACORN ENGINEERING, INC.
 158 DANFORTH (207) 779-2655
 ACCORN ENGINEERING, INC., MAINE 04102
 THIS PLAN SHALL BE VOID WITHOUT THE SIGNATURE OF THE ENGINEER.
 UNLESS OTHERWISE SPECIFIED, ALL DIMENSIONS SHALL BE IN FEET AND INCHES.
 UNLESS OTHERWISE SPECIFIED, ALL DIMENSIONS SHALL BE IN FEET AND INCHES.

FILE: 1060_CONGRESS
 DATE: 4/6/2015
 JUN: 1060
 SCALE: 1"=10'
 DESIGNED BY: MAG
 DRAWN BY: MAG
 CHECKED BY: WHS

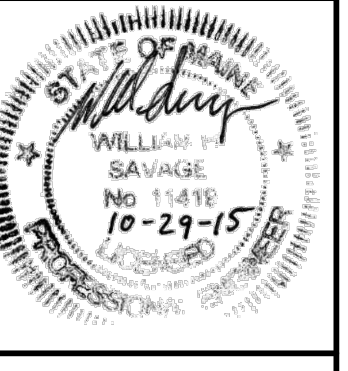

DRAWING NO.
C-11

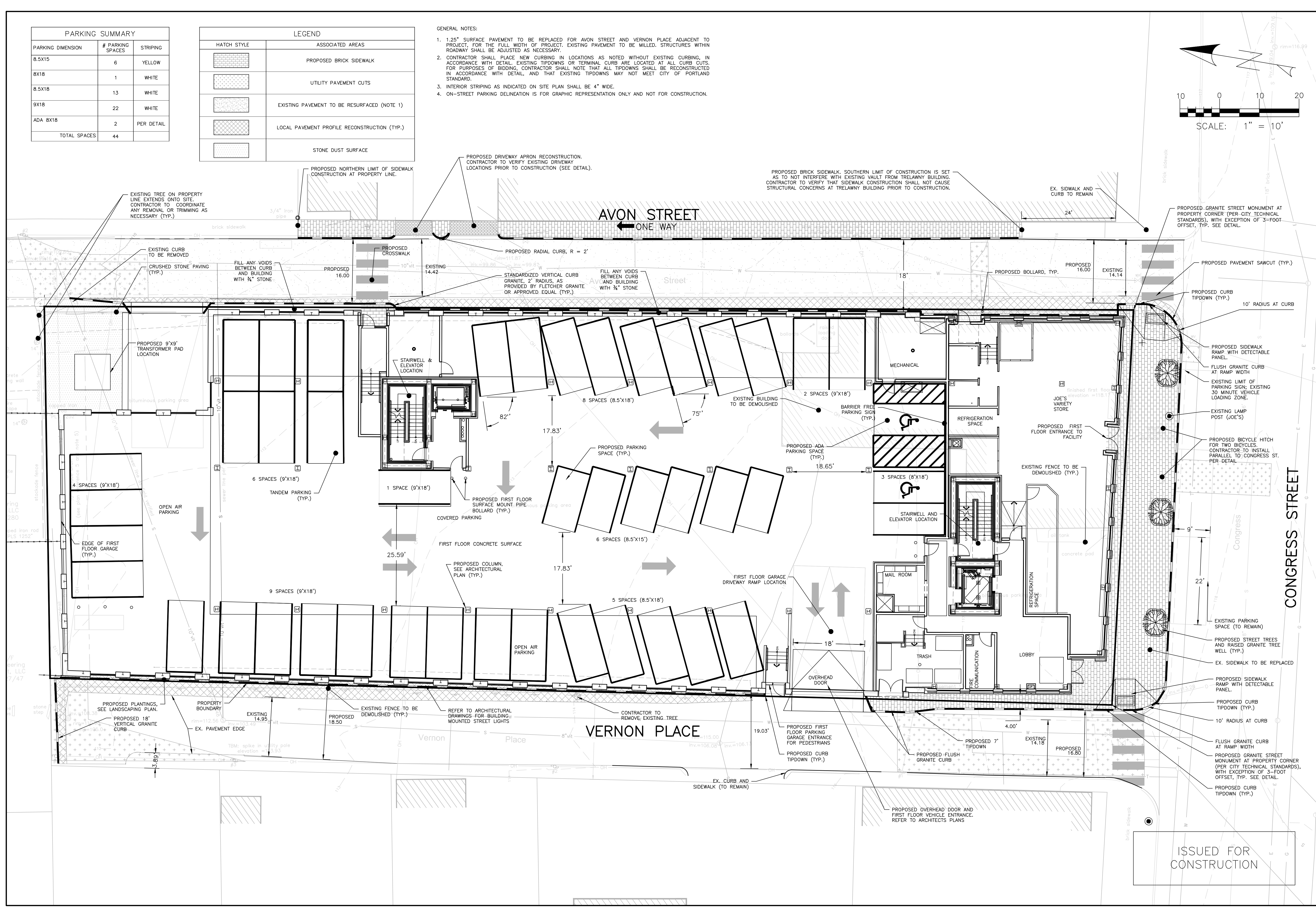

ISSUED FOR
 CONSTRUCTION