

**City of Portland, Maine – Building or Use Permit Application** 389 Congress Street, 04101, Tel: (207) 874-8703, FAX: 874-8716

Location of Construction: 675 Congress St		Owner: Doukas, William		Phone: 207-287-2754		Permit No:	
Owner Address:		Lessee/Buyer's Name: XXXXXXXXX Shalimar of India Restaurant		Phone:		BusinessName:	
Contractor Name: William Doukas		Address: 195 State St Portland, ME 04101		Phone:		Permit issued:	
Past Use: Restaurant		Proposed Use: Same		COST OF WORK: \$		PERMIT FEE: \$ 35.00	
				FIRE DEPT. <input type="checkbox"/> Approved <input type="checkbox"/> Denied		INSPECTION: Use Group: Type:	
				Signature:		Signature:	
Proposed Project Description: Erect Awnings				PEDESTRIAN ACTIVITIES DISTRICT (P.A.D.) Action: Approved <input type="checkbox"/> Approved with Conditions: <input type="checkbox"/> Denied <input type="checkbox"/> Signature: Date:			
Permit Taken By: Mary Gresik		Date Applied For: 04 March 1998					

Zone: CBL: 046-C-011

Zoning Approval:

**Special Zone or Reviews:**

Shoreland  
 Wetland  
 Flood Zone  
 Subdivision  
 Site Plan maj  minor  mm

**Zoning Appeal**

Variance  
 Miscellaneous  
 Conditional Use  
 Interpretation  
 Approved  
 Denied

**Historic Preservation**

Not in District or Landmark  
 Does Not Require Review  
 Requires Review

**Action:**

Approved  
 Approved with Conditions  
 Denied

Date: \_\_\_\_\_

**CERTIFICATION**

I hereby certify that I am the owner of record of the named property, or that the proposed work is authorized by the owner of record and that I have been authorized by the owner to make this application as his authorized agent and I agree to conform to all applicable laws of this jurisdiction. In addition, if a permit for work described in the application is issued, I certify that the code official's authorized representative shall have the authority to enter all areas covered by such permit at any reasonable hour to enforce the provisions of the code(s) applicable to such permit

SIGNATURE OF APPLICANT <i>William Doukas</i>		ADDRESS: 193-197 State St. <sup>Ap. #4</sup>		DATE: 04 March 1998		PHONE: 207-287-2754 (W) 874-7424 (H)	
RESPONSIBLE PERSON IN CHARGE OF WORK, TITLE <i>William Doukas</i>		" "		" "		PHONE: " "	

CEO DISTRICT

**SIGNAGE**

**PLEASE ANSWER ALL QUESTIONS**

ADDRESS: 675 Congress St. ZONE: B-3

OWNER: William Doukas

APPLICANT: William Doukas

ASSESSOR NO.: 46-C-11-22

SINGLE TENANT LOT? YES  NO   
MULTI TENANT LOT? YES  NO   
FREESTANDING SIGN? YES  NO  DIMENSIONS \_\_\_\_\_  
(ex. pole sign..)

} One Commercial Tenant on  
Ground Floor. Apts in 2nd & 3rd Flr.

MORE THAN ONE SIGN? YES  NO  DIMENSIONS \_\_\_\_\_  
BLDG. WALL SIGN? YES  NO  DIMENSIONS \_\_\_\_\_  
(attached to bldg)

MORE THAN ONE SIGN? YES  NO  DIMENSIONS \_\_\_\_\_

LIST ALL EXISTING SIGNAGE AND THEIR DIMENSIONS: See sketches.  
Repl. Awning Only.

*Handwritten signature and date: 3/11/98*

LOT FRONTAGE (FEET) 47' - Congress St. 80' - State St.  
BLDG FRONTAGE (FEET) 29' - Congress St. 73' - State St.

AWNING YES  NO  IS AWNING BACKLIT? YES  NO

HEIGHT OF AWNING: Congress - 9' State St. - 9 1/2'

IS THERE ANY COMMUNICATION, MESSAGE, TRADEMARK OR SYMBOL ON IT? Yes.

**A SITE SKETCH AND BUILDING SKETCH SHOWING EXACTLY WHERE EXISTING AND NEW**

**SIGNAGE IS LOCATED MUST BE PROVIDED. SKETCHES AND/OR PICTURES OF THE**

**PROPOSED SIGNS ARE ALSO REQUIRED.**

### Computation of Sign Areas

Location (see )	Existing	Proposed
1	20" x 20" = 400 SF	Same.
2	20" H x 60" L = 1200 SF	Same.
3	20" x 20" = 400 SF	Same.
4	20" H x 114" L = 2280 SF	Same
5	2' H x 7' L = 14 SF.	[ No Change No Proposal ]



Awning Proposed For Congress St. Side

[Very Similar to Existing Awning.] - Just Color Change

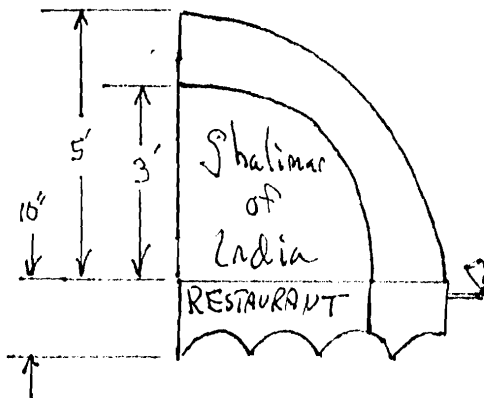
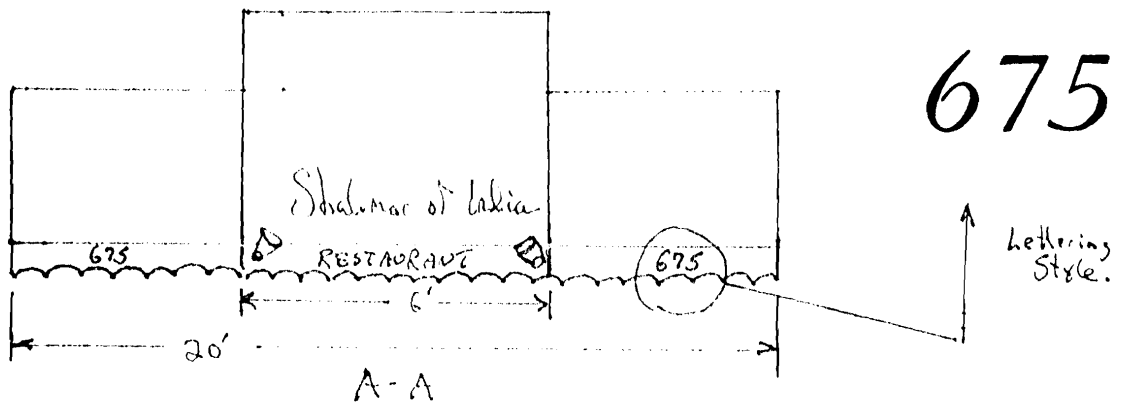
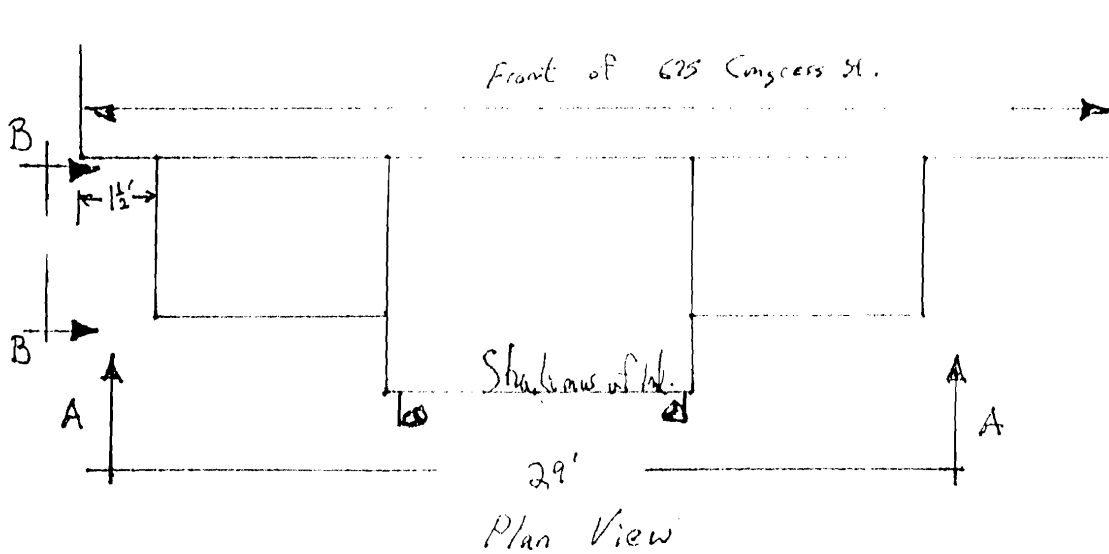

B-B  
 (Other Side Identical)

Color of Canvas - Maroon  
 Color of Letting - Cream.

Size of Awning - Same as Existing

Lettering Size - Same as Existing.

Lighting: Same.

*Awning Proposed For State St. Side*  
*[Very similar to Existing Awning.] - Just Color Change.*

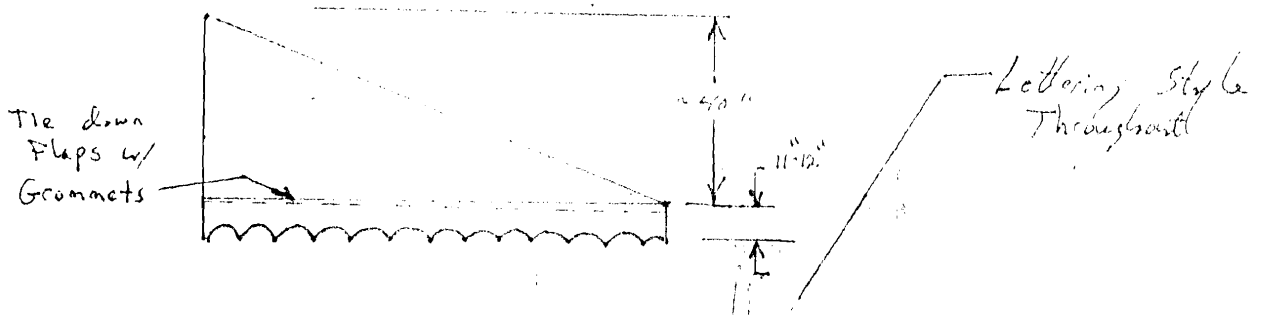
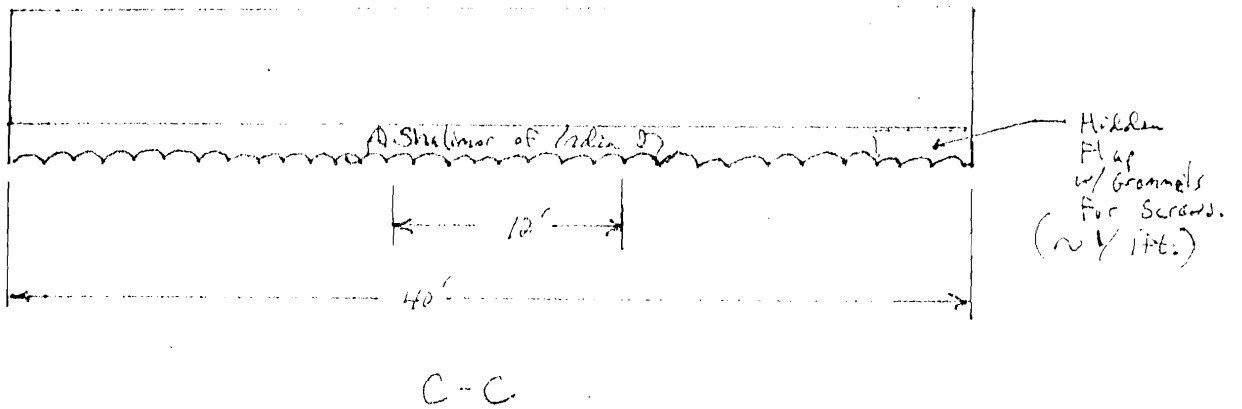
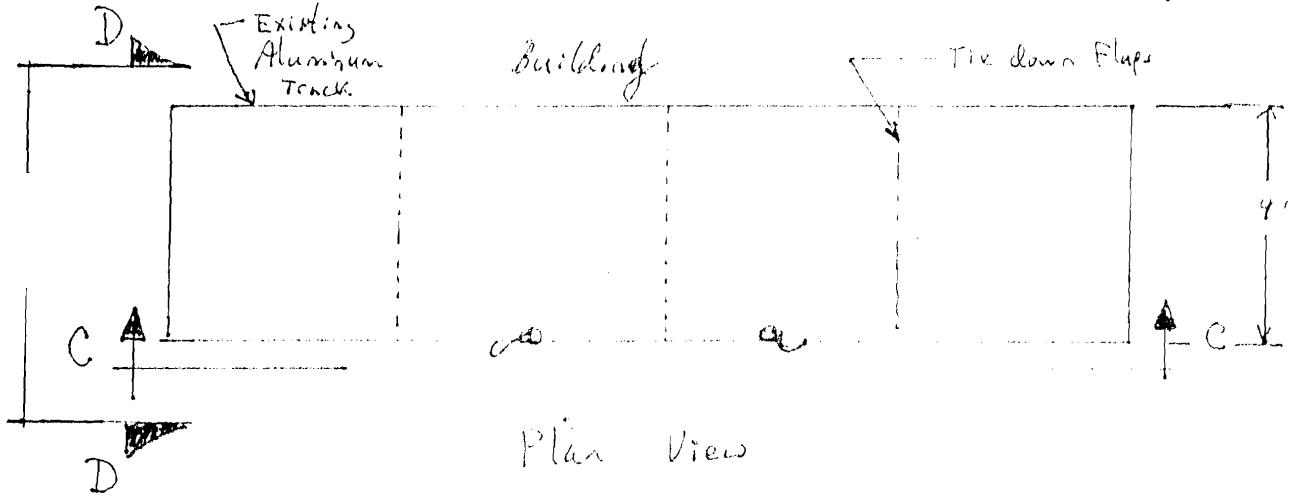

# Shalimar of India Restaurant

Color of Canvas: Maroon  
 Color of Letters: Cream  
 Size: Same as Existing  
 Lettering Size: Same as Existing.  
 Lighting: Same.

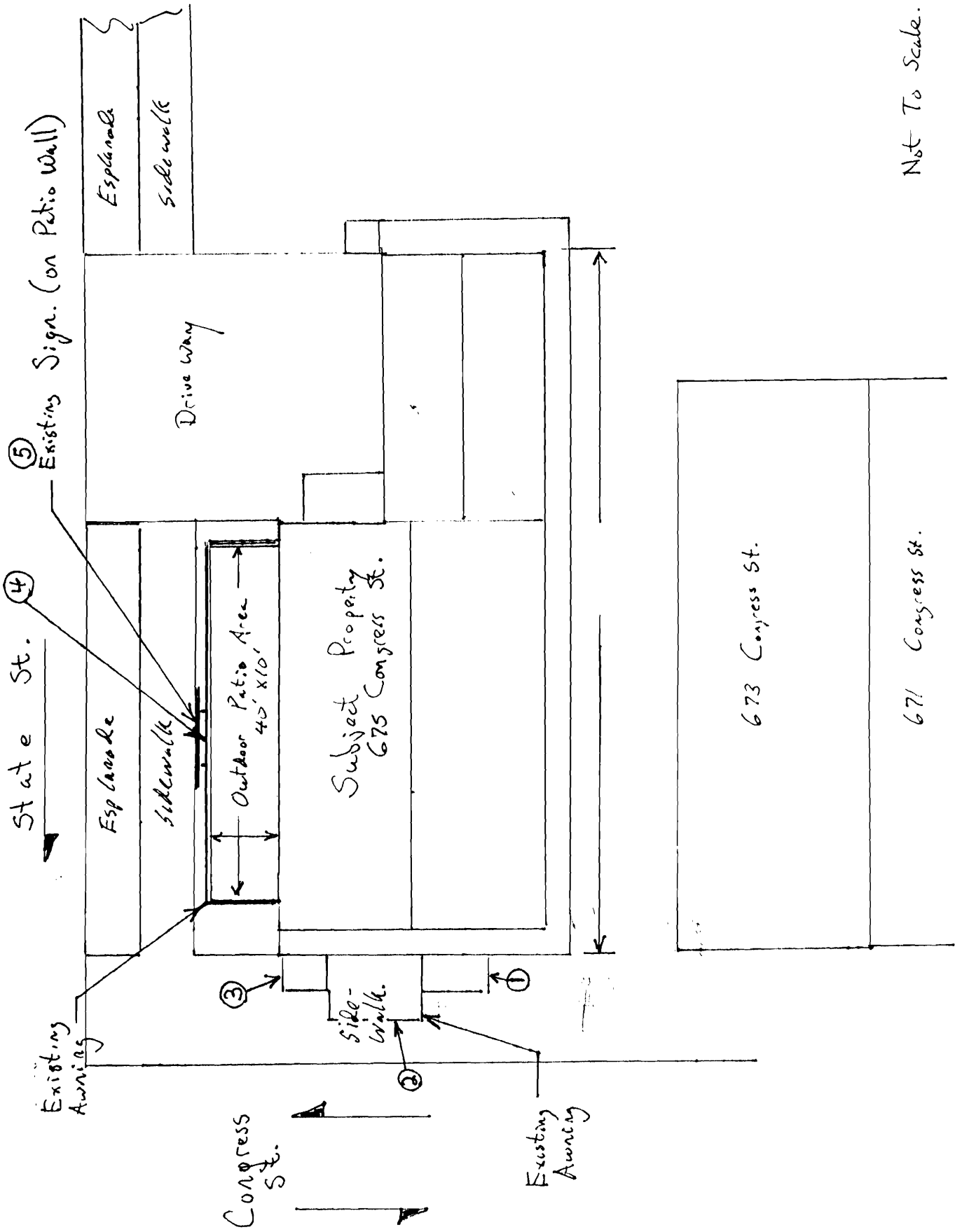

Not To Scale.