

235 STATE STREET
PORTLAND, MAINE
STRUCTURAL STABILIZATION

RESURGENCE
ENGINEERING & PRESERVATION, INC.
132 BRENTWOOD STREET
PORTLAND, ME 04103
207.773.4890

0

1 SITE PLAN
SCALE 1/4" = 1' 0"

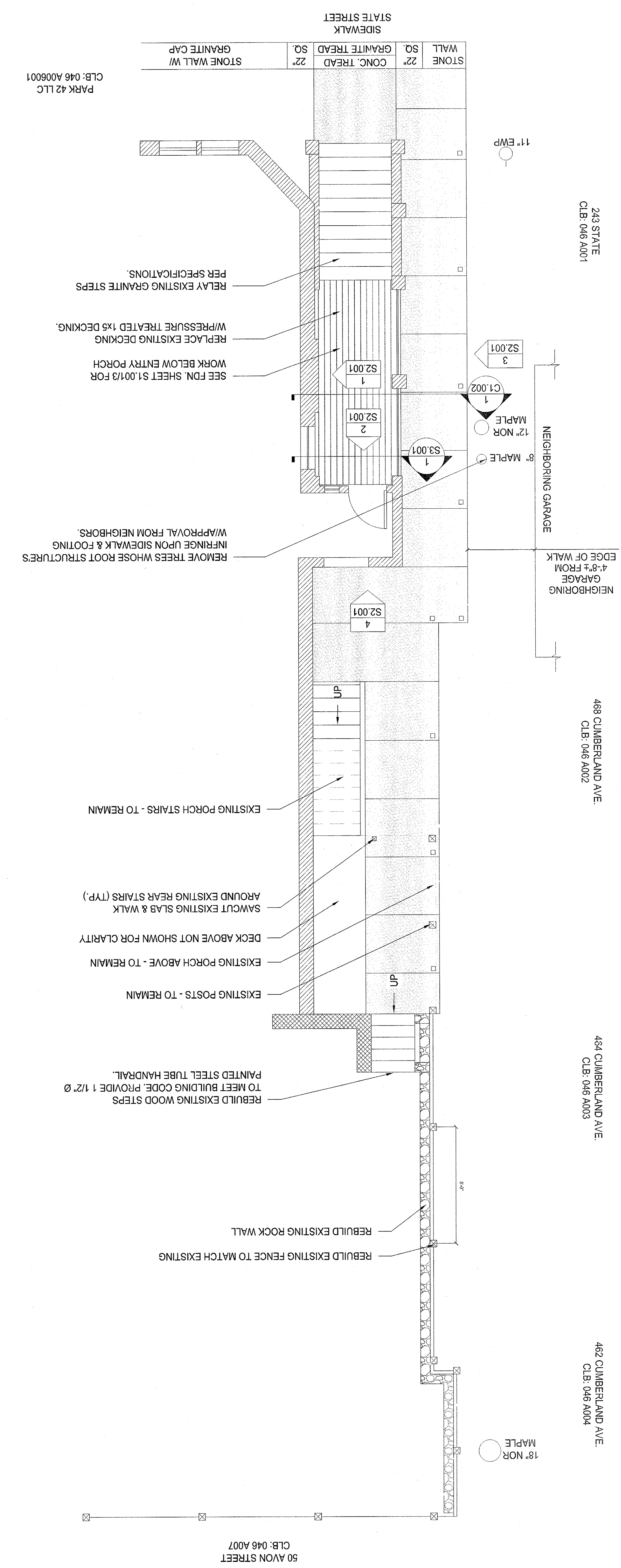

PARK 42 LLC
CLB: 046 A006001

235 STATE
CLB: 046 A001

488 CUMBERLAND AVE
CLB: 046 A002

484 CUMBERLAND AVE
CLB: 046 A003

482 CUMBERLAND AVE
CLB: 046 A004

50 AVON STREET
CLB: 046 A007

SEE FDN. SHEET S1.001/3 FOR
WORK BELOW ENTRY PORCH

REPLACE EXISTING DECKING
W/PRESSURE TREATED 1x5 DECKING.

RELAY EXISTING GRANITE STEPS
PER SPECIFICATIONS.

REMOVE TREES WHOSE ROOT STRUCTURES
INFRINGE UPON SIDEWALK & FOOTING
W/APPROVAL FROM NEIGHBORS.

EXISTING POSTS - TO REMAIN

EXISTING PORCH ABOVE - TO REMAIN

DECK ABOVE NOT SHOWN FOR CLARITY

SAWCUT EXISTING SLAB & WALK
AROUND EXISTING REAR STAIRS (TYP.)

EXISTING PORCH STAIRS - TO REMAIN

REBUILD EXISTING WOOD STEPS
TO MEET BUILDING CODE. PROVIDE 1 1/2" Ø
PAINTED STEEL TUBE HANDRAIL.

REBUILD EXISTING ROCK WALL

REBUILD EXISTING FENCE TO MATCH EXISTING