



Job #: 9882863 Customer: Phil's Rentals Date: 3/7/17

Consultant: L.T. Lewis Consultant Cell No.: 302 854-4586

Install: Seamless Aluminum 5" or 6" Gutter with Standard or Commercial Downspouts

SKETCH ENTIRE ROOF

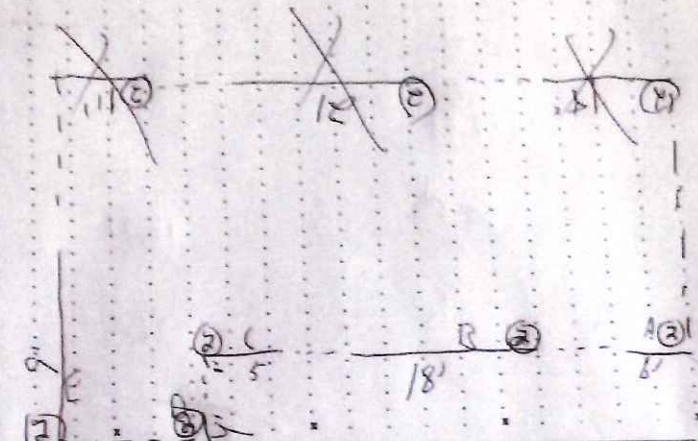

Key Code: Install Gutter: \_\_\_\_\_ No Gutter: \_\_\_\_\_ 1 Story Down Spouts 2 Story Down Spouts P Power Line(s)

MEASUREMENTS AND SPECIFICATIONS

1. Remove Existing Gutter (v one) Yes  No  Leaf Protection Panel Yes  No

2. Gutters - (Linear Feet)  
 Section A: 6'  
 Section B: 7'8"  
 Section C: 6'  
 Section D: 4'9"  
 Total Lin Ft: 43'

3. Leaf Protection - (Linear Feet)  
 Section A: \_\_\_\_\_  
 Section B: \_\_\_\_\_  
 Section C: \_\_\_\_\_  
 Section D: \_\_\_\_\_  
 Total Lin Ft: \_\_\_\_\_

4. Total Feet of Downspouts  
 Total Feet of 1 Story DIS (Each DIS 13") # DIS \_\_\_\_\_ x 13 = \_\_\_\_\_  
 Total Feet of 2 Story DIS (Each DIS 23") # DIS 5 x 23 = 115'  
 Note: 6" Gutter = one DIS every 40', 5" Gutter = one DIS every 30'

Gutter Color: White LP Color: \_\_\_\_\_

5. Roof Type (v one): Composition  Metal  Tile  6. Other Fascia Board  Open Rafter Tails  (select one style below)

PROPERTY CONSIDERATIONS (v all that apply)  
 Power Lines: may need to turn-off  Poor Access: special equipment required



Measure Sheet MUST be included with all iPad sales

Pictures are REQUIRED on All Jobs

COMMENTS