

# MERCY HOSPITAL STATE STREET 3B MODIFICATIONS



144 Fore Street/P.O. Box 618  
Portland, Maine 04104  
tel. (207) 772-3846  
fax. (207) 772-1070  
www.smrftinc.com



ARCHITECTURE  
ENGINEERING  
PLANNING  
INTERIORS  
ENERGY

**SMRT**

MERCY STATE STREET  
3B MODIFICATIONS  
PORTLAND, MAINE

## SCOPE OF WORK:

THIS PROJECT ENTAILS ADDING A CROSS CORRIDOR PARTITION WITH A SINGLE 4' DOOR TO SEPARATE ONE PATIENT WING FROM THE REST OF THE FLOOR. THE CURRENT NURSE STATION WILL BE SUBDIVIDED TO PROVIDE A DEDICATED WORK SPACE FOR THE SEPARATED WING.

AREA OF AFFECTED CONSTRUCTION IS APPROX 180 SF.

CORRIDORS WILL NOT CHANGE.  
EXIT SIGNS AND DEVICES WILL BE RELOCATED.

BUILDING IS 1-2 HOSPITAL OCCUPANCY  
CONSTRUCTION TYPE IS 1B

### APPLICABLE CODES

THIS PROJECT WAS DESIGNED ACCORDING TO THE FOLLOWING CODES:

**FIRE:** NFPA INCLUDING 101 LIFE SAFETY CODE, 2009 EDITION

**BUILDING:** IBC BUILDING CODE, 2009 EDITION

**ACCESSIBILITY:** ADA, ACCESSABILITY GUIDELINES FOR BUILDINGS AND FACILITIES 2010 EDITION.

**ELECTRICAL:** 2008 NATIONAL ELECTRIC CODE  
2009 INTERNATIONAL ENERGY CONSERVATION CODE

## DRAWING LIST

### GENERAL

GI001 COVER SHEET

### ARCHITECTURAL

AE101 FLOOR PLAN

### ELECTRICAL

E-001 LEGEND AND GENERAL NOTES

ED101 ELECTRICAL DEMOLITION PLAN

EP101 ELECTRICAL NEW WORK PLAN

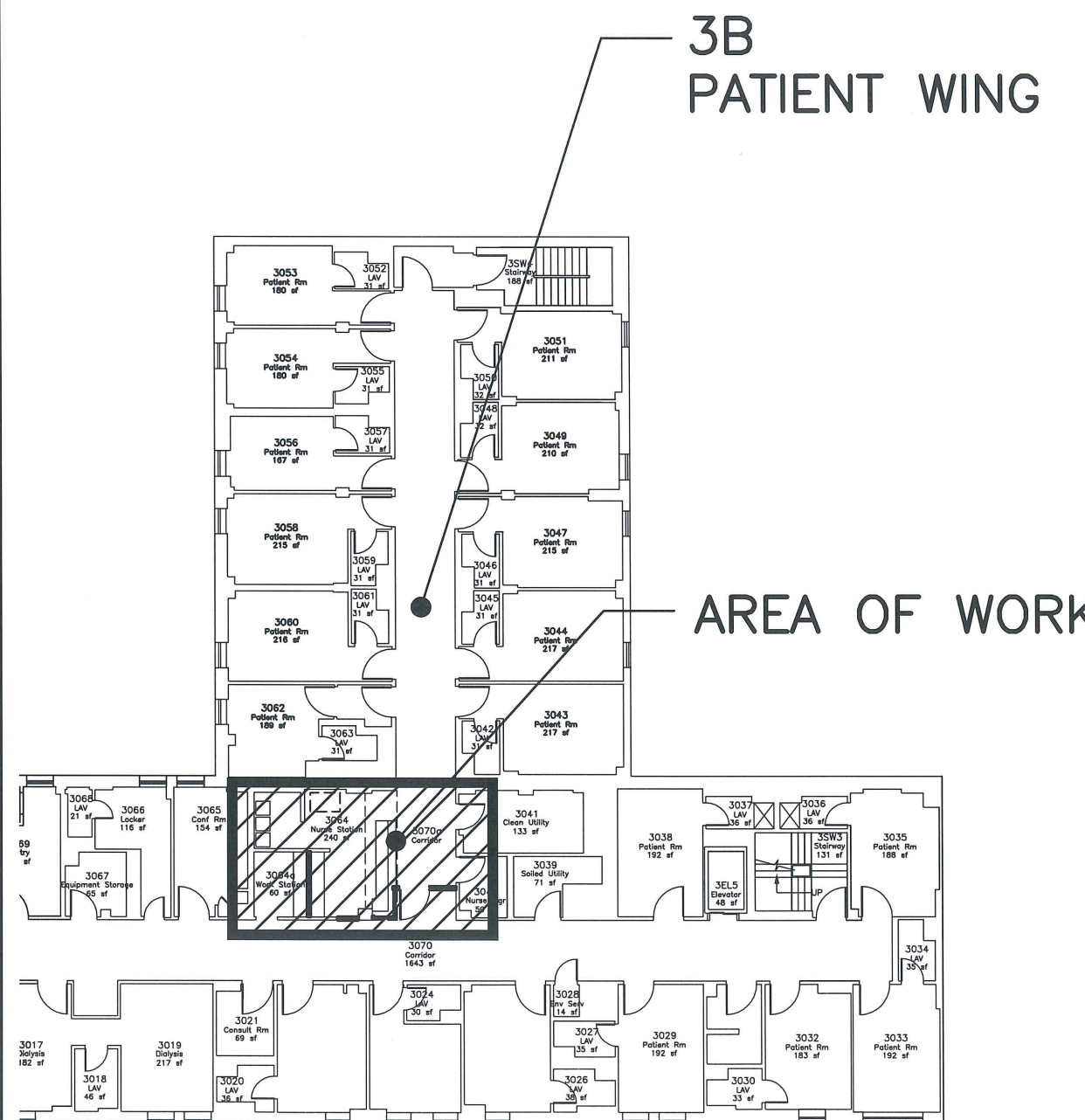

ISSUE FOR PERMIT  
06/10/15

CURRENT ISSUE STATUS:

REV	DESCRIPTION	DATE

SCALE: N/A

PROJECT MANAGER: KD

JC/DRAWN BY: KD

A/E OF RECORD: KD

CAD FILE: GI001-15098

PROJECT NO: 15098

DATE: 6/12/15

SHEET TITLE:

COVER SHEET

SHEET No. **GI - 001**