

3 LOW ROOF TO BRICK FLASHING
THIS DETAIL IS TYPICAL FOR MOST AT MASONRY WALL FLASHING DETAILS

SCALE: 6"=1'-0"

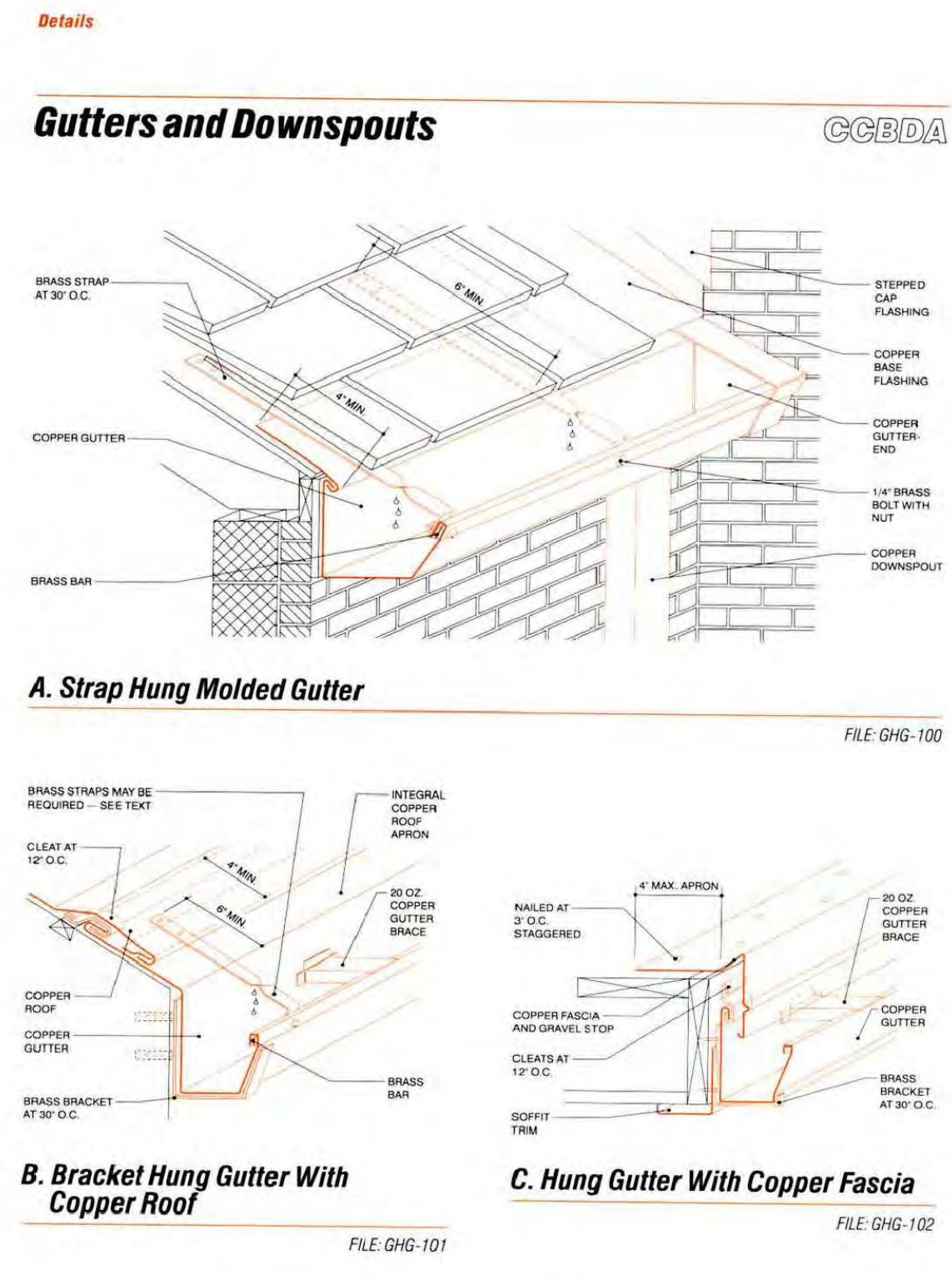

3 GUTTER DETAILS AT SLATE ROOF

SCALE: NTS

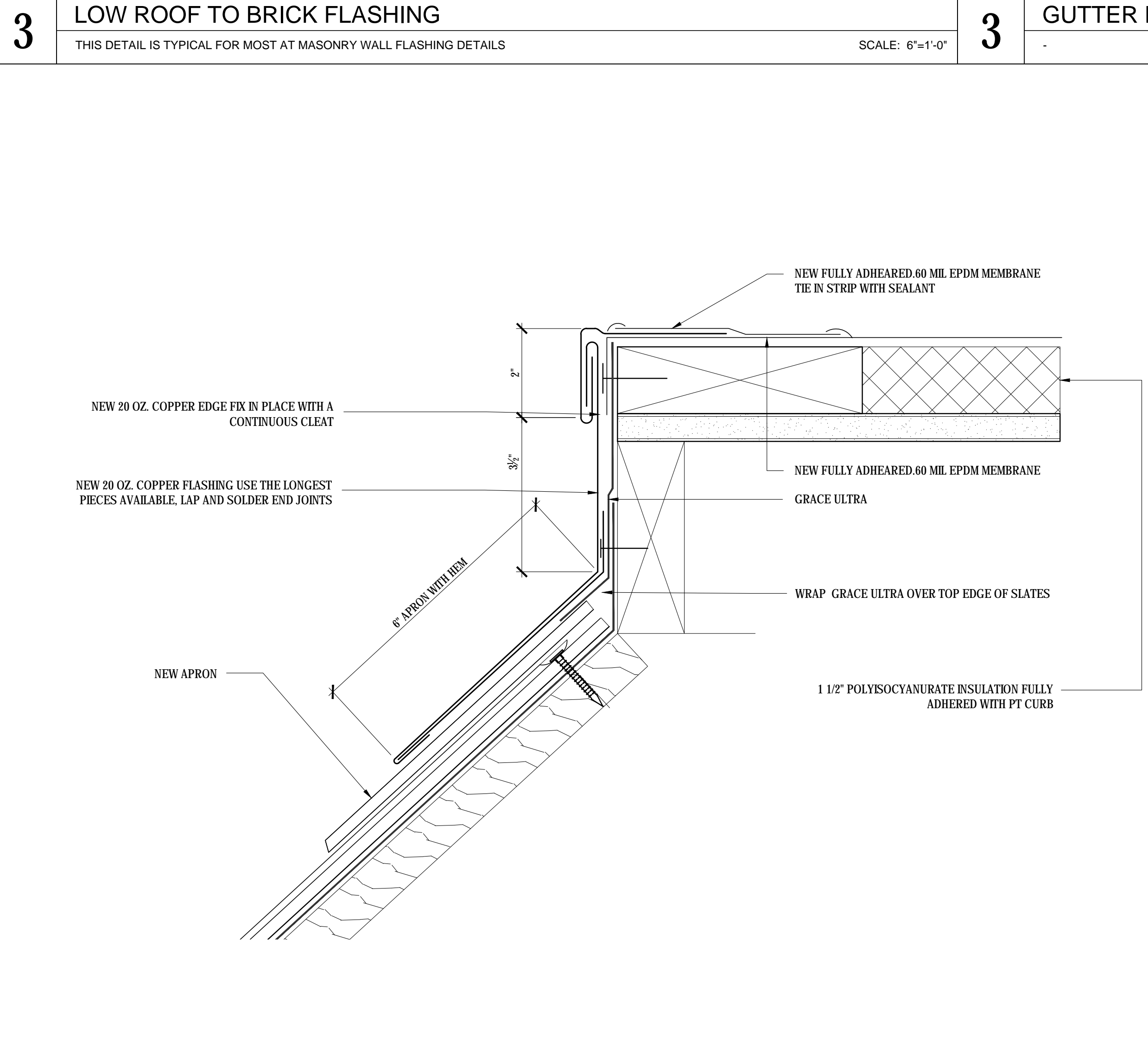
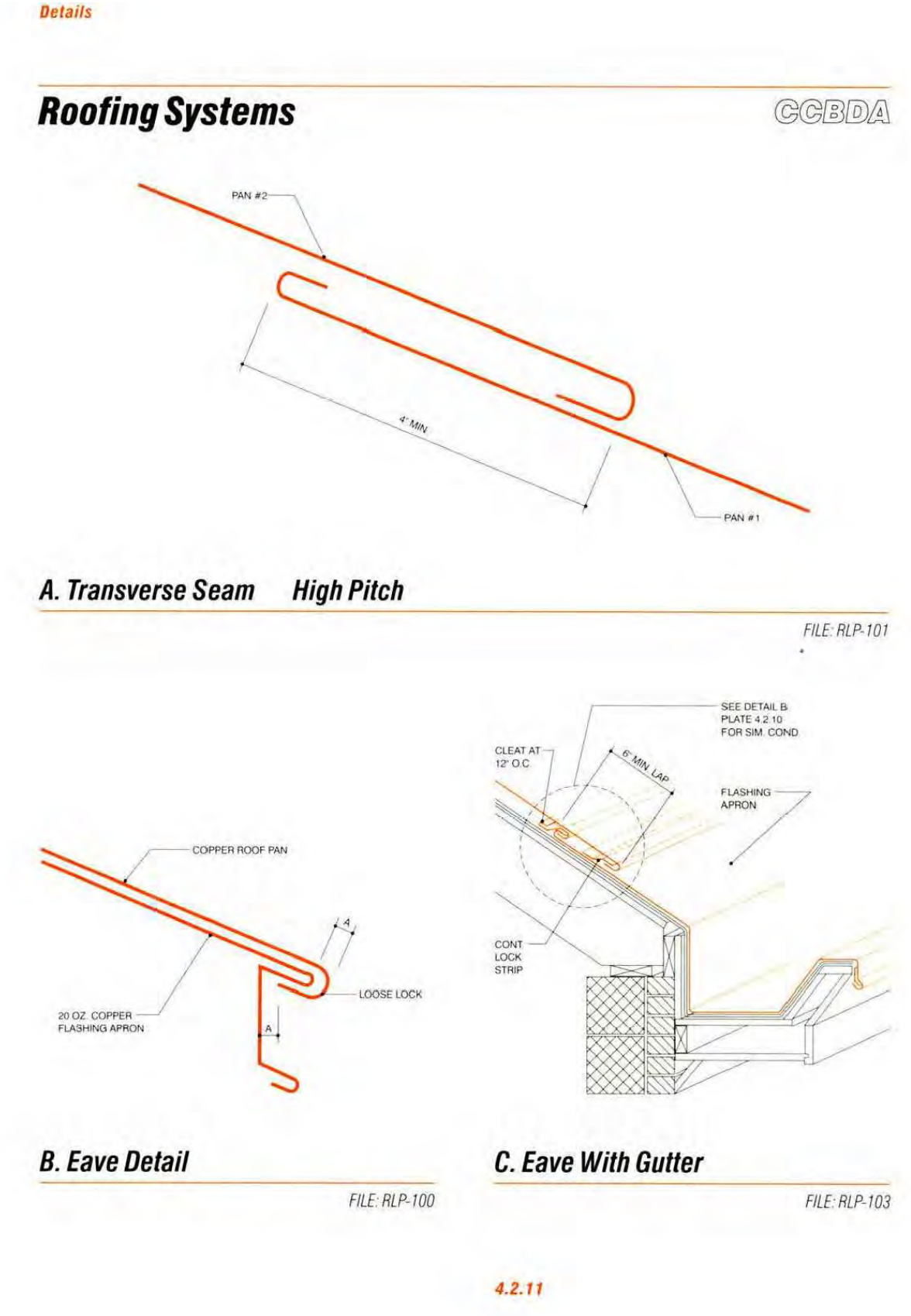

1 ROOF EDGE DETAIL
THE INTENTION OF THIS DETAIL IS TO REPLICATE THE ORIGINAL WITH NEW INSULATION THICKNESS ADDED.

SCALE: 6"=1'-0"

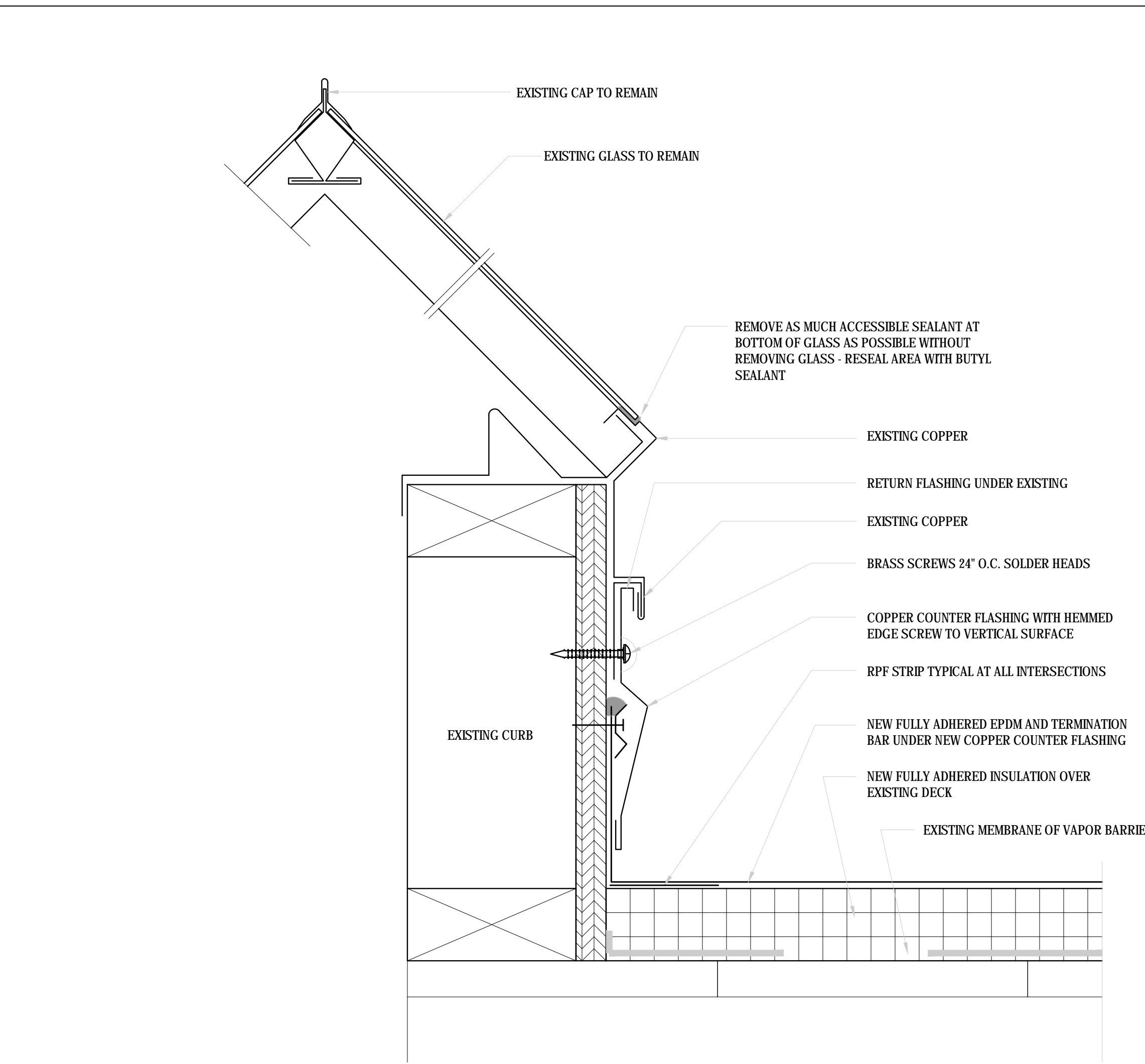

2 FLASHING DETAIL AT SKYLIGHT

SCALE: 6"=1'-0"

ISSUED FOR CONSTRUCTION

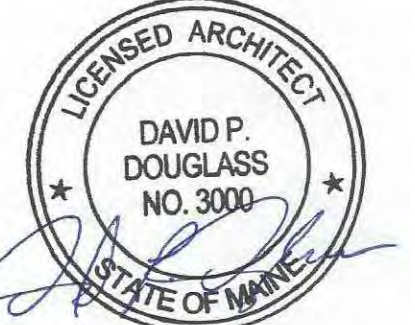

02/01/2016

Building Envelope Specialists
SPECIALIZED BUILDING CONSULTANTS
PO BOX 2589, SOUTH PORTLAND MAINE, 04116
PHONE: 207-400-0086

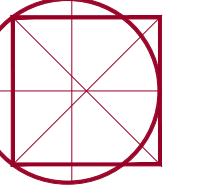

Episcopal Diocese of Maine
143 State Street Portland
LORING HOUSE
BUILDING ENVELOPE MASONRY REPAIR

REVISIONS

DRAWN BY: RJH
CHECKED BY: DPD
DATE: 02-01-2016
ISSUED: CONSTRUCTION DOCUMENTS

ROOF DETAILS

A1.3

SCALE: AS NOTED
PROJECT NUMBER: 008-15
© BUILDING ENVELOPE SPECIALISTS, INC. 2012