

**GENERAL NOTE:**  
 ALL WORK ON THIS PROJECT SHALL BE CONSISTENT WITH GOOD CONSTRUCTION PRACTICE AND SHALL CONFORM TO ALL APPLICABLE CODES AND REGULATIONS, INCLUDING BUT NOT LIMITED TO THE FOLLOWING:  
 MAINE UNIFORM BUILDING AND ENERGY CODE  
 PORTLAND CITY CODE INCLUDING CHAPTER 10-FIRE PREVENTION AND PROTECTION (INCL. NFPA 1 FIRE CODE AND NFPA 101, LIFE SAFETY CODE)  
 INTERNATIONAL RESIDENTIAL CODE 2009

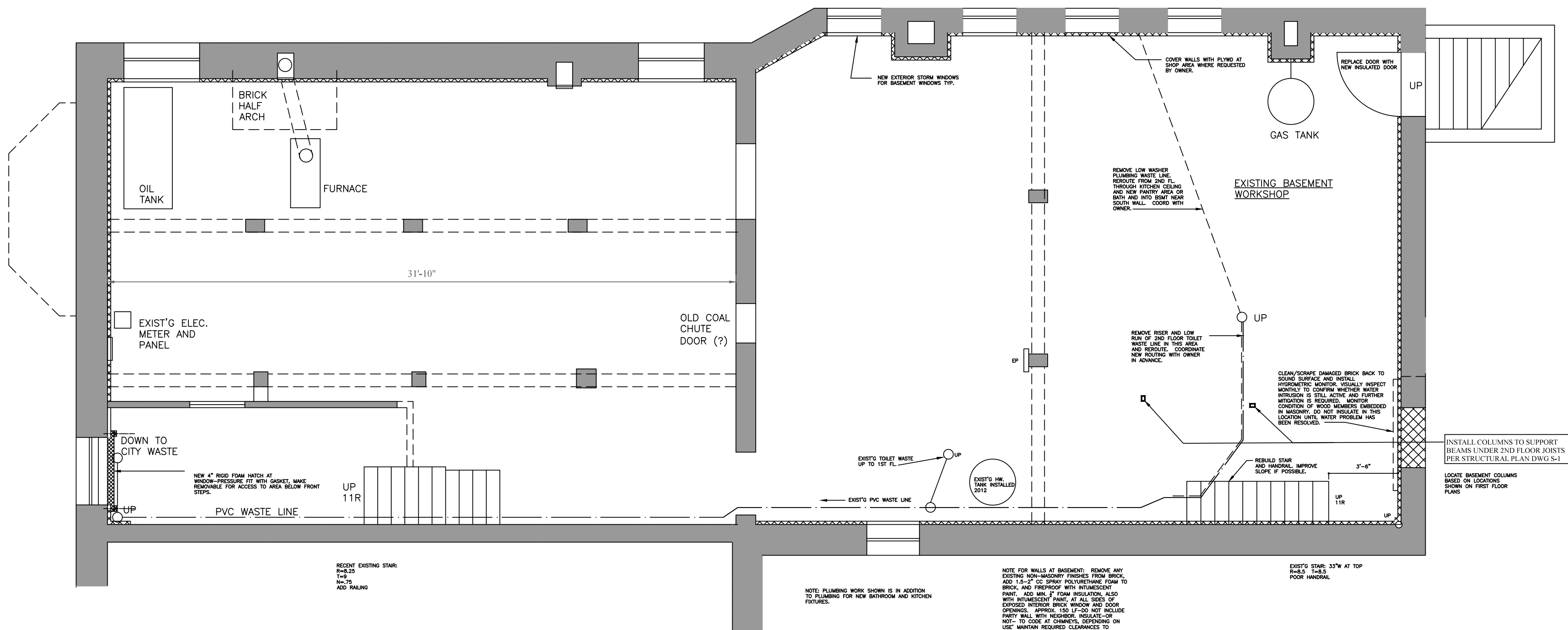

**1** BASEMENT FLOOR PLAN  
 SCALE: 1/4" = 1'-0"  
 0 1 2 3 4 5 10 15

Key Plan  
 Not to scale

Elizabeth Newman  
 Architect

32 Sawyer Street  
 Portland Maine 04103  
 w.207.899.1845 c.207.6215.6564  
 newman.liz@gmail.com

Mateosian  
 Family Home

143 Spring Street  
 Portland, Maine 04101

Drawing Title

Basement  
 Floor Plan

Scale AS NOTED

Date APRIL 30, 2013

Project No. 12.09

Drawing No.

A3