

SECTION NOTES

1.) TOP OF SUB FLOOR IS 3/4" BELOW FINISHED FLOOR AT ALL NEW FRAMED FLOOR LEVELS, U.N.O.



© 2016 RYAN SENATORE ARCHITECTURE

LAYFAYETTE BUILDING RENOVATION
PARK STREET
PORTLAND, MAINE

RSA
 RYAN SENATORE ARCHITECTURE
 565 CONGRESS STREET
 PORTLAND, MAINE 04101
 207-747-5159
 senatorearchitecture.com

CONSULTANTS:

REVISIONS:
 REVISION #1 - 8/2/17

DATE: SEPTEMBER 29, 2016

PROJECT No. 1621

DRAWN BY: RJS, RRT

CHECKED BY: RJS

SCALE: AS NOTED

SHEET TITLE:
 SECTIONS

A3-4

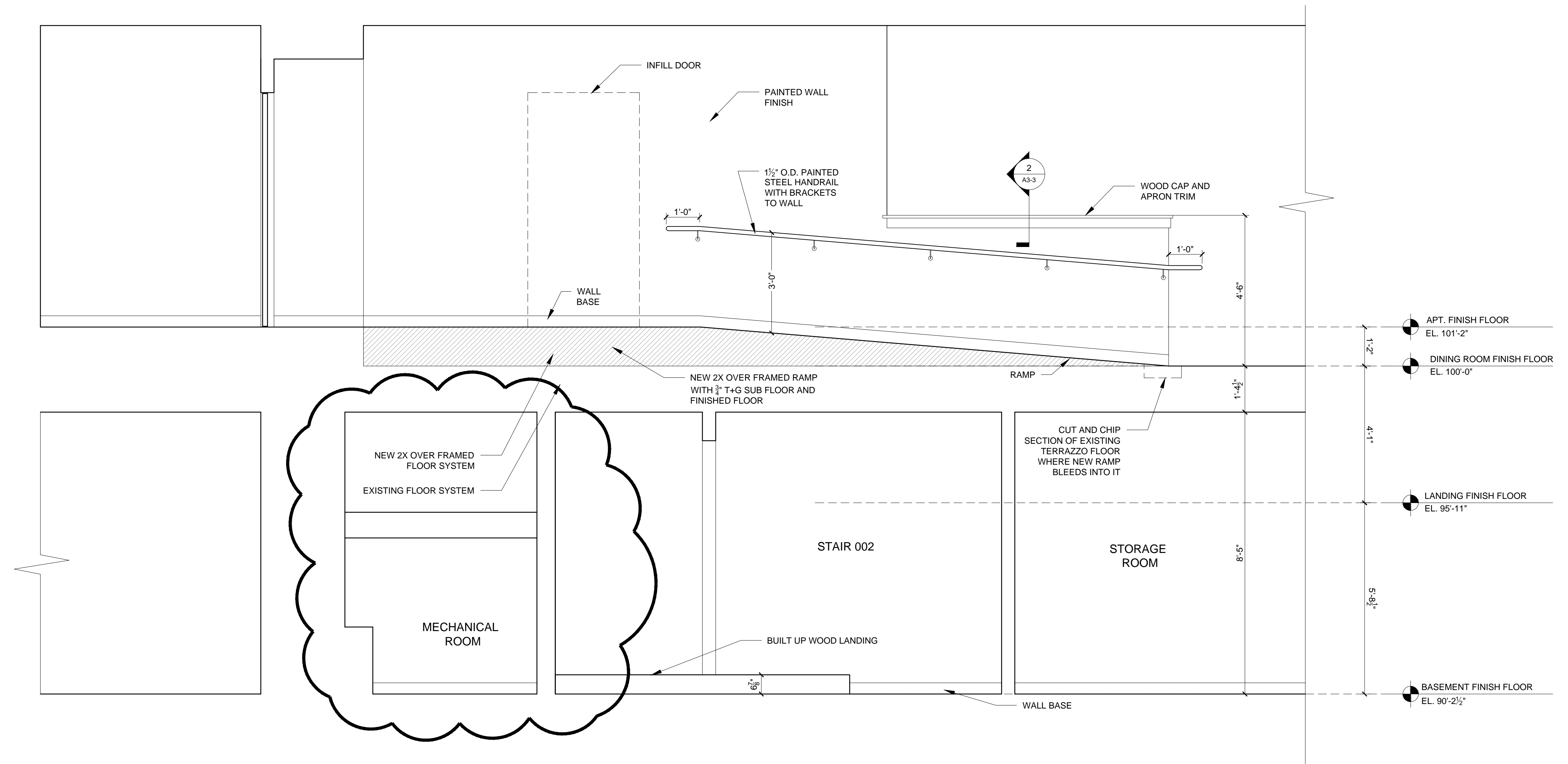

1 SECTION AT BASEMENT LANDING
 1/2" = 1'-0"