

| WALL LEGEND | |
|-------------------------|--|
| EXISTING WALL TO REMAIN | |
| WALL TO BE REMOVED | |

| DEMO LEGEND | |
|-------------|-----------------|
| R-F | REMOVE FLOORING |
| R-C | REMOVE CEILING |

- DEMOLITION NOTES**
- 1.) ALL HAZARDOUS MATERIALS TO BE REMOVED AND DISPOSED OF IN ACCORDANCE WITH ALL FEDERAL, STATE AND LOCAL REGULATIONS.
 - 2.) IF ANY ELEMENTS TO BE REMOVED ARE FOUND TO BE STRUCTURAL, THE G.C. SHALL NOTIFY THE ARCHITECT IN WRITING PRIOR TO REMOVING SUCH ELEMENTS
 - 3.) REMOVAL ALL UNUSED PLUMBING, ELECTRICAL, AND MECHANICAL ELEMENTS THAT ARE NOT PROPOSED TO BE REUSED
 - 4.) AT LOCATIONS OF FLOORING INDICATED TO BE REMOVED REMOVE ALL LAYERS OF FINISHED FLOORING UNDERLAYMENT AND ADHESIVES DOWN TO SLAB OR SHEATHING
 - 5.) AT LOCATIONS OF CEILINGS INDICATED TO BE REMOVED REMOVE ALL CEILINGS, TILES, GRIDS, AND STRAPPING TO JOISTS OR FRAMING AS WELL AS ANY IN CEILING ELEMENTS NOT SCHEDULE TO BE REUSED
 - 6.) RELOCATE AND REINSTALL ANY AND ALL FUNCTIONING MECHANICAL, ELECTRICAL AND PLUMBING ELEMENTS LOCATED IN WALLS, FLOORS AND CEILINGS INDICATED TO BE REMOVED
 - 7.) REMOVE ALL WALL COVERINGS ON WALLS INDICATED TO BE REMOVED, REPAINTED OR RE COVERED
 - 8.) PATCH AND REPAIR ALL WALLS CEILINGS AND FLOORS AT LOCATIONS OF REMOVED INTERSECTING WALLS, REMOVED BUILT-INS, ETC.

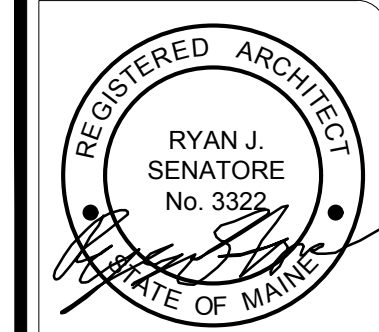
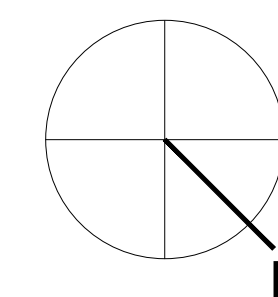
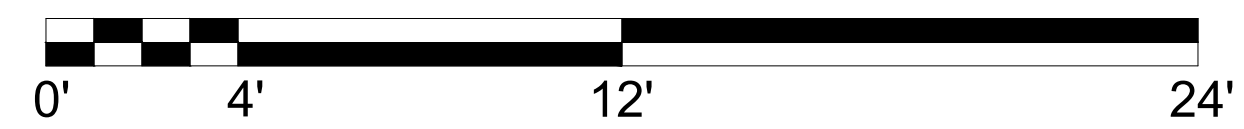
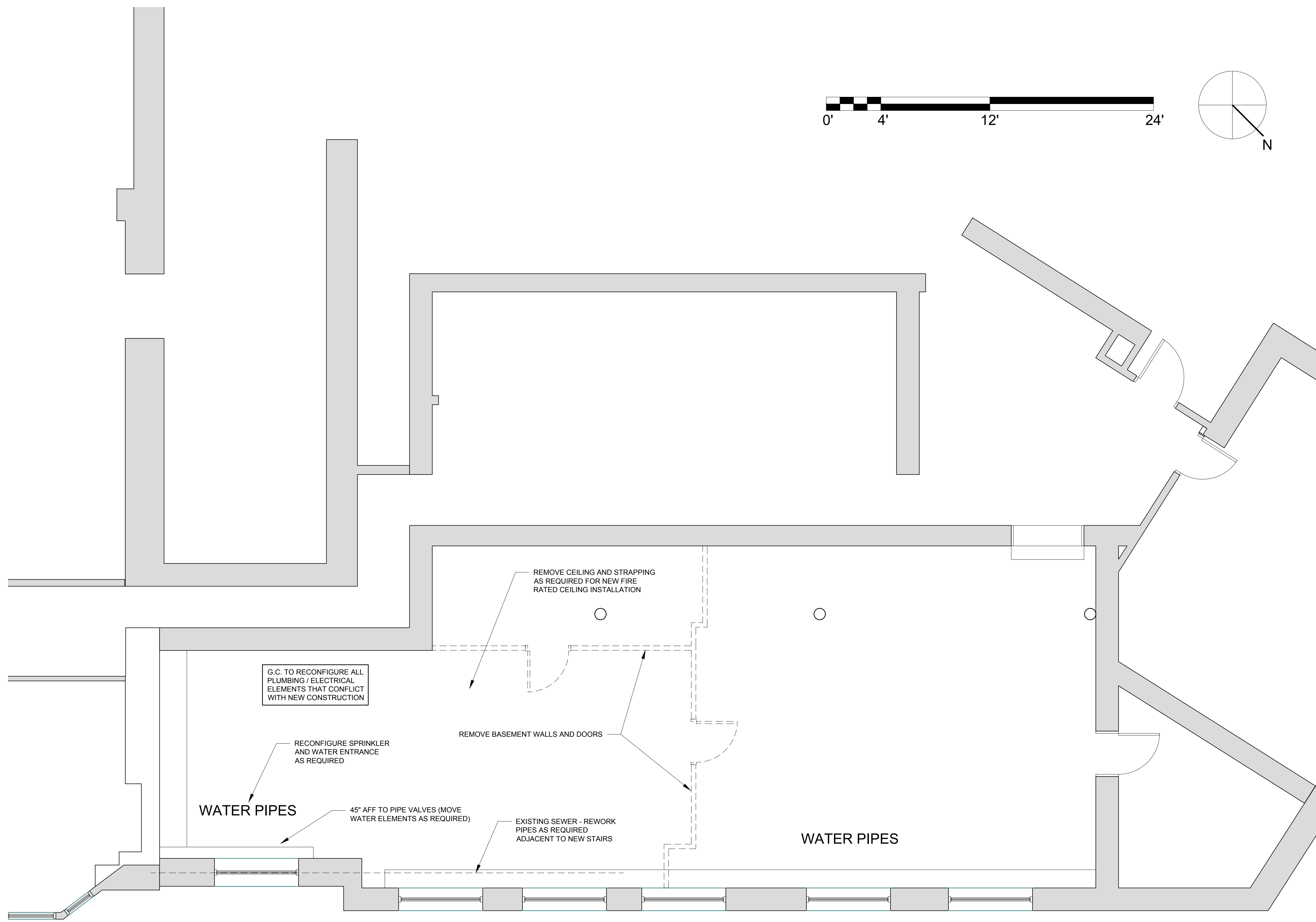

© 2016 RYAN SENATORE ARCHITECTURE

LAYFAYETTE BUILDING RENOVATION
 PARK STREET
 PORTLAND, MAINE



RYAN SENATORE
ARCHITECTURE
 565 CONGRESS STREET
 PORTLAND, MAINE 04101
 207-747-5159
 senatorearchitecture.com

CONSULTANTS:

REVISIONS:

DATE: SEPTEMBER 29, 2016

PROJECT No. 1621

DRAWN BY: RJS, RRT

CHECKED BY: RJS

SCALE: AS NOTED

SHEET TITLE:
 BASEMENT
 DEMO PLAN

1 BASEMENT DEMO PLAN
 1/4" = 1'-0"

AD1-0