

© 2016 RYAN SENATORE ARCHITECTURE

LAYFAYETTE BUILDING RENOVATION  
PARK STREET  
PORTLAND, MAINE



RYAN SENATORE  
ARCHITECTURE  
565 CONGRESS STREET  
PORTLAND, MAINE 04101  
207-747-5159  
senatorearchitecture.com

CONSULTANTS:

REVISIONS:

DATE: SEPTEMBER 29, 2016

PROJECT No. 18231

DRAWN BY: RJS, RRT

CHECKED BY: RJS

SCALE: AS NOTED

SHEET TITLE:  
DETAILS

A5-1

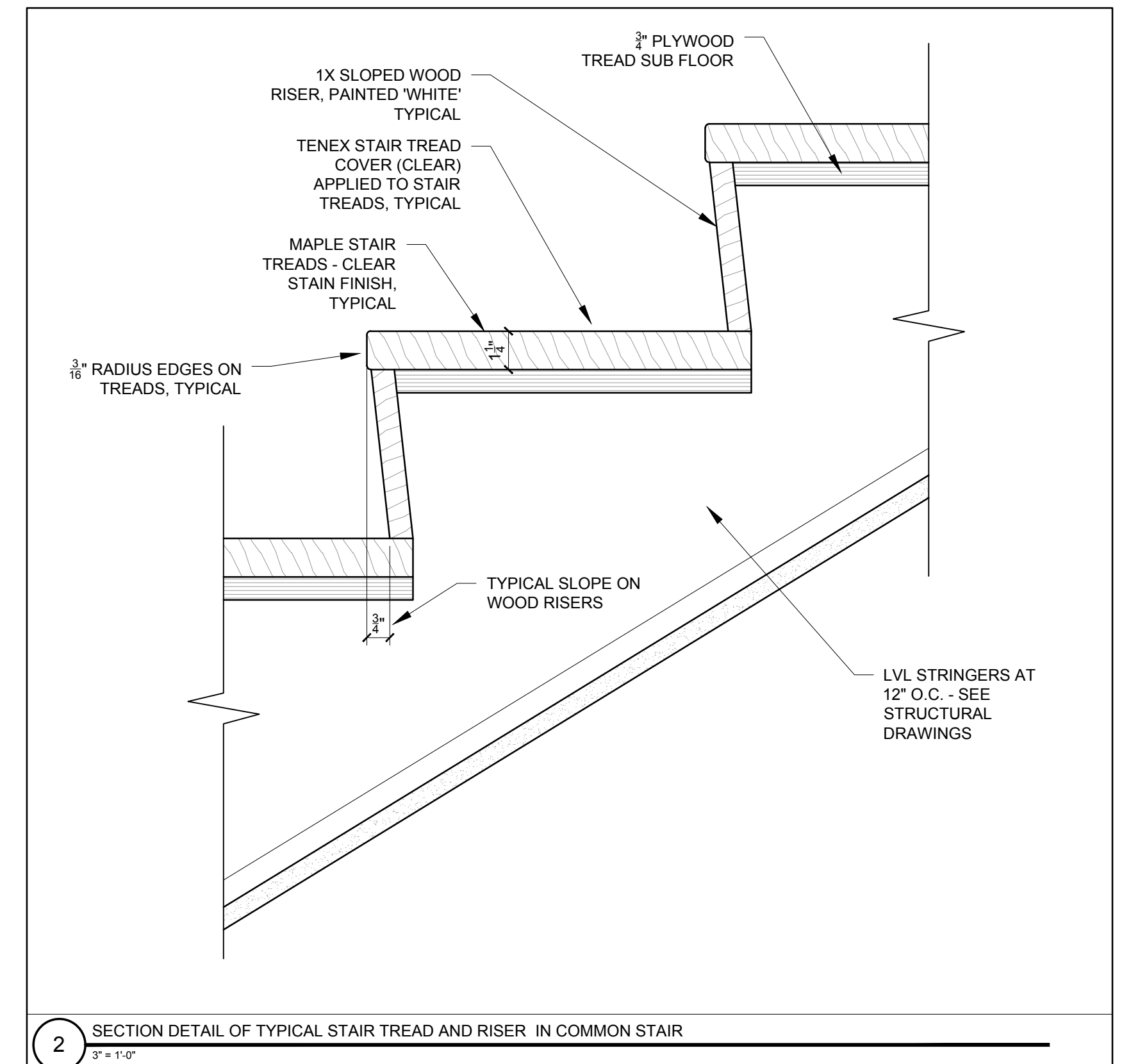

2 SECTION DETAIL OF TYPICAL STAIR TREAD AND RISER IN COMMON STAIR  
3" = 1'-0"

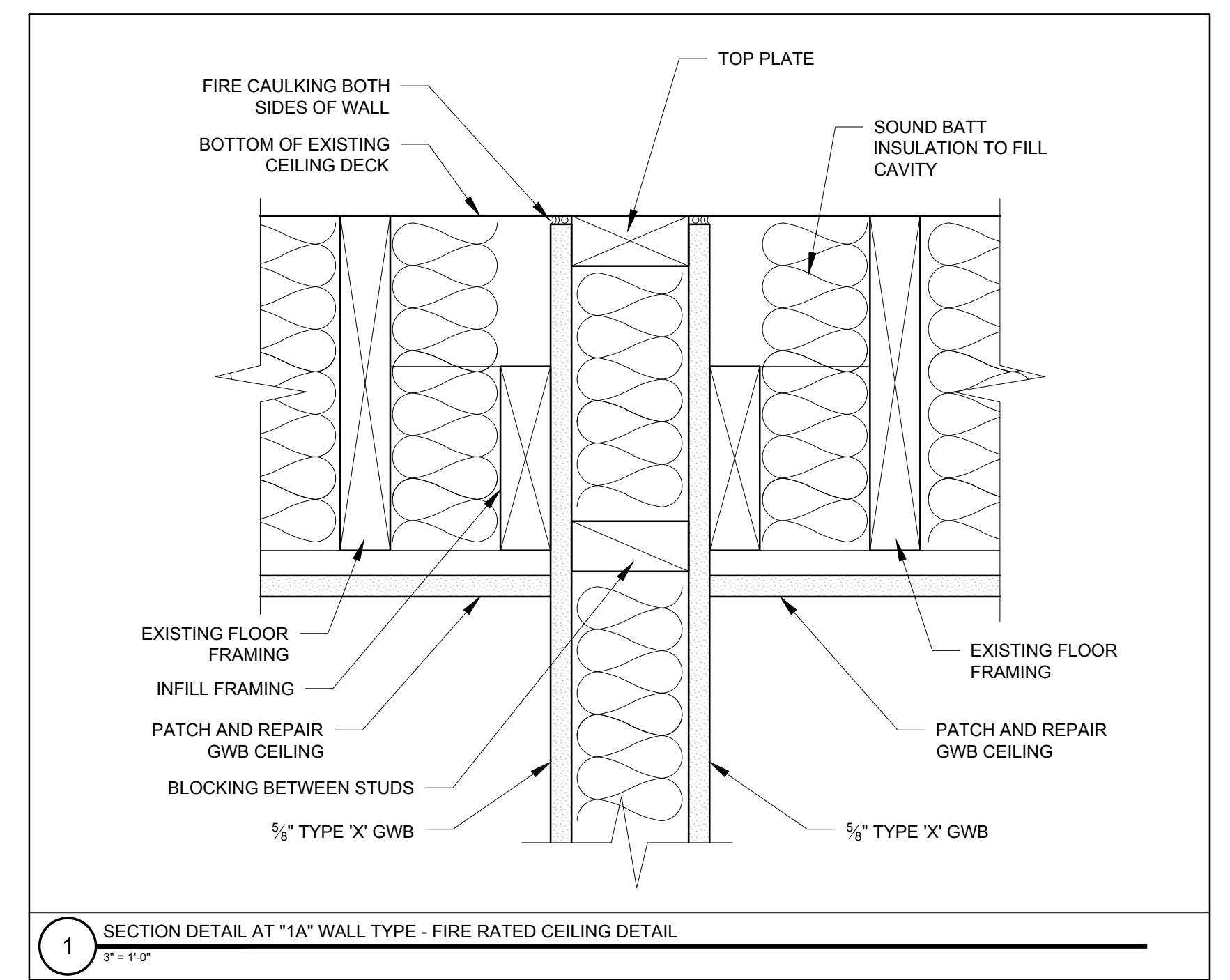

1 SECTION DETAIL AT 1 1/2" WALL TYPE - FIRE RATED CEILING DETAIL  
3" = 1'-0"

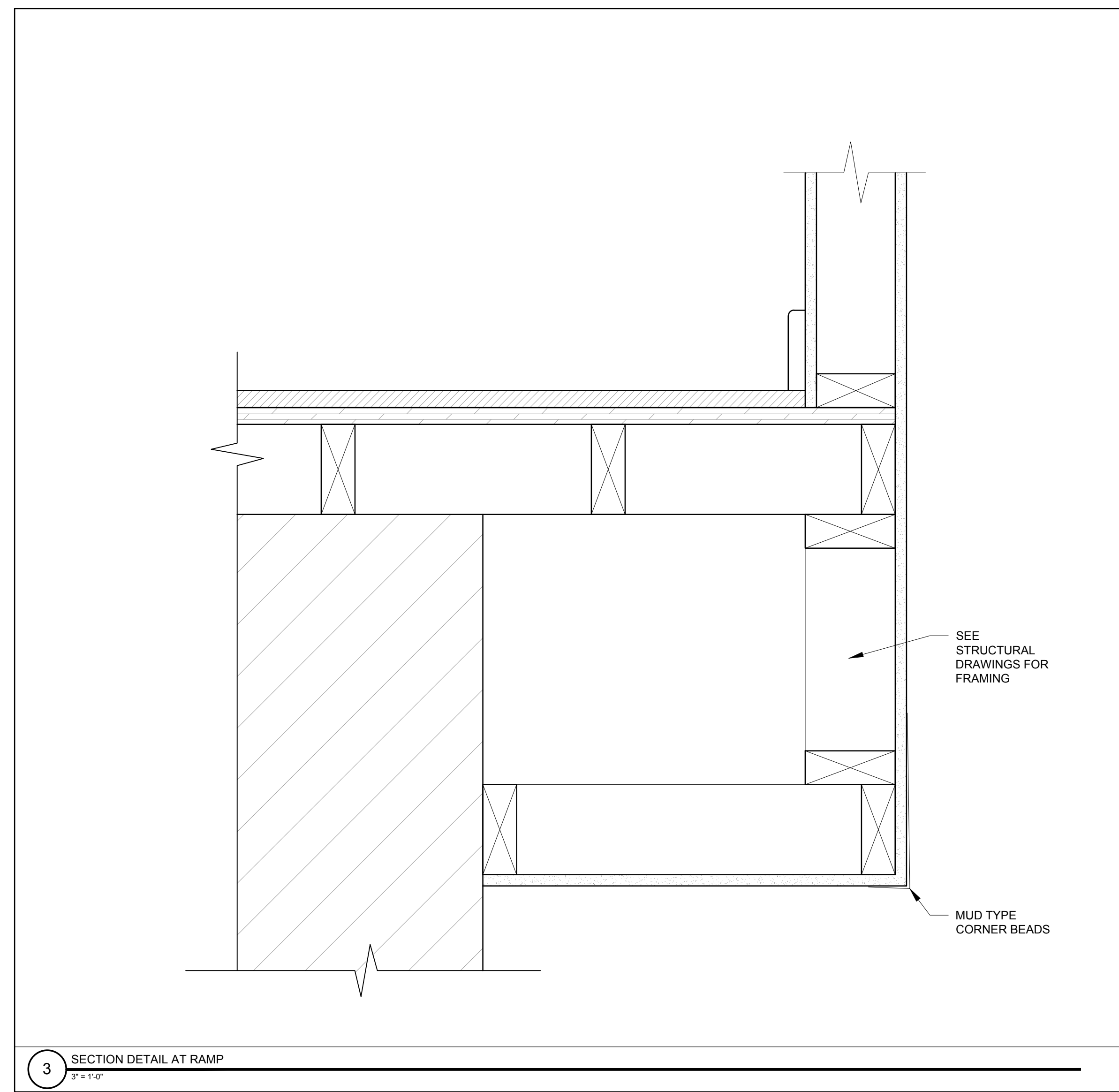

3 SECTION DETAIL AT RAMP  
3" = 1'-0"

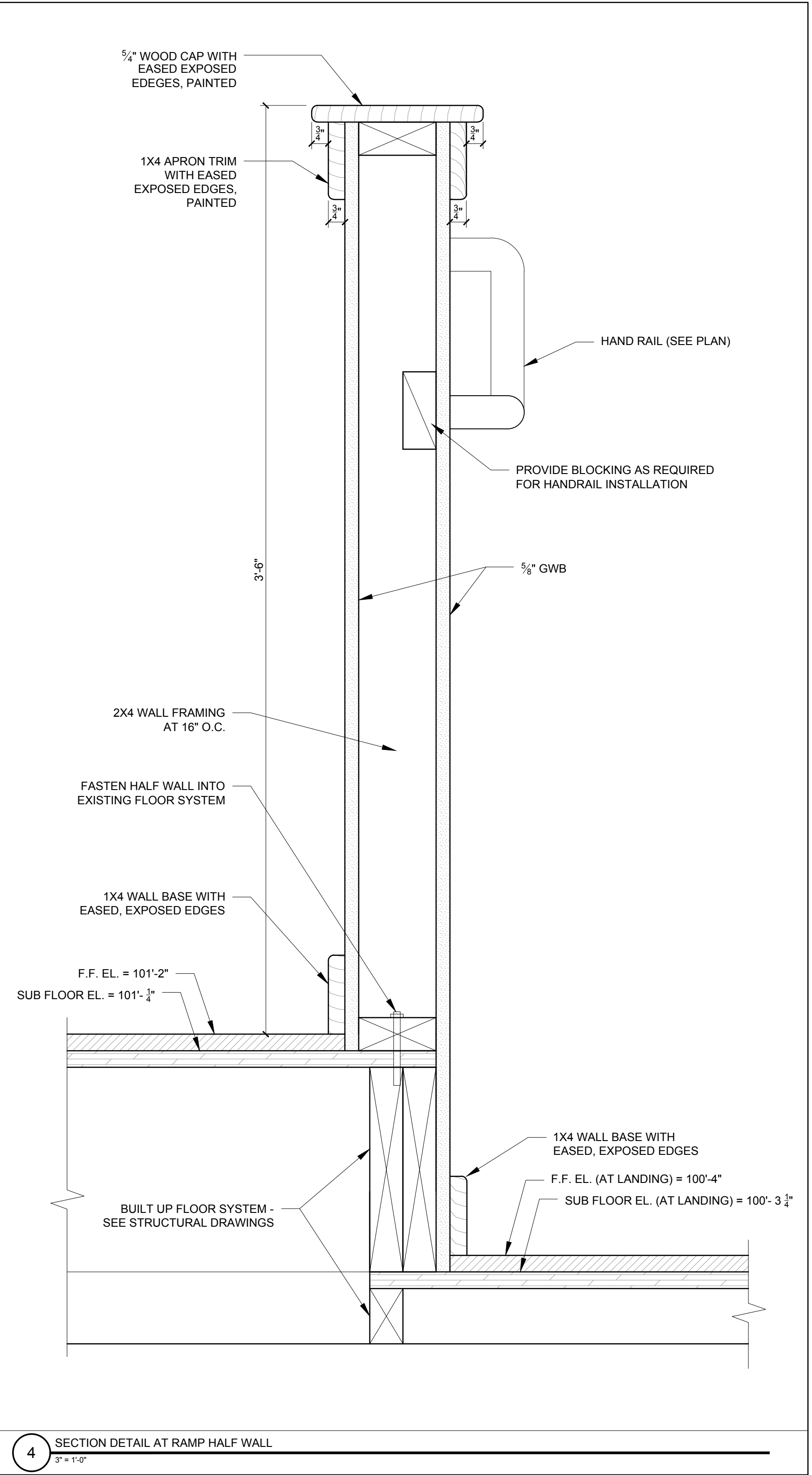

4 SECTION DETAIL AT RAMP HALF WALL  
3" = 1'-0"