

**660-662  
CONGRESS  
STREET**

PORTLAND, MAINE

ARCHITECT:  
**PRESENT ARCHITECTURE PLLC**  
66 WEST BROADWAY, SUITE 306  
NEW YORK, NY 10007  
T: (207) 449-8513

CONTRACTOR:  
**BAYHILL BUILDING & DESIGN**  
P.O. BOX 178  
SOUTH FREEPORT, ME 04078  
T: (207) 865-9351

STRUCTURAL ENGINEER:  
**ENGINEERING DESIGN  
PROFESSIONALS**

P.O. BOX 575  
FREEPORT, ME 04032  
T: (207) 865-9505

OWNER:  
**A.K. LONGFELLOW LLC**  
660 CONGRESS STREET  
PORTLAND, ME 04101

NO.	DATE	ISSUE
4	7/18/2014	PHASE 2 PERMIT ISSUE
3	1/15/2014	FIRE MARSHAL ISSUE
2	5/15/2013	PHASE 1 PERMIT ISSUE
1	3/28/2013	HPCA SET

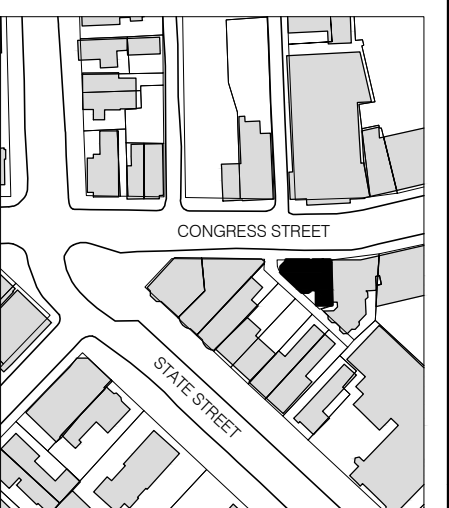

NTS N



B-SCAN:

DWG. CONTENTS:

**ROOF PLAN**

DATE: September 5, 2014  
SCALE: 1/4" = 1'-0"  
DWG. BY:  
PROJECT NO.: 008

DWG. NO.: **A-110**

SHEET NO.:

**GENERAL NOTES**

1. CONTINUOUS CUSTOM EPDM CHANNEL TO BE BUILT AT CURBS OF GANGED SKYLIGHTS, SEE 2/A-505.

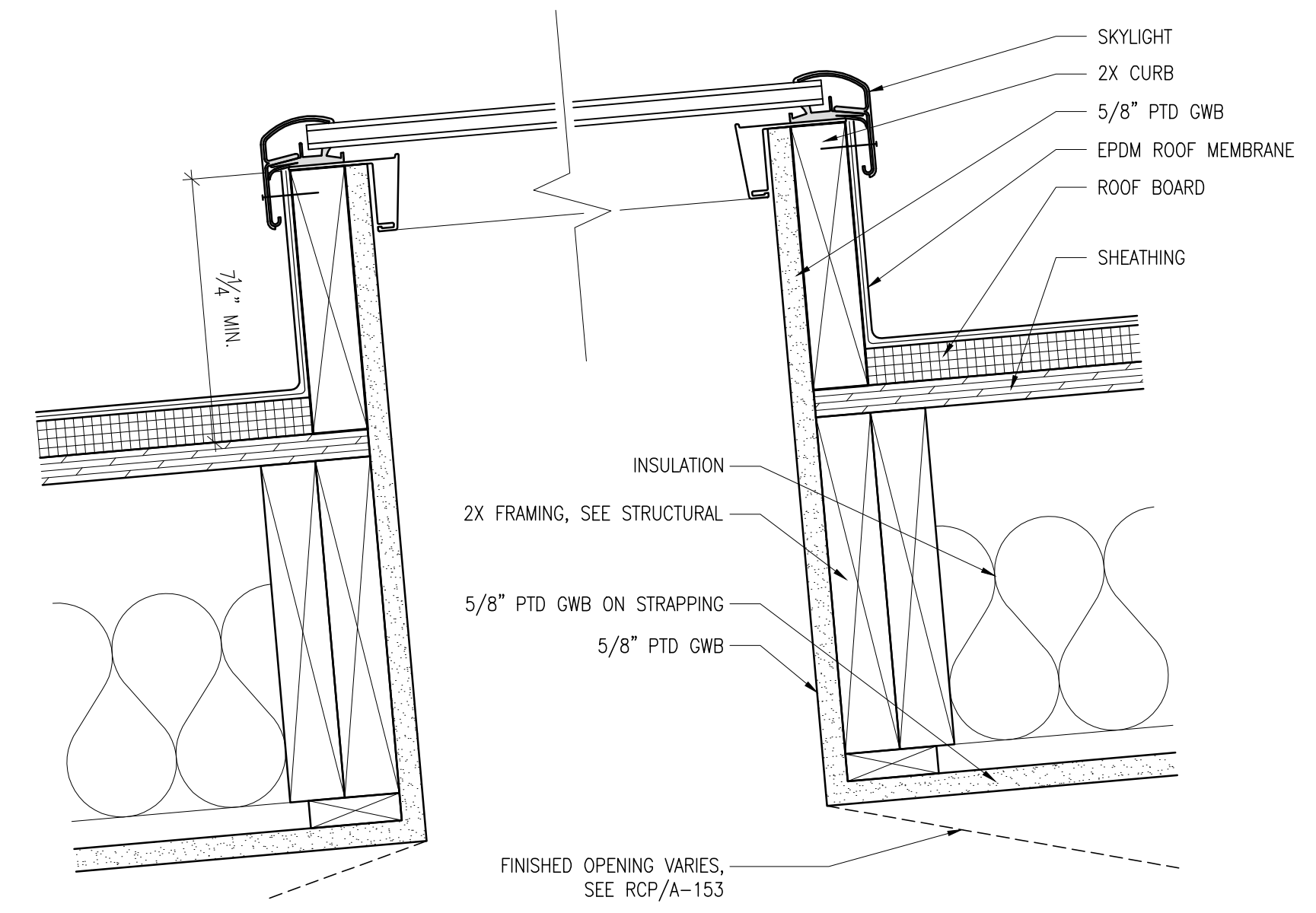

**2** FIXED SKYLIGHT VERTICAL CROSS SECTION  
3" = 1'-0"

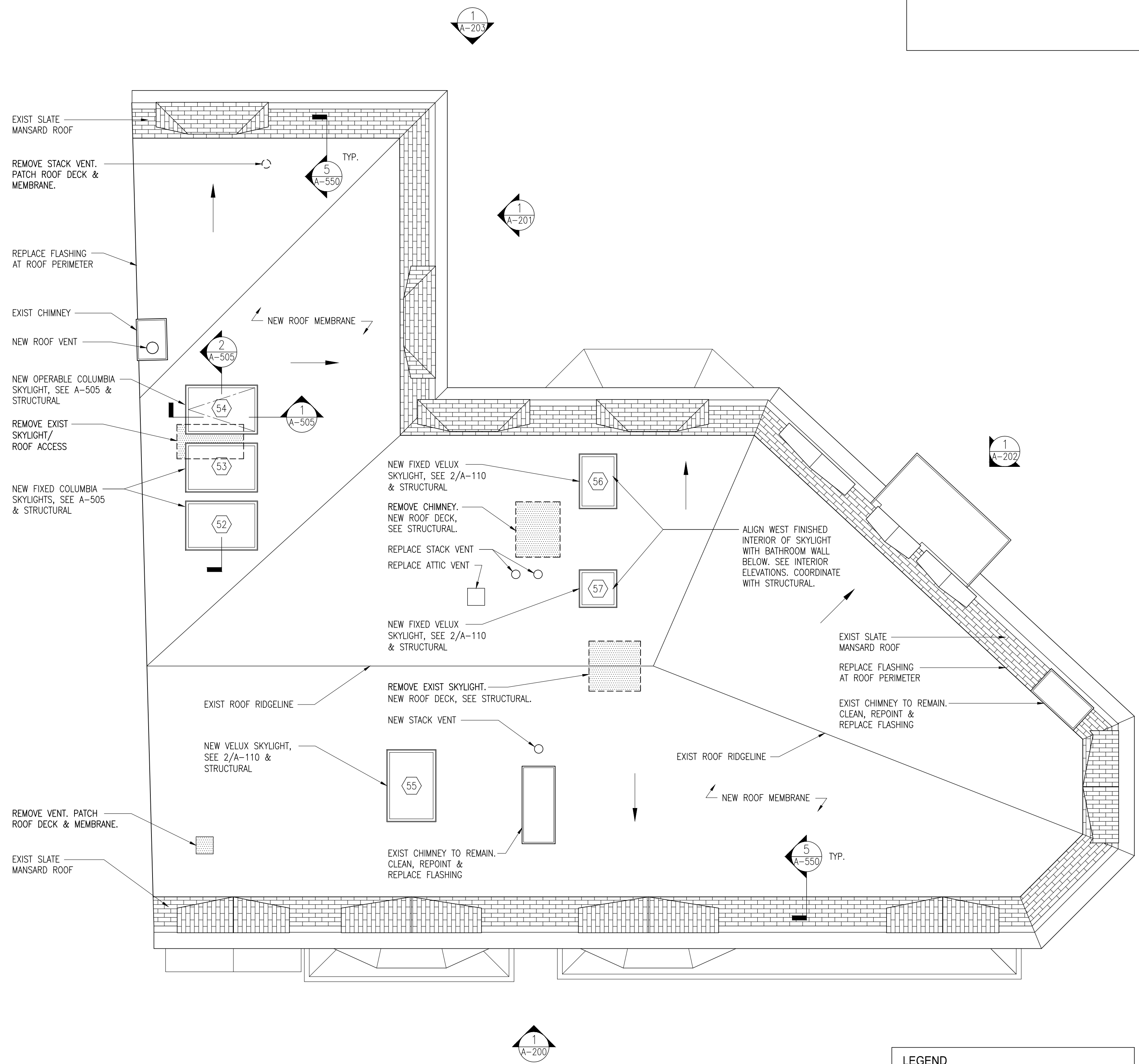

**1** ROOF PLAN  
1/4" = 1'-0"

**LEGEND**

[Symbol] SLATE ROOF