

**660-662
CONGRESS
STREET**

PORTLAND, MAINE

ARCHITECT:
PRESENT ARCHITECTURE PLLC

66 WEST BROADWAY, SUITE 306
NEW YORK, NY, 10007
T: (207) 449-9513

CONTRACTOR:
BAYHILL BUILDING & DESIGN

P.O. BOX 178
SOUTH FREEPORT, ME 04078
T: (207) 865-9351

STRUCTURAL ENGINEER:
**ENGINEERING DESIGN
PROFESSIONALS**

P.O. BOX 575
FREEPORT, ME 04032
T: (207) 865-9505

OWNER:
A.K. LONGFELLOW LLC

660 CONGRESS STREET
PORTLAND, ME 04101

4	8/28/2014	PERMITS PERMIT ISSUE
3	1/15/2014	FIRE MARSHAL ISSUE
2	5/15/2013	PHASE 1 PERMIT ISSUE
1	3/28/2013	HPCA SET
NO.	DATE	ISSUE

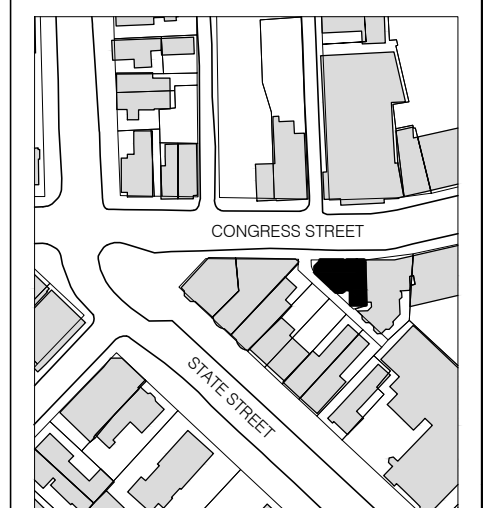

NTS
N



B-SCAN:

DWG. CONTENTS:
BASEMENT PLAN

DATE: September 5, 2014
SCALE: 1/4" = 1'-0"

DWG. NO.: **A-100**

SHEET NO.:

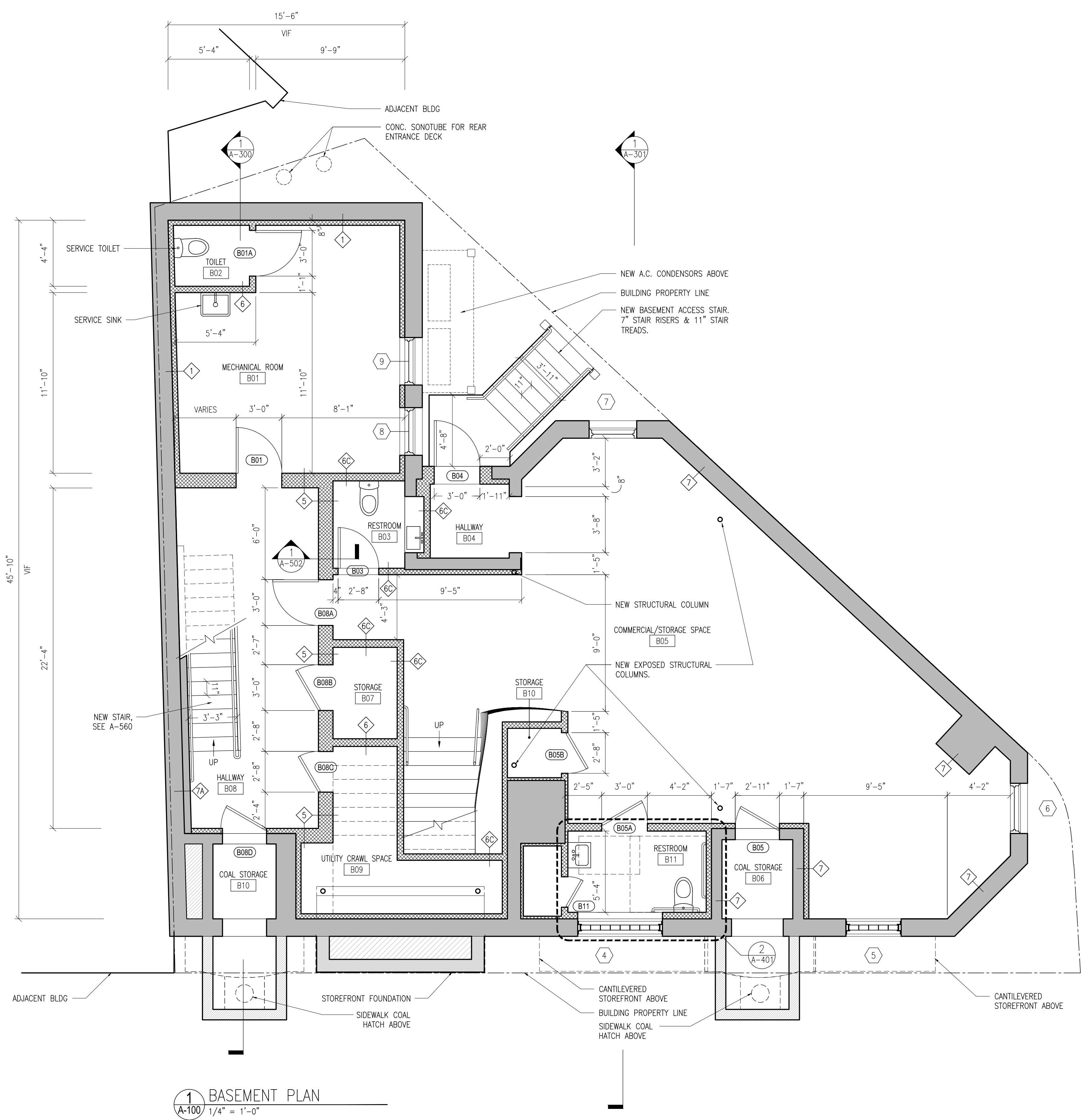

1
A-100
BASEMENT PLAN
1/4" = 1'-0"

LEGEND

	EXISTING CONSTRUCTION TO REMAIN
	NEW CONSTRUCTION