

**City of Portland, Maine - Building or Use Permit Application**  
 389 Congress Street, 04101 Tel: (207) 874-8703, Fax: (207) 874-8716

Permit No: 03-0626	Issue Date:	CBL: 044 G005001
-----------------------	-------------	---------------------

Location of Construction: 71 State St	Owner Name: Seventy-five State St	Owner Address: 75 State St	Phone:
Business Name:	Contractor Name: Portland Airconditioning, Inc.	Contractor Address: 205 Lincoln St. S. Portland	Phone 2077674567
Lessee/Buyer's Name	Phone:	Permit Type: HVAC	Zone: R6

Past Use: Elderly Housing/Multi Family	Proposed Use: Elderly Housing/Multi Family	Permit Fee: \$30.00	Cost of Work: \$30.00	CEO District: 2
---	---	------------------------	--------------------------	--------------------

FIRE DEPT: <input checked="" type="checkbox"/> Approved <input type="checkbox"/> Denied	INSPECTION: Use Group: R2 Type: NA 6/12/03 Signature: <i>[Signature]</i>
---	---

Proposed Project Description:  
 Install Gas Heating System in Roof Area  
*Air Cond.*

Signature: *[Signature]* Signature: *[Signature]*  
 PEDESTRIAN ACTIVITIES DISTRICT (P.A.D.)  
 Action:  Approved  Approved w/Conditions  Denied  
 Signature: \_\_\_\_\_ Date: \_\_\_\_\_

Permit Taken By: gad	Date Applied For: 06/06/2003	<b>Zoning Approval</b>	
-------------------------	---------------------------------	------------------------	--

1. This permit application does not preclude the Applicant(s) from meeting applicable State and Federal Rules. 2. Building permits do not include plumbing, septic or electrical work. 3. Building permits are void if work is not started within six (6) months of the date of issuance. False information may invalidate a building permit and stop all work..	Special Zone or Reviews <input type="checkbox"/> Shoreland <input type="checkbox"/> Wetland <input type="checkbox"/> Flood Zone <input type="checkbox"/> Subdivision <input type="checkbox"/> Site Plan Major <input type="checkbox"/> Minor <input type="checkbox"/> MIM <input type="checkbox"/> Date: <i>6/10/03</i>	Zoning Appeal <input type="checkbox"/> Variance <input type="checkbox"/> Miscellaneous <input type="checkbox"/> Conditional Use <input type="checkbox"/> Interpretation <input type="checkbox"/> Approved <input type="checkbox"/> Denied Date: _____	Historic Preservation <input type="checkbox"/> Not in District or Landmark <input type="checkbox"/> Does Not Require Review <input type="checkbox"/> Requires Review <input type="checkbox"/> Approved <input type="checkbox"/> Approved w/Conditions <input type="checkbox"/> Denied Date: _____
--	--	--	--

**CERTIFICATION**

I hereby certify that I am the owner of record of the named property, or that the proposed work is authorized by the owner of record and that I have been authorized by the owner to make this application as his authorized agent and I agree to conform to all applicable laws of this jurisdiction. In addition, if a permit for work described in the application is issued, I certify that the code official's authorized representative shall have the authority to enter all areas covered by such permit at any reasonable hour to enforce the provision of the code(s) applicable to such permit.

\_\_\_\_\_  
 SIGNATURE OF APPLICANT ADDRESS DATE PHONE

\_\_\_\_\_  
 RESPONSIBLE PERSON IN CHARGE OF WORK, TITLE DATE PHONE

RECEIVED  
JUN 11 2003

**BECKER**  
structural engineers, inc.

BY: .....

June 10, 2003

John Gerken  
Wright-Ryan Construction  
10 Danforth Street  
Portland, ME 04104

Re: 75 State Street Roof Top Mechanical Unit

Dear John,

This letter is to confirm our earlier conversation regarding the location of a new roof-top mechanical unit at the 75 State Street Renovation Project in Portland.

The existing roof structure consists of a two-way cast-in-place reinforced concrete slab system, with cast-in-place reinforced concrete columns. Please reference the Field Sketch prepared by Wright-Ryan, received by Becker Structural Engineers on June 9, 2003. Per our conversation, the new unit weighs approximately 900 pounds. The location of the new mechanical unit over roof column 3/F as indicated in the June 9, 2003 Field Sketch is structurally acceptable.

Please contact me if you have any questions or comments regarding this letter, or if you need assistance with any other matter.

Sincerely,  
**Becker Structural Engineers, Inc.**

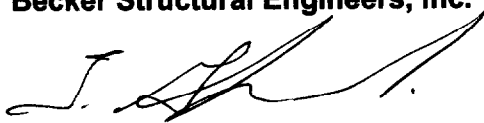

Thaddeus Gabryszewski, P.E.  
Structural Engineer

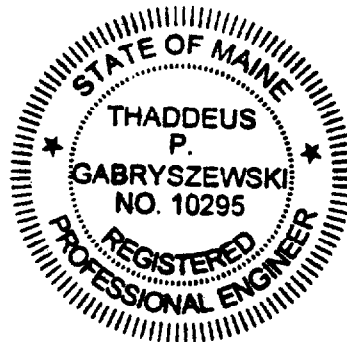

Enclosures – June 9, 2003 Field Sketch prepared by Wright-Ryan

CC: Rande Whitehouse – Gawron Turgeon Architects  
Peter Haber – Wright-Ryan Construction



# Andersen



881 FOREST AVENUE  
PORTLAND, MAINE 04103-4107  
TEL: 207-772-2223 FAX: 207-773-3261  
EMAIL: sales@lorangerdoor.com

DATE:

JOB:

WRIGHT-RYAN CO.  
JOB - 75 STATE ST.  
SUPERVISOR - JOHN M. GERRARD  
DRAWER - BILLY STIB

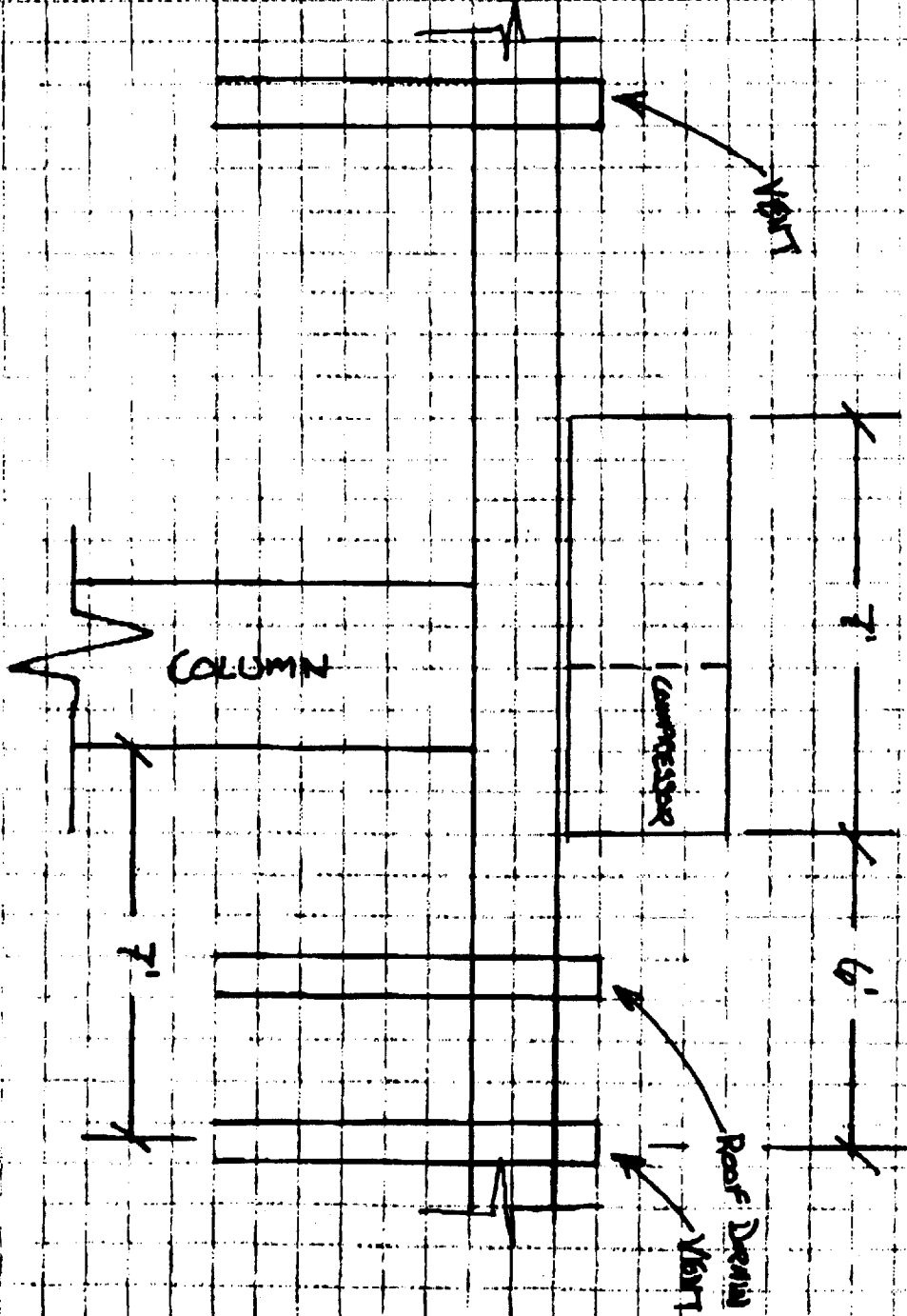

BECKER STRUCTURAL ENGINEERS, INC.  
JUN 9 2003



FILL IN AND SIGN WITH INK 03-0622p

# APPLICATION FOR PERMIT HEATING OR POWER EQUIPMENT



To the INSPECTOR OF BUILDINGS, PORTLAND, ME.

044-G-005

The undersigned hereby applies for a permit to install the following heating, cooking or power equipment in accordance with the Laws of Maine, the Building Code of the City of Portland, and the following specifications:

Location / CBL 75 State Street Use of Building elderly housing Date 06/03/03  
Name and address of owner of appliance \_\_\_\_\_

Installer's name and address Portland Air conditioning Inc 205 Lincoln St  
So Portland, ME 04106 Telephone 207 767 4567

**Location of appliance:**

Basement       Floor  
 Attic             Roof

**Type of Fuel:**

Gas       Oil       Solid

**Appliance Name:** Chiller

U.L. Approved  Yes  No

Will appliance be installed in accordance with the manufacture's installation instructions?  Yes  No

IF NO Explain: \_\_\_\_\_

**Type of Chimney:**

Masonry Lined  
Factory built \_\_\_\_\_

Metal  
Factory Built U.L. Listing # \_\_\_\_\_

Direct Vent  
Type \_\_\_\_\_ UL# \_\_\_\_\_

**Type of Fuel Tank**

Oil  
 Gas

Size of Tank \_\_\_\_\_

Number of Tanks \_\_\_\_\_

Distance from Tank to Center of Flame \_\_\_\_\_ feet.

Cost of Work: \$ 21,740

Permit Fee: \$ 177.00

**The Type of License of Installer:**

Master Plumber # \_\_\_\_\_  
 Solid Fuel # \_\_\_\_\_  
 Oil # \_\_\_\_\_  
 Gas # PNT434  
 Other \_\_\_\_\_

**Approved**

**Approved with Conditions**

Fire: \_\_\_\_\_  
Ele.: \_\_\_\_\_  
Bldg: \_\_\_\_\_

See attached letter or requirement

Signature of Installer \_\_\_\_\_

DEPT. OF BUILDING INSPECTION  
CITY OF PORTLAND  
Inspector's Signature \_\_\_\_\_ Date Approved \_\_\_\_\_

White - Inspection    Yellow - File    Pink - Applicant's    Gold - Assessor's Copy

