

- NOTES:
1. ALL CWS AND CWR DISTRIBUTION PIPING ON ROOF TO BE SCHEDULE 80 PVC
 2. ALL CWS AND CWR DISTRIBUTION PIPING ON ROOF TO BE INSULATED WITH 1" FIBERGLASS AND WRAPPED WITH 0.16" EMBOSSED ALUMINUM JACKET.

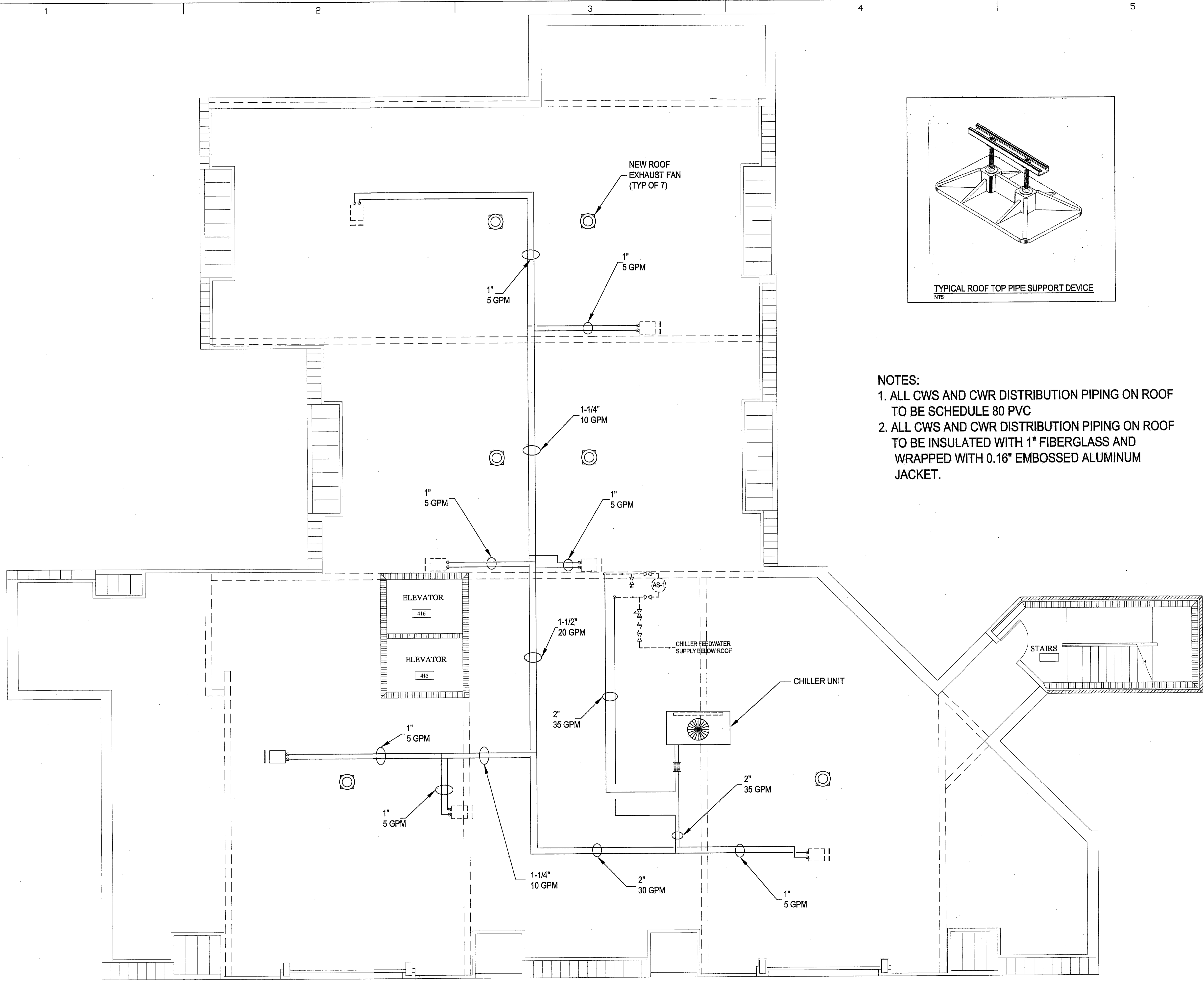

ROOF PLAN
 SCALE: 1/4" = 1'-0"

75 STATE STREET
 PORTLAND, ME
 HARBORSIDE SOUTH

ROOF PLAN

PROJECT NUMBER:	42096
ISSUED:	9-10-07
DRAWN BY:	MGR
CHECKED BY:	DWM / CB
FILENAME:	.DWG

M-4