

**GAWRON  
TURGEON  
ARCHITECTS**

29 Black Point Road  
Scarborough, ME 04074  
www.gawronturgeon.com  
Tel. 207 . 883 . 6307  
Fax. 207 . 883 . 0361

CUTLER HOUSE RENOVATION  
PORTLAND, MAINE

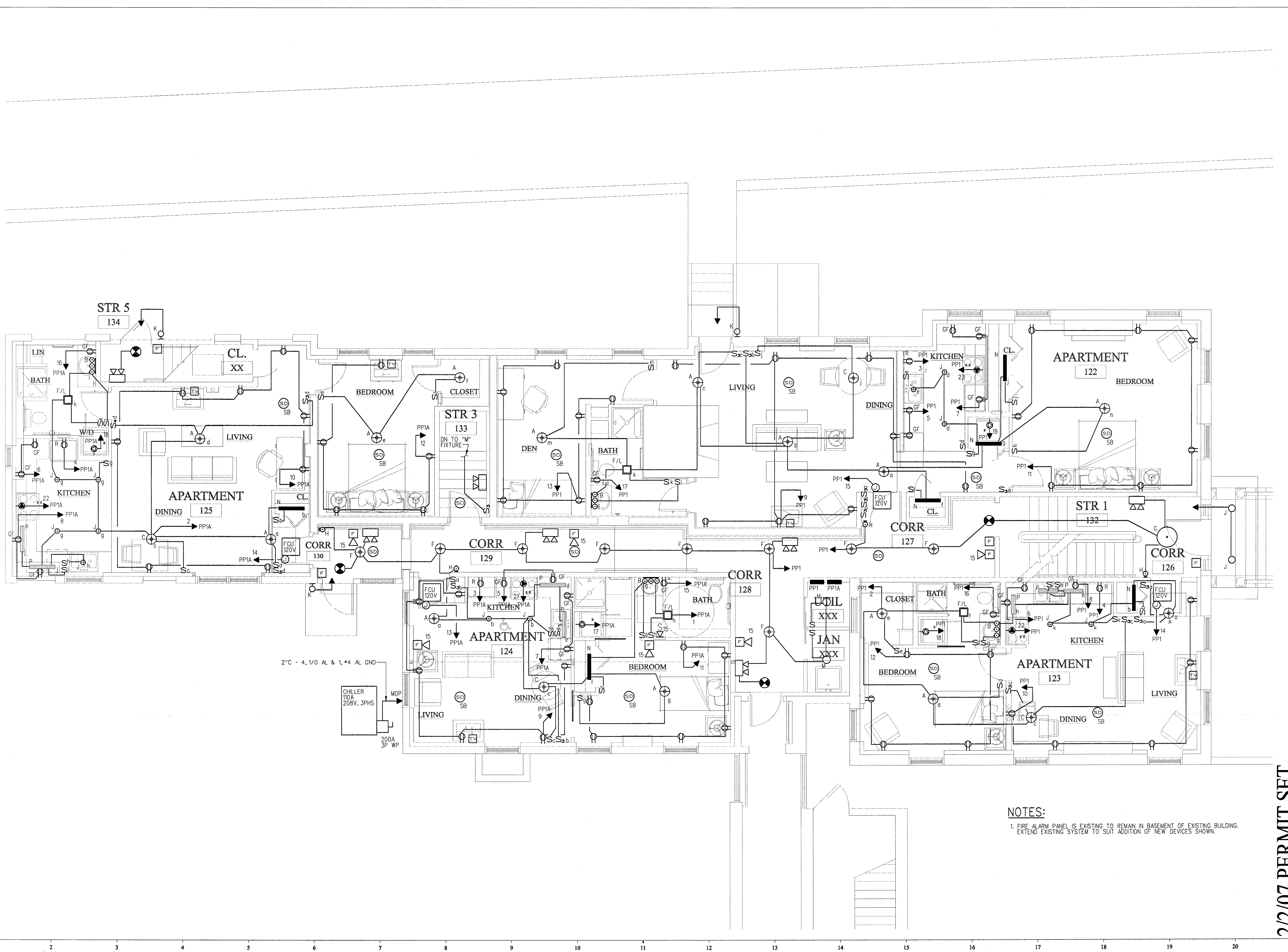

2" C - 4, 1/0 AL & 1, \*4 AL GND  
CHILLER  
110A  
208V, 3PHS  
200A  
3P WP  
MDP

**NOTES:**  
1. FIRE ALARM PANEL IS EXISTING TO REMAIN IN BASEMENT OF EXISTING BUILDING.  
EXTEND EXISTING SYSTEM TO SUIT ADDITION OF NEW DEVICES SHOWN.

REVISIONS		
#	DATE	DESCRIPTION

DATE:	2/2/07
PROJECT #:	060905
DRAWN BY:	SPD
CHECKED BY:	WSBJR
DRAWING SCALE:	1/4"=1'-0"

SHEET TITLE  
FIRST FLOOR  
ELECTRICAL  
PLAN

**E-101**

© COPYRIGHT 1985-2003  
REPRODUCTION OR USE OF  
THIS DOCUMENT WITHOUT  
WRITTEN PERMISSION OF  
GAWRON ARCHITECTS IS PROHIBITED

2/2/07 PERMIT SET