

THIS IS NOT A BOUNDARY SURVEY

INSPECTION OF PREMISE

I HEREBY CERTIFY TO

NORTHEAST LAND TITLE, FIRST NEW HAMPSHIRE MORTGAGE, AND ITS TITLE INSURER

The monumentation is in harmony with current deed description.

The building setbacks are in conformity with town zoning requirements.

The land and the dwelling do not appear to fall within the special flood hazard zone as delineated by the Federal Emergency Management Agency.

97 DANFORTH ST. PORTLAND, ME.

Job Number: 118-41

Inspection Date: 10-02-89

Scale: 1" = 30'

OWNER: JUDY KELLY

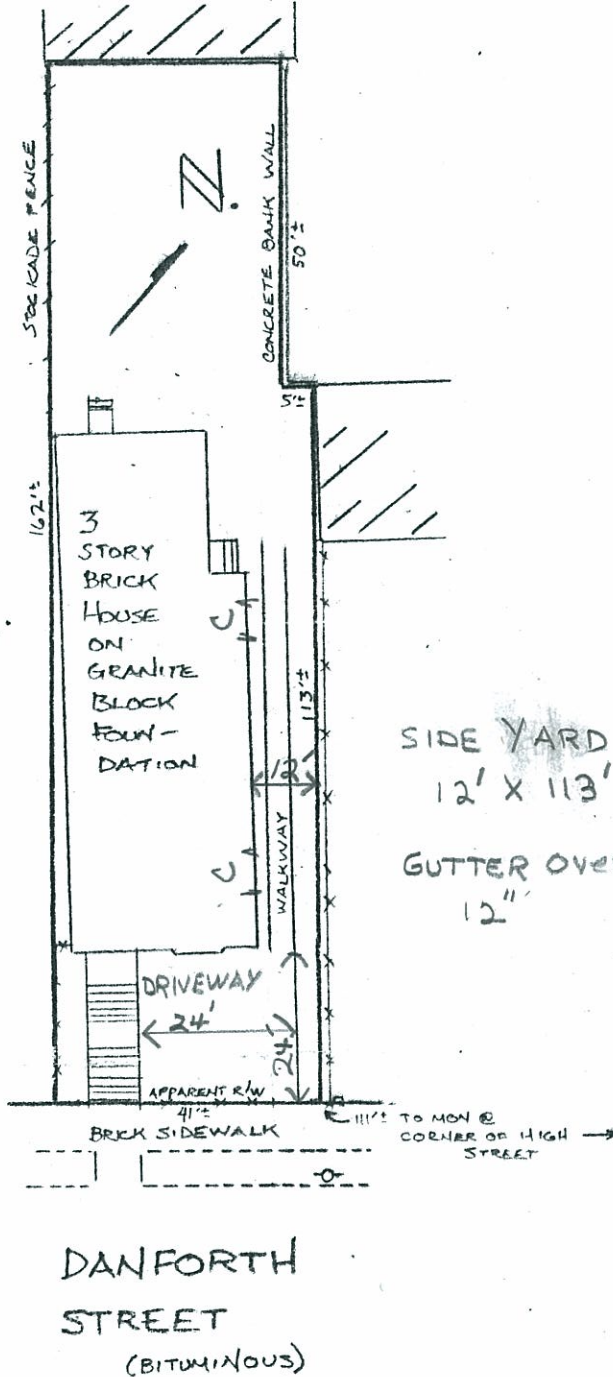
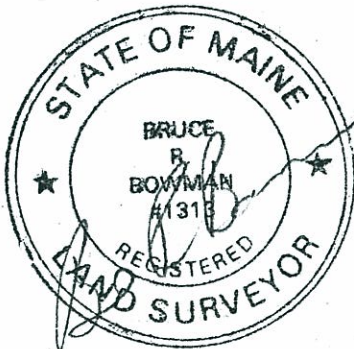

SIDE YARD 12' X 113'

GUTTER OVERHANG 12"

DANFORTH STREET (BITUMINOUS)

Plot Plan

THIS PROPERTY IS SUBJECT TO ALL RIGHTS AND EASEMENTS OF RECORD. THOSE THAT ARE EVIDENT ARE SHOWN. THIS PLAN MIGHT NOT REVEAL CONFLICTS WITHIN ABUTTING DEEDS.

BRUCE R. BOWMAN, R.L.S. 20 Forest Avenue Cumberland, Maine Phone: (207)829-3959

PLAN BOOK PAGE LOT DEED BOOK 7845 PAGE 84 COUNTY CUMBERLAND

THIS PLAN IS NOT FOR RECORDING Drawn by: J.C.