

Owner:

**Children's  
Hospital Housing  
Partners, LP**

309 Cumberland Ave.  
Suite 203  
Portland, Maine 04101

CONSTRUCTION MANAGER:

**WRIGHT-RYAN  
CONSTRUCTION**

10 DANFORTH STREET  
PORTLAND, ME 04101  
TEL: (207) 773-3625

**ELM  
TERRACE**

68 HIGH STREET  
PORTLAND, MAINE

Project No: 09428

Drawing Title:  
**REMOVALS  
REFLECTED  
CEILING PLAN -  
THIRD FLOOR**

Scale: 1/8" = 1'-0"

Date: ISSUED SEPTEMBER 8, 2011

- Revisions:
- △ MAINE HOUSING CONCEPT SUBMISSION 02-01-2011
  - △ HISTORIC PRESERVATION SUBMISSION 03-23-2011
  - △ 50% MAINEHOUSING REVIEW 04-01-2011
  - △ 90% MAINEHOUSING REVIEW 06-03-2011
  - △ NPS SUBMISSION 07-01-2011
  - △ ISSUED SEPTEMBER 8, 2011

Drawing Number:

**D2.03**

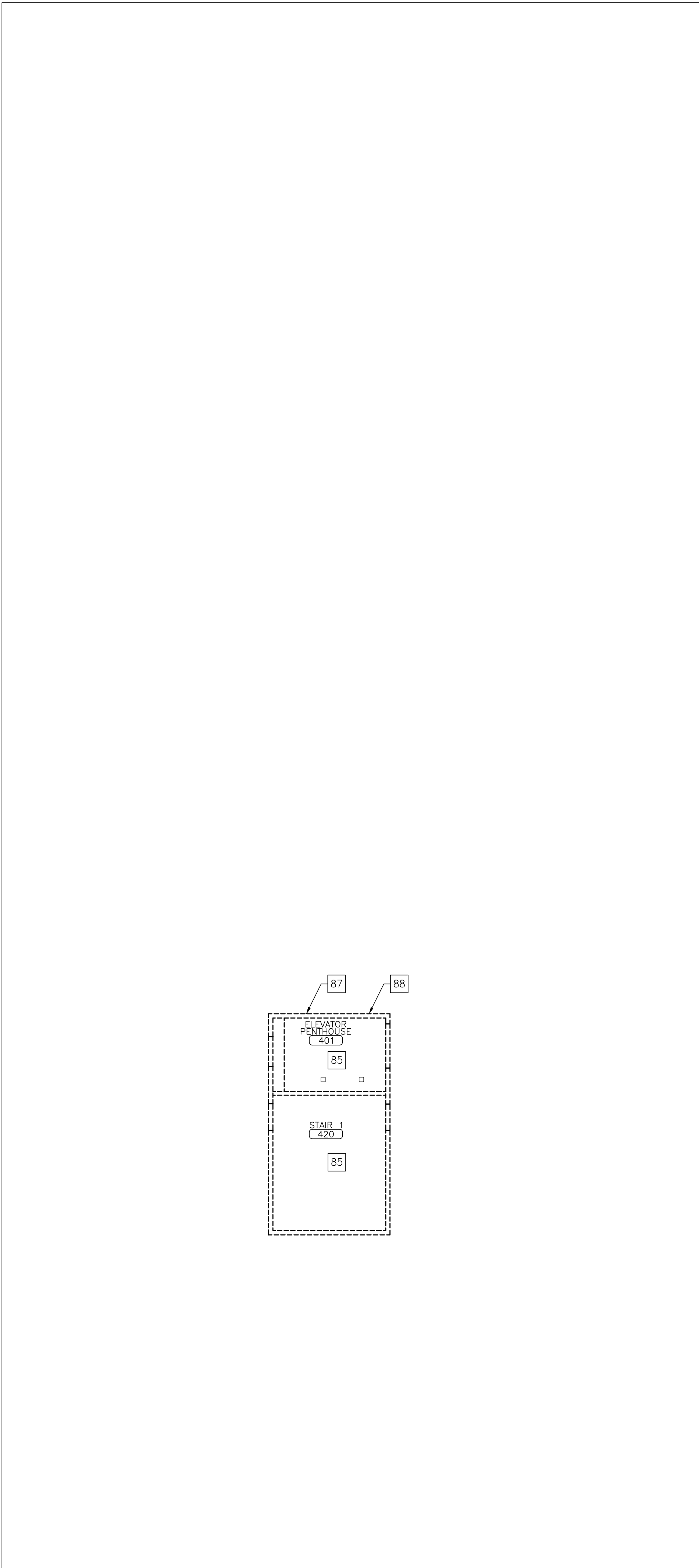

**2** PARTIAL REMOVALS REFLECTED CEILING PLAN - ROOF  
SCALE: 1/8" = 1'-0"

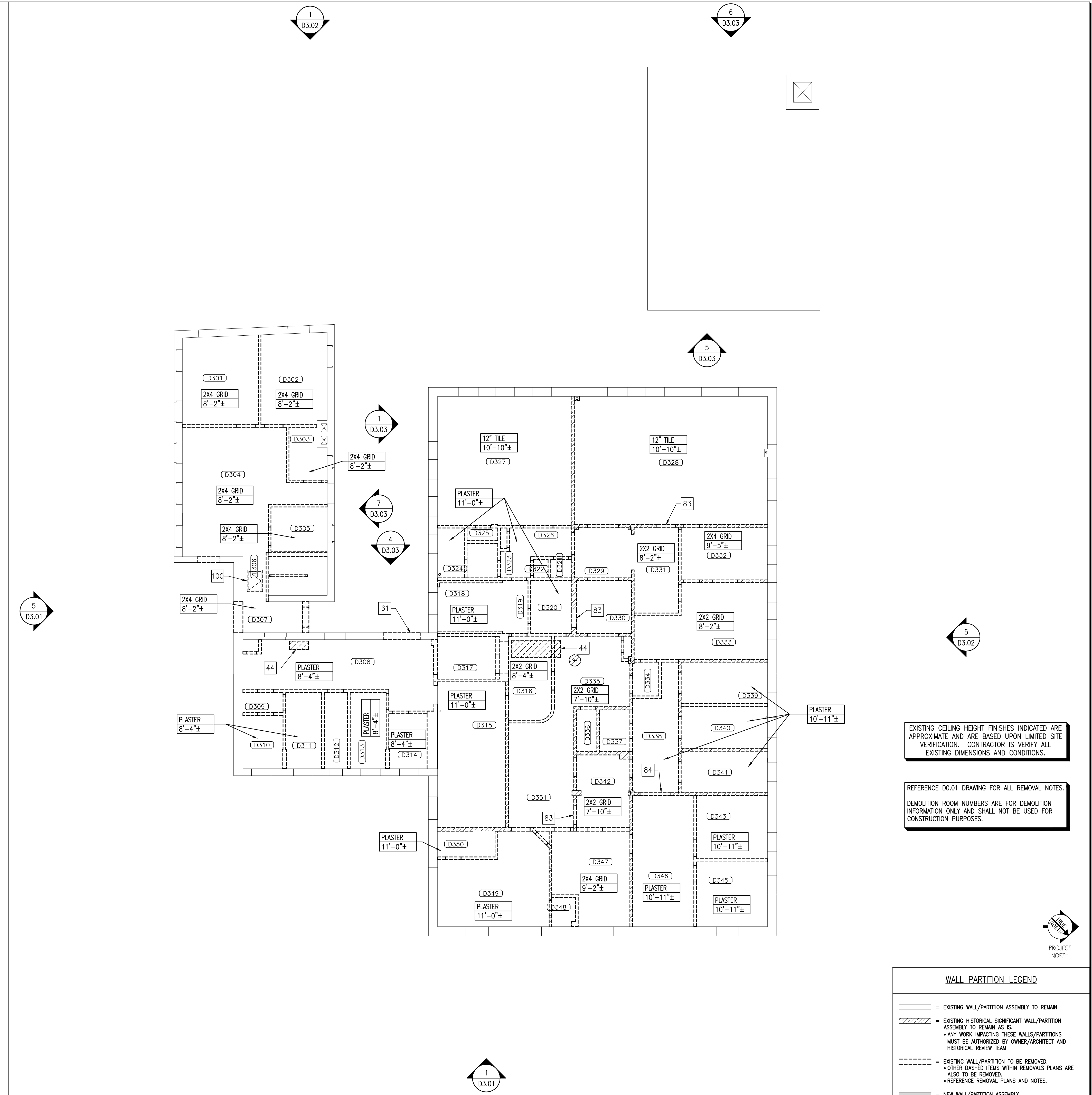

**1** REMOVALS REFLECTED CEILING PLAN - THIRD FLOOR  
SCALE: 1/8" = 1'-0"

EXISTING CEILING HEIGHT FINISHES INDICATED ARE APPROXIMATE AND ARE BASED UPON LIMITED SITE VERIFICATION. CONTRACTOR IS VERIFY ALL EXISTING DIMENSIONS AND CONDITIONS.

REFERENCE D0.01 DRAWING FOR ALL REMOVAL NOTES.  
DEMOLITION ROOM NUMBERS ARE FOR DEMOLITION INFORMATION ONLY AND SHALL NOT BE USED FOR CONSTRUCTION PURPOSES.

**WALL PARTITION LEGEND**

	= EXISTING WALL/PARTITION ASSEMBLY TO REMAIN
	= EXISTING HISTORICAL SIGNIFICANT WALL/PARTITION ASSEMBLY TO REMAIN AS IS. • ANY WORK IMPACTING THESE WALLS/PARTITIONS MUST BE AUTHORIZED BY OWNER/ARCHITECT AND HISTORICAL REVIEW TEAM
	= EXISTING WALL/PARTITION TO BE REMOVED. • OTHER DASHED ITEMS WITHIN REMOVALS PLANS ARE ALSO TO BE REMOVED. • REFERENCE REMOVAL PLANS AND NOTES.
	= NEW WALL/PARTITION ASSEMBLY. • REFERENCE PARTITION SCHEDULE
	= INDICATES FIRE RATED WALL/PARTITION ASSEMBLY. • REFERENCE PARTITION SCHEDULE

