

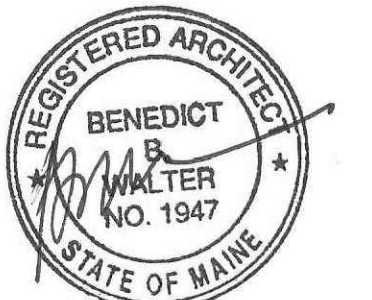

**CWS Architects**  
 Architecture  
 Space Planning  
 Value Design

434 Cumberland Avenue  
 Portland, ME 04101  
 Phone: (207)774-4441  
 Fax: (207)774-4016  
 www.CWSarch.com



Owner:  
**Children's Hospital Housing Partners, LP**  
 309 Cumberland Ave.  
 Suite 203  
 Portland, Maine 04101

CONSTRUCTION MANAGER:  
**WRIGHT-RYAN CONSTRUCTION**  
 10 DANFORTH STREET  
 PORTLAND, ME 04101  
 TEL: (207) 773-3625

**ELM TERRACE**

68 HIGH STREET  
 PORTLAND, MAINE

Project No: 09428

Drawing Title:  
**REMOVALS PLAN - THIRD FLOOR**

Scale: 1/8" = 1'-0"  
 Date: ISSUED SEPTEMBER 8, 2011

- Revisions:
- △ MAINE HOUSING CONCEPT SUBMISSION 02-01-2011
  - △ HISTORIC PRESERVATION SUBMISSION 03-23-2011
  - △ 50% MAINEHOUSING REVIEW 04-01-2011
  - △ 90% MAINEHOUSING REVIEW 06-03-2011
  - △ NPS SUBMISSION 07-01-2011
  - △ ISSUED SEPTEMBER 8, 2011

Drawing Number:  
**D1.03**

9/8/2011 10:06 AM

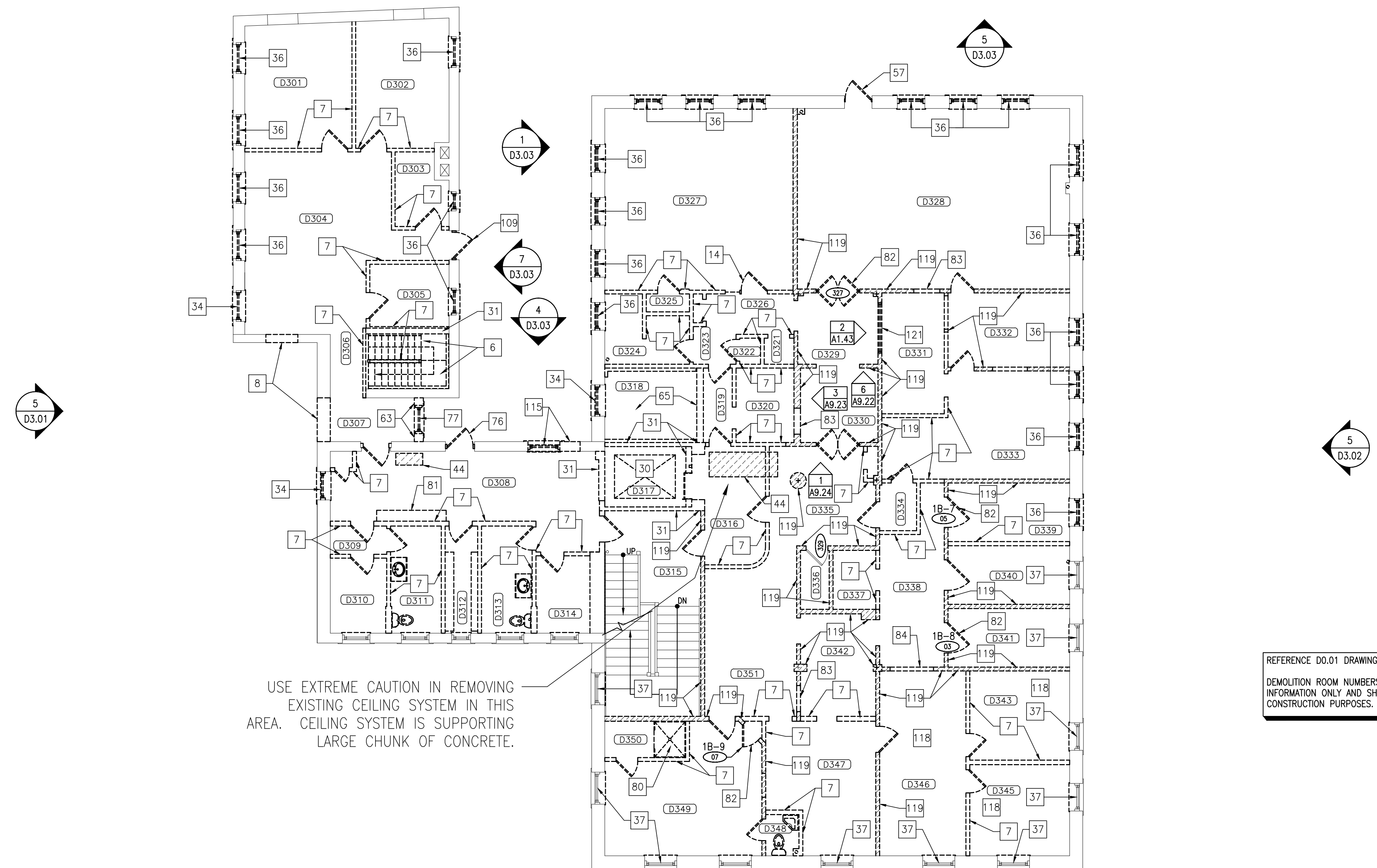
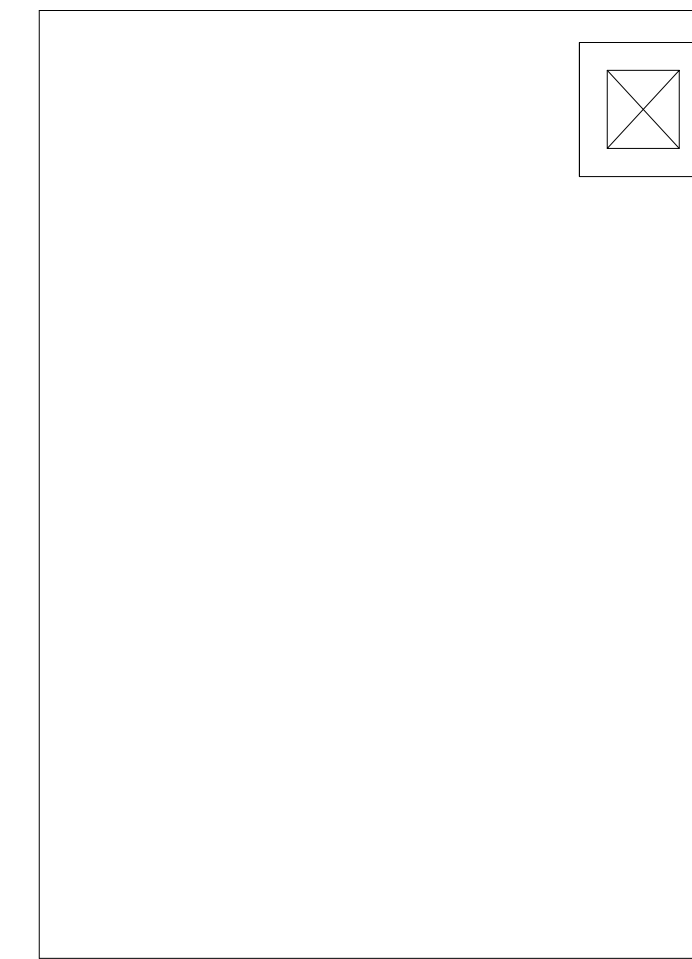

REFERENCE D0.01 DRAWING FOR ALL REMOVAL NOTES.  
 DEMOLITION ROOM NUMBERS ARE FOR DEMOLITION INFORMATION ONLY AND SHALL NOT BE USED FOR CONSTRUCTION PURPOSES.



**WALL PARTITION LEGEND**

- = EXISTING WALL/PARTITION ASSEMBLY TO REMAIN
- = EXISTING HISTORICAL SIGNIFICANT WALL/PARTITION ASSEMBLY TO REMAIN AS IS.  
 • ANY WORK IMPACTING THESE WALLS/PARTITIONS MUST BE AUTHORIZED BY OWNER/ARCHITECT AND HISTORICAL REVIEW TEAM
- - - - = EXISTING WALL/PARTITION TO BE REMOVED.  
 • OTHER DASHED ITEMS WITHIN REMOVALS PLANS ARE ALSO TO BE REMOVED.  
 • REFERENCE REMOVAL PLANS AND NOTES.
- = NEW WALL/PARTITION ASSEMBLY.  
 • REFERENCE PARTITION SCHEDULE
- = INDICATES FIRE RATED WALL/PARTITION ASSEMBLY.  
 • REFERENCE PARTITION SCHEDULE

SCALE: 1/8" = 1'-0"

**1 REMOVALS PLAN - THIRD FLOOR**

1  
D3.02

6  
D3.03

5  
D3.03

1  
D3.03

7  
D3.03

4  
D3.03

5  
D3.01

5  
D3.02

1  
D3.01