

TR-1 RESILIENT TO CARPET SCALE: 1'-0"=1'-0"

TR-2 RESILIENT TO RESILIENT SCALE: 1'-0"=1'-0"

TR-3 SEALED CONCRETE TO CARPET SCALE: 1'-0"=1'-0"

TR-4 ENTRY MAT TO TILE SCALE: 1'-0"=1'-0"

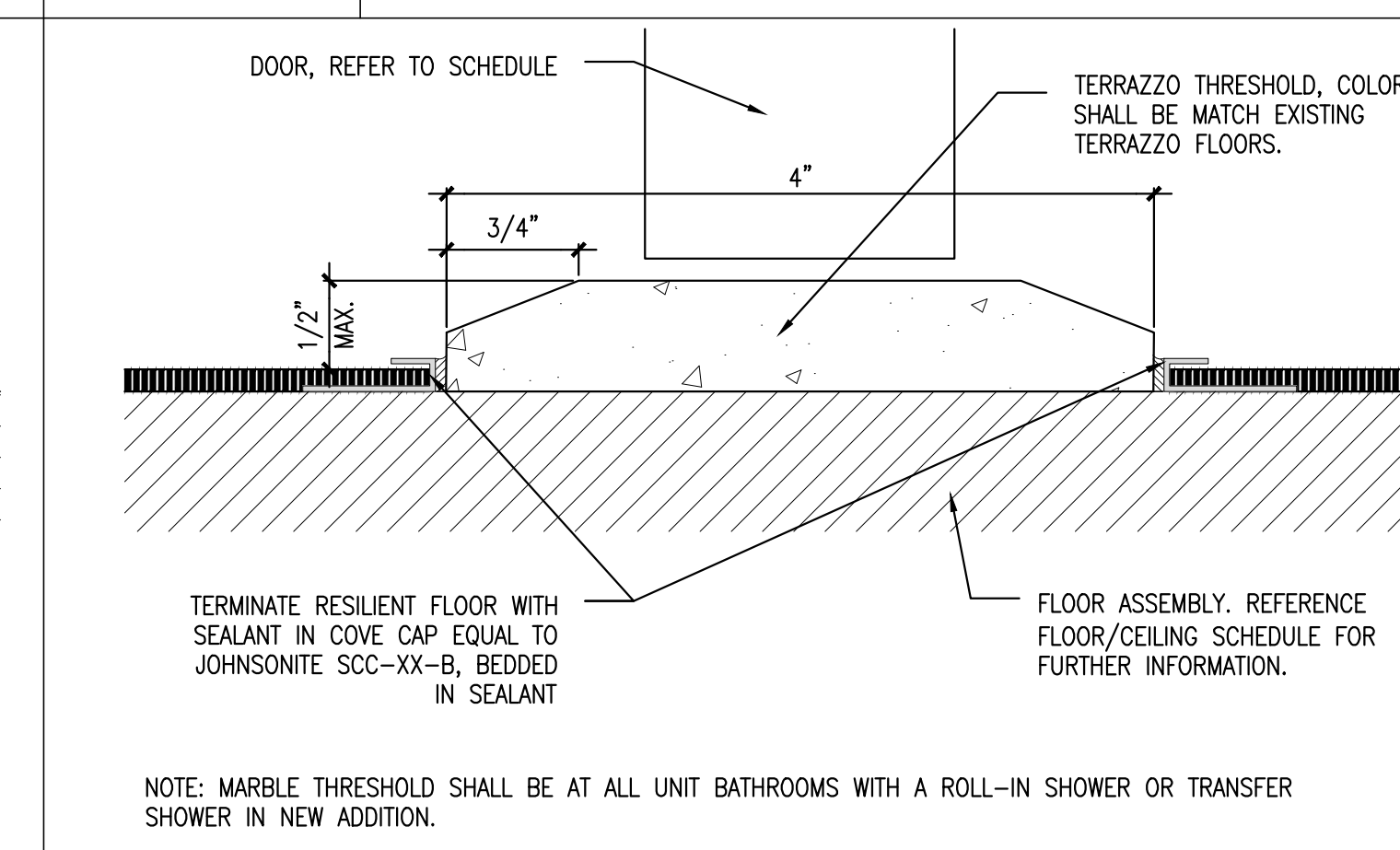
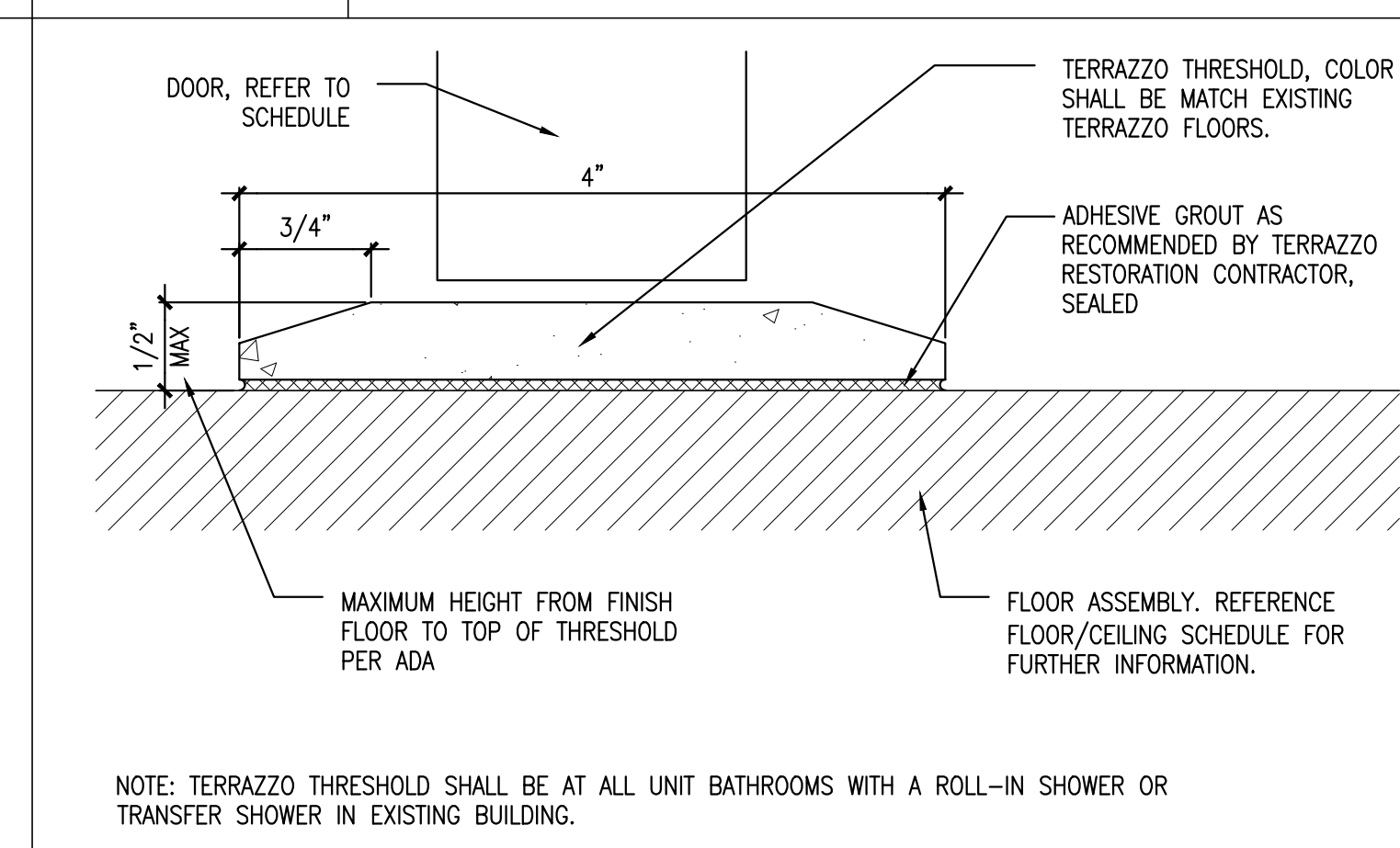
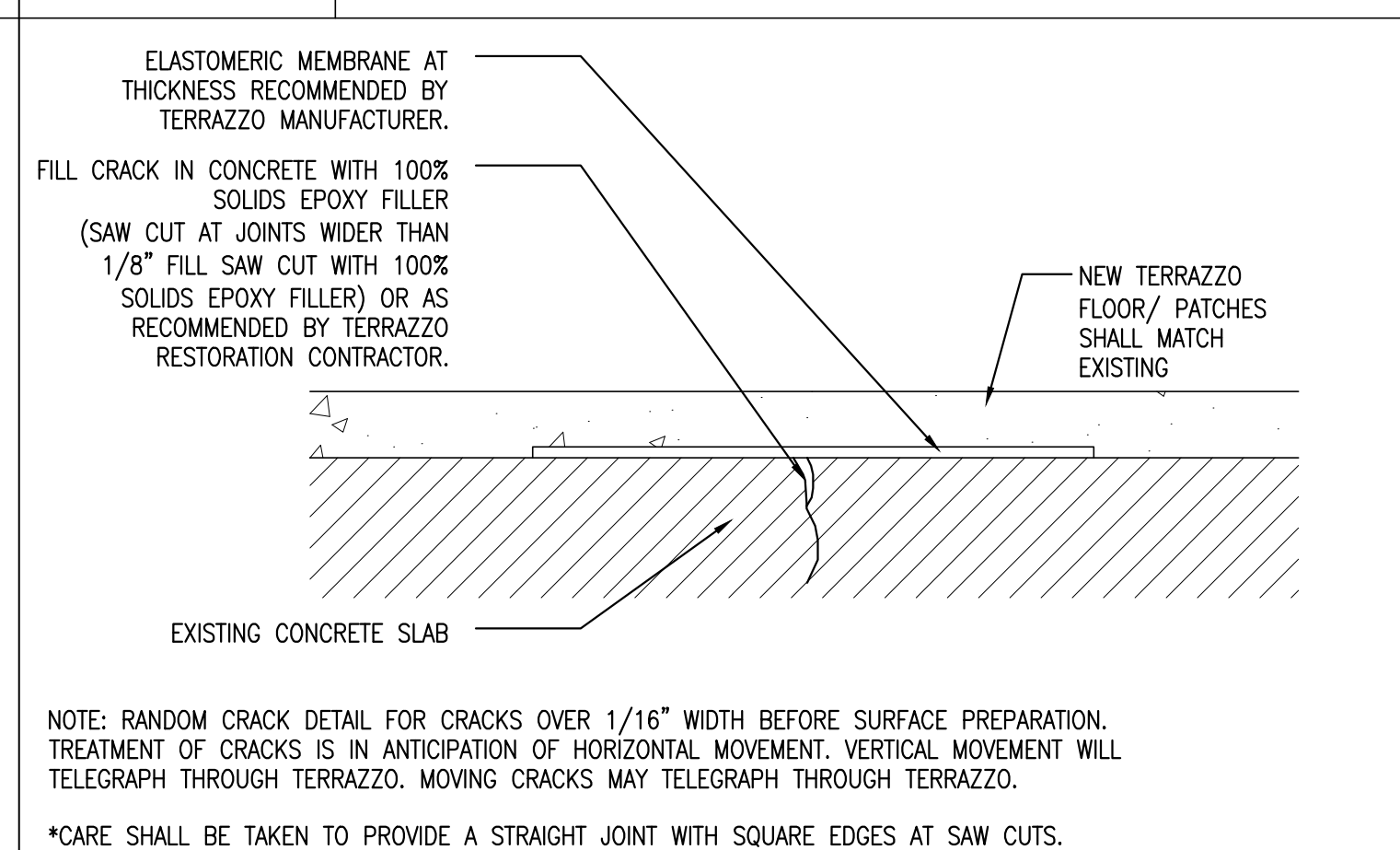
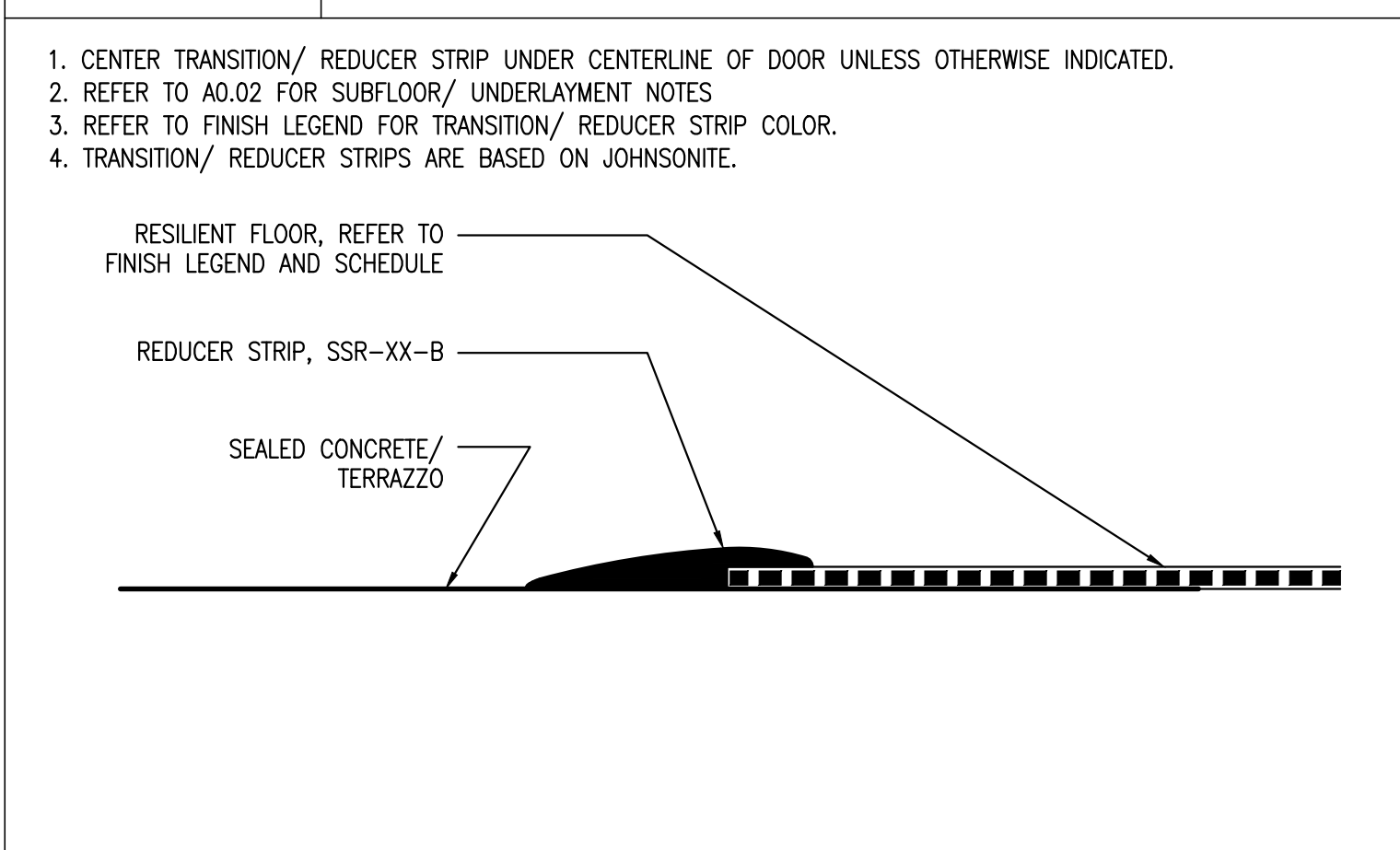

TR-5 SEALED CONCRETE TO RESILIENT SCALE: 1'-0"=1'-0"

TR-6 TERRAZZO CRACK REPAIR SCALE: 1'-0"=1'-0"

TR-7 TERRAZZO THRESHOLD SCALE: 1'-0"=1'-0"

TR-8 TERRAZZO THRESHOLD SCALE: 1'-0"=1'-0"

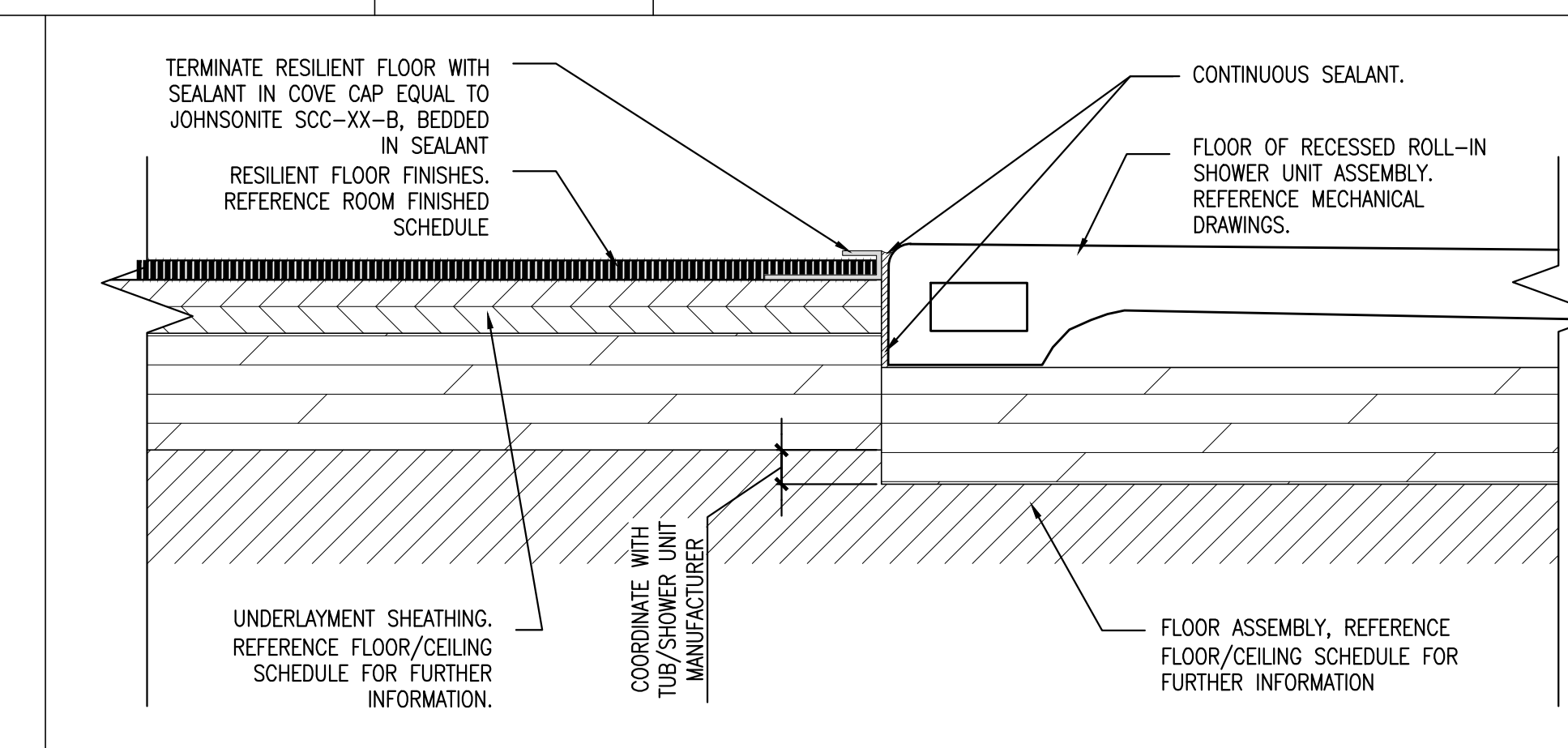
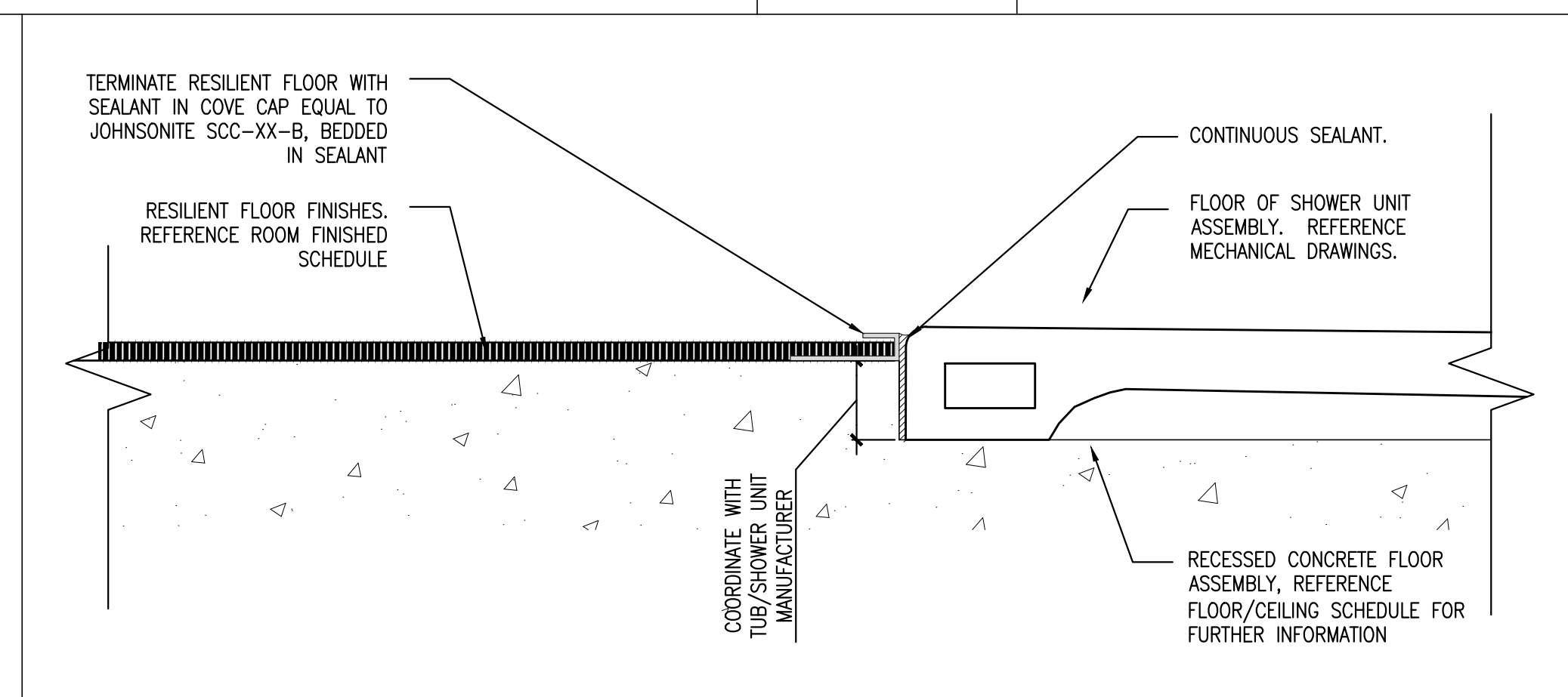
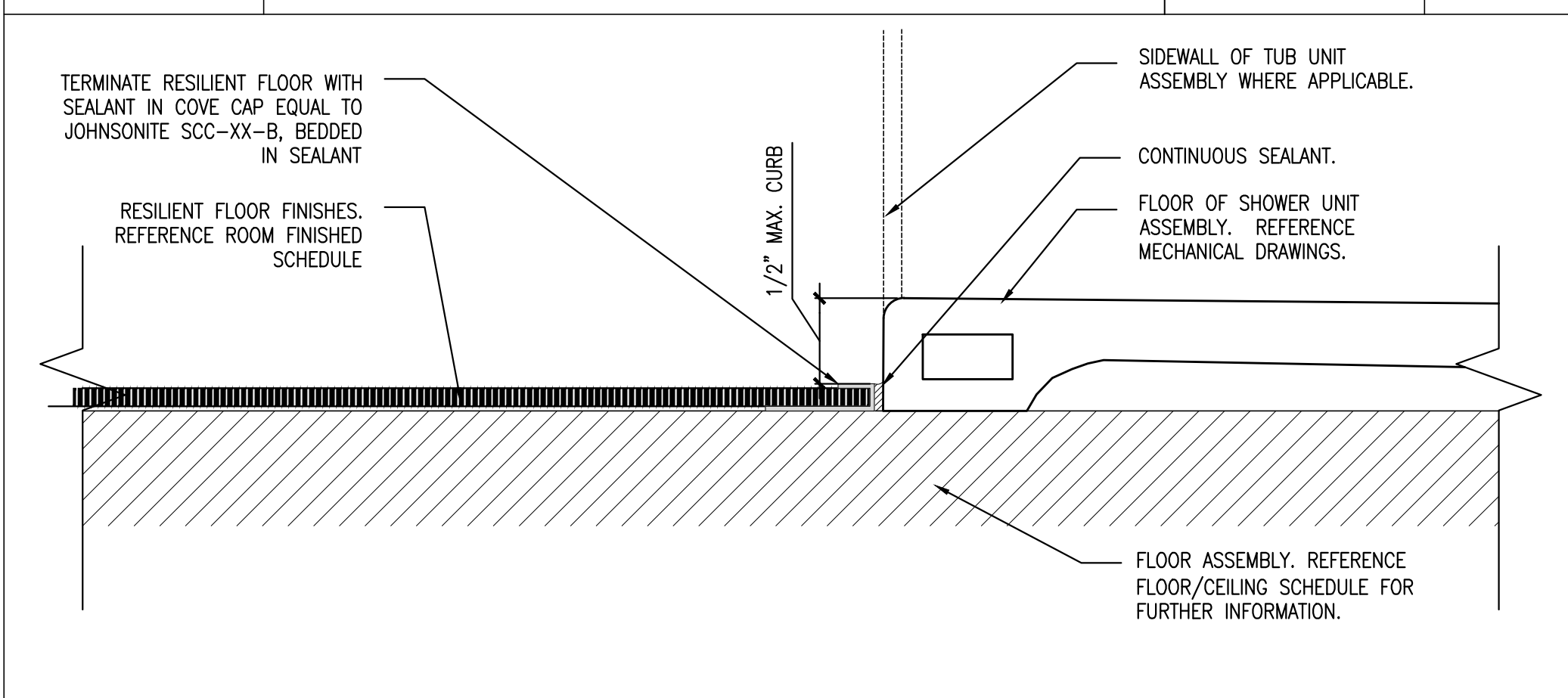

TR-9 RESILIENT TERMINATION @ TRANSFER SHOWER AND TUB UNIT SCALE: 1'-0"=1'-0"

TR-10 RECESSED ROLL-IN SHOWER TRANSITION SCALE: 1'-0"=1'-0"

TR-11 RECESSED ROLL-IN SHOWER TRANSITION SCALE: 1'-0"=1'-0"

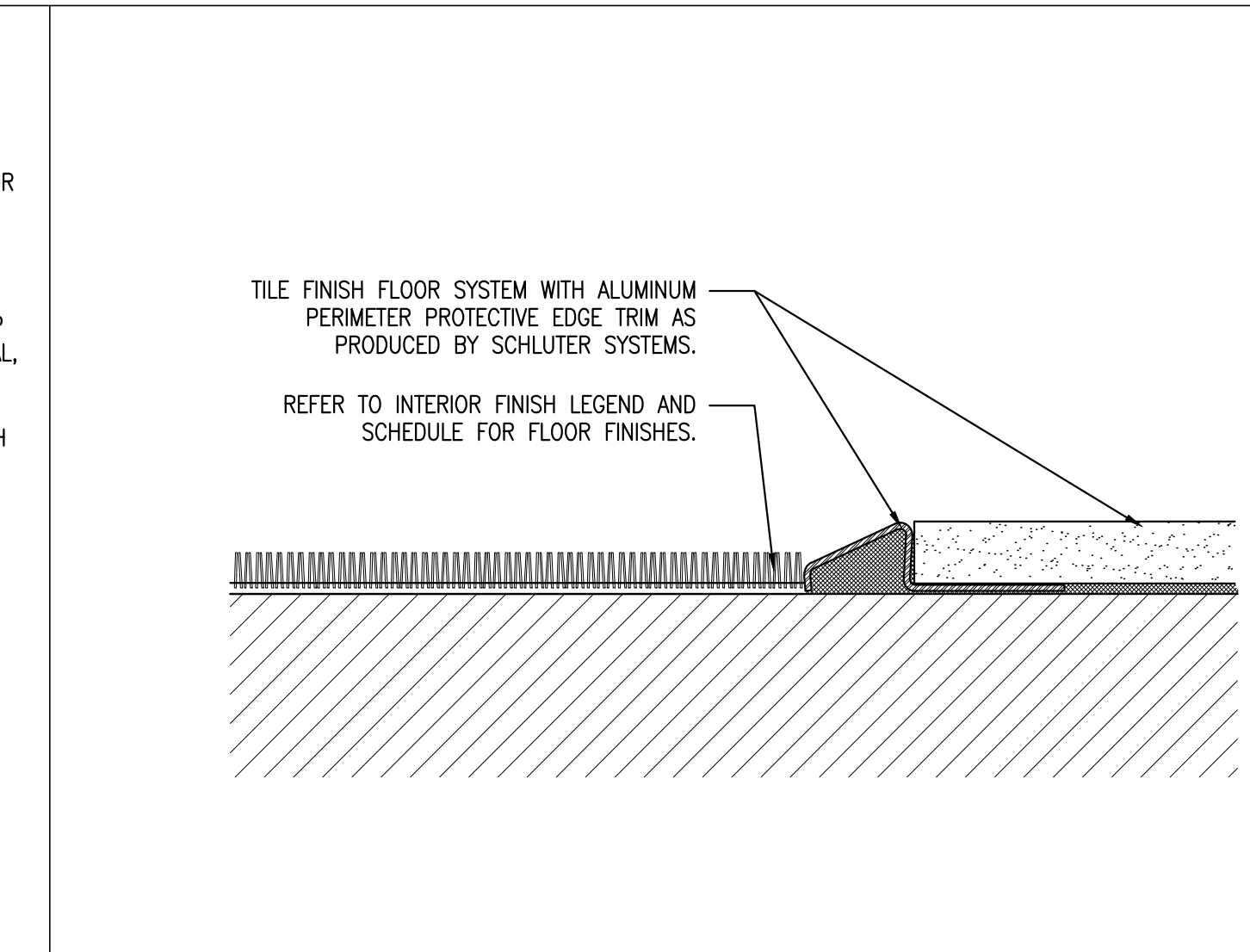
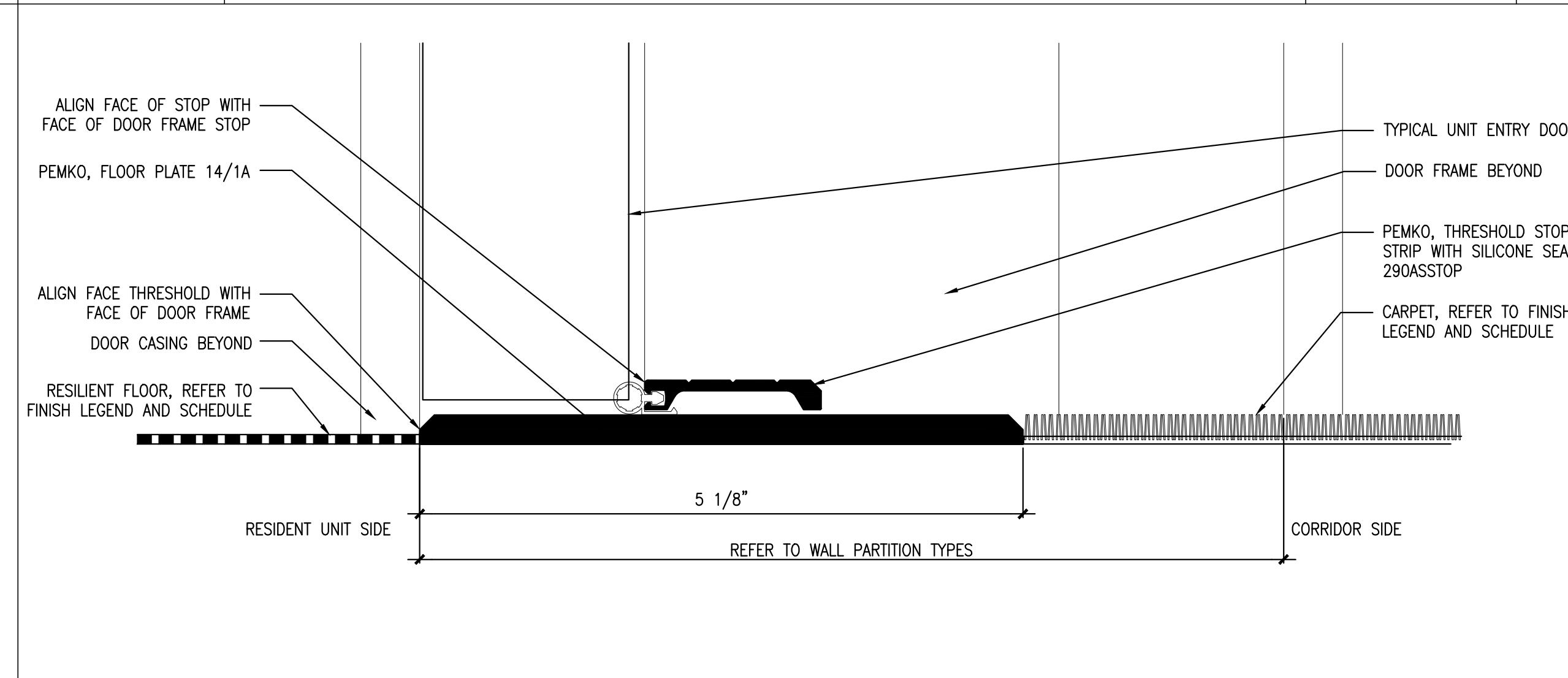
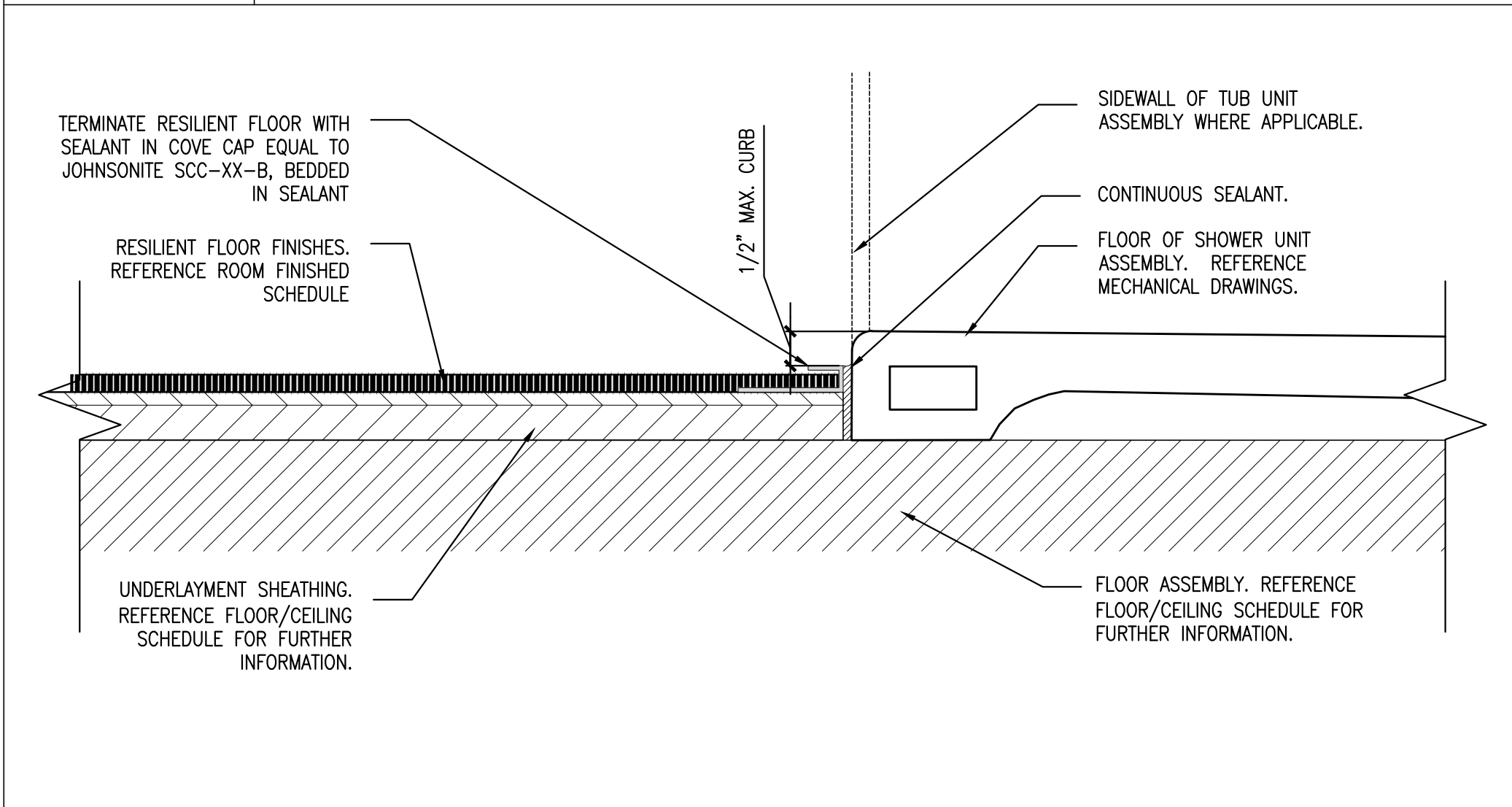

TR-12 RESILIENT TERMINATION @ TRANSFER SHOWER AND TUB UNIT SCALE: 1'-0"=1'-0"

TR-13 UNIT ENTRY DOOR THRESHOLD W/ PERIMETER SEAL SCALE: 1'-0"=1'-0"

TR-14 TILE TO CARPET SCALE: 1'-0"=1'-0"

CWS
CWS Architects
Architecture
Space Planning
Value Design
434 Cumberland Avenue
Portland, ME 04101
Phone: (207)774-4441
Fax: (207)774-4016
www.CWSarch.com

REGISTERED ARCHITECT
BENEDICT
WALTER
NO. 1947
STATE OF MAINE

Owner:
Children's Hospital Housing Partners, LP
309 Cumberland Ave.
Suite 203
Portland, Maine 04101

CONSTRUCTION MANAGER:
WRIGHT-RYAN CONSTRUCTION
10 DANFORTH STREET
PORTLAND, ME 04101
TEL: (207) 773-3625

ELM TERRACE
68 HIGH STREET
PORTLAND, MAINE

Project No: 09428
Drawing Title:
TRANSITION DETAILS
Scale: AS NOTED
Date: ISSUED SEPTEMBER 8, 2011

Revisions:
 ▲ MAINE HOUSING CONCEPT SUBMISSION 02-01-2011
 ▲ HISTORIC PRESERVATION SUBMISSION 03-23-2011
 ▲ 50% MAINEHOUSING REVIEW 04-01-2011
 ▲ 90% MAINEHOUSING REVIEW 06-03-2011
 ▲ NPS SUBMISSION 07-01-2011
 ▲ ISSUED SEPTEMBER 8, 2011

Drawing Number:
A9.32