

1 DETAIL @ PARAPET

REFERENCED FROM:

SCALE: 1/2" = 1'-0"

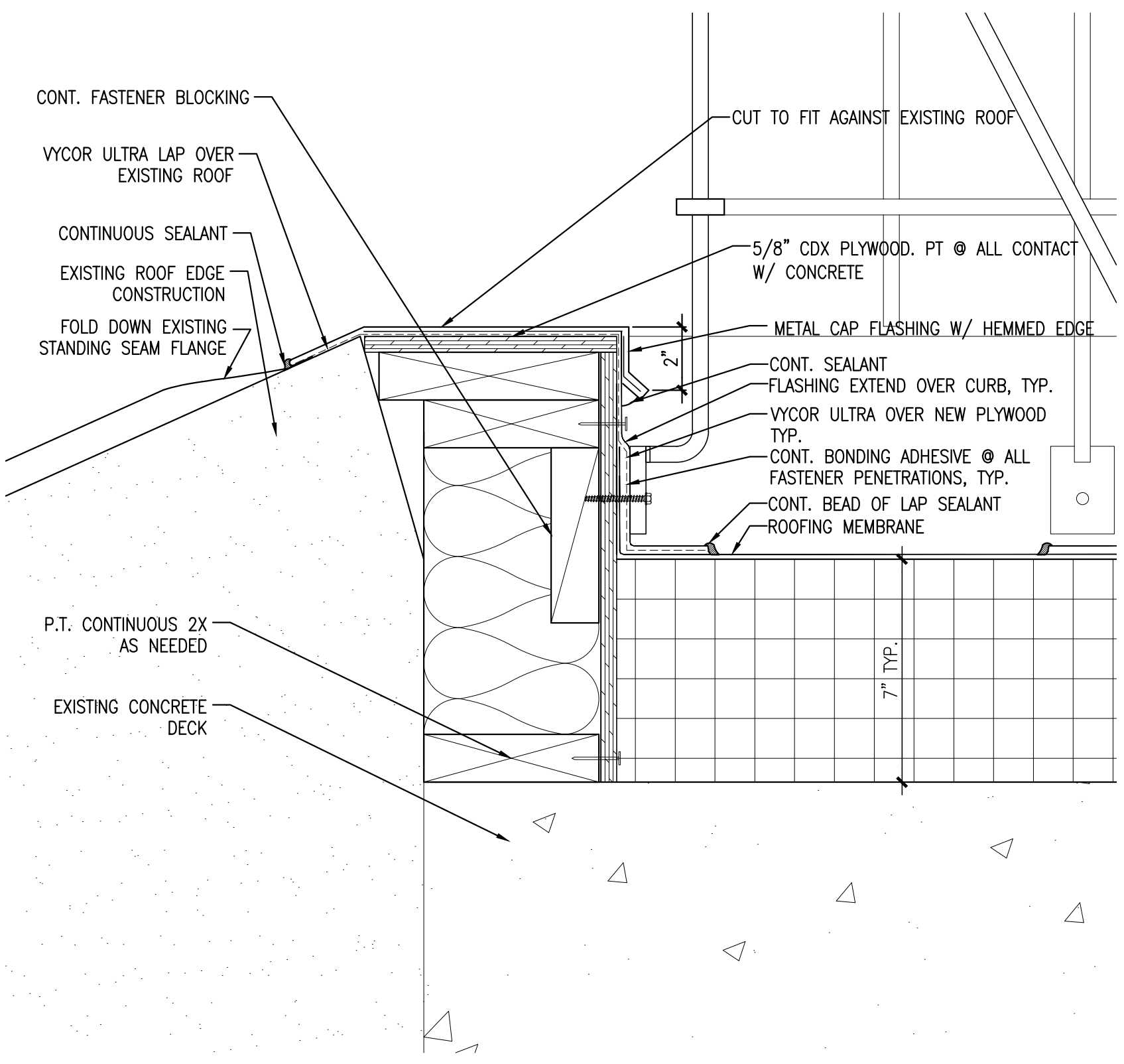

2 DETAIL @ CONNECTION TO PARAPET

REFERENCED FROM:

SCALE: 1'-0" = 1'-0"

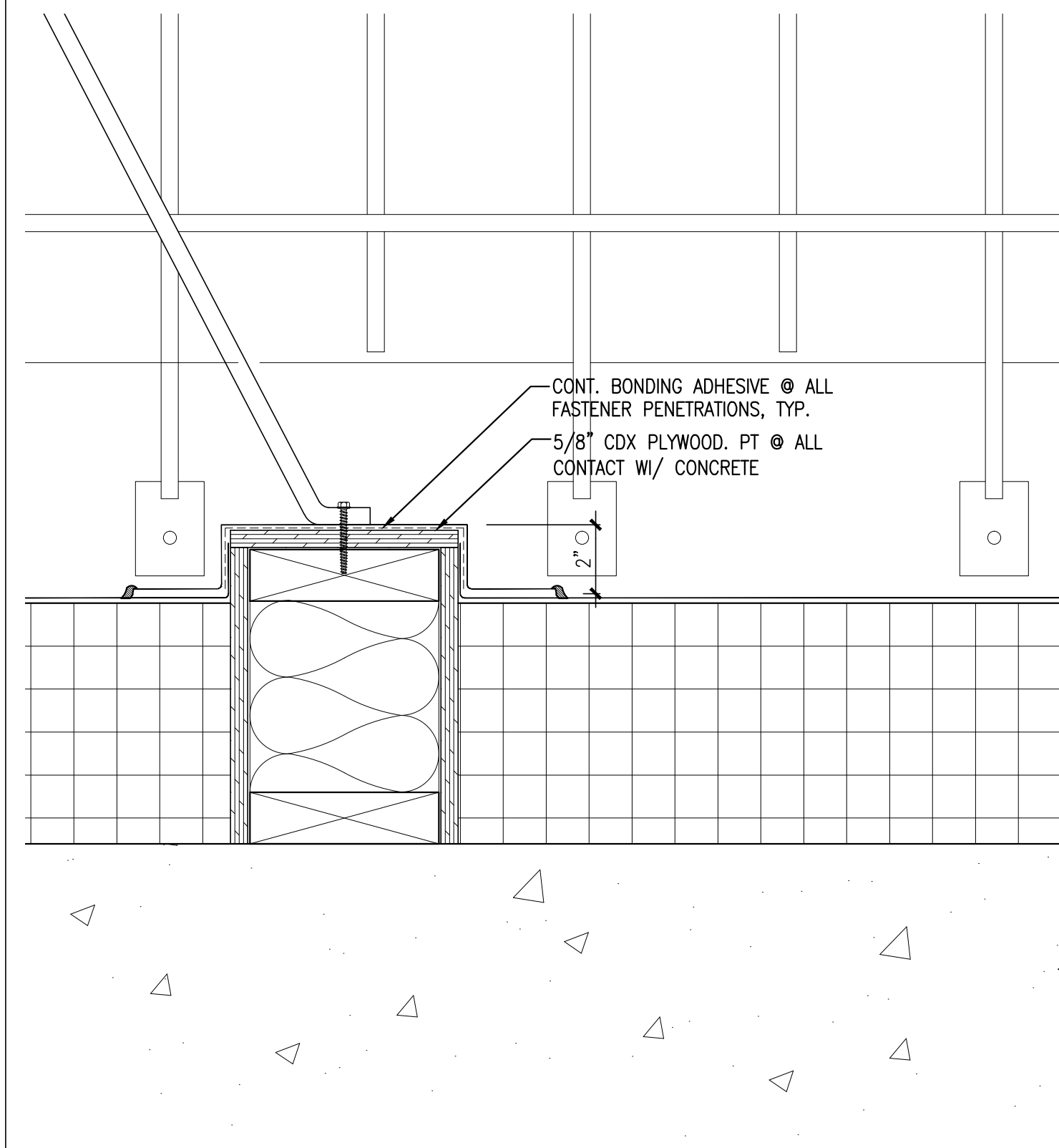

3 DETAIL @ SUPPORT FOOTING

REFERENCED FROM:

SCALE: 3/8" = 1'-0"

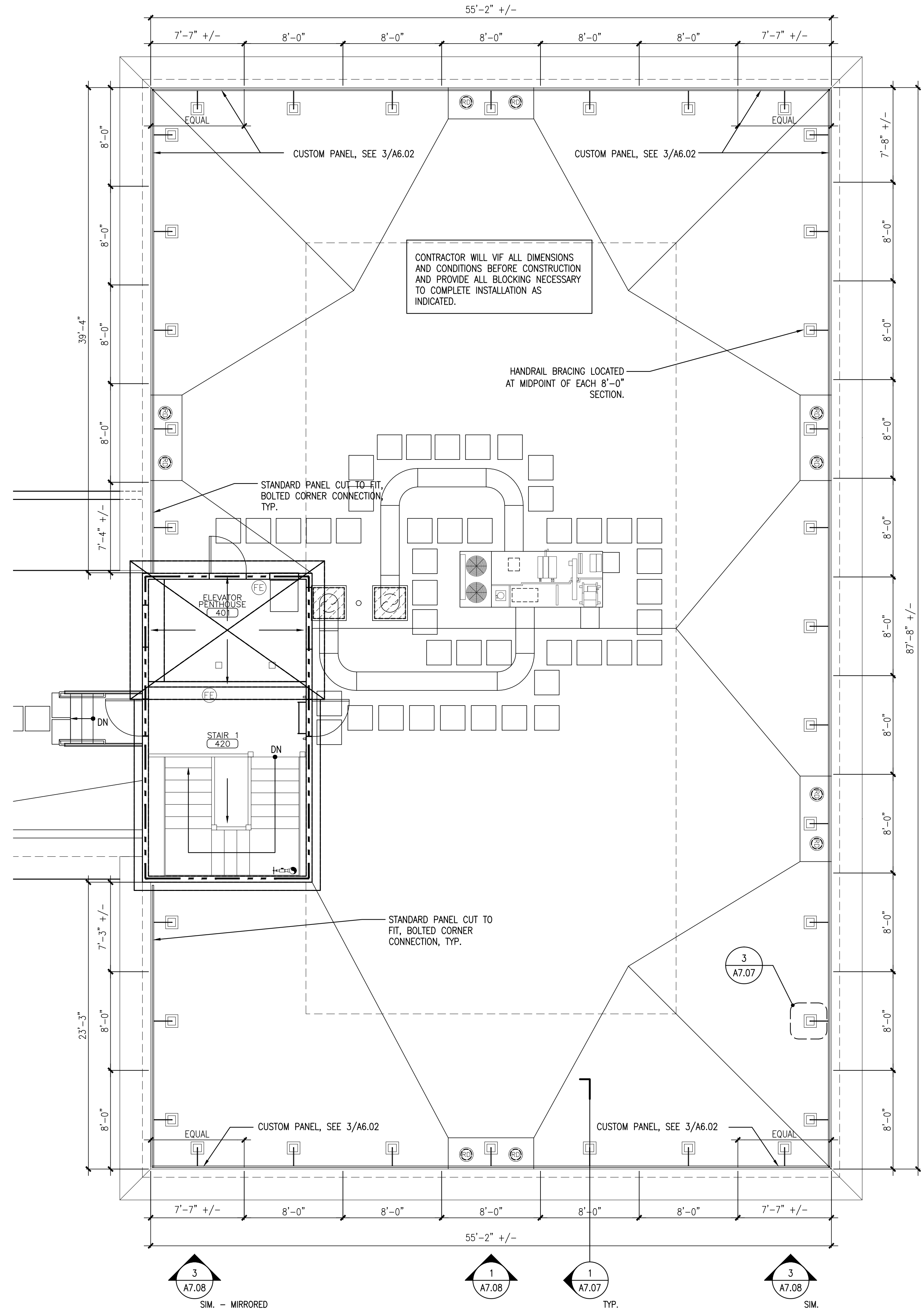

4 ENLARGE ROOF PLAN @ EXISTING BUILDING

REFERENCED FROM:

SCALE: 3/16" = 1'-0"



CWS Architects

Architecture
Space Planning
Value Design

434 Cumberland Avenue
Portland, ME 04101
Phone: (207)774-4441
Fax: (207)774-4016

www.CWSarch.com

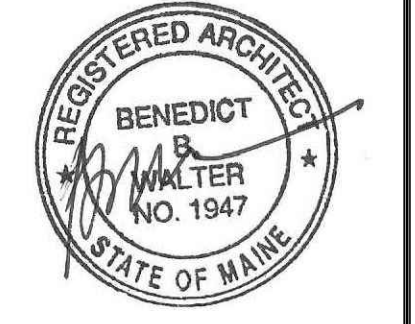

Owner:
Children's Hospital Housing Partners, LP
309 Cumberland Ave.
Suite 203
Portland, Maine 04101

CONSTRUCTION MANAGER:
WRIGHT-RYAN CONSTRUCTION
10 DANFORTH STREET
PORTLAND, ME 04101
TEL: (207) 773-3625

ELM TERRACE

68 HIGH STREET
PORTLAND, MAINE

Project No: 09428

Drawing Title:
ENLARGED ROOF PLAN AND RAILING DETAILS

Scale: AS NOTED

Date: ISSUED SEPTEMBER 8, 2011

- Revisions:
- △ MAINE HOUSING CONCEPT SUBMISSION 02-01-2011
 - △ HISTORIC PRESERVATION SUBMISSION 03-23-2011
 - △ 50% MAINEHOUSING REVIEW 04-01-2011
 - △ 90% MAINEHOUSING REVIEW 06-03-2011
 - △ NPS SUBMISSION 07-01-2011
 - △ ISSUED SEPTEMBER 8, 2011

Drawing Number:

A7.07

9/8/2011 11:47 AM